

Truss Mount 2 Point Strut Brace

911/912/930

READ BEFORE INSTALLATION

The use of any Rennline product is the sole responsibility of the end user. Rennline Inc. accepts no responsibility for warranty voids or damage resulting from the use of these products. Do to the varying location of wiring harnesses and other components, carefully inspect any area prior to drilling. All Rennline products are intended for off road use and should be installed by a qualified automotive technician.

ITEM NO.	QTY.	PART NO.	DESCRIPTION
1	1	SB80_A	STRUT TOWER BASE, TOP RIGHT
2	1	SB80_B	STRUT TOWER BASE, TOP LEFT
3	1	SB80_C	STRUT TOWER BASE, BOTTOM RIGHT
4	1	SB80_D	STRUT TOWER BASE, BOTTOM LEFT
5	6	SB80_E	STRUT TOWER BASE, BUSHING
6	1	CVRM8	1/2-20 ROD END
7	1	CVEM8L	1/2-20 ROD END, LEFT HAND
8	2	6391K174	3/8 BRONZE BUSHING, 1/2 OD
9	4	92196A611	3/8-16 X 1.50 SHCS, S/S
10	12	98017A199	.375 S/S WASHER
11	4	91292A164	M12 X 1.5 X 50mm SHCS, S/S
12	4	91845A031	3/8-16 HEX NUT, S/S
13	1	94846A525	1/2-20 HEX JAM NUT
14	1	99612A136	1/2-20 HEX JAM NUT LEFT HAND

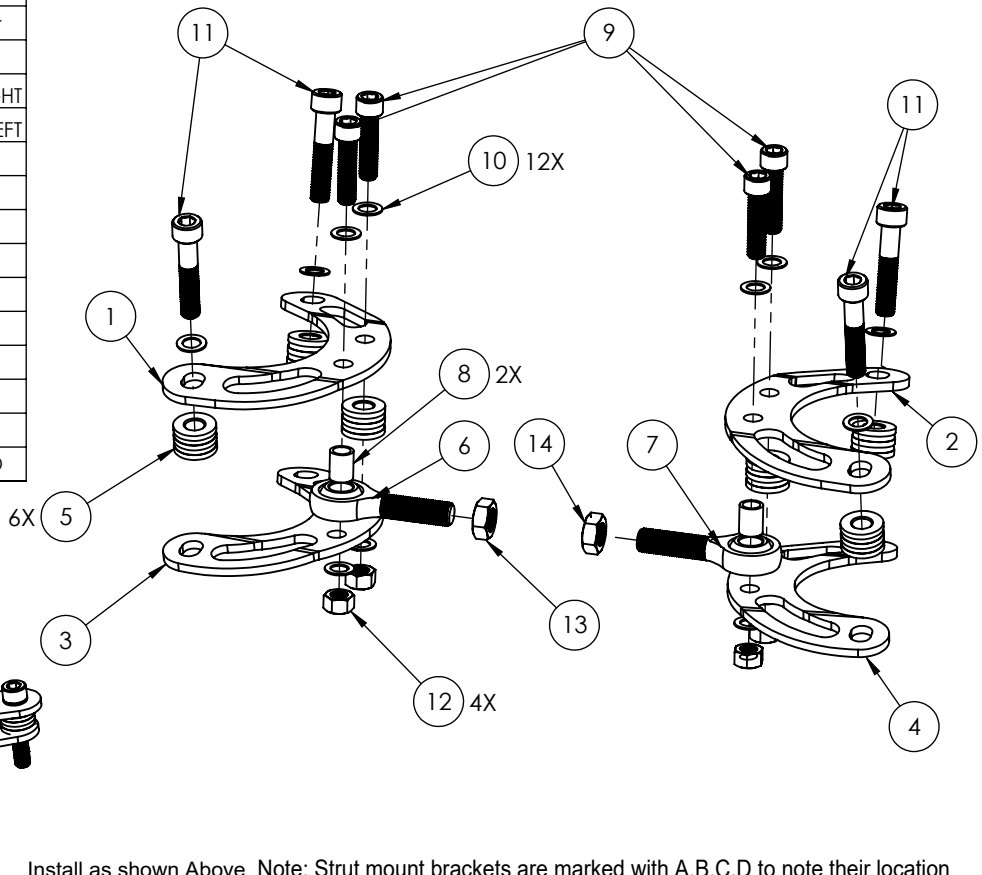

Install as shown Above Note: Strut mount brackets are marked with A,B,C,D to note their location Keep all bolts finger tight until installation is complete.

BARS

Install rod ends into each end of cross bars. All left handed threads are marked in red.

Tighten all components except for the lock nuts on each end of the cross bars.

Cross bar length is adjusted by rotating center bar while end joints stay stationary.

Adjust Cross bars to the desired prestress and then tighten lock nuts.

