



PRODUCT GUIDE

Pruning tools and harvest equipment for the professional fruit industry

TABLE OF CONTENTS

Introduction	2
Hickok Loppers	3-4
Vaca Tree Shears	5-6
Vaca & Superior Vine Shears	7-9
Vaca Girdlers	10
ARS Long Arm Pruners	11
X Series Electric Pruners	12
Fanno Saws	13-15
Vesco & Antonini	16
ARS Pruners & Saws	17
Vaca & Superior Hand Pruners	18
Manzana Clippers	19
Hickok Fruit Clippers	20
W&W Picking Bags	21-22
W&W Buckets	23
W&W Harnesses & Accesories	24
W&W Liners & Clips	25
W&W Cherry Buckets	26
Warranty Information	27



History

Superior Fruit Equipment was founded in 1995 in Wenatchee, WA, the heart of the fruit growing region of the Pacific Northwest. We manufacture four of the most well-known and respected brands in the professional tree fruit industry: Hickok Pruning Tools (established in 1928), Vaca Shears (established in 1912), and Wells & Wade Harvest Equipment (established in 1922) and Fanno Saws (established 1920).

Today, we operate out of our 35,000 square foot building in East Wenatchee. Our location gives us instant access to feedback from users of the tools we manufacture. We are proud to be the sole lopper manufacturer in the USA.

Products

We proudly manufacture our loppers in the USA. Our picking bags and buckets are manufactured both in the USA and in Taiwan. We utilize the latest technology to manufacture the highest quality tools available to the professional tree fruit industry. We only use the finest materials, and all replacement parts are readily available to extend the life of the tools.

Distribution

Our products are sold through stocking dealers located in the various fruit growing regions of the world and now arborist supply stores. We are not structured to mass produce lower quality products to compete in the discount arena. Because of this, our products are only available from those sources that offer the finest quality merchandise for the discriminating buyer. In addition to manufacturing and distributing Hickok Loppers, Vaca Shears, Fanno Saws and Wells & Wade Harvest Equipment we also distribute professional orchard, tree, and vine care products from ARS tools, Manzana Clippers, Vesco Pruning Tools, and Antonini Knives.



TREE & VINE LOPPERS



MADE IN THE USA

- **STRONG ALLOY STEEL**
For a tough, durable, incredible edge
- **ADVANCED HEAT TREATING PROCESS**
Unique to Hickok and Vaca tools
- **LIGHTEST PROFESSIONAL PRUNING TOOL**
Up to 30% lighter than competition
- **ALWAYS "USER FRIENDLY"**
Current parts still fit our 1991 shears
- **MADE IN THE USA**
American craftsmanship since 1928
- **LIFETIME WARRANTY**
For the useful life of the tool



Vine Loppers



20M	20V	24M	24V
Length 20 in. 508 mm.	Length 20 in. 508 mm.	Length 24 in. 610 mm.	Length 24 in. 610 mm.
Weight 1.94 lbs. 0.88 kgs.	Weight 1.46 lbs. 0.66 kgs.	Weight 2.12 lbs. 0.96 kgs.	Weight 1.72 lbs. 0.78 kgs.
Case 10 qty. 22 lbs.	Case 10 qty. 18 lbs.	Case 10 qty. 25 lbs.	Case 10 qty. 21 lbs.

Tree Loppers



28A	28W	32A	32W	36A	36W	42A
Length 28 in. 711 mm.	Length 28 in. 711 mm.	Length 32 in. 838mm.	Length 32 in. 838mm.	Length 36 in. 914 mm.	Length 36 in. 914 mm.	Length 42 in. 1066 mm.
Weight 2.62 lbs. 1.19 kgs.	Weight 2.22 lbs. 1.01 kgs.	Weight 2.86 lbs. 1.30 kgs.	Weight 2.54 lbs. 1.15 kgs.	Weight 3.04 lbs. 1.38 kgs.	Weight 2.76 lbs. 1.27 kgs.	Weight 3.35 lbs. 1.51 kgs.
Case 10 qty. 30 lbs.	Case 10 qty. 28 lbs.	Case 10 qty. 33 lbs.	Case 10 qty. 30 lbs.	Case 10 qty. 36 lbs.	Case 10 qty. 32 lbs.	Case 10 qty. 38 lbs.

Also available in 26" and 30" overall lengths.

HICKOK REPLACEMENT PARTS



HICKOK LOPPERS

Item #		Description
Tree	Vine	
400	600	Replacement blade
405	605	Replacement hook
410	410	Centerbolt assembly (bolt & nut)
413	413	Lock nut
415	615	Bumper assembly (complete)
150-xx	250-xx	Hickory handle (xx=length)
450-xx	650-xx	Aluminum handle (xx=length)
141 (B/P)	141 (B/P)	Nut & bolt for hickory handles
441 (B/P)	441 (B/P)	Nut & bolt for aluminum handles

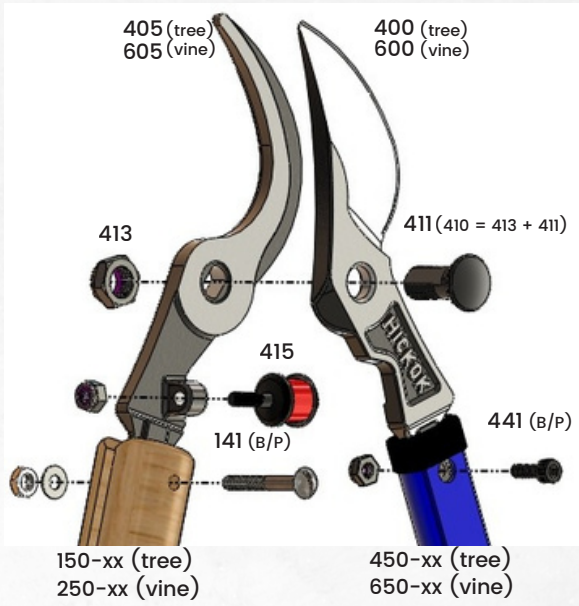

MADE IN THE USA

REPLACEMENT PARTS

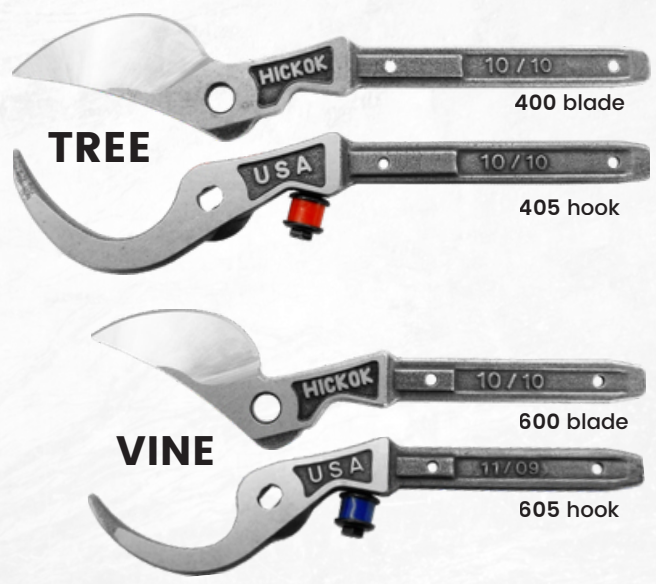

4900 SERIES 'STANDARD'



Lightweight tree shear for rapid, clean cutting and user comfort

4922A	4922H	4924A	4924H	4926A	4926H
Length Handle: 22" Overall: 27"	Length Handle: 22" Overall: 27"	Length Handle: 24" Overall: 30"	Length Handle: 24" Overall: 30"	Length Handle: 26" Overall: 32"	Length Handle: 26" Overall: 32"
Case 10 qty. 25 lbs.	Case 10 qty. 24 lbs.	Case 10 qty. 27 lbs.	Case 10 qty. 26 lbs.	Case 10 qty. 30 lbs.	Case 10 qty. 29 lbs.

4928A	4928H	4930A	4930H
Length Handle: 28" Overall: 34"	Length Handle: 28" Overall: 34"	Length Handle: 30" Overall: 36"	Length Handle: 30" Overall: 36"
Case 10 qty. 31 lbs.	Case 10 qty. 31 lbs.	Case 10 qty. 32 lbs.	Case 10 qty. 32 lbs.



REPLACEMENT PARTS

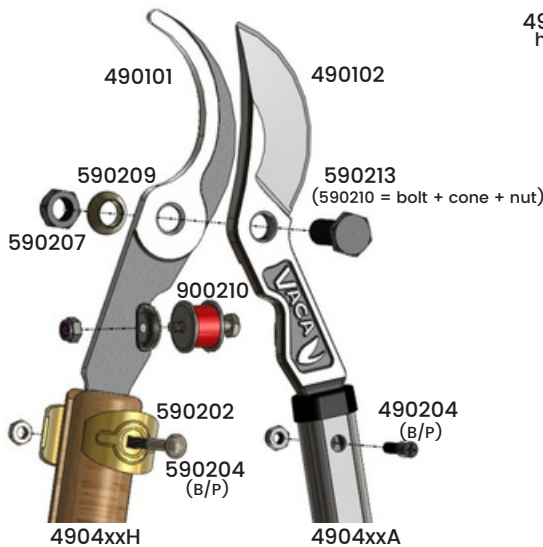

900110
Vaca bumper kit
(nut & bolt)



900100
Corona bumper kit
(rivet)



590210
4900 centerbolt kit
(bolt/cone/nut)



590202
handle clip



490204 (B/P)
bolt & nut
(aluminum handle)



590204 (B/P)
bolt & nut
(hickory handle)



4904xxA
aluminum handle



4904xxH
hickory handle

Aluminum & Hickory
Handles

(with handle bolts)

Item	#Length
490422A/H	22"
490424A/H	24"
490426A/H	26"
490428A/H	28"
490430A/H	30"

B = Bulk packed (1 nut, 1 bolt)
P = Packaged pair (2 nuts, 2 bolts)

VACA TREE LOPPERS

5900 SERIES 'CLASSIC'



VACA TREE LOPPERS



This tree shear is very popular with orchard professionals for larger cutting requirements. Its durable construction is built for heavier cutting jobs.

5922A	5922H	5924A	5924H	5926A	5926H
Length Handle: 22" Overall: 27"	Length Handle: 22" Overall: 27"	Length Handle: 24" Overall: 30"	Length Handle: 24" Overall: 30"	Length Handle: 26" Overall: 32"	Length Handle: 26" Overall: 32"
Case 10 qty. 27 lbs.	Case 10 qty. 26 lbs.	Case 10 qty. 29 lbs.	Case 10 qty. 28 lbs.	Case 10 qty. 31 lbs.	Case 10 qty. 30 lbs.

5928A	5928H	5930A	5930H
Length Handle: 28" Overall: 34"	Length Handle: 28" Overall: 34"	Length Handle: 30" Overall: 36"	Length Handle: 30" Overall: 36"
Case 10 qty. 33 lbs.	Case 10 qty. 32 lbs.	Case 10 qty. 35 lbs.	Case 10 qty. 34 lbs.

REPLACEMENT PARTS



590301
plug



590302
plunger



590303
spring



141 (B/P)
590204 (B/P)
bolt & nut
(hickory handle)



490204 (B/P)
bolt & nut
(aluminum handle)



590300
black rubber bumper

[B = Bulk packed (1 nut, 1 bolt)
P = Packaged pair (2 nuts, 2 bolts)]

Handles
(with handle bolts)



590202
handle clip



590210
5900 centerbolt kit
(bolt/cone/nut)



5904xxA
aluminum handle



5904xxH
hickory handle

Item #	Length
590414A/H	14"
590417A/H	17"
590422A/H	22"
590424A/H	24"
590426A/H	26"
590428A/H	28"
590430A/H	30"

Hook



590105
5700 series



590103
5800 series



590101
5900 series

Blade



590106
5700 series



590104
5800 series



590102
5900 series

5700 SERIES 'MIGHTY MIGHT'

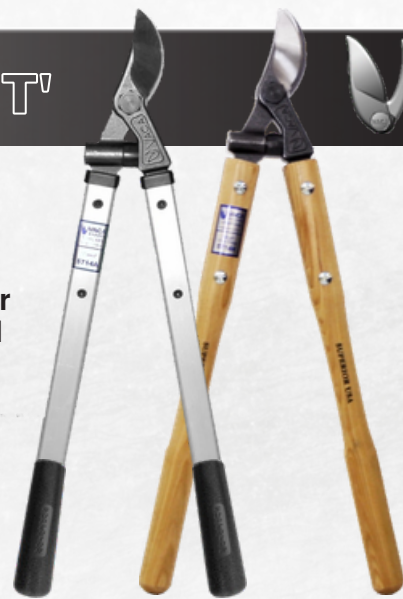

5714A

Length
Handle: 14"
Overall: 20"

Case
10 qty.
17 lbs.

5714H

Length
Handle: 14"
Overall: 20"

Case
10 qty.
17 lbs.

Lightweight vine shear for fast work in the vineyard

5800 SERIES 'CLASSIC'

Professional vine shear for larger vines and dwarf trees. Slim head design makes this shear very popular.



5817A

Length
Handle: 17"
Overall: 22"

Case
10 qty.
23 lbs.

5822A

Length
Handle: 22"
Overall: 26"

Case
10 qty.
25 lbs.

5822H

Length
Handle: 22"
Overall: 26"

Case
10 qty.
24 lbs.

5824A

Length
Handle: 24"
Overall: 29"

Case
10 qty.
26 lbs.

5824H

Length
Handle: 24"
Overall: 29"

Case
10 qty.
25 lbs.

See page 6 for replacement parts

5700 SERIES



5800 & 5900 SERIES

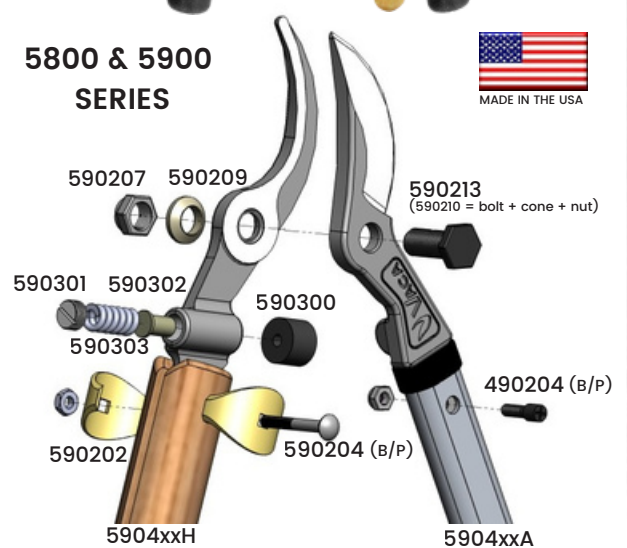

VACA VINE LOPPERS

4700 SERIES 'STANDARD'



VACA VINE LOPPERS

Lightweight professional vine shear

**NEW WITH
RIGHT HAND
CENTERBOLT**

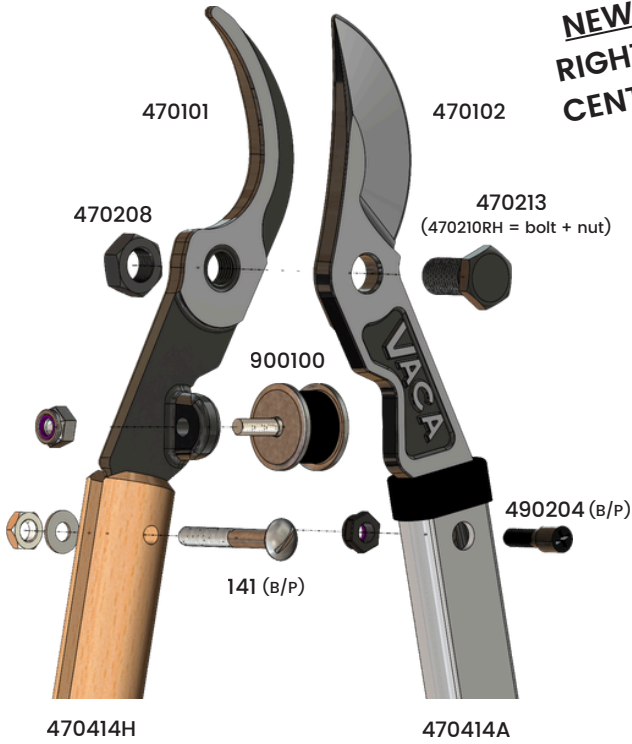

4714A
Length
Handle: 14"
Overall: 19"
Case
10 qty.
15 lbs.

4714H
Length
Handle: 14"
Overall: 19"
Case
10 qty.
16 lbs.

REPLACEMENT PARTS



900100*
rubber bumper kit



470210RH*
R.H. centerbolt & nut
(Left hand centerbolt available)



490204 (B/P)
bolt & nut
(aluminum handle)



141 (B/P)
bolt & nut
(hickory handle)



470101RH* / 470101LH*
R.H. hook L.H. hook



470102*
blade

*Interchangeable
with discontinued
Corona model
195 BN



470414A
aluminum handle



470414H
hickory handle



MADE IN THE USA

ASPARAGUS KNIFE

Available in 21" and 23"

V Blade

HAK-V21
HAK-V23

Angled Blade

HAK-A21
HAK-A23



Blades Available

- HAK-VB Replacement Blades Qty. 25
- HAK-AB Replacement Blades Qty. 25
- HAK-VB200 Replacement Blades Qty. 200
- HAK-AB200 Replacement Blades Qty. 200

- Ergonomic Handle
- Steel handles
- Side of Blade Sharpened
- High -Carbon Steel
- Case pack 10

SVF SERIES VINE SHEARS

SVF-20

- 20" overall length
- Steel handles
- Forged Steel blade/hook
- Compare to Bahco P14 Series
- Parts interchangeable w/ Bahco P14 series
- Case pack - 10

SVF-24

- 24" overall length
- Steel handles
- Forged Steel blade/hook
- Compare to Bahco P14 Series
- Parts interchangeable w/ Bahco P14 series
- Case pack - 10



VINE LOPPERS

SUPERIOR



REPLACEMENT PARTS



SVF-20H*
Hook



SVF-20B*
Blade



SVF-20RB*
Bumper (set)



SVF-20CB*
Bolt, nut & washer



SVF-20BN
Handle bolt & nut

*Interchangeable with Bahco Model P14-50
All Parts Interchangeable with SV-20 and SV-24

Item #	Description	Overall Length	Case Pack	Case Weight
5600	Cane Girdler	4 3/4"	10	2 lbs.
5601	Trunk Girdler 1/8"	9"	10	4 lbs.
5602	Trunk Girdler 3/16"	9"	10	4 lbs.
5603	Trunk Girdler 1/4"	9"	10	4 lbs.
5607	Trunk Girdler 2mm	9"	10	4 lbs.
5604	Trunk Girdler 1/8" with 1" scraper	10 1/2"	10	5 lbs.
5605	Trunk Girdler 3/16" with 1" scraper	10 1/2"	10	5 lbs.
5606	Trunk Girdler 1/4" with 1" scraper	10 1/2"	10	5 lbs.
5608	Trunk Girdler 2mm with 1" scraper	10 1/2"	10	5 lbs.

The Practice of Girdling...

Agricultural girdling is the removal of a strip of bark on either the trunk or cane to advance maturity or produce larger fruit.

Hard chrome plated blade



Cane Girdler

#5600



MADE IN THE USA

Trunk Girdler

- #5601 - 1/8"
- #5602 - 3/16"
- #5603 - 1/4"
- #5607 - 2mm

Trunk Girdler w/scraper

- #5604 - 1/8" w/scraper
- #5605 - 3/16" w/scraper
- #5606 - 1/4" w/scraper
- #5608 - 2mm w/scraper

VACA GIRDLEERS

LONG ARM PRUNERS

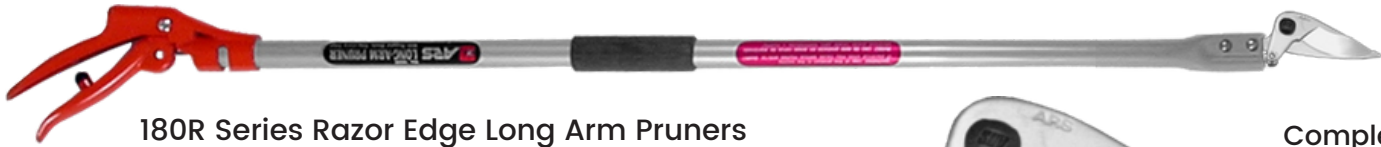

180R Series Razor Edge Long Arm Pruners

180R1.2
4 ft.

180R1.8
6 ft.

180R2.4
8 ft.

A28
Razor edge head
for 180R Series



Complete list of
replacement parts
available

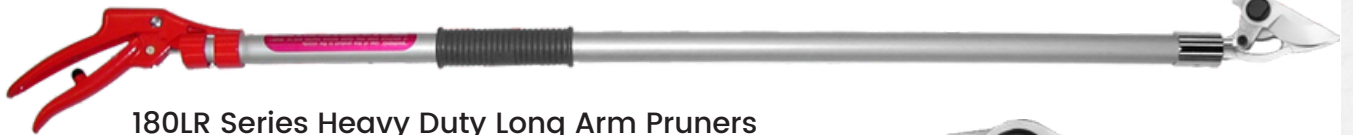

180LR Series Heavy Duty Long Arm Pruners

180LR1.2
4 ft.

180LR1.8
6 ft.

180LR2.1
8 ft.

A180L-1
Heavy duty head
for 180L Series



TELESCOPIC PRUNERS



160ZF Series Cut & Hold Telescopic Pruners

160ZF203
4 ft. - 7 ft.

160ZF305
6 ft. - 10 ft.

160ZF1
Cut & Hold head for
160ZR Series

Cut & Hold (160ZF Series)
Holding device allows you to cut
& hold branches, fruit, leaves,
or flowers for easy retrieval.

½ inch cutting capacity



180ZF Series Telescopic Pruners

180ZF203
4 ft. - 7 ft.

180ZF305
6 ft. - 10 ft.

180ZF1
Razor edge head for
180ZF Series

Razor Edge (180ZF Series)
Slim design dropped forged blades are
hard chrome plated for sap and mold
resistance.



ARS LONG ARM PRUNERS

DEMO UNITS AVAILABLE!

ELECTRIC PRUNERS



HICKOK

by Vesco

ELECTRIC PRUNERS

INCLUDES 2 BATTERIES & CHARGER!



X37AF

- 1.3" cutting capacity
- Progressive trigger technology
- 8 hour cutting time between two batteries
- Available in 32" and 64" lengths & 60-90" telescopic
- Lightweight—only 4.4 lbs



CORDLESS



#AST54/150-230



#ASF54/220



#ASF54/160



#ASF54/90

EXTENSION POLES AVAILABLE IN 3
FIXED SIZES OR TELESCOPIC
32/64/86 INCH FIXED
60-90 INCH TELESCOPIC



X100
CORDLESS SAW

X100

- Vesco Battery Pack LitePro 38
- 4" cutting capacity
- 180 cut battery life
- fixed & telescopic pole options



X37
CORDLESS

X37

- Vesco Battery Pack LitePro 54
- 1.3" cutting capacity
- 8 hour battery life
- fixed & telescopic pole options
- includes 2 batteries



X30
CORDLESS

X30-B1

- Vesco Battery Pack LitePro 38
- 1.25" cutting capacity
- 3-4 hour battery life
- 2 batteries included

Accessories Included:



X SERIES ELECTRIC PRUNERS

- Hot forged chrome vanadium steel cutting head gives exceptional mechanical performance:
 - Mechanical resilience
 - Light weight
 - Thin profile
- Progressive cutting system reacts instantly to the trigger position to help make clean precise cuts
- Quickly switch to the smaller-opening mode to speed through small diameter cuts
- External grease fitting allows for lubricating the cutting head without disassembling it



made in Italy

FOLDING SAWS



FS0

- 14" cutting edge
- 6 points per inch



FS1

- 10.5" cutting edge
- 6 points per inch



FS2

- 8.5" cutting edge
- 7 points per inch



FS3

- 9" cutting edge -
- 7 points per inch

Replacement blades available



FI-112

- 10" cutting edge
- 6 points per inch



FIXED BLADE LANCETOOTH SAWS

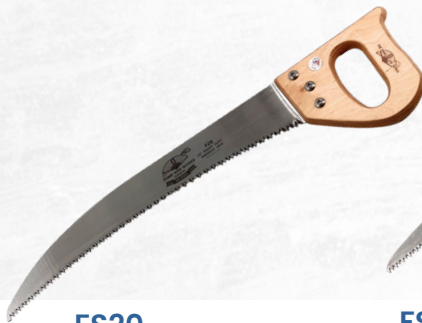

FS20

- 19" cutting edge
- 5 points per inch
- FS9sB blade



FS4

- 13" cutting edge
- 6 points per inch
- FS4B blade



FS14

- 13" cutting edge
- 7 points per inch
- FS14-B blade

PT-45/ RF-05

- 16.5" cutting edge
- 5.5 points per inch
- 30" handle



FS22

- 21" cutting edge
- 5 points per inch
- FS22-B blade



FS24

- 22.5" cutting edge
- 4.5 points per inch
- FS24-B blade



FS-K24

- 22.5" cutting edge
- 4.5 points per inch
- FS-K24-B blade



FS7

- 24" cutting edge
- 6 points per inch
- FS7-B blade



FS8

- 22" cutting edge
- 5.5 points per inch
- FS8-B blade



FS30

- 30" cutting edge
- 4.5 points per inch
- FS30-B blade

MADE IN USA

 WITH U.S. &
 INTERNATIONAL
 PARTS

**SPECIAL
 USE SAWS**

FANNO SAWS

FIXED BLADE TRI-EDGE SAWS



FANNO ARBORIST SAWS



FI-1311

- 13" cutting edge
- 6 teeth per inch
- FI-13sB blade

FI-1300

- 13" cutting edge
- 6 teeth per inch
- FI-13sB blade

FI-K1500

- 13" curved raker
- 6 teeth per inch
- FI-K15sB blade

**NEW
IMPROVED
DESIGN!**



FI-1330

- 13" cutting edge
- 6 teeth per inch
- 30" handle

FI-1311PGS

- 13" cutting edge
- 6.4 teeth per inch
- rubber handle

FI-1700

- 15" cutting edge
- 5.5 points per inch
- "Mondo" saw

SAW SHEATHS

NEW!



FI-1311PS

- plastic sheath for FI-1311

BS-20/LS-20

- sheath for FS20
- rubberized or leather

BS-22/24 / LS-22/24

- sheath for FS22 & FS24
- rubberized or leather

BS-1125S

- sheath for FI-1125sB
- rubberized



BS-1700/LS-1700

- sheath for FI-1700
- rubberized or leather

BS-HH17S

- sheath for FI-HH17sB
- rubberized

BS-5S

- sheath for FS-9sB & FS-5sB
- rubberized

LS-1311

- sheath for FI-1311
- leather



FANNO SAW WORKS

1920 100+ YEARS 2020

POLE SAW BLADES



ASH-rd

- aluminum socket head
- updated design



PSS-3T

- Secures your pole saw when climbing & repositioning in the canopy
- Clips securely and easily to harness



FS-PSM

- pole saw head with mounting bolts

Fiberglass Pole - slotted & drilled or blank



FPS-6

6 ft.

FPS-8

8 ft.

FPS-10

10 ft.

FPS-12

12 ft.

FPS-14

14 ft.

AGRICULTURE



FI-500B

- 19.5" tri-edge blade
- 16.5" cutting edge
- 5.5 teeth per inch



FS5-B

- 19.5" lance tooth blade
- 16.5" cutting edge
- 5.5 points per inch

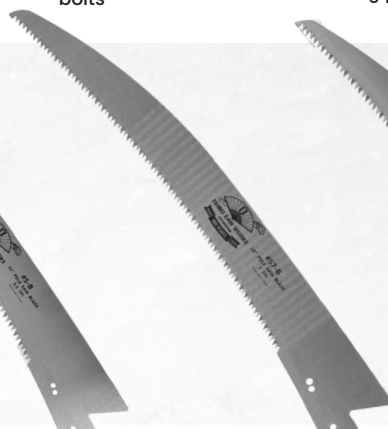

FS57-B

- 19.5" lance tooth blade
- 15.5" cutting edge
- 7 points per inch



FS9-B

- 22.5" lance tooth blade
- 17" cutting edge
- 5 points per inch



FS9s-B

- 20.5" lance tooth blade
- 19" cutting edge
- 5 points per inch

ARBORICULTURE



FS5s-B

- 19.5" lance tooth blade
- 16.5" cutting edge
- 5.5 points per inch



FI-13sB

- 14.5" tri-edge blade
- 13" cutting edge
- 6 teeth per inch



FI-HI13sB

- 15.5" tri-edge blade
- 13" cutting edge
- 6 teeth per inch



FI-K15sB

- 15.5" tri-edge tooth blade - 13" cutting edge
- 6 teeth per inch

ARBORICULTURE



FI-17sB

- 17" tri-edge tooth blade
- 15" cutting edge
- 5.5 teeth per inch

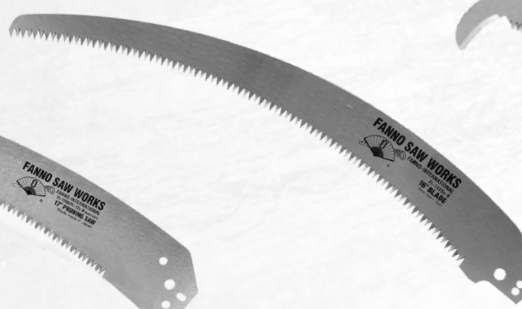

FI-1125sB

- 16.5" bi-edge blade - 15" cutting edge
- 6 teeth per inch

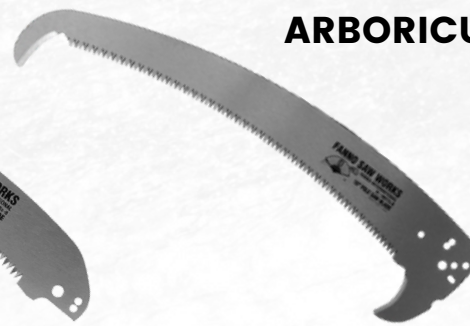

FI-HH17sB

- 18" tri-edge tooth blade
- 14" cutting edge
- 5.5 teeth per inch

FANNO SAWS

ANVIL & BY-PASS LOPPERS



T20/80

VESCO Curved Anvil
Lever Action Lopper - 31.5"



V60/50

VESCO 20" By-
Pass Branch Cutter



HAND PRUNERS



A2-ML

VESCO
Double-Cut
Pruner



A6

VESCO
8" Curved Anvil
Hand Pruner



A3

VESCO
By-Pass Short
Blade Vine
Shear



A1

VESCO By-
Pass Vine
Shear

GRAFTING KNIVES BUDDING/GRAFTING



5791

ANTONINI Grafting Knife
Folding / Stainless



5771

ANTONINI Budding / Grafting
Knife Folding / Stainless

VESCO
MADE IN ITALY

HAND PRUNERS & CLIPPERS



3 Sizes Available

130DX

7" fine cut light duty pruner
Multiple colors

140DX

7" straight blade pruner
Multiple colors

FB-8

8" lightweight ergonomic pruner

VS-7XZ

7" heavy duty professional pruner

VS-8XZ

8" heavy duty professional pruner

VS-9XZ

9" heavy duty professional pruner



300L

7" high carbon steel straight blade grape clipper

300SS

6" high carbon steel straight blade grape clipper

310

6" high carbon steel curved blade grape clipper

330HN

6" multi-purpose scissor w/ blade cap
Multiple colors

340H-T

7.5" utility scissor

FOLDING SAWS



210DX

-5.5" tri-edge tooth blade
-plastic handle

G-18L

- 7" tri-edge tooth blade
- plastic handle

GR-17

- 6.5" tri-edge tooth curved blade
- rubber grip

FIXED BLADE SAWS



UV-32E

13" turbocut saw w/ sheath and tri-edge tooth blade (with gullets)

CT-32E

13" turbocut saw w/ sheath and tri-edge tooth blade (no gullets)

UV-32EN

13" curved saw with gullets and plastic handle (no sheath)

CAM18LN

Pruning saw w/ sheath and 7" tri-edge tooth blade

ARS PRUNERS & SAWS

GRAPE CLIPPERS



VACA & SUPERIOR

CLIPPERS & PRUNERS



5121

7" carbon steel curved blade



5122

7" stainless steel straight blade



5125

7" stainless steel curved blade



5123

6" stainless steel curved blade

SHEATHS



LS-100C

Leather sheath w/ clip for small pruners



LS-200C

Leather sheath w/ clip for large pruners & folding saws



LS-300C

Leather sheath with Clip (for Grape Clippers)

HAND PRUNERS



Replacement Parts Available



HP-4

7.5" heavy duty pruner

5/8" CUT



HP-2

8.5" heavy duty pruner

1" CUT



HP-8

8.25" hand pruner

1" CUT



HP-6

7.75" hand pruner

3/4" CUT



HP-5

7.5" hand pruner

7/8" CUT

Teflon Coated

FRUIT STEM CLIPPERS



MANZANITA CLIPPERS

M96-AM
Manzana
mandarin clippers



M14-AM
Manzana
citrus/apple
clippers with
leather strap

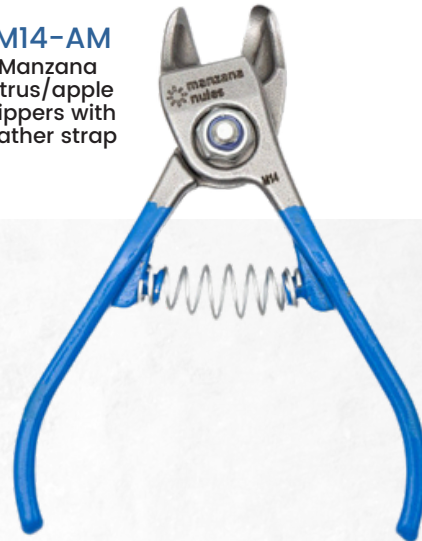

M22-AM
Manzana avocado
clippers with
leather strap



M21-C
Manzana garlic
clippers



EXCLUSIVE
USA distributor for
Manzana Clippers

- By-pass cutting system**
Unique by-pass system provides for a clean cut every time
- Extra-fine cutting blade**
Blade is designed to cut right at the peduncle
- Ergonomic design**
Fits comfortably in hand; curved design helps reduce fatigue

- Curved & rounded tips**
Avoids punctures to the skin of the fruit
- Counter-blade relief**
Avoids scrapes & scratches to the skin of the fruit
- Carbon steel**
Allows steel to be heat treated for optimum strength & durability

FRUIT STEM CLIPPERS



HICKOK FRUIT STEM CLIPPERS

Rounded tips ensure there are no apple punctures.

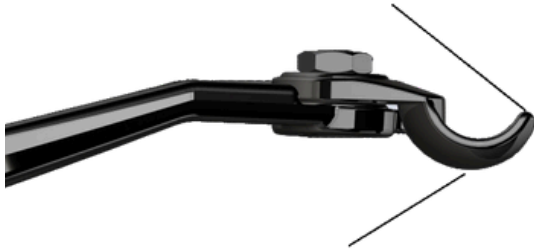

Small radius cutting edge allows clipper to clip the stem down inside the bowl of the apple.

Open tips require proper angle to clip helping to prevent clipper punctures

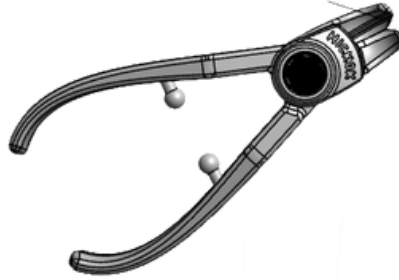

FC-200

- Puncture proof design
- Deeper bowl and rounder tips compared to FC-100
- Prevents clipper damage
- Ergonomic design

Designed for apples!



FC-300

- By-Pass blades to cut stem
- Puncture proof design
- Effortless cutting for less fatigue
- Deeper bowl/ rounder tips compared to FC- 200



FC-SS

Hickok Stem Stopper

- Stop damage from clipped stems
- Fits FC-200 & FC-300
- Stainless steel
- Sold separately or attached

*Holds stem until released outside of your bag or bucket.



KEEP CLIPPED STEMS OUT OF YOUR BAG, BUCKET, AND BIN!



MADE IN THE USA



Item #	Description	Fruit Capacity	Weight (lbs.)	Height (in.)	Length (in.)	Width (in.)
73187	Cordura short bag	1 bushel (42 lbs.)	2.00	28	18	9
73393	Cordura long bag	1 1/3 bushel (56 lbs.)	2.10	34	18	9



73153 (80RL)
Cotton Picking Bag - Long
 Same as 80R but 6" longer for added capacity. Holds 1 1/3 bushel (56 lbs.). Comes with standard 96" strap



73187 (80S)
Cordura Picking Bag
 Cordura bag w/ padded back, leather padded rim & strong steel frame. Water, mildew, mold & abrasion resistant. Holds 1 bushel (42 lbs.). Comes with standard 96" strap



73393 (80SL)
Cordura Picking Bag - Long
 Same as 80S but 6" longer for added capacity. Holds 1 1/3 bushel (56 lbs.). Comes with standard 96" strap

INDUSTRIAL GRADE BUBBLE PACK LAYER



73250
Padded Fruit Picking Bag
 Cordura nylon bag w/ sewn-in padded layer for extra fruit protection, padded back, leather/foam padded rim & strong steel frame. Water, mildew, mold & abrasion resistant. Holds 1 bushel (42 lbs.). Comes with standard 96" strap

MADE IN USA

 WITH U.S. & INTERNATIONAL PARTS



73200
RipStop Fruit Picking Bag
 RipStop material with padded rim and sewn in ropes. Holds 1 bushel (42 lbs.). Comes with standard 96" strap

W&W PICKING BAGS

PICKING BAGS



NYLON

NEW DESIGN!

CORDURA

Item #	Description
74340	40 lbs Nylon Citrus Bag
74365	65 lbs Nylon Citrus Bag
74380	80 lbs Nylon Citrus Bag
74450	50 lbs Cordura Citrus Bag
74465	65 lbs Cordura Citrus Bag
74480	80 lbs Cordura Citrus Bag



W&W PICKING BAGS



73420
Canvas Picking Sleeves
- Sold in Pairs
- 2 Sets of Snaps



75575
Vinyl Citrus Picking Bag 75lb
- "Cosner" Style
- Heavy Vinyl Material
- Includes snap hook, rope, welded "O" rings, and shoulder strap

NEW!



75540
Vinyl Peach Picking Bag 40lb
- "Cosner" Style
- Heavy Vinyl Material



73600
California Apple/Peach Picking Bag
- With Padded Straps
- Heavy Nylon Material
- Reinforced Corners
- Stiffer Back Panel



57006P-DH
Apple Bag/Bucket- Padded
- Padded Straps
- Heavy Nylon Material
- Padded Rim & Bucket
- Padded Skirt
- Snap Hooks/Rings/Ropes
- Zipper option available, folds down flat

PICKING BUCKETS

W&W
Harvest Equipment



SINCE 1918

Parts & replacement bottoms available

Item #	Description	Fruit Capacity	Weight (lbs.)	Height (in.)	Length (in.)	Width (in.)
7P104	Jumbo picking bucket	3/4 bushel (32 lbs.)	4.84	11 1/2	15	11
7P105	Jumbo picking bucket w/ padded bottom	2/3 bushel (28 lbs.)	5.38	11 1/2	15	11

Intended to be worn in front of body only. Side wear may cause damage to bucket due to uneven weight distribution.



Inside view of 7P105 skirt



Sewn-in plastic - padded insert protects fruit in bottom of bucket.



7P104

Jumbo plastic fruit picking bucket w/ leather padded rim & foam liner. Holds 3/4 bushel (32 lbs.)

7P104S

Same as 7P104 except single shoulder strap Holds 3/4 bushel (32 lbs.)

7P105

Same as 7P104 except with rigid padded bottom sewn into skirt. Holds 2/3 bushel (28 lbs.)

7P005

Same as 7P104 except with no foam liner. Holds 3/4 bushel (32 lbs.)

7P039

Same as 7P104 except with no leather rim or foam liner. Holds 3/4 bushel (32 lbs.)

All buckets come with standard 96" strap (#73757)

W&W BUCKETS

HARNESSES & ACCESSORIES

W&W ACCESSORIES



73757

96" heavy duty cotton strap
(108" also available-73781)



73486

Heavy duty comfort harness



73488

Heavy duty padded
comfort harness



73410

Rope Bag
Diameter: 9.5 in.
Height: 10 in.
Strap: 52 in.



24350

Single strap padded
harness (Includes slides)
(not for use with #7P104 or 7P105)

DELUXE!



73450

Comfort shoulder pads (pair)



24352

Deluxe single strap padded
harness



73418

W&W Blueberry
Picking Harness
with Snaps



73430

Coffee Belt
(Mega Grip material)
(Includes snap hooks)



74230

Heavy duty snap
hooks (pair)



74230

2" Snap Hook for
Cherry Buckets

LINERS & CLIPS



MADE IN THE USA

BL-1
Plastic Bag Liner
-100 bags per roll
RECYCLABLE ♻️

**HELPS KEEP BAG
& PICKER DRY!**



**CERTIFIED
FOOD SAFE**



M24-C
Manzana / W&W Plastic Fruit Caliper
(inches)



REUSABLE



LC-1
Liner Clips
-12 sets per case (6 per set)
Fits 73187, 73397, 73120, 73153

LC-3
Bucket Liner Clips
-12 sets per case (6 per set)
Fits 7P104 / 7P105



**KEEPS BAG &
BUCKET CLEAN!**

W&W LINERS & CLIPS

HARNESSES & BUCKETS



MADE IN THE USA

Item #	Description	Fruit Weight Capacity (lbs.)		Height (in.)	Length (in.)	Width (in.)
89000	18 qt. cherry bucket	18 qts.	2.60	8 1/2	17 1/4	11 1/4
89200	22 qt. cherry bucket	22 qts.	2.82	8 1/2	18	13

KIDNEY-SHAPED



D-SHAPED



FOOD GRADE SAFE

89000

18 qt. plastic cherry / olive bucket

89001

18 qt. plastic cherry / olive bucket with pad

89200

22 qt. plastic cherry / olive bucket

89201

22 qt. plastic cherry / olive bucket with pad

Also used for coffee and other fruits & vegetables Harnesses sold separately. See below.



73484

Deluxe cotton cherry harness with snap hooks



73520

Seatbelt webbing harness w/ padded patch Also available in long (#73520-L)

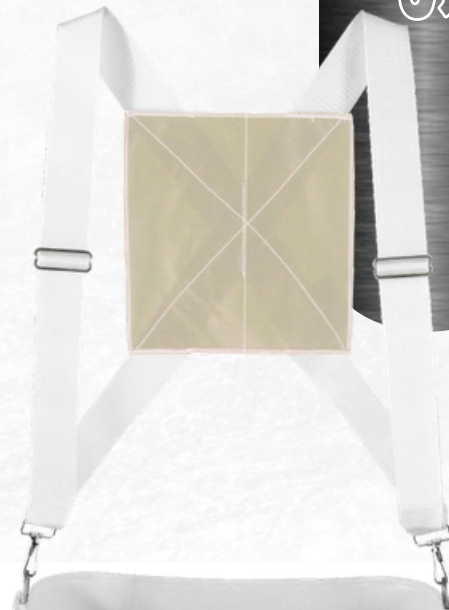

73518

Standard polyester cherry harness with snap hooks

W & W
CHERRY BUCKETS



CONTACT

3557 Territorial Way
East Wenatchee, WA 98802

Phone: (509) 662-6065

Fax: (509) 662-1661

Email: sales@sfequip.com

Web: www.sfequip.com

Hours: 8:00am -5:00pm Mon - Thurs

8:00am -4:00pm Fri
(Pacific Standard Time)



WARRANTY POLICY

Superior Fruit Equipment warrants to the original purchaser that the products we manufacture and sell are free from defects in material and workmanship for the useful life of the specific tool. Normal wear or incidental damage to the tool from use or maintenance is not covered. We reserve the option to repair or replace any product returned under warranty and only if, in our judgement, the product has not been misused or altered inappropriately.

The product must be returned to the factory freight prepaid with a copy of the original invoice. After inspection, repair or replacement we will ship the product back freight by like method.

Regarding Hickok and Vaca loppers: Superior Fruit Equipment will replace parts that have failed due to defects in materials or workmanship. We will not replace parts that have been abused or misused, including:

- Blades filed razor thin with the factory cutting bevel removed
- Aluminum handles bent from attempting to cut material too hard or too large
- Wood handles broken
- Hook or blade tangs broken at the top of the handle

Extensive laboratory testing shows that when a lopper is subjected to excessive cutting force but the handles are kept in alignment, the blade/hook tang fails through the top bolthole. This is a rare occurrence with the handles normally breaking (wood) or bending (aluminum) first. A tang broken above the top bolthole indicates that side loading or twisting occurred and the resulting torque breakage is not covered by warranty.