

# Revelite AL - Standard Mount

Installation Instructions

cerno®

## General Product Information

This product is suitable for indoor dry and damp locations only.

THIS IS A LOW VOLTAGE (24VDC) FIXTURE AND MUST BE USED WITH THE SUPPLIED OR MANUFACTURER APPROVED POWER SUPPLY



### CAUTION - RISK OF FIRE



The hardwire version requires installation by a qualified electrician. Before installing be sure to read all instructions and **TURN POWER OFF TO THE JUNCTION BOX.**

This fixture is only compatible with 0-10V low voltage dimmers. Dimming control cannot be achieved using TRIAC, ELV, or other phase-dimming methods.

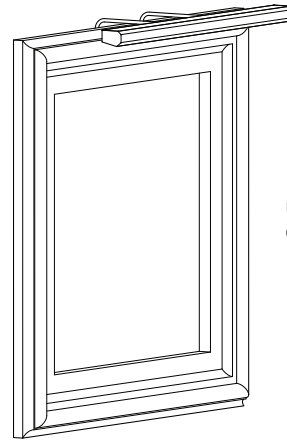

US Patent # 7,070,293 and 9,134,004.  
Other US and International Patents Pending

## Installing the Mounting Bracket

- 1 Attach the plastic mounting bracket and reinforcement bracket to the back of the frame using the supplied #8 panhead screws.
- 2 If necessary, use the included spacers to ensure that when the mounting arms are slid into the bracket, they will be clear of any obstructions on the back of the frame and canvas.

Alternatively, if desired, the mounting bracket can be attached to the wall behind the artwork.

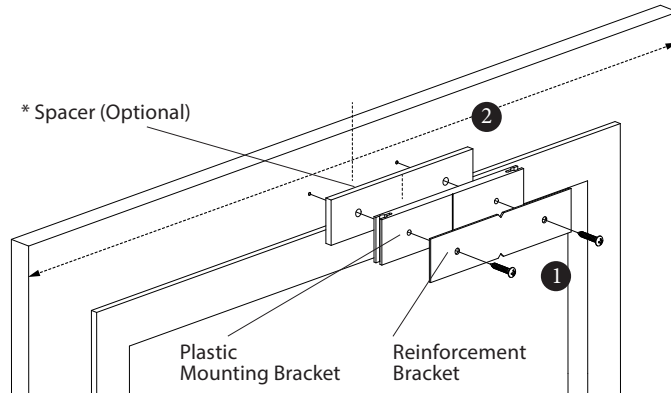

## Installing the Dimmer Switch

- 3 The included dimmer switch can be used to turn the fixture on and off, as well as dim the fixture. It can be mounted wherever you prefer, however we recommend mounting it to the back of the frame, either on the bottom as shown, or on the side.
- 4 Attach the switch using the included #6 flathead screws or adhesive patches.

Note: If you would like to use a remote dimmer or control system, see the section later in these instructions.

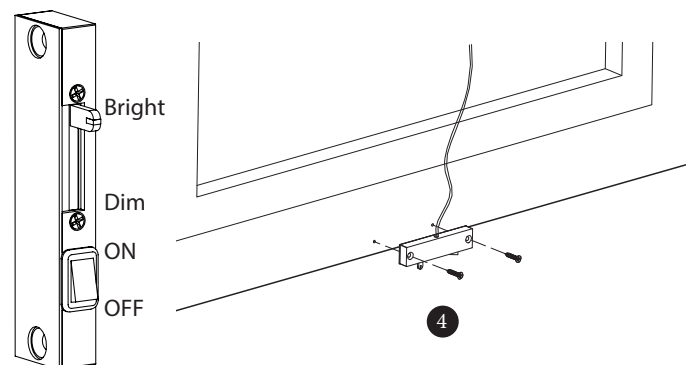
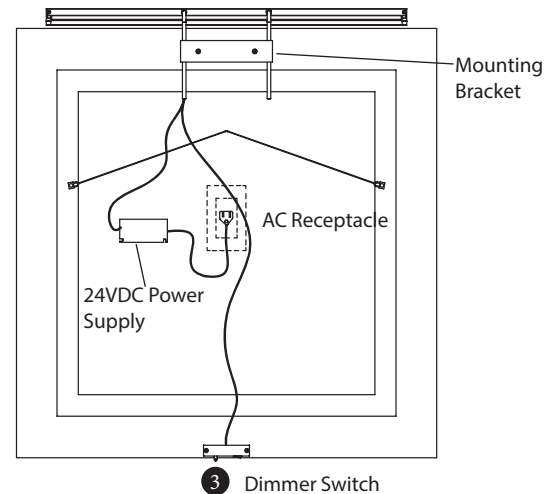

### Electrical Connections

#### 5 For Plug-In Version Only

The included plug-in power supply can be mounted to the wall behind the painting, attached to the back of the frame, or installed remotely.

#### 6 For Hardwired Version Only:

A junction box is required to place the power supply and electrical connections. A 4in square deep junction box with a 3in plaster ring is recommended. Use wire nuts to make the connections between the unswitched line voltage wires and the power supply. Use wire nuts or the provided low voltage connectors to make the electrical connections between the low voltage output wires and the fixture leads.

The Revelite AL can be controlled by connecting the purple and grey wires to a dimmer or control system that uses the industry standard 0-10V dimming interface. More than one Revelite AL fixture can be attached to the same dimmer. Dimmers should be installed by a licensed electrician and in accordance with the manufacturer's instructions.

#### 5 Plug-In Version

PLUG-IN  
Standard Mount Only

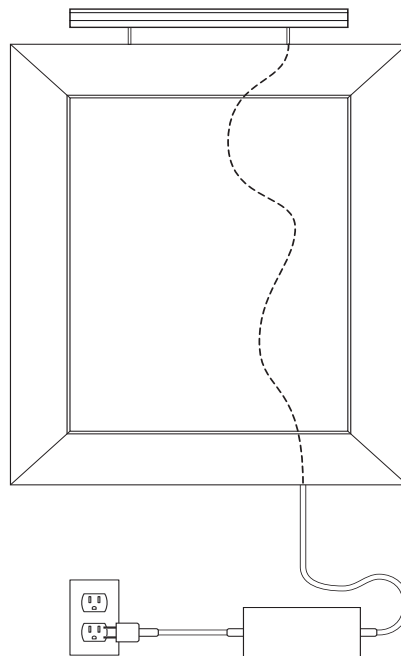
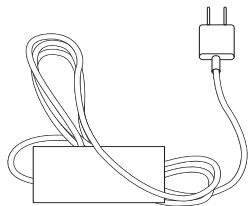

#### 6 Hardwired Version

HARDWIRE  
Standard or Direct Wire Mount

j-box by  
others

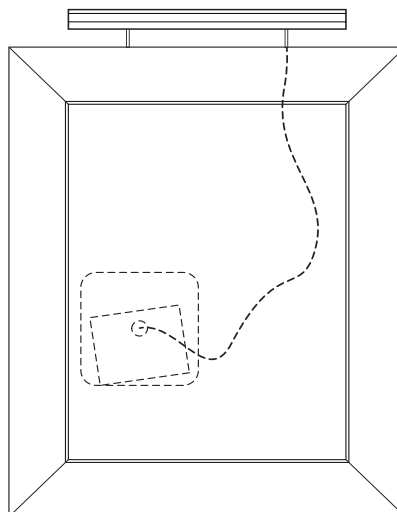
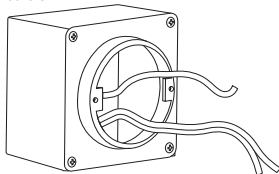

### WARNING

CONNECTING THE FIXTURE DIRECTLY TO LINE VOLTAGE WILL DESTROY IT AND VOID THE WARRANTY!

MAKE SURE THAT THE RED WIRE IS CONNECTED TO THE POSITIVE (+) LEAD ON THE POWER SUPPLY, AND THE BLACK WIRE IS CONNECTED TO THE NEGATIVE (-) or GROUND LEAD ON THE POWER SUPPLY.

### 6 Hardwired Version Continued

#### Hardwire Wiring Diagram Using a Remote 0-10V Dimmer Switch or Control System

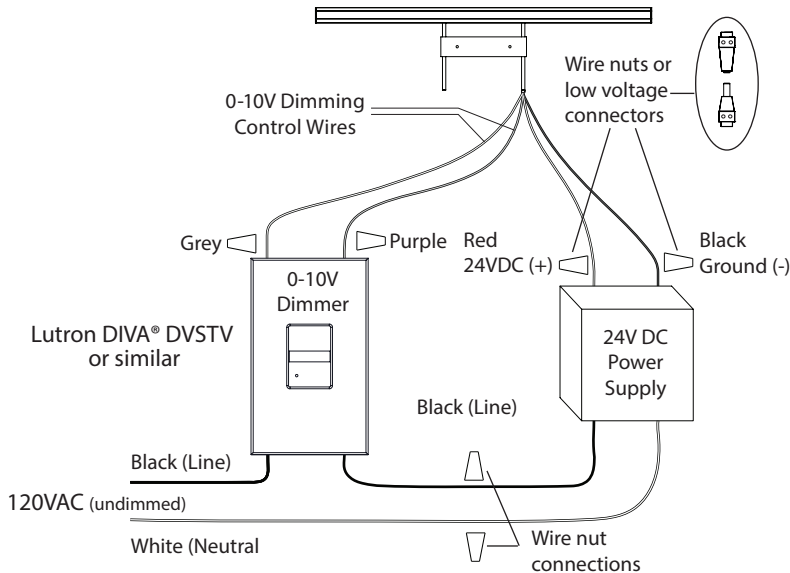

#### Hardwire Wiring Diagram Using the Included Dimmer Switch

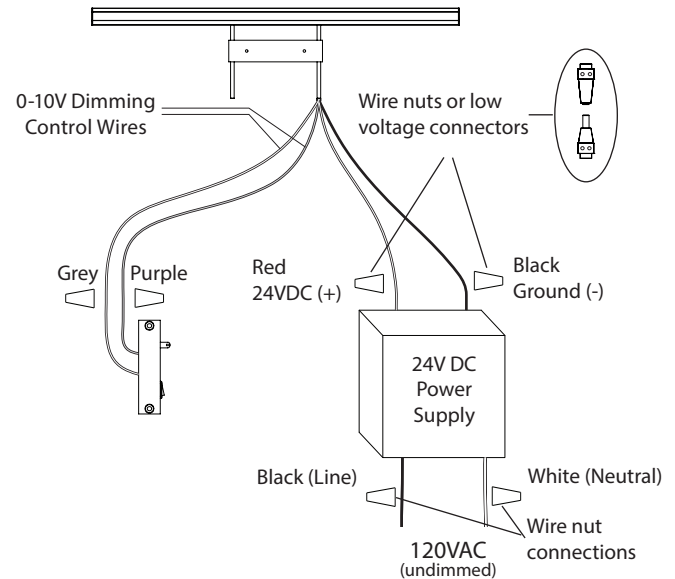

### CRITICAL NOTE

CONNECTING THE FIXTURE DIRECTLY TO LINE VOLTAGE WILL DESTROY IT AND VOID THE WARRANTY! REVERSING THE POLARITY WILL DAMAGE THE FIXTURE AND VOID THE WARRANTY!

THIS FIXTURE IS ONLY COMPATIBLE WITH 0-10V LOW VOLTAGE DIMMERS. DIMMING CONTROL CANNOT BE ACHIEVED USING TRIAC, ELV, OR OTHER PHASE-DIMMING METHODS.

MAKE SURE THAT THE RED WIRE IS CONNECTED TO THE POSITIVE (+) LEAD ON THE POWER SUPPLY, AND THE BLACK WIRE IS CONNECTED TO THE NEGATIVE (-) or GROUND LEAD ON THE POWER SUPPLY.

### Dimming Configurations

The Revelite AL can be dimmed only by using the violet and grey 0-10V leads that exit the fixture. Dimming control cannot be achieved using TRIAC, ELV, or other phase-dimming methods. The methods listed below for dimming the Revelite through the 0-10V leads are all recommended but are not entirely comprehensive; however, please use caution when experimenting with other methods of 0-10V control.

#### 1) Using the Included Dimmer Switch

The included dimmer switch can be used to turn the fixture on and off, as well as dim the fixture. It can be mounted wherever you prefer, however we recommend mounting it to the back of the frame, either on the bottom as shown, or on the side.

Refer to steps 3 and 4, from earlier in these instructions if you would like to using the included dimmer switch.

#### 2) Using a Compatible 0-10V Wall Dimmer

Many companies offer 0-10V compatible wall dimmers that preserve the same aesthetic as traditional wall dimmers. It is the installer's responsibility to ensure that the wall dimmer chosen is compatible and to follow the installation instructions included with that system correctly.

It is not possible to achieve dimming control through the use of a TRIAC, ELV, or phase-dimming wall dimmer.

#### 3) Using a Compatible Control System

Many home and commercial lighting control systems are available that are compatible with 0-10V dimmable fixtures. Incorporating the Revelite AL fixture with older systems that were not originally compatible with 0-10V fixtures may be possible through the use of ten volt interfaces that can read a phase-dimmed input and produce a 0-10V output. Please inquire with the manufacturer of a control system before attempting to interface it with the Revelite AL fixture.

### Installing Fixture to the Mounting Bracket

- 7 Attach the fixture to the mounting bracket by sliding the arms vertically into the mounting bracket. Do not snap the mounting arms into sides!
- 8 Adjust the height of the fixture and level it by sliding the mounting arms up or down in the slots in the mounting bracket. The bottom of the fixture should be about 4 inches above the top edge of the canvas.

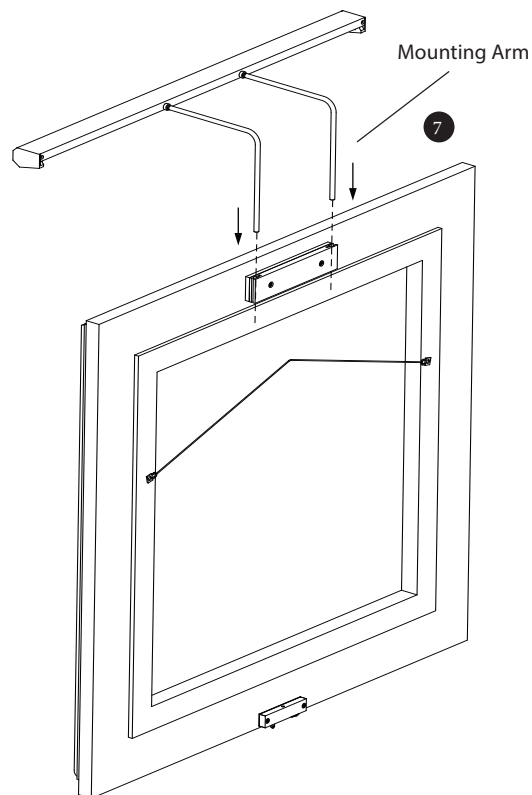
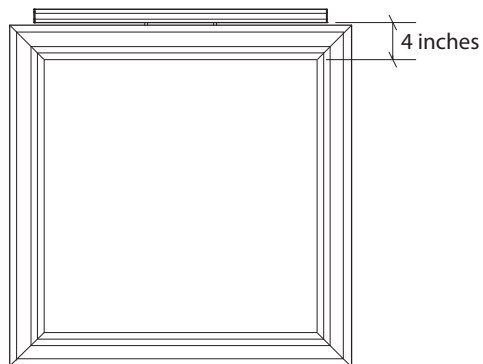

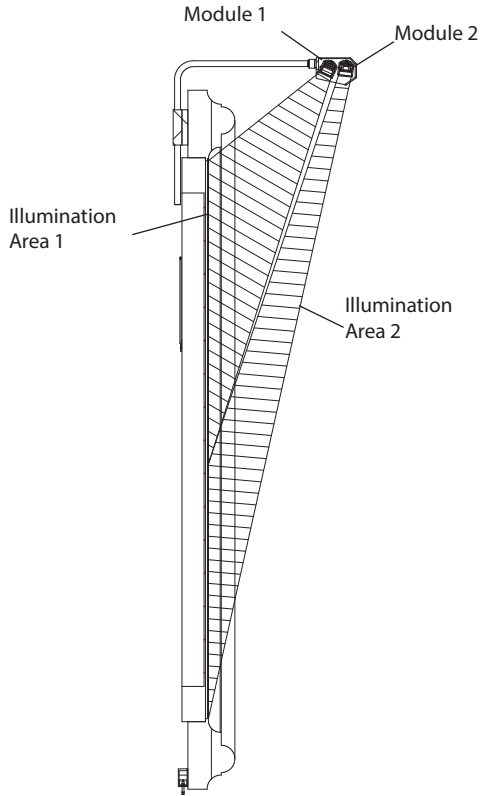

### Adjusting the Light Output

Every Revelite AL is custom tuned to illuminate the size of the canvas specified at the time of purchase. The following adjustments should not need to be made unless the fixture is moved to a different size canvas, or you would like to further tune the light output once it is mounted to the actual piece of art.

The Revelite AL consists of independently tilt-able and aim-able rows of LEDs, or “modules”. The Revelite AL1 has one module, and the Revelite AL2 has two. Module 1 is closest to the artwork and illuminates the upper area of the canvas, Module 2 is farther away from the artwork and illuminates the lower area of the canvas.

- 9 The brightness of each module is adjusted by turning the small phillips head screw located at the right side of the fixture when you are facing it. The screw should turn with very little resistance. Using too much force may damage delicate electronic components. Once the brightness has been adjusted for each module, the brightness balance between the two modules will stay the same when the fixture is dimmed using the included dimmer or a remote dimmer.
- 10 To tilt, or aim each module, loosen the locking screws at each end of the module, tilt the module to the desired position, and then tighten the locking screws.

A #1 phillips screwdriver and a 5/64” allen key have been included in the hardware kit.

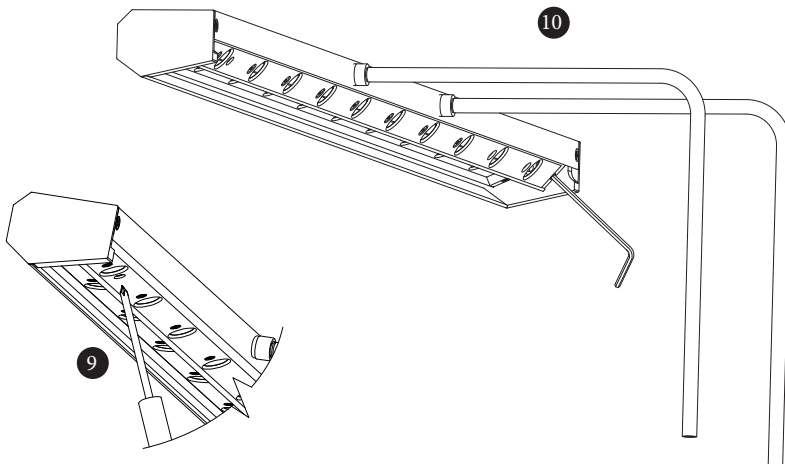
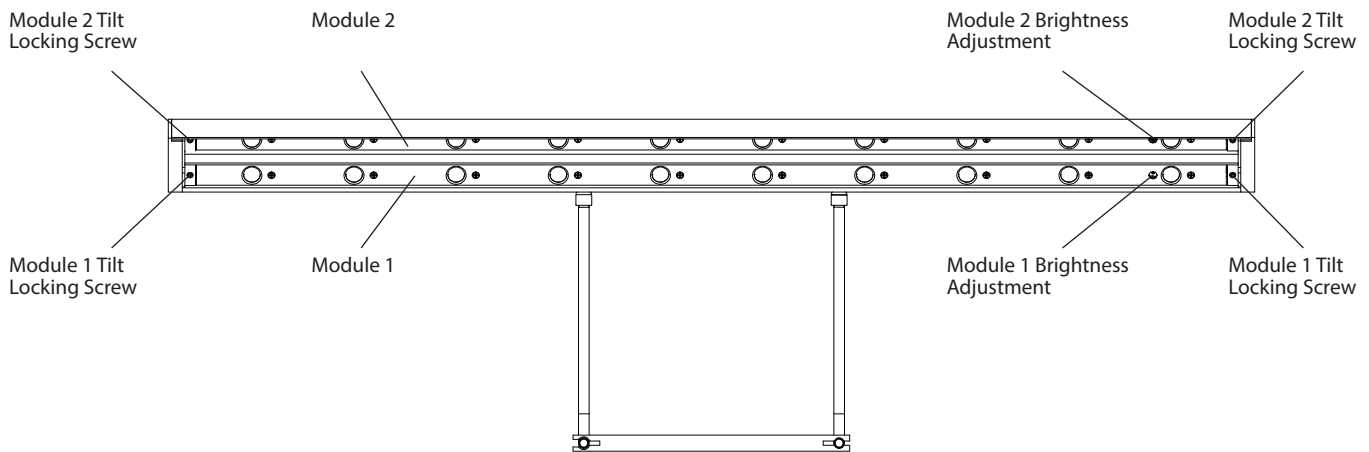

### Recommended Adjustment Procedure

The following procedure is recommended for adjusting your Revelite AL:

1. Turn the brightness of module 1 all the way down and the brightness of module 2 all the way up.
2. Adjust the tilt of module 2 until it covers the bottom two thirds of the canvas.
3. Turn the brightness up on module 1 and adjust the tilt until the top of the canvas is illuminated. Fine tune the brightness of module 1 until vertical uniformity is achieved.
4. Adjust the overall brightness using the dimmer switch.