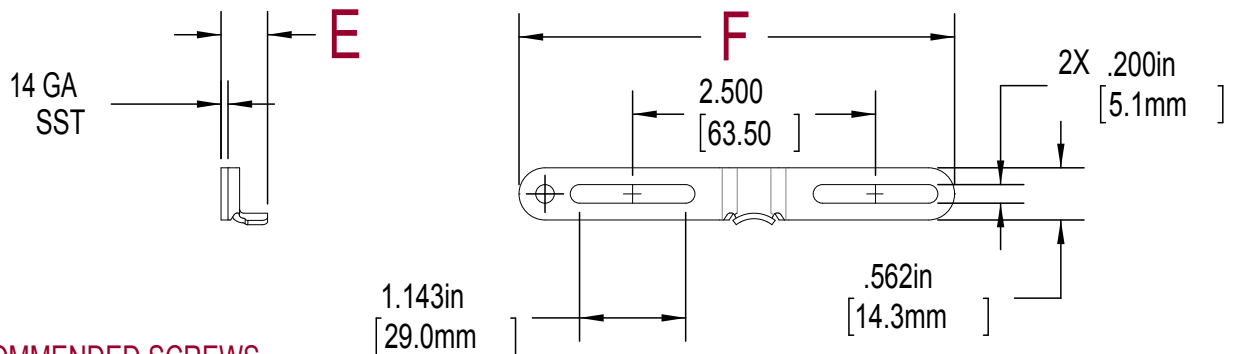

FIG. 9 KEEPERS 21087, 21088, 21089 AND 21325



RECOMMENDED SCREWS

WOOD, PVC, METAL - 2 #10 PHILIPS PAN HEAD SST SCREWS.
LENGTH AND THREAD TYPE DETERMINED BY PROFILE.

KEEPER NUMBER	E	F
21087	.375 [9.5mm]	4.735 [120.3mm]
21088	.500 [12.7mm]	4.647 [118.0mm]
21089	.562 [14.3mm]	4.593 [116.7mm]
21325	.688 [17.5mm]	4.647 [118.0mm]

FIG. 10 KEEPER 20800

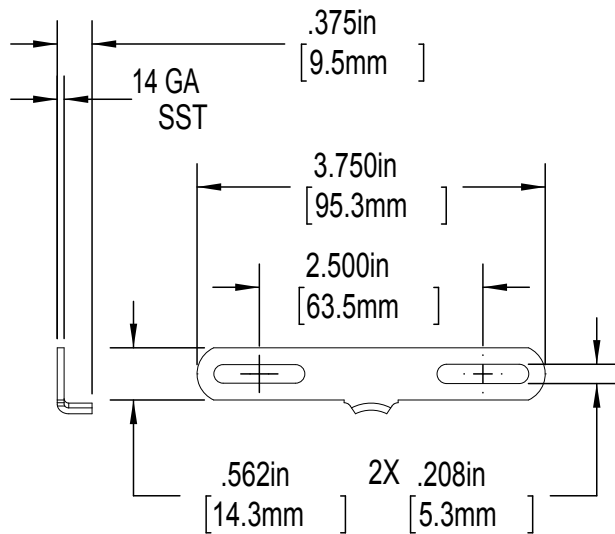

RECOMMENDED SCREWS

WOOD, PVC, METAL - 2 #10 PHILIPS PAN HEAD SST SCREWS. LENGTH AND THREAD TYPE DETERMINED BY PROFILE.

FIG. 11 KEEPERS 31376 AND 31384 (with positive pick-up tab)

NOTE; CANNOT BE USED IN TIEBAR APPLICATIONS.

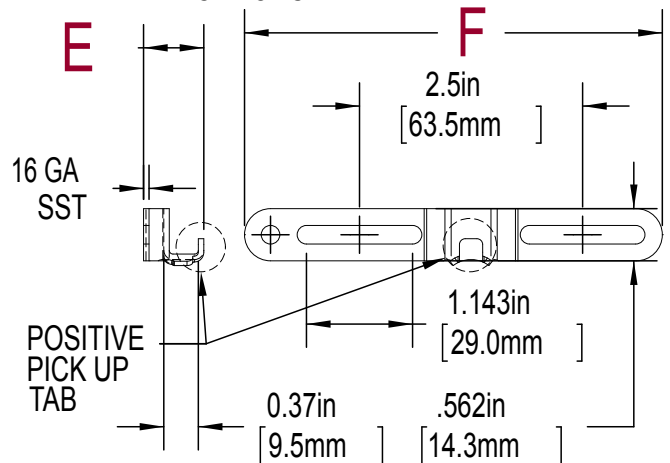

KEEPER NO.	E	F
31376	.590 [15.0mm]	4.593[116.7mm]
31384	.373 [9.5mm]	4.735[120.3mm]

RECOMMENDED SCREWS

WOOD, PVC, METAL - 2 #10 PHILIPS PAN HEAD SST SCREWS. LENGTH AND THREAD TYPE DETERMINED BY PROFILE.