

Mk5 Vent Gauge Assembly – P3cars.com

Updated 12-27-2010

Refer to the “Car Installation” instructions for removing your vent from the car.

WARNING – Do this assembly in a warm area with lots of light, allow parts to warm up to room temperature or the vent plastic will be brittle.

STEP 1: Prepare the vent. Using a flathead screwdriver, unclip the vent face starting with the bottom clips. You may need to rotate the open/close dial to gain access to the lower clips. Press down and forward to slide the bottom clips out.

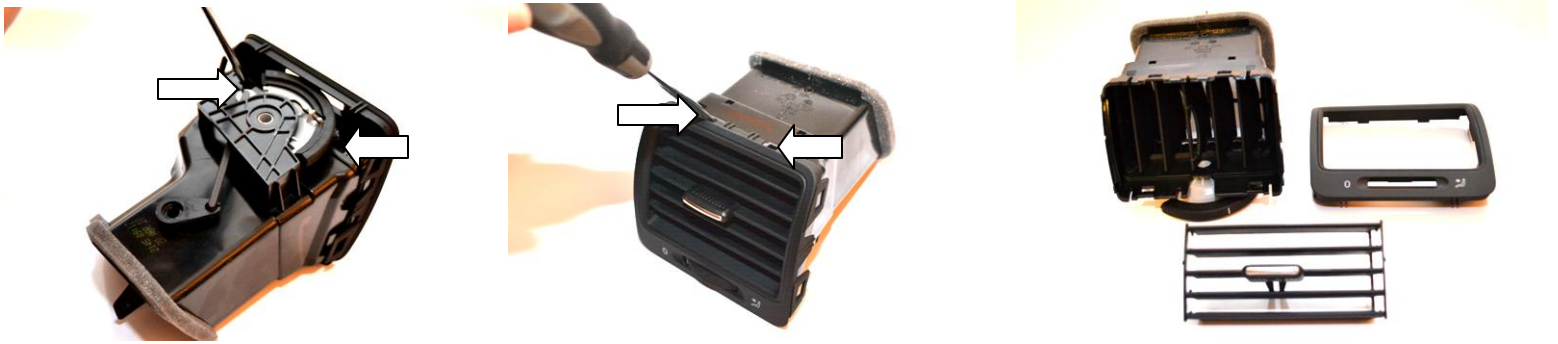

STEP 2: Prepare the slats and glass. Carefully remove the 2 bottom slats and set them aside. Then of the remaining 3 slats swap the bottom and middle of the 3 slats so that the controller is now in the middle as shown. Remove the adhesive backing from the glass back.



STEP 3: Insert the slats assembly into the vent, lining up the tabs and slat controller, it will fit snugly. Feed the wire through as shown, you may need to kink the wire at a 90 degree angle to keep the wire in place. Line up the glass onto the vent, press to adhere it to the front of the vent frame as shown. After you verify the gauge is fitted as shown, slide on the front of the vent until all 4 clips click into place.

