





WELDING RESPIRATOR

RPB® Z4 (Pg. 1 of 2)

#	DESCRIPTION	PART #
	RPB® Z4® WELDING RESPIRATOR W/ ZYTEC FIRE-RATED FACE SEAL, BREATHING TUBE, PX5 AIR PAPR AND FIRE-RATED BELT.	15-018-11-FR
	RPB® Z4® WELDING RESPIRATOR W/ FIRE-RATED SHOULDER CAPE, BREATHING TUBE, PX5 AIR PAPR AND FIRE-RATED BELT	15-018-21-FR
	RPB® Z4® RESPIRATOR W/ ADF LENS, FIRE-RATED SHOULDER CAPE, DOES NOT INCLUDE BREATHING TUBE	15-010-21
	RPB® Z4® RESPIRATOR W/ ADF LENS, FIRE-RATED FACE SEAL, DOES NOT INCLUDE BREATHING TUBE	15-010-11
1	WELDING IMPACT LENS, Z-LINK+®, Z4®	16-872
2	WELDING ADF (AUTO-DARKEN FILTER) REAR LENS (PK10), Z-LINK+®, Z4®	16-873
3	RPB® Z4® SAFETY LENS (10 PACK)	15-878
4	Z-LINK+®, Z4® ADF (AUTO-DARKEN FILTER) LENS	16-871
5	Z-LINK+®, Z4® WELD LENS RETAINER	16-672
6	Z-LINK+®, Z4® MAGNIFYING LENS HOLDER	16-875
7.1	1.0 MAGNIFYING LENS, ULTRA, Z3, Z4® & Z-LINK®	13-072-1
7.2	1.5 MAGNIFYING LENS, ULTRA, Z3, Z4® & Z-LINK®	13-072-1.5
7.3	2.0 MAGNIFYING LENS, ULTRA, Z3, Z4® & Z-LINK®	13-072-2
7.4	2.5 MAGNIFYING LENS, ULTRA, Z3, Z4® & Z-LINK®	13-072-2.5
8.1	RPB® Z4® SIDE WINDOW BLOCKERS, SOLID GRAY (PAIR)	15-821
8.2	RPB® Z4® SIDE WINDOW SHADE IR5 (PAIR)	15-821-5
9	RPB® Z4® FIRE-RATED FACE SEAL	15-711

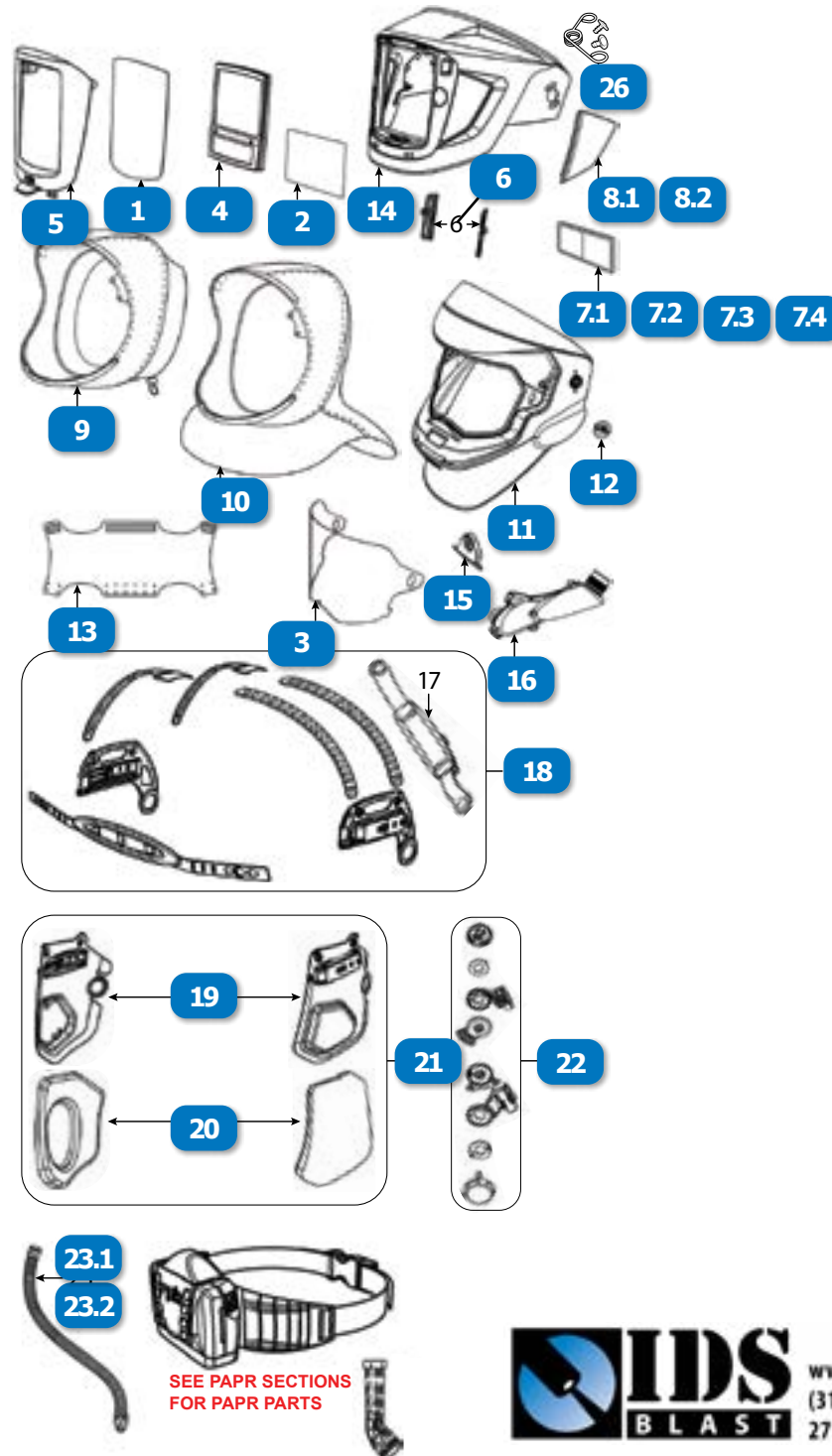

SEE PAPR SECTIONS
FOR PAPR PARTS



www.idsblast.com
(317) 545-0665 - (800) 800-0665
2717 Tobey Dr. Indianapolis, IN 46219

WELDING RESPIRATOR

RPB® Z4 (Pg. 2 of 2)

#	DESCRIPTION	PART #
10	RPB® Z4® FIRE-RATED SHOULDER CAPE	15-721
11	RPB® Z4® FACESHIELD	15-811
12	RPB® Z4® SAFETY LENS BAYONET (PAIR)	15-832
13	LINK® SYSTEM & T200 - HEAD HARNESS BROW PAD	16-526
14	RPB® Z4® WELD VISOR ASSEMBLY W/ ADF RETAINER AND PAIR OF SIDE WINDOW BLOCKERS, SOLID GRAY	15-812
15	RPB® Z4® FRONT CAPE CLIP COVER	15-831
16	RPB® Z4® AIR INTAKE ASSEMBLY WITH SCREWS	15-851
18	RPB® Z4® HEAD HARNESS ASSEMBLY W/ RATCHET ASSEMBLY AND COMFORT SIDE PADDING SYSTEM	15-840
19	RPB® Z4® SIDE PAD MOUNTS (PAIR)	15-148
20	LINK® SYSTEM, SIDE PADDING SYSTEM, 1 PAIR, PADS ONLY, ACCOMMODATES COMMS-LINK™ SYSTEM	16-528
21	RPB® Z4® COMFORT SIDE PADDING SYSTEM	15-848
22	RPB® Z4® HEAD HARNESS BRACKET AND ADJUSTMENT SYSTEM	15-830
23.1	LINK® SYSTEM, BREATHING TUBE, NEW STYLE (RPB PN 04-837A)	04-835
23.2	RPB® Z4® FIRE-RATED BREATHING TUBE HOSE COVER (DOES NOT INCLUDE THE BREATHING TUBE)	04-854
26	RPB® Z4® WELDING VISOR SPRINGS AND SCREWS	15-822

