

# Z-LINK

RPB® (Pg. 1 of 3, See Next Page For Parts Table)

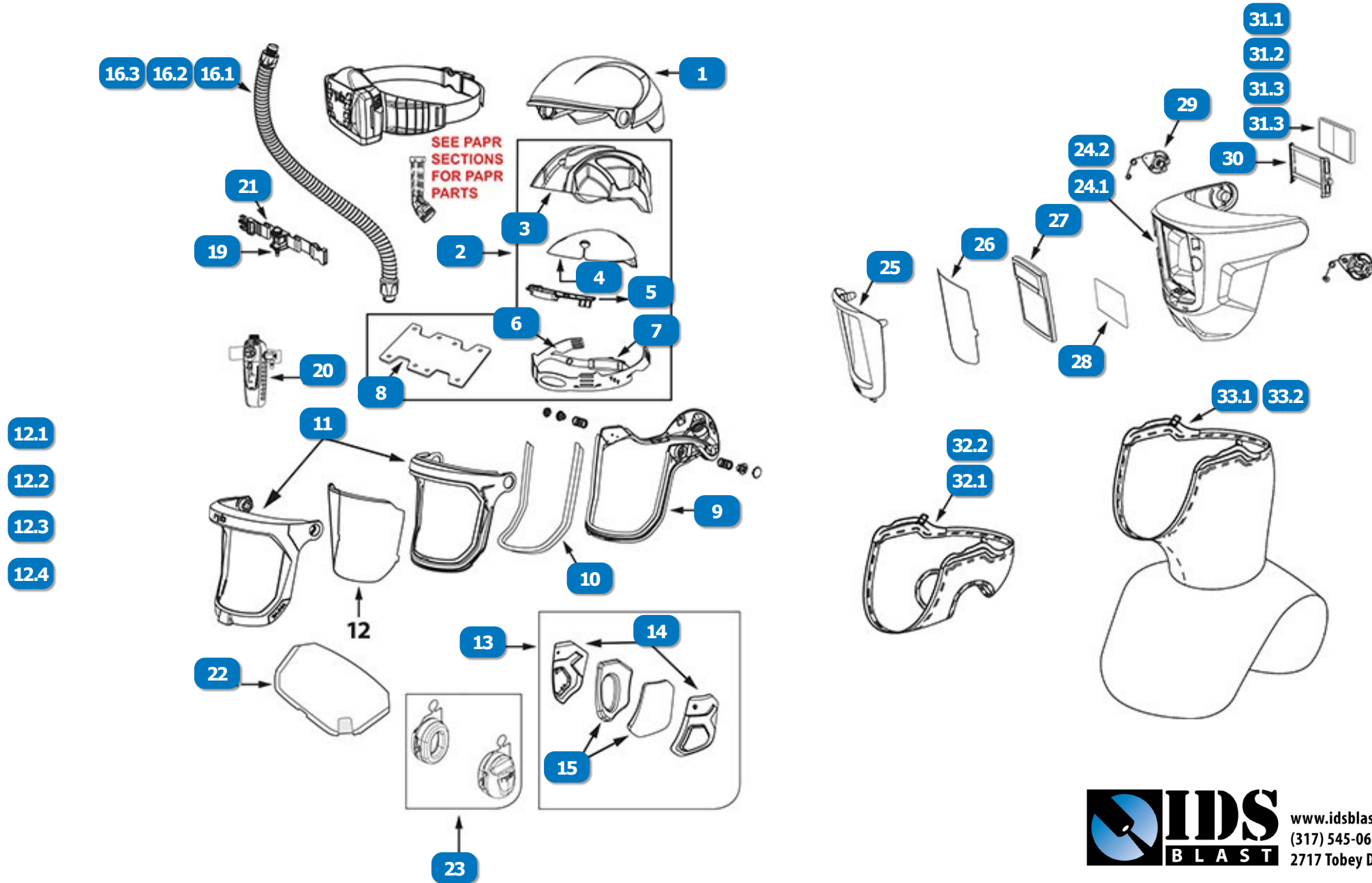







www.idsblast.com  
(317) 545-0665 • (800) 800-0665  
2717 Tobey Dr. Indianapolis, IN 46219

# Z-LINK

## RPB® (Pg. 2 of 3)

#	DESCRIPTION	PART #
	RPB® Z-LINK® RESPIRATOR W/ ZYTEC FIRE-RATED SHOULDER CAPE, CONSTANT FLOW VALVE, ANSI Z87+ SAFETY LENS, ANSI Z89.1 HARD HAT PROTECTION (NIOSH APPROVED NO. TC-19C-0535 TYPE C)	16-011-21
	RPB® Z-LINK® RESPIRATOR W/ ZYTEC FIRE-RATED FACE SEAL, C40 CLIMATE CONTROL DEVICE, ANSI Z87+ SAFETY LENS, ANSI Z89.1 HARD HAT PROTECTION (NIOSH APPROVED NO. TC-19C-0534 TYPE C)	16-015-11
	RPB® Z-LINK® RESPIRATOR W/ ZYTEC FIRE-RATED SHOULDER CAPE, C40 CLIMATE CONTROL DEVICE, ANSI Z87+ SAFETY LENS, ANSI Z89.1 HARD HAT PROTECTION (NIOSH APPROVED NO. TC-19C-0535 TYPE C)	16-015-21
	RPB® Z-LINK® RESPIRATOR W/ ZYTEC FIRE-RATED FACE SEAL, PX5 AIR PAPR BELT MOUNTED POWERED RESPIRATOR & HIGH EFFICIENCY HEPA FILTER, ANSI Z87+ SAFETY LENS, ANSI Z89.1 HARD HAT PROTECTION. NOT FOR USE IN WET PAINTING APPLICATIONS. (NIOSH APPROVAL NO. TC -21C- 1123 TYPE C)	16-018-11-FR
	RPB® Z-LINK® RESPIRATOR W/ ZYTEC FIRE-RATED SHOULDER CAPE, PX5 AIR PAPR BELT MOUNTED POWERED RESPIRATOR & HIGH EFFICIENCY HEPA FILTER, ANSI Z87+ SAFETY LENS, ANSI Z89.1 HARD HAT PROTECTION. NOT FOR USE IN WET PAINTING APPLICATIONS. (NIOSH APPROVAL NO. TC -21C- 1124 TYPE C)	16-018-21-FR
	RPB® Z-LINK®+ RESPIRATOR W/ ZYTEC FIRE-RATED FACE SEAL, WELD VISOR W/ AUTO-DARKEN FILTER, C40 CLIMATE CONTROL DEVICE, ANSI Z87+ SAFETY LENS, ANSI Z89.1 HARD HAT PROTECTION (NIOSH APPROVED NO. TC-19C-0534 TYPE C)	16-075-11
	RPB® Z-LINK®+ RESPIRATOR W/ ZYTEC FIRE-RATED SHOULDER CAPE, WELD VISOR W/ AUTO-DARKEN FILTER, C40 CLIMATE CONTROL DEVICE, ANSI Z87+ SAFETY LENS, ANSI Z89.1 HARD HAT PROTECTION (NIOSH APPROVED NO. TC-19C-0535 TYPE C)	16-075-21
	RPB® Z-LINK®+ RESPIRATOR W/ ZYTEC FIRE-RATED FACE SEAL, WELD VISOR W/ AUTO-DARKEN FILTER, PX5 AIR PAPR BELT MOUNTED POWERED RESPIRATOR & HIGH EFFICIENCY HEPA FILTER, ANSI Z87+ SAFETY LENS, ANSI Z89.1 HARD HAT PROTECTION. NOT FOR USE IN WET PAINTING APPLICATIONS. (NIOSH APPROVED NO. TC -21C- 1123 TYPE C)	16-078-11-FR
	RPB® Z-LINK®+ RESPIRATOR W/ ZYTEC FIRE-RATED SHOULDER CAPE, WELD VISOR W/ AUTO-DARKEN FILTER, PX5 AIR PAPR BELT MOUNTED POWERED RESPIRATOR & HIGH EFFICIENCY HEPA FILTER, ANSI Z87+ SAFETY LENS, ANSI Z89.1 HARD HAT PROTECTION. NOT FOR USE IN WET PAINTING APPLICATIONS. (NIOSH APPROVED NO. TC -21C- 1124 TYPE C)	16-078-21-FR
	RPB® Z-LINK® RESPIRATOR W/ FACE SEAL TYCHEM QC, CONSTANT FLOW VALVE, ANSI Z87+ SAFETY LENS, ANSI Z89.1 HARD HAT PROTECTION (NIOSH APPROVAL NO. TC-19C-0534 TYPE C)	16-011-12
	RPB® Z-LINK® RESPIRATOR W/ TYCHEM SL SHOULDER CAPE, CONSTANT FLOW VALVE, ANSI Z87+ SAFETY LENS, ANSI Z89.1 HARD HAT PROTECTION (NIOSH APPROVED NO. TC-19C-0535 TYPE C)	16-011-23

#	DESCRIPTION	PART #
	RPB® Z-LINK® RESPIRATOR W/ TYCHEM QC FACE SEAL, C40 CLIMATE CONTROL DEVICE, ANSI Z87+ SAFETY LENS, ANSI Z89.1 HARD HAT PROTECTION (NIOSH APPROVED NO. TC-19C-0534 TYPE C)	16-015-12
	RPB® Z-LINK® RESPIRATOR W/ TYCHEM SL SHOULDER CAPE, C40 CLIMATE CONTROL DEVICE, ANSI Z87+ SAFETY LENS, ANSI Z89.1 HARD HAT PROTECTION (NIOSH APPROVED NO. TC-19C-0535 TYPE C)	16-015-23
	RPB® Z-LINK® RESPIRATOR W/ TYCHEM QC FACE SEAL, PX5 AIR PAPR BELT MOUNTED POWERED RESPIRATOR & HIGH EFFICIENCY HEPA FILTER, ANSI Z87+ SAFETY LENS, ANSI Z89.1 HARD HAT PROTECTION. NOT FOR USE IN WET PAINTING APPLICATIONS. (NIOSH APPROVAL NO. TN 21C-1121 TYPE C)	16-018-12
	RPB® Z-LINK® RESPIRATOR W/ TYCHEM SL SHOULDER CAPE, PX5 AIR PAPR BELT MOUNTED POWERED RESPIRATOR & HIGH EFFICIENCY HEPA FILTER, ANSI Z87+ SAFETY LENS, ANSI Z89.1 HARD HAT PROTECTION. NOT FOR USE IN WET PAINTING APPLICATIONS. (NIOSH APPROVAL NO. TN 21C-1122 TYPE C)	16-018-23
	RPB® 25' BREATHING AIR SUPPLY HOSE, 3/8" ID, 1/4" QUICK RELEASE FITTINGS	NV-2028
	RPB® 50' BREATHING AIR SUPPLY HOSE, 3/8" ID, 1/4" QUICK RELEASE FITTINGS	NV-2029
<b>1</b>	T-LINK® HARD HAT ASSEMBLY, INCLUDES JAW	17-010
<b>2</b>	LINK® COMFORT-LINK™ FIT SYSTEM	16-520-T
<b>3</b>	LINK® SYSTEM, IMPACT ABSORBER	16-521
<b>4</b>	LINK® SYSTEM, COMFORT PAD	16-522
<b>5</b>	LINK® SYSTEM, HEAD HARNESS BRACKET AND AIR DIRECTOR	16-525
<b>6</b>	LINK® SYSTEM, HEAD HARNESS ASSEMBLY	16-531
<b>7</b>	LINK® SYSTEM & T200 - HEAD HARNESS RACHET ADJUSTER ASSEMBLY	16-530
<b>8</b>	LINK® SYSTEM & T200 - HEAD HARNESS BROW PAD	16-526
<b>9</b>	LINK SYSTEM, JAW ASSEMBLY	16-514
<b>10</b>	Z-LINK® JAW SEAL	16-515
<b>11</b>	Z-LINK® VISOR	16-611

# Z-LINK

## RPB® (Pg. 3 of 3)

#	DESCRIPTION	PART #
12.1	Z-LINK® SAFETY LENS - ANTI-FOG/ANTI-SCRATCH	16-810
12.2	Z-LINK® SAFETY LENS - SMOKE TINTED - ANTI-FOG/ANTI-SCRATCH	16-810-ST
12.3	Z-LINK® SAFETY LENS - YELLOW - ANTI-FOG/ANTI-SCRATCH	16-810-YT
12.4	Z-LINK® SAFETY LENS - IR-TINTED SHADE 5 - ANTI-SCRATCH	16-810-IR5
13	LINK® SYSTEM, SIDE PADDING SYSTEM	16-520-S
14	LINK® SYSTEM, SIDE PADDING SYSTEM, FRAMES ONLY	16-527
15	LINK® SYSTEM, SIDE PADDING SYSTEM, 1 PAIR, PADS ONLY, ACCOMMODATES COMMS-LINK™ SYSTEM	16-528
16.1	LINK® SYSTEM, BREATHING TUBE, NEW STYLE (RPB PN 04-837A), FOR PX4 AIR PAPP, INCLUDES ADAPTOR TO CONNECT NEW STYLE BREATHING TUBE TO OLD STYLE RESPIRATOR (REPLACES RPB PN 04-835)	04-835
16.2	LINK® SYSTEM, BREATHING TUBE, NEW STYLE (RPB PN 04-833A), FOR SUPPLIED AIR, INCLUDES ADAPTOR TO CONNECT NEW STYLE BREATHING TUBE TO OLD STYLE RESPIRATOR (REPLACES RPB PN 04-830)	04-830
16.3	LINK® SYSTEM, AIR INLET ADAPTER FOR Z-LINK & T-LINK (FOR CONNECTING NEW STYLE BREATHING TUBE TO Z-LINK & T-LINK)	16-519
19	CONSTANT FLOW VALVE ASSEMBLY W/BELT	03-101
20	RPB® C40 RESPIRATOR CLIMATE CONTROL DEVICE, COOLING/HEATING, ADJUSTABLE, W/BSP THREAD & BELT	03-501
21	BELT W/BUCKLE	NV-2022
22	Z-LINK® TEAR-OFF LENSES (PACK OF 50)	16-811
23	QUIET-LINK® HELMET EARMUFFS, 25 DBA ATTENUATION, FOR T-LINK® & Z-LINK® RESPIRATOR SYSTEMS, REPLACES SIDE PADDING SYSTEM. ALSO COMPATIBLE WITH Z4® WELDING RESPIRATOR.	18-533
24.1	Z-LINK+® WELD VISOR WITHOUT LENS	16-671

#	DESCRIPTION	PART #
24.2	Z-LINK+® WELD VISOR INCLUDING ADF (AUTO-DARKEN FILTER) LENS. INCLUDES VISOR CLIPS & SPRINGS (16-673).	16-670
25	Z-LINK+®, Z4® WELD LENS RETAINER	16-672
26	WELDING IMPACT LENS, Z-LINK+®, Z4®	16-872
27	Z-LINK+®, Z4® ADF (AUTO-DARKEN FILTER) LENS	16-871
28	WELDING ADF (AUTO-DARKEN FILTER) REAR LENS (PK10), Z-LINK+®, Z4®	16-873
29	Z-LINK+® WELD VISOR ATTACHMENT CLIP AND SPRING	16-673
30	Z-LINK+®, Z4® MAGNIFYING LENS HOLDER	16-875
31.1	1.0 MAGNIFYING LENS, ULTRA, Z3, Z4® & Z-LINK®	13-072-1
31.2	1.5 MAGNIFYING LENS, ULTRA, Z3, Z4® & Z-LINK®	13-072-1.5
31.3	2.0 MAGNIFYING LENS, ULTRA, Z3, Z4® & Z-LINK®	13-072-2
31.3	2.5 MAGNIFYING LENS, ULTRA, Z3, Z4® & Z-LINK®	13-072-2.5
32.1	Z-LINK® ZYTEC® FACE SEAL	16-711
32.2	Z-LINK® TYCHEM® QC FACE SEAL	16-712
33.1	Z-LINK® ZYTEC® SHOULDER CAPE	16-721
33.2	Z-LINK® TYCHEM® SL SHOULDER CAPE	16-723



www.idsblast.com  
 (317) 545-0665 • (800) 800-0665  
 2717 Tobey Dr. Indianapolis, IN 46219