

VACUUM BLASTER WORKHEAD II

#	DESCRIPTION	PART #
1	VACUUM WORKHEAD II COMPLETE, W/2" SLEEVE, LESS NOZZLE	314.0015
2	VACUUM WORKHEAD II HANDLE BAR	314.A016
3	VACUUM WORKHEAD II HANDLE GRIP	312.D204G
4.1	VACUUM WORKHEAD II SLEEVE 2"	314.A032
4.2	VACUUM WORKHEAD II SLEEVE 4"	314.A034
5	VACUUM WORKHEAD II LOCATING RING (THREADED)	314.A020
6.1	NOZZLE, TUNGSTEN CARBIDE, LONG VENTURI, 1/4" BORE, 1" ENTRY, 1-1/4" NPSM THREAD, ALL POLY JACKET	TLVE-4AP
6.2	NOZZLE, TUNGSTEN CARBIDE, LONG VENTURI, 3/8" BORE, 1" ENTRY, 1-1/4" NPSM THREAD, ALL POLY JACKET	TLVE-6AP
7	VACUUM WORKHEAD II LOCKING RING (W/ HARDWARE)	314.A015
8	BRUSH, OUTER FLAT, VACUUM BLASTER VWII/2.5/3/RIGHT ANGLE	800070
9	HOSE, 3" x 60, BLAST & VACUUM H301	800144
10	NOZZLE HOLDER, ALUMINUM, 3/4", 150 PSI MAX (FOR USE WITH VACUUM WORKHEAD II)	314.D005

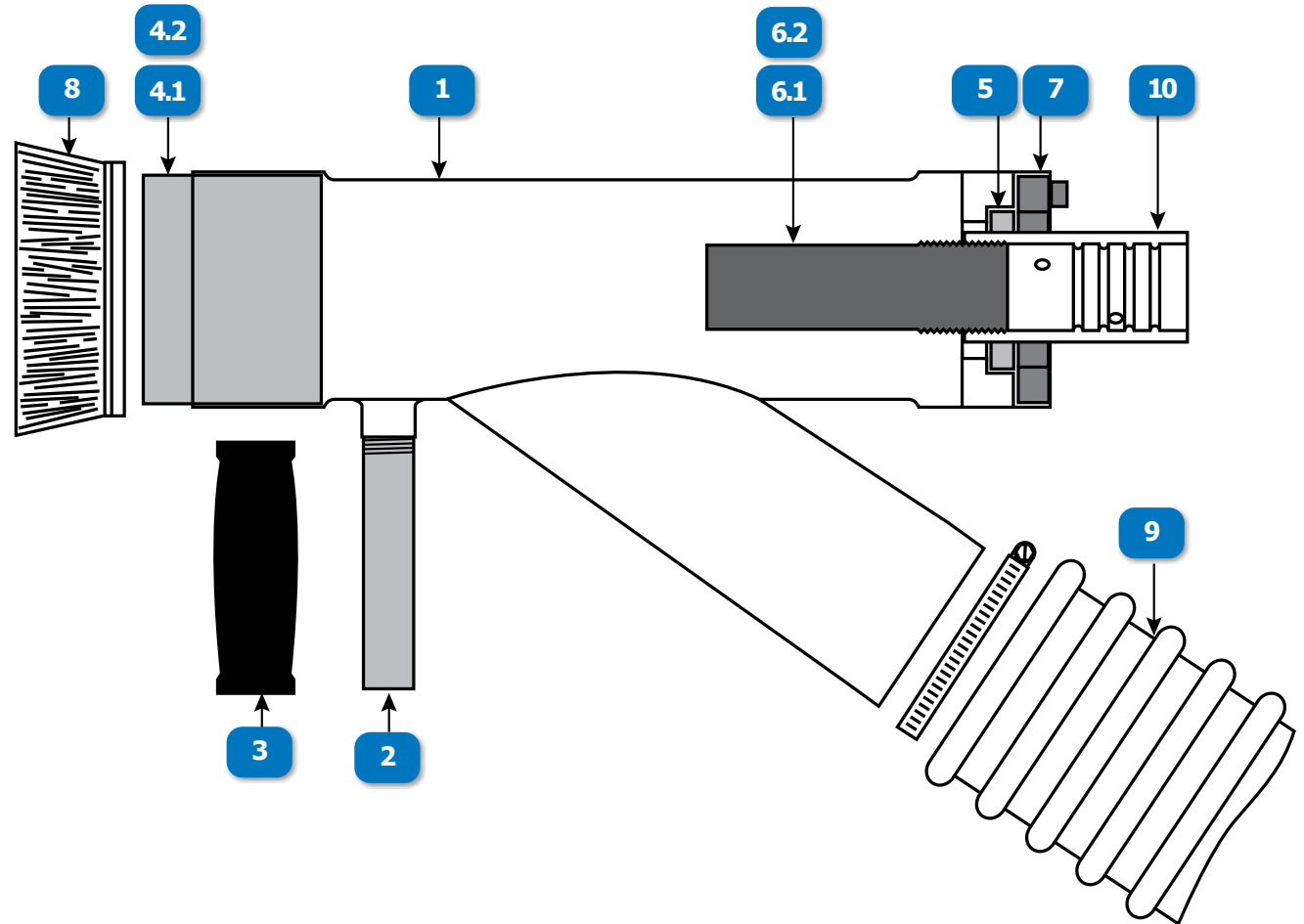

www.idsblast.com
 (317) 545-0665 - (800) 800-0665
 2717 Tobey Dr. Indianapolis, IN 46219