

TERAVALVE™ XL

#	DESCRIPTION	PART #
	TERAVALVE™ XL, COMPLETE VALVE, 3/4", TUNGSTEN CARBIDE, 1-1/4" NPT BLAST POT CONNECTION, 3/4" MALE x 3/4" MALE NPT NIPPLE (Original Equipment Mfg)	2130-005 OEM
	TERAVALVE™ XL, COMPLETE VALVE, 1", TUNGSTEN CARBIDE, 1-1/4" NPT BLAST POT CONNECTION, 1" MALE x 1-1/4" MALE NPT NIPPLE (Original Equipment Mfg)	2130-006 OEM
	TERAVALVE™ XL, COMPLETE VALVE, 1-1/4", TUNGSTEN CARBIDE, 1-1/4" NPT BLAST POT CONNECTION, 1-1/4" MALE x 1-1/4" MALE NPT NIPPLE (Original Equipment Mfg)	2130-007 OEM
	TERAVALVE™ XL, COMPLETE VALVE, 1-1/2", TUNGSTEN CARBIDE, 1-1/4" NPT BLAST POT CONNECTION, 1-1/2" MALE x 1-1/2" MALE NPT NIPPLE (Original Equipment Mfg)	2130-008 OEM
	TERAVALVE™ XL, REPLACEMENT PARTS KIT, INCLUDES #7, (2)#9, 11, 12, (3)15, 16, 17, 18 & 21 (Original Equipment Mfg)	2130-000-99 OEM
	TERAVALVE™ XL, REPLACEMENT PARTS KIT, SEALS ONLY, INCLUDES (2)#9, 11, (3)15, 17, 18 (Original Equipment Mfg)	2130-000-98 OEM
1.1	TERAVALVE™ XL, KNOB (Original Equipment Mfg)	2130-000-01 OEM
1.2	TERAVALVE™ XL, KNOB DECAL (Original Equipment Mfg)	2130-000-17 OEM
2	TERAVALVE™ XL, CAP (Original Equipment Mfg)	2130-000-02 OEM
3	HEX HEAD CAP SCREW, 1/4" x 1-1/2" LONG	110120306
4	FLAT WASHER, 1/4" SAE	888-7027-50202PB
5	VENT, 1/8"	888-2014-300PB
6	TERAVALVE™ XL, VIBRATION DISC (15 PACK) (Original Equipment Mfg)	2130-000-15 OEM
7	TERAVALVE™ XL, SPRING (Original Equipment Mfg)	2130-000-03 OEM
8	HEX NUT, 5/16" UNC	888-7017-505PB
10	TERAVALVE™ XL, DIAPHRAGM PLATE (Original Equipment Mfg)	2130-000-05 OEM

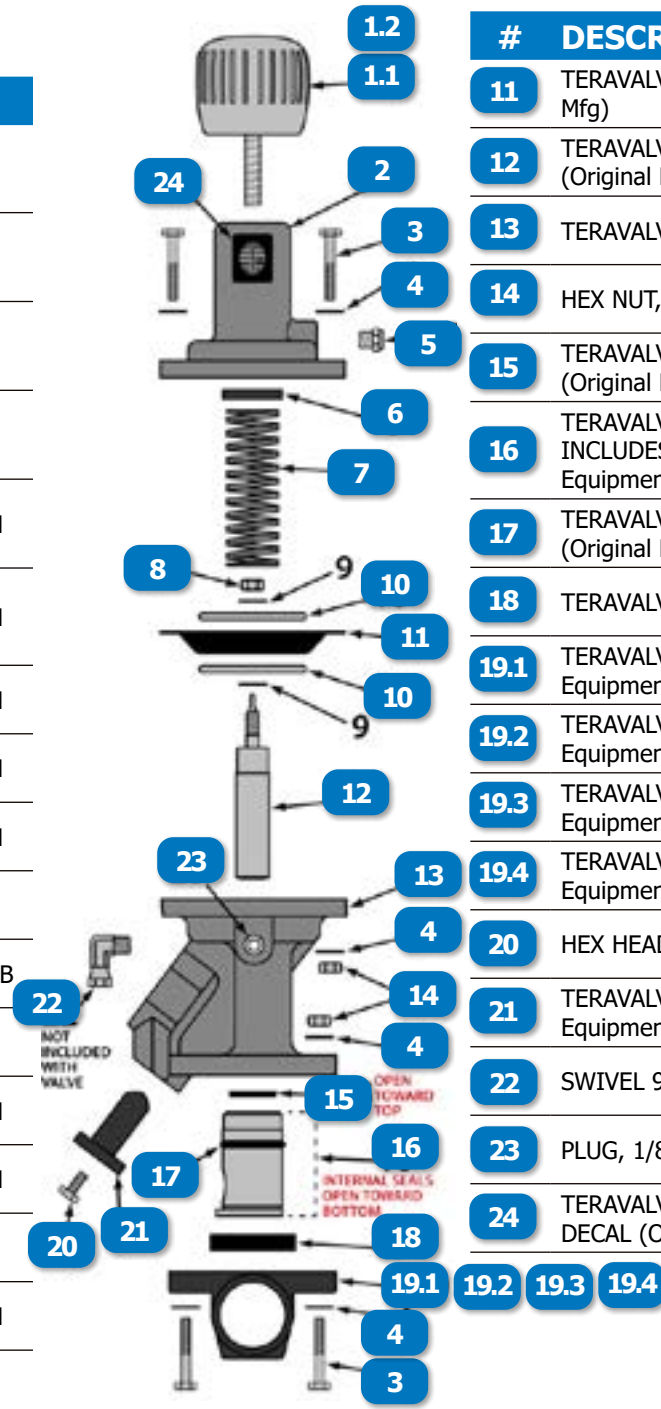

#	DESCRIPTION	PART #
11	TERAVALVE™ XL, DIAPHRAGM (Original Equipment Mfg)	2130-000-04 OEM
12	TERAVALVE™ XL, TUNGSTEN CARBIDE PLUNGER (Original Equipment Mfg)	2130-000-06 OEM
13	TERAVALVE™ XL, BODY (Original Equipment Mfg)	2130-000-11 OEM
14	HEX NUT, 1/4" UNC	1136102
15	TERAVALVE™ XL, PLUNGER SEAL (10 PACK) (Original Equipment Mfg)	2130-000-08 OEM
16	TERAVALVE™ XL, TUNGSTEN CARBIDE SLEEVE, INCLUDES O-RING & INTERNAL WIPERS (Original Equipment Mfg)	2130-000-07 OEM
17	TERAVALVE™ XL, SLEEVE O-RING (10 PACK) (Original Equipment Mfg)	2130-000-09 OEM
18	TERAVALVE™ XL, SEAT (Original Equipment Mfg)	2130-000-10 OEM
19.1	TERAVALVE™ XL, BASE, 3/4" x 3/4" (Original Equipment Mfg)	2130-005-12 OEM
19.2	TERAVALVE™ XL, BASE, 1" x 1-1/4" (Original Equipment Mfg)	2130-006-12 OEM
19.3	TERAVALVE™ XL, BASE, 1-1/4" x 1-1/4" (Original Equipment Mfg)	2130-007-12 OEM
19.4	TERAVALVE™ XL, BASE, 1-1/2" x 1-1/2" (Original Equipment Mfg)	2130-008-12 OEM
20	HEX HEAD CAP SCREW, 1/4" x 1/2" LONG	110120300
21	TERAVALVE™ XL, CLEANOUT PLUG (Original Equipment Mfg)	2130-000-13 OEM
22	SWIVEL 90*, 1/8"MNPT X 1/8"F	888-4203-50000PB
23	PLUG, 1/8" (Original Equipment Mfg)	3032-100 OEM
24	TERAVALVE™ XL, VIRTUAL POSITION INDICATOR DECAL (Original Equipment Mfg)	2130-000-16 OEM