

# RECLAIMER (PRESSURE)

## EMPIRE STYLE (Pg. 1 of 3)

#	DESCRIPTION	PART #
1.1	RECLAIMER ASSEMBLY, 400 CFM	140439
1.2	RECLAIMER ASSEMBLY, 600 CFM	140440
1.3	COATING ONLY, 600 RECLAIMER, POLYURETHANE, (FACTORY INSTALLED)	525861
1.4	RECLAIMER ASSEMBLY, 900 CFM	140441
1.5	COATING ONLY, 900 RECLAIMER, POLYURETHANE (FACTORY INSTALLED)	525891
2.1	WEAR PLATE, 400 CFM RECLAIMER, (FACTORY INSTALLED)	514471
2.2	WEAR PLATE, 600 CFM RECLAIMER, (FACTORY INSTALLED)	514481
2.3	WEAR PLATE, 900 CFM RECLAIMER, (FACTORY INSTALLED)	514491
2.4	WEAR PLATE, 400 CFM RECLAIMER, (CUSTOMER INSTALLED)	514501
2.5	WEAR PLATE, 600 CFM RECLAIMER, (CUSTOMER INSTALLED)	514511
2.6	WEAR PLATE, 900 CFM RECLAIMER, (CUSTOMER INSTALLED)	514521
3.1	DOOR, RECLAIMER	760721
3.2	SCREEN, RECLAIMER, REMOVABLE, #8 MESH, 11-1/2" DIA x 2-1/8" HEIGHT (RECOMMENDED FOR 36 GRIT AND FINER ABRASIVES)	739041
3.3	SCREEN, RECLAIMER, REMOVABLE, #4 MESH, 11-1/2" DIA x 2-1/8" HEIGHT (RECOMMENDED FOR ABRASIVES LARGER THAN 36 GRIT)	739051
3.4	ROUND MAGNETIC SEPARATOR GRATE, 10" DIAMETER, 2-1/2" HEIGHT	511572
4	GASKET, DOOR, RECLAIMER	524331
5.1	GASKET, HOPPER	524371

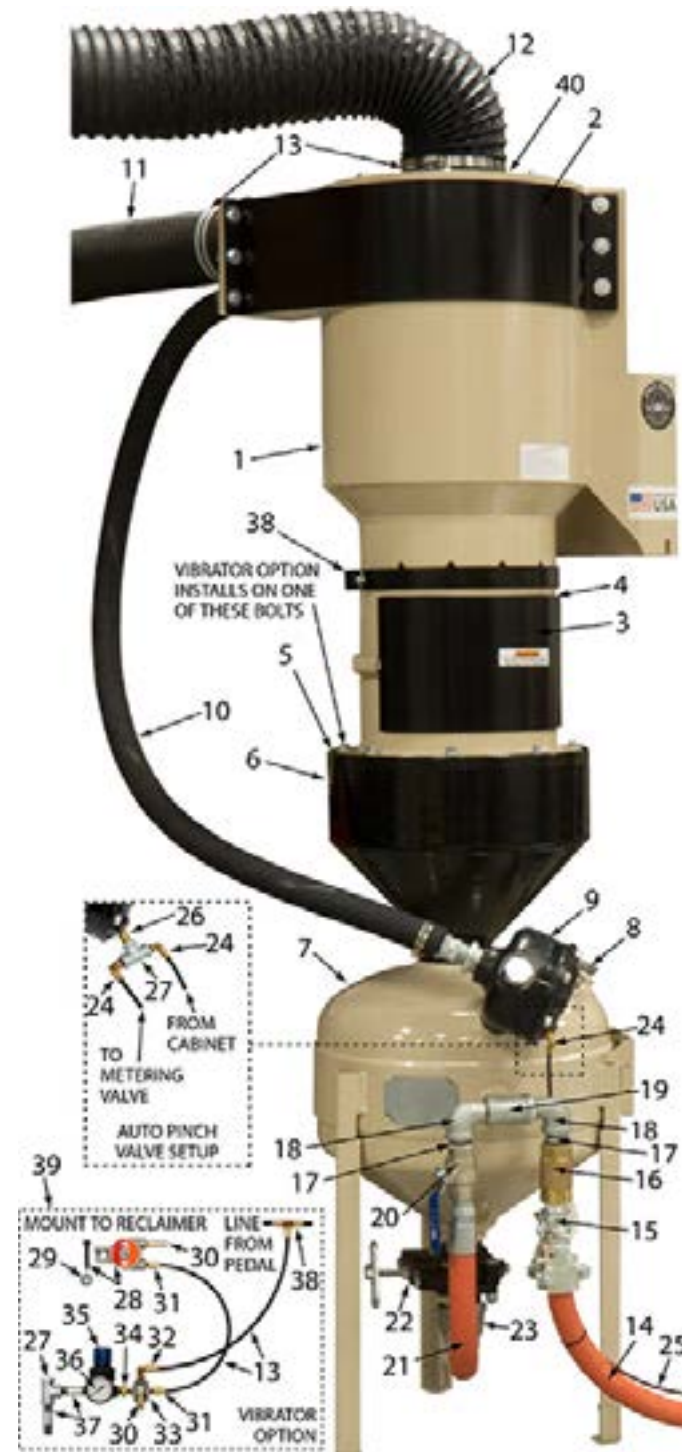

www.idsblast.com  
 (317) 545-0665 • (800) 800-0665  
 2717 Tobey Dr. Indianapolis, IN 46219

# RECLAIMER (PRESSURE)

## EMPIRE STYLE (Pg. 2 of 3)

#	DESCRIPTION	PART #
5.2	RECLAIMER SCREEN, 11 GA PERF, 5/16" HOLES, 13" DIA.	760711
5.3	FLAT WASHER, 3/8"	33008
5.4	LOCK WASHER, 3/8"	1133622
5.5	HEX BOLT, 3/8"-16 x 1 HHCS	105-3816-1
6	HOPPER, PRESSURE	760741
7.1	PRESSURE VESSEL, 1 CU. FT. (28 LITERS), (INCLUDES PLUNGER & SEALING RING)	760811
7.2	PLUNGER, SEALING, COATED	510431
7.3	RING SEALING	523942
8	SIGHT GLASS, 1-1/4" MNPT, EACH	545471
9.1	VALVE, EXHAUST, #8 (INCLUDES: X-TREME DUTY™ BALL)	290182
9.2	VALVE, EXHAUST, #8 & #2, REPAIR KIT, INCLUDES # 1, (2)2, 3, & 4 (INCLUDES: X-TREME DUTY™ BALL)	290183
9.3	VALVE BALL, X-TREME DUTY™	525322
9.4	NOZZLE, CERAMIC, STRAIGHT BORE, 5/16" BORE, 1-3/8" LENGTH, FLANGED	CL198-5
9.5	NOZZLE, BORON CARBIDE, STRAIGHT BORE, GUN INSERT, 5/16" BORE, 1-1/8" FLANGED x 1-3/8" LENGTH	502-081
10.1	HOSE, EXHAUST, FOR STANDARD 1 CU FT VESSEL (67" OAL)	522611
10.2	FITTING, BARBED, 1"	STC10
10.3	CLAMP, HOSE 2"	HS32
11.1	HOSE, CONVEYING, MEDIUM DUTY, NOMINAL 4" ID, PRICE PER FOOT, SOLD IN 10' INCREMENTS ONLY, BOX SIZE 50'	1830-20

#	DESCRIPTION	PART #
11.2	HOSE, CONVEYING, MEDIUM DUTY, NOMINAL 6" ID, PRICE PER FOOT, SOLD IN 10' INCREMENTS ONLY, BOX SIZE 50'	1830-100
11.3	HOSE, CONVEYING, HEAVY DUTY, NOMINAL 4" ID, HG 29, PRICE PER FOOT, SOLD IN 10' INCREMENTS ONLY, SECTION SIZE 100'	4 VH ARVAC
11.4	HOSE, CONVEYING, HEAVY DUTY, NOMINAL 6" ID, HG 29, PRICE PER FOOT, SOLD IN 10' INCREMENTS ONLY, SECTION SIZE 100'	6 VH ARVAC
12.1	HOSE, DUST, NOMINAL 6" ID, PRICE PER FOOT, SOLD IN 25' SECTIONS ONLY	220-006
12.2	HOSE, DUST, NOMINAL 10" ID, PRICE PER FOOT, SOLD IN 25' SECTIONS ONLY	220-010
13.1	CLAMP, HOSE 4"	HS64
13.2	CLAMP, HOSE 6"	HS96
13.3	CLAMP, HOSE 10"	HS152
13.4	CLAMP, SPIRAL, FITS 4" CONVEYING HOSE, HEAVY DUTY	400SCR
13.5	CLAMP, SPIRAL, FITS 6" CONVEYING HOSE, HEAVY DUTY	600SCR
14.1	AIR HOSE ASSEMBLY, 1" x 42" LONG, FITS 2636 EMPIRE STYLE CABINETS	140301
14.2	AIR HOSE ASSEMBLY, 1" x 5' LONG, FITS 3648, 3674 & 3696 EMPIRE STYLE CABINETS	140302
14.3	AIR HOSE ASSEMBLY, 1" x 6' LONG, FITS 3660 & 4848 EMPIRE STYLE CABINETS	140303
14.4	AIR HOSE ASSEMBLY, 1" x 7' LONG, FITS 6060 & 60120 EMPIRE STYLE CABINETS	140304
15	AIR HOSE COUPLING, 2 LUG, 1" MALE NPT	UM-100
16	VALVE, 1", BALL CHECK	517503
17	NIPPLE, TBE, GALV, 1" x CLOSED	888-3029-10699PB
18	ELBOW, STREET, 90*, GALV, 1"	888-3006-106PB
19.1	TEE, GALV, 1" x 1" x 1/2"	888-3011-10604PB

# RECLAIMER (PRESSURE)

## EMPIRE STYLE (Pg. 3 of 3)

#	DESCRIPTION	PART #
19.2	NIPPLE, TBE, SCHEDULE 80, GALV, 1/2" x CLOSED	888-3028-10499PB
20	BALL VALVE, FULL PORT, 1" NPT, CHROME PLATED BRASS W/ NYLOCK HANDLE NUT	VB100
21	PUSHER LINE KIT (FLEX) 1" x 16", OAL 20"	290-320
22.1	VALVE, PINCH, MANUAL (INCLUDES: X-TREME DUTY™ TUBE)	290383
22.2	VALVE, PINCH, AUTOMATIC (INCLUDES: X-TREME DUTY™ TUBE)	290215
22.3	TUBE, METERING, X-TREME DUTY™ , 3/4" I.D.	523592
23	TEE, GALV, 1" x 1" x 2" (FITS PRESSURE CABINETS)	545822
24	ADAPTOR, 1/4" TUBE x 1/4" MPT, 90*	520242
25	TUBING, BLACK, POLYETHYLENE, 1/4" (PER FT), SOLD IN 10' INCREMENTS ONLY	510541
26	NIPPLE, HEX 1/4" MNPT x 1/4" MNPT	888-3031-31202PB
27	TEE, GALV, 1/4"	888-3011-102PB
28	VIBRATOR, TURBINE, 1/8" NPT	517971
29	SPACER, 3/4" OD x 5/16" ID x 1/2" LG, ZINC PLATED	536359
30	DIFFUSER 1/8" SINTERED	F109-063
31	ADAPTOR, 1/4" TUBE x 1/8" MPT	520252
32	ADAPTOR, 1/4" TUBE x 1/8" MPT, 90*	520432
33	VALVE, AIR, PILOT OPERATED, 3-WAY, 1/8" NPT, NORMALLY CLOSED	519011
34	NIPPLE, HEX, 1/4" MNPT x 1/8" MNPT	888-3031-31200PB

#	DESCRIPTION	PART #
35	REGULATOR, PRESSURE, 1/4" (PANEL MOUNT)	517611
36	PRESSURE GAUGE, 1/8" NPT	04-915
37	NIPPLE, TBE, GALV, 1/4" x 2"	888-3029-10209PB
38.1	ADAPTOR, TEE, 1/4" TUBE	522991
38.2	TUNING BAND, RECLAIMER, REPLACEMENT KIT, INCLUDES HARDWARE AND GASKET	767-581-KIT
39	RECLAIMER SCREEN VIBRATOR KIT (CUSTOMER INSTALLED)	140419