

AUTOMATIC SUCTION GUN

MH3 STYLE (Pg. 1 of 2, See Next Page For Parts Table)

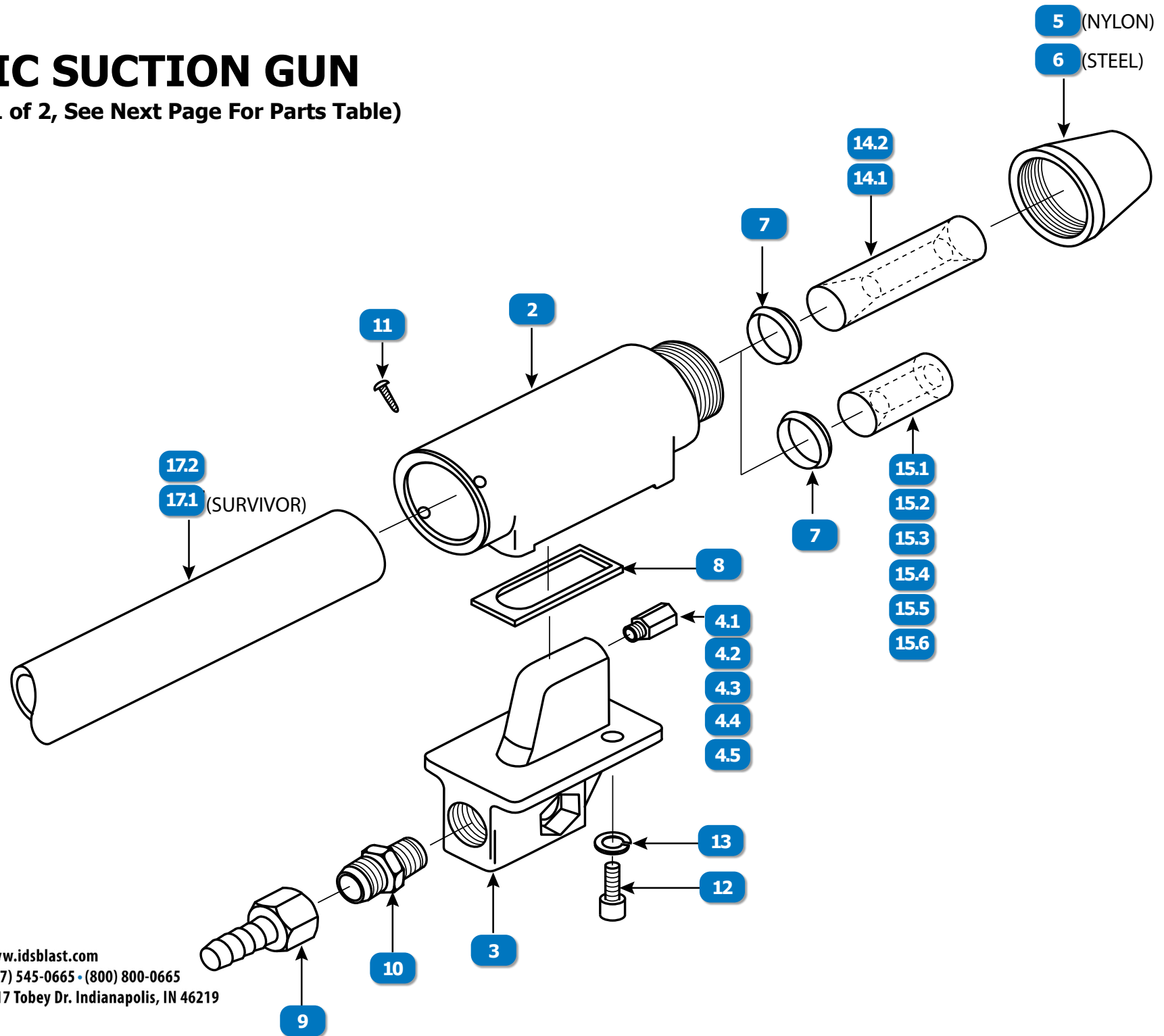

www.idsblast.com
(317) 545-0665 • (800) 800-0665
2717 Tobey Dr. Indianapolis, IN 46219

AUTOMATIC SUCTION GUN

MH3 STYLE (Pg. 2 of 2)

#	DESCRIPTION	PART #
	GUN, AUTOMATIC SUCTION, 1/4" TUNGSTEN NOZZLE, W 1/8" AIR JET	507643
	GUN, AUTOMATIC SUCTION, 5/16" TUNGSTEN NOZZLE, W 5/32" AIR JET	507653
	GUN, AUTOMATIC SUCTION, 7/16" TUNGSTEN NOZZLE, W 7/32" AIR JET	507663
	GUN, AUTOMATIC SUCTION, 1/4" BORON NOZZLE, W 1/8" AIR JET	507673
	GUN, AUTOMATIC SUCTION, 5/16" BORON NOZZLE, W 5/32" AIR JET	507683
	GUN, AUTOMATIC SUCTION, 7/16" BORON NOZZLE, W 7/32" AIR JET	507693
	GUN, AUTOMATIC SUCTION, 3/8" BORON WIDE SPRAY NOZZLE, W 3/16" AIR JET	507823
	GUN, AUTOMATIC SUCTION, 3/8" TUNGSTEN WIDE SPRAY NOZZLE, W 3/16" AIR JET	507833
	GUN, AUTOMATIC SUCTION, 3/8" BORON WIDE SPRAY NOZZLE, W/NYLON ADAPTOR, W 3/16" AIR JET	507923
	GUN, AUTOMATIC SUCTION, 3/8" TUNGSTEN WIDE SPRAY NOZZLE, W/NYLON ADAPTOR, W 3/16" AIR JET	507933
	GUN, AUTOMATIC SUCTION, 1/4" TUNGSTEN NOZZLE, W/NYLON ADAPTOR, W 1/8" AIR JET	507943
	GUN, AUTOMATIC SUCTION, 5/16" TUNGSTEN NOZZLE, W/ NYLON ADAPTOR, W 5/32" AIR JET	507953
	GUN, AUTOMATIC SUCTION, 7/16" TUNGSTEN NOZZLE, W/NYLON ADAPTOR, W 7/32" AIR JET	507963
	GUN, AUTOMATIC SUCTION, 1/4" BORON NOZZLE, W/NYLON ADAPTOR, W 1/8" AIR JET	507973
	GUN, AUTOMATIC SUCTION, 5/16" BORON NOZZLE, W/NYLON ADAPTOR, W 5/32" AIR JET	507983
	GUN, AUTOMATIC SUCTION, 7/16" BORON NOZZLE, W/NYLON ADAPTOR, W 7/32" AIR JET	507993
2	GUN BODY, AUTOMATIC SUCTION	752353
3	AIR INLET	752373

#	DESCRIPTION	PART #
4.1	AIR JET, 1/16"	752386
4.2	AIR JET, 1/8", (YELLOW)	752383
4.3	AIR JET, 5/32", (GREEN)	752393
4.4	AIR JET, 3/16", (BLUE)	505733
4.5	AIR JET 7/32", (WHITE)	752403
5	ADAPTOR, NOZZLE (NYLON)	505641
6	ADAPTOR, NOZZLE (STEEL)	504931
7	RETAINING RING, WIDE SPRAY	1424-480
8	GASKET, AUTOMATIC SUCTION GUN	523983
9	FITTING, 1/2" HOSE x 1/2", BRASS	520402
10	ADAPTOR, 1/2" HOSE x 3/8" NPT	520413
11	SCREWS 4 PCS, #8 x 5/8" LONG	554232
12	SOCKET HEAD CUP SCREW, 1/4"-20 x 5/8" LONG	553081
13	LOCK WASHER, 1/4"	552752
14.1	NOZZLE, TUNGSTEN CARBIDE, STRAIGHT BORE, WIDE SPRAY GUN INSERT, 3/8" BORE, 7/8" OD x 2-3/4" LENGTH	TL170-6
14.2	NOZZLE, BORON CARBIDE, STRAIGHT BORE, WIDE SPRAY, GUN INSERT, 3/8" BORE, 7/8" OD x 2-3/4" LENGTH	1348-600
15.1	NOZZLE, TUNGSTEN CARBIDE, STRAIGHT BORE, GUN INSERT, 1/4" BORE, 7/8" OD x 1-3/8" LENGTH	TL166-4

#	DESCRIPTION	PART #
15.2	NOZZLE, TUNGSTEN CARBIDE, STRAIGHT BORE, GUN INSERT, 5/16" BORE, 7/8" OD x 1-3/8" LENGTH	TL166-5
15.3	NOZZLE, TUNGSTEN CARBIDE, STRAIGHT BORE, GUN INSERT, 7/16" BORE, 7/8" OD x 1-3/8" LENGTH	TL166-7
15.4	NOZZLE, BORON CARBIDE, STRAIGHT BORE, GUN INSERT, 1/4" BORE, 7/8" OD x 1-3/8" LENGTH	1348-620
15.5	NOZZLE, BORON CARBIDE, STRAIGHT BORE, GUN INSERT, 5/16" BORE, 7/8" OD x 1-3/8" LENGTH	1348-630
15.6	NOZZLE, BORON CARBIDE, STRAIGHT BORE, GUN INSERT, 7/16" BORE, 7/8" OD x 1-3/8" LENGTH	1348-650
16	HOSE, AIR, RED, NOMINAL 1/2" ID x 55/64" OD, WP 200 PSI, PRICE PER FOOT, SOLD IN 10' INCREMENTS ONLY, REEL SIZE 500'	112-4580
17.1	HOSE, SUCTION, BLACK, NOMINAL 5/8" ID x 1-1/16" OD, 2 PLY, WP 150 PSI, PRICE PER FOOT, SOLD IN 10' INCREMENTS ONLY, REEL SIZE 400'	520802
17.2	SURVIVOR® HOSE, SUCTION, BLACK, NOMINAL 5/8" ID x 1-1/16" OD, 2 PLY, WP 150 PSI, PRICE PER FOOT, SOLD IN 10' INCREMENTS, REEL SIZE 400'	SUR581116 B