

HAND GUN ASSEMBLY

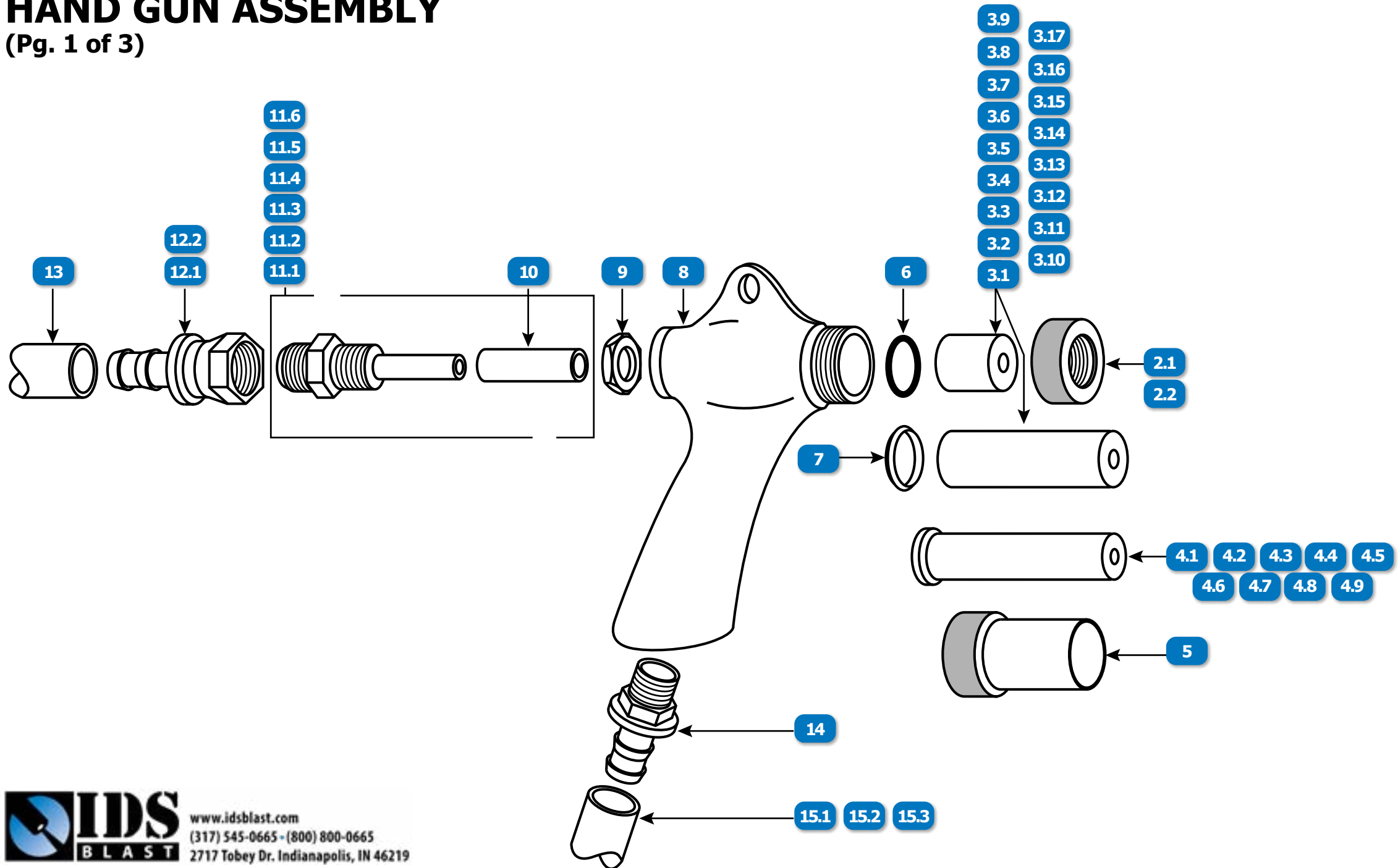





(Pg. 1 of 3)



www.idsblast.com
(317) 545-0665 - (800) 800-0665
2717 Tobey Dr. Indianapolis, IN 46219

HAND GUN ASSEMBLY

(Pg. 2 of 3)

#	DESCRIPTION	PART #
	GUN ASSEMBLY, W 3/32" ORIFICE, LESS NOZZLE	1667-800
	GUN ASSEMBLY, W 1/8" ORIFICE, LESS NOZZLE	1667-810
	GUN ASSEMBLY, W 5/32" ORIFICE, LESS NOZZLE	1667-820
	GUN ASSEMBLY, W 3/16" ORIFICE, LESS NOZZLE	1667-830
	GUN ASSEMBLY, W 7/32" ORIFICE, LESS NOZZLE	1667-840
	GUN ASSEMBLY, W 1/4" ORIFICE, LESS NOZZLE	1667-850
2.1	NUT, NOZZLE HOLDING	1347-1240
2.2	NUT, NOZZLE HOLDING, WIDE SPRAY	1347-1510
3.1	NOZZLE, CERAMIC, STRAIGHT BORE, GUN INSERT, 1/4" BORE, 7/8" OD X 1-3/8" LENGTH	CL166-4
3.2	NOZZLE, CERAMIC, STRAIGHT BORE, GUN INSERT, 5/16" BORE, 7/8" OD X 1-3/8" LENGTH	CL166-5
3.3	NOZZLE, CERAMIC, STRAIGHT BORE, GUN INSERT, 3/8" BORE, 7/8" OD X 1-3/8" LENGTH	CL166-6
3.4	NOZZLE, TUNGSTEN CARBIDE, STRAIGHT BORE, GUN INSERT, 1/4" BORE, 7/8" OD X 1-3/8" LENGTH	TL166-4
3.5	NOZZLE, TUNGSTEN CARBIDE, STRAIGHT BORE, GUN INSERT, 5/16" BORE, 7/8" OD X 1-3/8" LENGTH	TL166-5
3.6	NOZZLE, TUNGSTEN CARBIDE, STRAIGHT BORE, GUN INSERT, 3/8" BORE, 7/8" OD X 1-3/8" LENGTH	TL166-6
3.7	NOZZLE, TUNGSTEN CARBIDE, STRAIGHT BORE, GUN INSERT, 7/16" BORE, 7/8" OD X 1-3/8" LENGTH	TL166-7
3.8	NOZZLE, TUNGSTEN CARBIDE, STRAIGHT BORE, GUN INSERT, 1/2" BORE, 7/8" OD X 1-3/8" LENGTH	TL166-8
3.9	NOZZLE, BORON CARBIDE, STRAIGHT BORE, GUN INSERT, 1/4" BORE, 7/8" OD X 1-3/8" LENGTH	1348-620
3.10	NOZZLE, BORON CARBIDE, STRAIGHT BORE, GUN INSERT, 5/16" BORE, 7/8" OD X 1-3/8" LENGTH	1348-630

#	DESCRIPTION	PART #
3.11	NOZZLE, BORON CARBIDE, STRAIGHT BORE, GUN INSERT, 3/8" BORE, 7/8" OD X 1-3/8" LENGTH	1348-640
3.12	NOZZLE, BORON CARBIDE, STRAIGHT BORE, GUN INSERT, 7/16" BORE, 7/8" OD X 1-3/8" LENGTH	1348-650
3.13	NOZZLE, BORON CARBIDE, STRAIGHT BORE, GUN INSERT, 1/2" BORE, 7/8" OD X 1-3/8" LENGTH	1348-1090
3.14	NOZZLE, TUNGSTEN CARBIDE, STRAIGHT BORE, WIDE SPRAY GUN INSERT, 3/8" BORE, 7/8" OD X 2-3/4" LENGTH	TL170-6
3.15	NOZZLE, BORON CARBIDE, STRAIGHT BORE, WIDE SPRAY, GUN INSERT, 5/16" BORE, 7/8" OD X 2-3/4" LENGTH	1348-590
3.16	NOZZLE, BORON CARBIDE, STRAIGHT BORE, WIDE SPRAY, GUN INSERT, 3/8" BORE, 7/8" OD X 2-3/4" LENGTH	1348-600
3.17	NOZZLE, BORON CARBIDE, STRAIGHT BORE, WIDE SPRAY, GUN INSERT, 7/16" BORE, 7/8" OD X 2-3/4" LENGTH	1348-610
4.1	NOZZLE, EXTENSION #5, 3" LONG, HEAT TREATED STEEL	1348-230
4.2	NOZZLE, EXTENSION #6, 3" LONG, HEAT TREATED STEEL	1348-240
4.3	NOZZLE, EXTENSION #7, 3" LONG, HEAT TREATED STEEL	1348-250
4.4	NOZZLE, EXTENSION #5, 6" LONG, HEAT TREATED STEEL	1348-340
4.5	NOZZLE, EXTENSION #6, 6" LONG, HEAT TREATED STEEL	1348-350
4.6	NOZZLE, EXTENSION #7, 6" LONG, HEAT TREATED STEEL	1348-360
4.7	NOZZLE, EXTENSION #5, 9" LONG, HEAT TREATED STEEL	1348-130
4.8	NOZZLE, EXTENSION #6, 9" LONG, HEAT TREATED STEEL	1348-140
4.9	NOZZLE, EXTENSION #7, 9" LONG, HEAT TREATED STEEL	1348-150
5	GUARD, WIDE SPRAY NOZZLE	1661-60
6	O-RING	1423-70
7	RETAINING RING, WIDE SPRAY	1424-480

HAND GUN ASSEMBLY

(Pg. 3 of 3)

#	DESCRIPTION	PART #
8	GUN BODY, HAND	1237-10
9	NUT, LOCKING	1347-1230
10	SLEEVE, RUBBER	1450-50
11.1	ORIFICE, 3/32"	1701-280
11.2	ORIFICE, 1/8"	1701-290
11.3	ORIFICE, 5/32"	1701-300
11.4	ORIFICE, 3/16"	1701-310
11.5	ORIFICE, 7/32"	1701-320
11.6	ORIFICE, 1/4"	1701-330
12.1	FITTING, 1/2" SWIVEL x 1/2" PUSH LOK	1219-300
12.2	FITTING, 1/2" SWIVEL TO 3/8" BARB	1219-350
13	HOSE, AIR, INSTA-GRIP, BLACK, NOMINAL 1/2" ID, WP 300 PSI, PRICE PER FOOT, SOLD IN 10' INCREMENTS ONLY, REEL SIZE 500'	535-278-016
14	FITTING, 1/2" HOSE BARB x 3/8" NPT	1219-340
15.1	HOSE, SUCTION, CLEAR, NOMINAL 1/2" ID x 3/4" OD, PRICE PER FOOT, SOLD IN 10' INCREMENTS ONLY, BOX SIZE 100'	C-210-A1/2
15.2	HOSE, SUCTION, BLACK, NOM. ID 1/2" x 15/16" OD, 2 PLY, PRICE PER FOOT, SOLD IN 10' INCREMENTS ONLY, REEL SIZE 400 FT	112-4710
15.3	SURVIVOR® HOSE, SUCTION, BLACK, NOM. ID 1/2" x 15/16" OD, 2 PLY, PRICE PER FOOT, SOLD IN 10' INCREMENTS, REEL SIZE 400 FT	SUR121516 B



www.idsblast.com
(317) 545-0665 - (800) 800-0665
2717 Tobey Dr. Indianapolis, IN 46219