

LUXEMBOURG ®

ROCKING CHAIR
DESIGN BY FRÉDÉRIC SOFIA

ITEM 4166



TESTING STANDARDS - Upon request
NF EN 581-1 (all products), NF EN 581-2 (seats)

WARRANTY

	IN ALUMINUM	IN STEEL
STRUCTURAL	3 YEARS	2 YEARS
FINISH	2 YEARS	1 YEAR

TECHNICAL FEATURE - STRUCTURE



Tubular aluminum frame
Curved aluminum slats seat
Curved aluminum slats backrest
Aluminum slats armrests

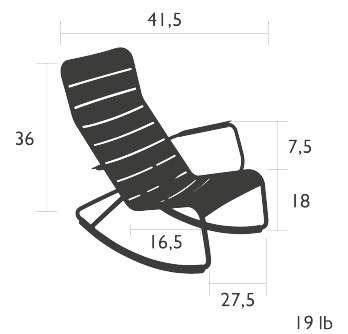

FURTHER INFORMATION

Bespoke project : Laser cutting, Ground attachment, Cable attachment, Special RAL, Silkscreen printing
Spare parts : Assembly Key, Pads, Screws

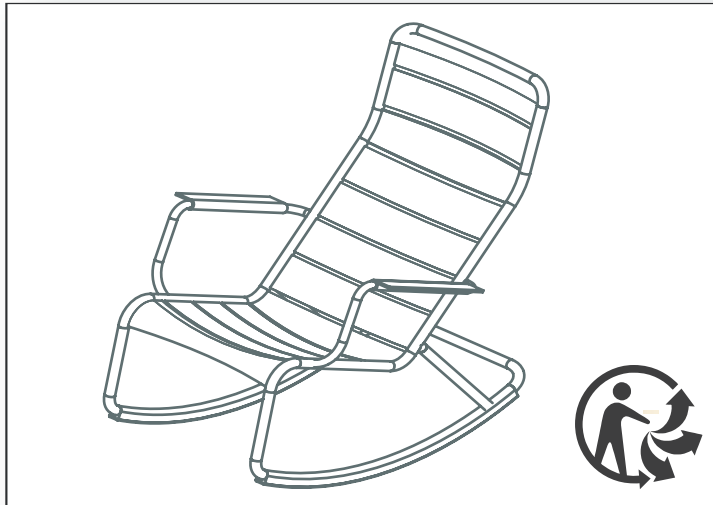

F **MISE EN GARDE:** N'assimilez pas le rocking chair à un jouet ou à une balançoire : tout enfant doit l'utiliser sous le contrôle d'un adulte.

GB **WARNING:** Please remember this rocking chair is not a toy or a swing: children must not use it without full adult supervision.

D **ACHTUNG:** Dieser Rocking Chair ist weder eine Schaukel noch ein Spielzeug : Kinder dürfen diesen nur unter Beaufsichtigung eines Erwachsenen verwenden.

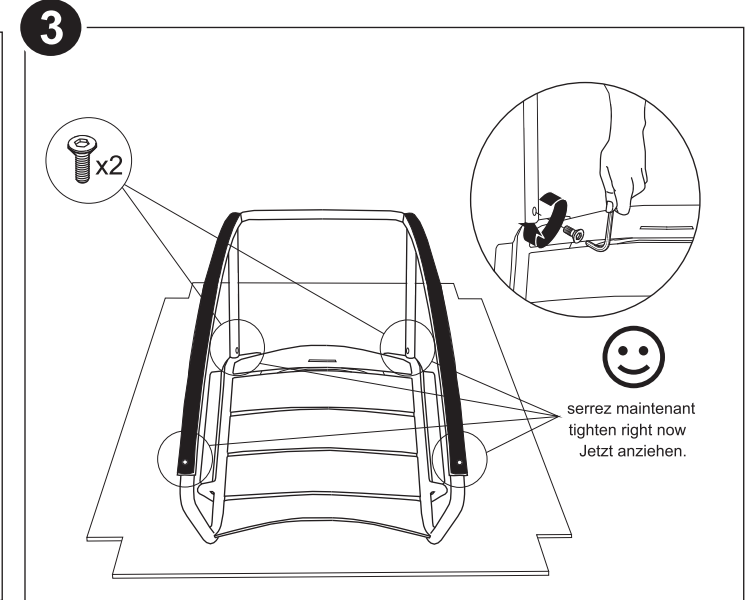
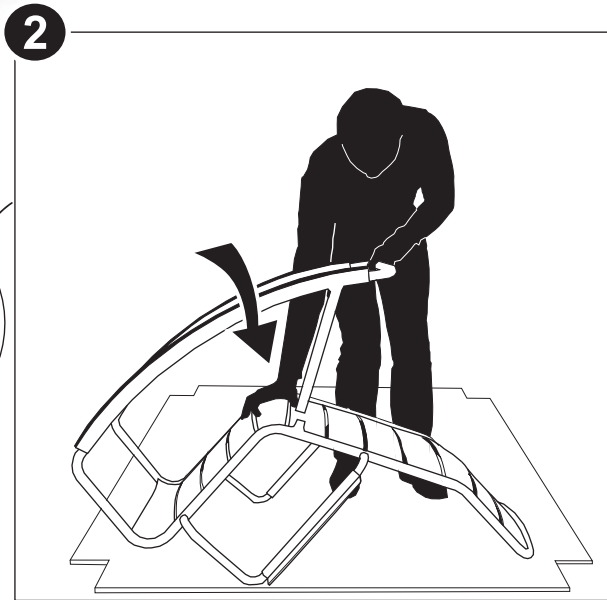
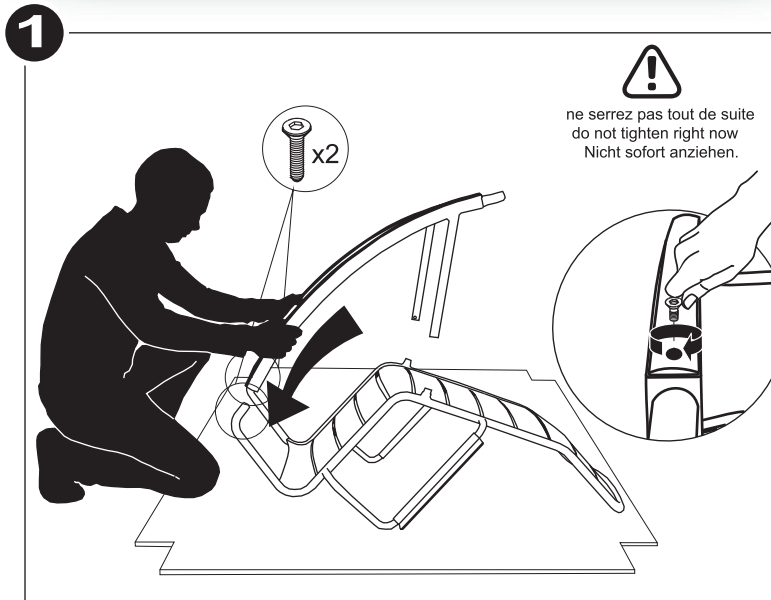
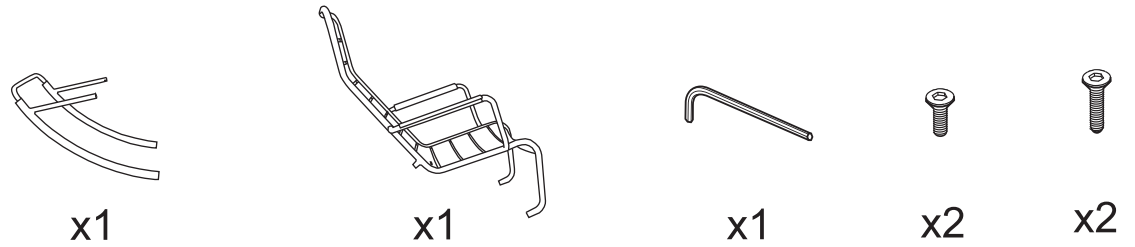

LUXEMBOURG rocking chair
DESIGN FRÉDÉRIC SOFIA



fermob