

Herman SHY3

Signe Hytte

2022

Subject of measurement

Product: Herman SHY3

Item number: 84482001

Tracking number: VT220908-005971

Tested light source

LED 2,2W - &Tradition

Light output: 221 lumen

Colour temperature (Kelvin): 3951K

Test Result

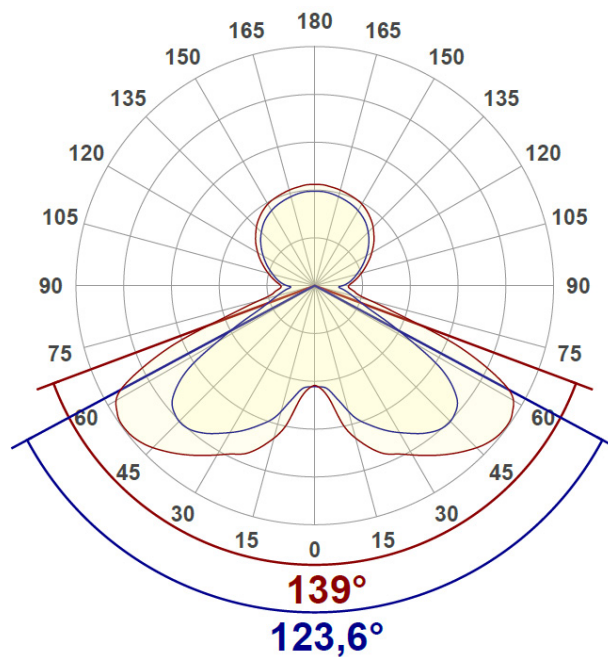

Beam angle: 139°

Intensity distribution - Polar

Measurements obtained

Light output	221 lumen
Light efficiency	101 lumen/Watt
IES file available	Yes
LDT files available	Yes

* Results may vary depending on the type of bulb used in the lamp.

Instructions



Herman SHY3 Signe Hytte 2022

Congratulations with your new Herman table lamp, designed in 2022 by Signe Hytte. We hope you will enjoy using this product. Please follow these instructions to ensure correct installation. If you have any questions or comments, please do not hesitate to contact us by mail at:

info@andtradition.com

Herman SHY3

Signe Hytte

2022

Please read these instructions carefully and retain them for future reference to ensure that the product is used correctly. For your own safety, please study each step of this instruction manual first. &Tradition is not responsible for any faults or damages caused by not following these instructions correctly. Do not modify this product in any way.

Contents

- A Lamp
- B Shade brackets
- C Lamp holder ring
- D Glass shade (comes in separate box)

Tools needed

- Bulb type E14

Safety precautions

- Dispose of plastic bag from packaging and do not allow children to play with it.
- Keep the product out of the reach of children.
- The lamp is only suitable for indoor use.
- Consult a professionally qualified electrician if in any doubt.
- Do not place the cable within reach of small children or anywhere with a risk of falling over it.
- If the external cable or cord of this lamp is damaged, it must be replaced by the manufacturer or a similar qualified person in order to avoid a hazard.

Cleaning instructions

- Wipe the surface of the shade with a dry cloth.
- Do not use any abrasive cleaning tools such as steel wool, scouring sponges or stiff brushes.
- Never use strong cleaning agents such as white spirit, turpentine, household glass cleaner or cellulose thinners.

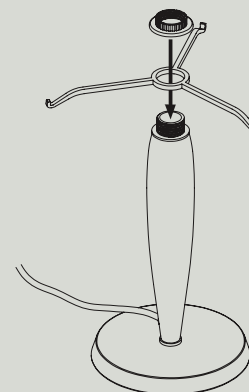
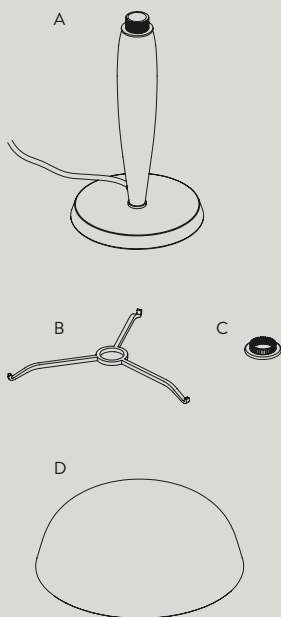

Step 1

Place the shade bracket over the socket and screw the lamp holder ring back on the socket to secure it.

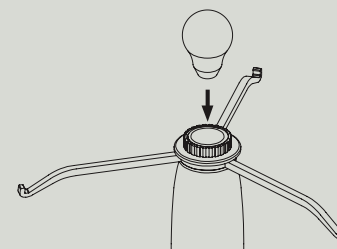

Step 2

Place the light bulb on the socket and ensure that it sits tight.

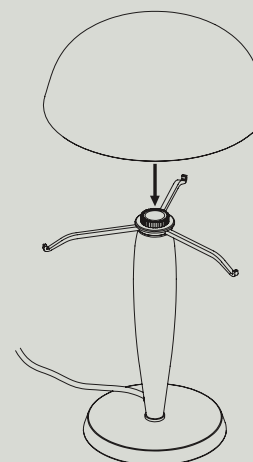

Step 3

Carefully place the shade onto the shade bracket.

For indoor use only
E14 maximum 25W
Bulb not included

&Tradition®

Herman ^{SHY3}
Signe Hytte
2022





H: 36cm / 14.2in

D: 25cm / 9.8in

Herman^{SHY3}

Signe Hytte

2022

Product category

Table lamp

Environment

Indoor

Materials

Shade: Opal Glass, Stem: Walnut Wood,
Base: Marble Stone, Cord: Black fabric with a
dimmer

Production process

Marble stone has been cut to form the base of
the lamp. The wooden stem has been spun and
afterwards oiled. The shade is made of mouth blown
opal glass

Colours

Oiled Walnut, White Opal Glass & Cream Marble

Dimensions

H: 36cm / 14.2in, L: 25cm / 9.8in,
D: 25cm / 9.8in

Packaging dimensions

H: 18cm / 7.1in, W: 32cm / 12.6in,
D: 32cm / 12.6in

Colli quantity

2 pcs

Weight

Product: 2.1kg
Incl. Packaging: 4.4 kg (base: 2.3kg, shade: 1.9kg)

Voltage

220-240V – 50Hz

Light source

E14 max 25 Watt
Dimmable

Certifications



Cord Length

L: 200cm / 78.8in

→ Stock item

Cleaning instructions

Please download our Material Care & Cleaning
instructions through www.andtradition.com



&Tradition[®]