

ASPLUND | COLLECTION

FURNITURE GUIDE

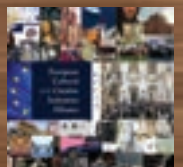

PROUD MEMBERS OF



ASPLUND - MATERIALS

In the ASPLUND range the chosen colours and nuances in the materials and finishes are carefully chosen to enrich both materials as well as the product.

ASPLUNDS' chosen materials and finishes:

veneers in oak and ash

Our oak and ash veneers are FSC-certified and sourced within the EU.

Every piece is unique in its own and is pressed on top of a MDF-Plus or a plywood which is then treated with a tinted oil wax. Oil wax without top coat must be maintained, read more about this in our maintenance/care guides.

Tabletops for dining tables are coated with a polyurethane layer. Desktops are as standard treated with an oil wax. The polyurethane makes the surfaces less delicate when used daily as it is more resistant to water, stains and UV-radiation.

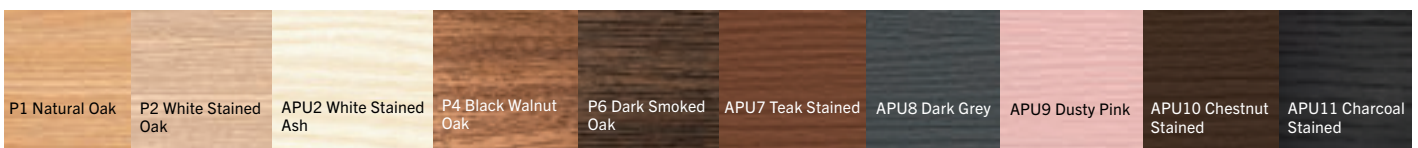

SOLID WOOD

Our solid wood is FSC certified and sourced within the EU. Solid wood is a natural and living material. We love to use solid wood for its strength, quality, strong character, and unique grain and colour. Generally the solid wood is treated with a sustainable oil wax if nothing else mentioned.

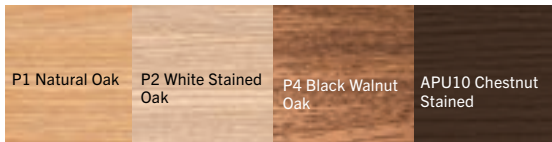

LACQUERED MDF

Our EU-sourced MDF is PEFC-certified and Svanenmärkt Medium Density Fibreboard. The density is approx. 760-800 kg/m³.

Our matte-lacquered MDF have a triple applied durable acid-hardened lacquer. For some products, where extra durability is required, we add a polyurethane lacquer.

Since Jan 2022, our Snow and Frame series are coated with a more sustainable water-based laquer. It contains a crosslink formula that makes it more dense, durable, has a higher viscosity and is more resistant to liquids as alcohol and coffee than other sustainable lacquers.

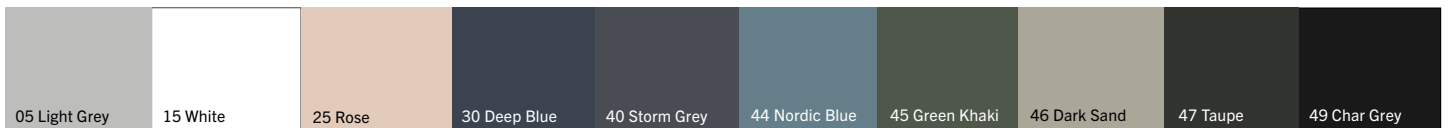

LACQUERED METAL

The metal is lacquered with a smooth semi-matte powdercoating in the ASPLUND colours.

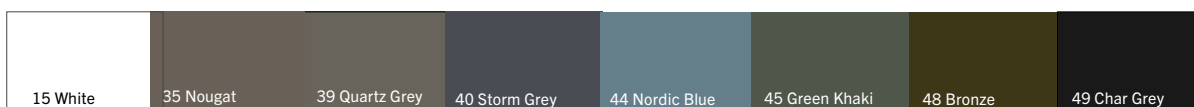

GLASS: CLEAR, LACQUERED OR TINTED

Clear glass is a 8 mm hardened glass with a slight phase to protect its corners and edges.

The lacquered glass actually has a lacquered MDF board as a base with a clear glass on top. If there is the demand for a pure white glass, there is a special "opti white" glass that can be ordered.

Tinted mirror glass for Otto Mirror are also possible for special orders on Tati coffee tables in Bronze.

STONES

Carrara Marble, Nero Marquina Marble, Pietra Grey Marble, Elegant Grey marble and Jura Limestone.

Our stone tops are sourced within the EU. They are polished to result a smooth matte appearance and are coated with a NANO finish which makes it more resistant to grains and stains plus that it makes the surface softer and smoother.

NANO finishes wears off after use and shall be maintained. Either with an Alkemi NANO spray or a natural stone wax cleaning kit.

All stones are taken from nature and every stone is different. Small tarolis, fossils , colour differences and lines are a proof of authenticity.

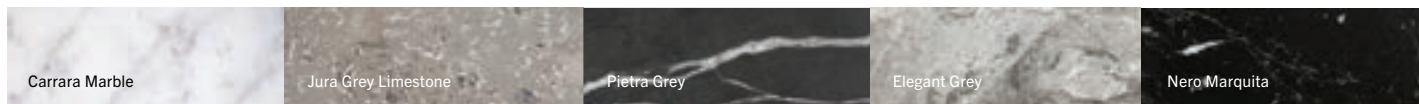

Carrara Marble is the ultimate classic type of marble that is quarried in the Carrara region of Italy. It has been used for centuries in art and architecture, and is prized for its unique veining and fresh white color. We use a B-C assortment quality which have reference to the clarity of the white.

Jura Limestone is a beige and grey limestone with no red tones from Germany. It is renowned throughout the world for its enduring beauty with encapsulated "Ammonite" fossils dating back to the Jurassic period, hence the name "Jura". Fine lines and metallic shimmers can also be a part of the characteristic pattern.

Pietra Grey is a calcite marble, A warm gray base that is calm and solid in appearance . The pattern alternates between very fine snow-white streaks and barely perceptible linear slate-colored glazes. The surface is silk matt honed.

Although Elegant Grey is a light grey marble quarried in Pakistan. The light grey variations in the stone has an elegant scandinavian look. The natural, non directional pattern is elegant and soft shifting and the surface is silk matt honed.

Nero Marquina with origin from Spain, it is an elegant black marble with discrete white veins. The surface is silk matt honed.

COLOUR CORE LAMINATE

A full all-white Formica laminate with no dark edges. Relatively maintenance-free surface material that has a high resistance to liquids and deeper scratches.

15 White

LEATHER: NATURAL, COGNAC, DARK BROWN AND BLACK

The leather we use is a vegetable tanned leather. The natural material, an aniline leather is threatened with wax, which gives an authentic look and patina from its original structure including its original scars, marks and color changes.



For any requires outside our standard range, please do not hesitate to contact us. Many materials can be readapted on other elements of our furniture.

Please find our Maintenance Guide for the different materials and finishes on page 76.



Remy Serving Trolley in White Stained Oak, Green Khaki metal bar and Elegant Grey top.

INDEX

ASPLUND - UPDATED INFORMATION 2023 AND MATERIAL LIST	2
ASPLUND - ABOUT OUR COLLECTION & THE STORY	6

STORAGE

REMY SERVING TROLLEY.....	10
FRAME CABINET	12
FRAME SEMI CABINET	12
FRAME XL	14
FRAME	16
LUC.....	18
LUC CONSOLE	20
LUC DELUXE	20
KILT LIGHT	24
KILT SIDEBBOARD.....	26
KILT OPEN	28
VASS.....	30
SNOW	32
PILE	34

FURNITURE

CHAMFER	38
TATI COFFEE TABLES	42
TATI CONSOLE	44
TATI NIGHT TABLES.....	44
TATI DESK	46
PALAIS COFFEE TABLES	48
PALAIS OVALE.....	50
PALAIS ROYAL.....	52
PALAIS MEGA	54
MOCI DINING TABLE.....	56
TATI DINING TABLES	58
BERMUDA	60
VASS DESK.....	62
OBLIQUE COFFEE TABLE	64
OBLIQUE DESK / SIDETABLE	64
PAGODA.....	66
BELLE	68
TATI COAT RACK.....	70
TATI MIRROR.....	72
OTTO MIRROR.....	74

ASPLUND - FURNITURE CARE/MAINTENANCE.....	76
---	----

ASPLUND - ABOUT OUR COLLECTION

For over three decades ASPLUND has worked on developing new designs by up-and-coming, as well as acclaimed, Swedish and international designers. This has resulted in a collection of carpets, storage, tables and other products. The ASPLUND Collection has a style that is something functional yet elegant, something Swedish yet international. And something we want to have and use in our own spaces. Pieces with a subtle identity in high quality which we believe will last for a long time.

Not only because of the well worked through design and function, but also since we choose to have a handmade or a semi manual production where everything is made to order. In that way we do not have any leftover stock and only produce as many pieces as actually needed. As a producer we see it as our responsibility to make sure that our production take place under both ethically and environmentally sustainable conditions. We are always working on improving not only our quality, but also to reach our sustainability goals. To find out more about our continuous work, check our website where we update our improvements as often as we can.

ASPLUND - MADE IN SWEDEN

In a time where the trend among furniture brands is to outsource production abroad, ASPLUND remains determined and committed to keep most of our manufacturing in Sweden. This way we are contributing to and invigorating the Swedish furniture industry and also maintaining original core values of Swedish design and manufacturing. Many pieces in our collection involves expertise from several small factories to get them up to standard. All factories specialized in their own field.

ASPLUND - THE STORY

Founded in 1990, by brothers Michael and Thomas Asplund, Gallery ASPLUND was exhibiting furniture as objects of fine art. In collaboration with designers and artists the gallery soon became a stage for contemporary art. These collaborations resulted in ASPLUND's own production line of furniture and contemporary design pieces; "ASPLUND Collection" led by Creative Director Sandra Adrian Asplund, who joined the company in 1995. The same year the gallery moved to larger premises at our current location, Sibyllegatan 31, where we today have the office, R&D dept, interior & design studio and a store that is also our showroom. With constant influences by literally meeting the end customer, and through our interior architect team's challenges, we learn daily what is needed in our homes and spaces. Nature, craftsmanship, materials and techniques combined with tradition have always been in focus and our key inspiration. This combined with the knowledge that natural materials both feels vivid and changes gracefully over time, has contributed to the ASPLUND approach of design. Over the years ASPLUND's signature style has shown the world that Swedish minimalism can be warm and elegant. We work to create design classics that can be passed on for generations.

Today ASPLUND is an internationally acclaimed design establishment, which has contributed significantly to the idea of contemporary Swedish design. ASPLUND Collection, created in collaboration with renowned designers, can be found in homes, hotels and public spaces globally. Today ASPLUND is represented at retailers world wide. The rest is both history, the present and hopefully the future.

/The ASPLUND Family









REMY SERVING TROLLEY

By Broberg & Ridderstråle 2021

A small and flexible kitchen island on castors with a selected material mix of oak veneer, metal, leather and marble. Perfect to complement a kitchen, dining room, board room or a lounge area.

Top:
Carrara Marble
Nero Marquina
Jura Limestone
Pietra Grey
Elegant Grey

Metal bar in lacquered metal:
39 Quartz Grey
45 Green Khaki
49 Char Grey

Colours:
P2 - White Stained Oak
P4 - Black Walnut Oak
P6 - Dark Smoked Oak



Remy Serving Trolley

H: 90 cm
D: 50 cm
W: 100 cm

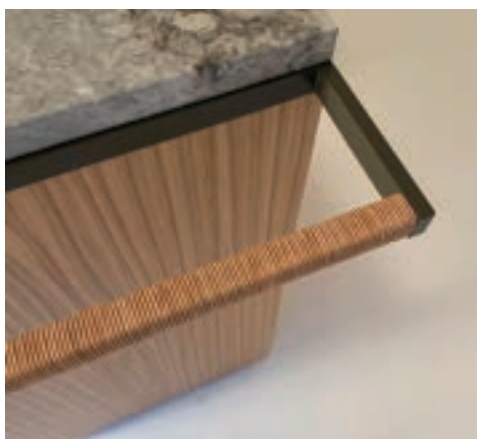

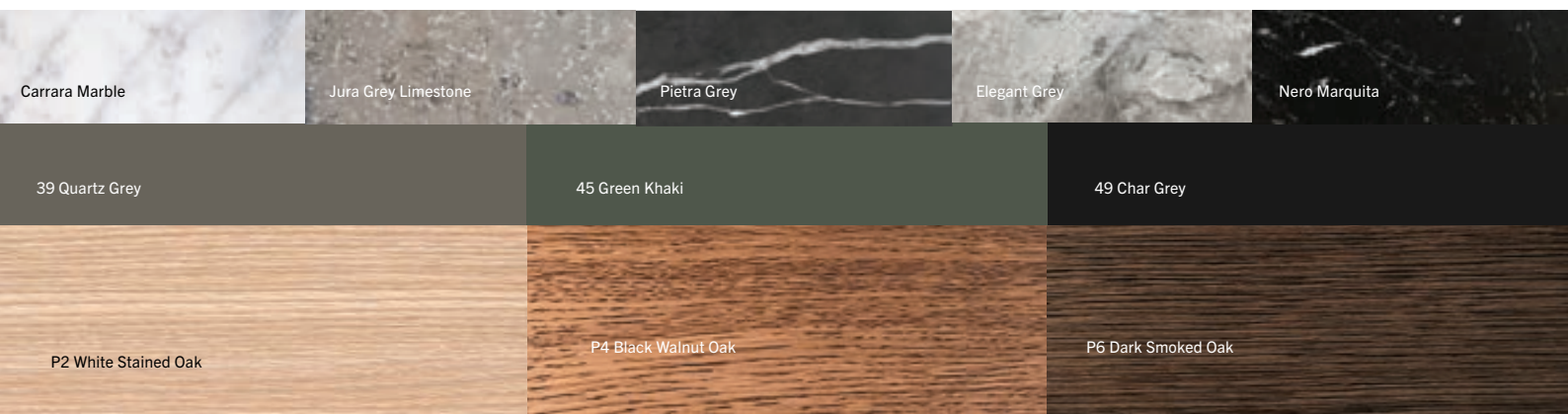

Carrara Marble

Jura Grey Limestone

Pietra Grey

Elegant Grey

Nero Marquitta

39 Quartz Grey

45 Green Khaki

49 Char Grey

P2 White Stained Oak

P4 Black Walnut Oak

P6 Dark Smoked Oak

FRAME CABINET

By Anya Sebton & Eva Lilja Löwenhielm 2011

Cabinet with lacquered MDF frame, stand in lacquered metal, doors and sides in glass with twined leather handles.

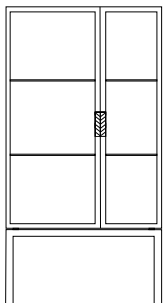

Frame Cabinet

H: 170 cm

D: 40 cm

W: 90 cm

Glass cabinet with lacquered MDF frame, stand in lacquered metal, doors and sides in glass with twined leather handles. Including two glass shelves.

Adjustable feet.

Adjustable hinges in stainless steel.

Possibility for additional shelves.

Colours:

15 White

40 Storm Grey

44 Nordic Blue

45 Green Khaki

46 Dark Sand

47 Taupe

49 Char Grey

Leather:

Natural

Cognac

Dark Brown

Black

*Stand height: 43 cm

FRAME SEMI CABINET

By Anya Sebton & Eva Lilja Löwenhielm 2011

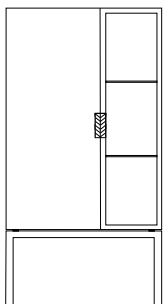

Frame Semi Cabinet

H: 170 cm

D: 40 cm

W: 90 cm

Glass cabinet in lacquered MDF, stand in lacquered metal. Left side has a covered door and a covered side with two lacquered shelves and the right side has a glass door and a glass side with two glass shelves. Doors with twined leather handles.

Adjustable feet.

Adjustable hinges in stainless steel.

Possibility for additional shelves.

Frame Semi Cabinet (Storm Grey)

ASPLUND



15 White	40 Storm Grey	44 Nordic Blue	45 Green Khaki	46 Dark Sand
47 Taupe	49 Char Grey	Natural	Cognac	Dark Brown
		Black		

FRAME XL

By Anya Sebton & Eva Lilja Löwenhielm 2011

Highest cabinet in the Frame series, with glass or covered doors and handles in leather.

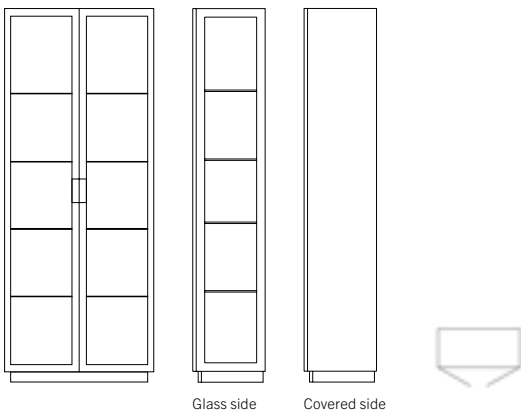

Glass side Covered side

Frame XL (Glass doors)

H: 206 cm (base 6 cm)

D: 40 cm

W: 80 cm

Cabinet with glass doors.

Highest cabinet in the Frame series, with handles in leather. Two glass doors and standard hinges.

Four adjustable glass shelves. Metal fixing for middle glass shelf to secure stability. Distance/safety brackets available as an addition to be mounted on the upper back edge. Recommended especially if designated room has large floor lists.

Choose between:

- Covered sides
- Right side in glass and covered left side
- Covered right side and left side in glass
- Both sides in glass

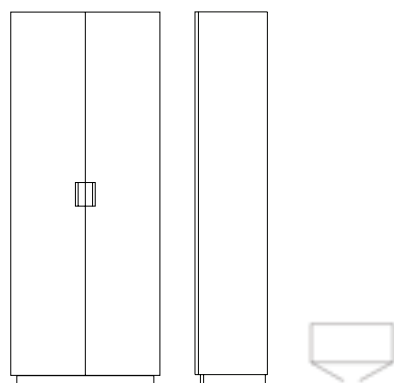

Frame XL (Covered doors)

H: 206 cm (base 6 cm)

D: 40 cm

W: 80 cm

Cabinet with covered doors and sides.

Highest cabinet in the Frame series, with handles in leather.

One shelf is fixed with a metal fixing.

Distance/safety brackets to be mounted on the upper back edge are included.

Recommended especially if designated room has large floor lists.

Colours Frame XL:

05 Light Grey

15 White

40 Storm Grey

44 Nordic Blue

45 Green Khaki

46 Dark Sand

47 Taupe

49 Char Grey

Leather:

Natural

Cognac

Dark Brown

Black

When co-ordering two or more Frame units, please choose the position of the base.

Standard:

Optional:

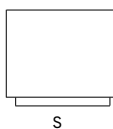

S

• Left

• Centre

• Right

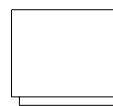

L



C



R

ASPLUND



Frame XL Glass Doors (Dark Sand). Dark Brown leather handles.

05 Light Grey

15 White

40 Storm Grey

44 Nordic Blue

45 Green Khaki

46 Dark Sand

47 Taupe

49 Char Grey

Natural

Cognac

Dark Brown

Black

FRAME

By Anya Sebton & Eva Lilja Löwenhielm 2014

Storage with covered or glass folding doors or drawers with handles in leather.

Hinges on the left hand side.

Material: Lacquered MDF

Cable holes on the backside. Storage with glass doors lack cable holes.

Colours:

05 Light Grey
15 White
40 Storm Grey
44 Nordic Blue
45 Green Khaki
46 Dark Sand
47 Taupe
49 Char Grey

Leathers:

Natural
Cognac
Dark Brown
Black

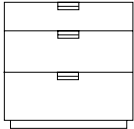

Frame Drawer Low

H: 70 cm
D: 42 cm
W: 80 cm

Three drawers

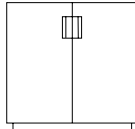

Frame 80 Low (covered doors)

H: 70 cm
D: 42 cm
W: 80 cm

Sliding door.
Including one lacquered adjustable shelf.

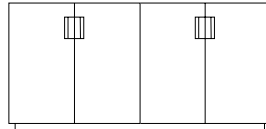

Frame 160 Low (covered doors)

H: 70 cm
D: 42 cm
W: 160 cm

Two sliding doors. One partition.
Including two lacquered adjustable shelves.

When co-ordering two or more Frame units, please choose the position of the base.

Standard:



S

Optional:

• Left • Centre • Right



L



C

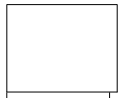

R

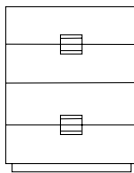

Frame Drawer Medium

H: 90 cm
D: 42 cm
W: 80 cm

Two medium and two large drawers

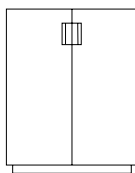

Frame 80 Medium (covered doors)

H: 90 cm
D: 42 cm
W: 80 cm

Sliding door.
Including two lacquered adjustable shelves.

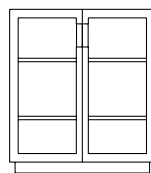

Frame 80 Medium (Glass doors)

H: 90 cm
D: 42 cm
W: 80 cm

Sliding door in glass.
Including two lacquered adjustable shelves. Cabinet with glass doors has no holes at the back.

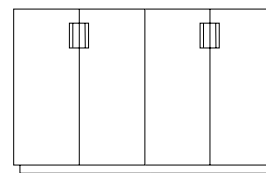

Frame 160 Medium (covered doors)

H: 90 cm
D: 42 cm
W: 160 cm

Two sliding doors. One partition.
Including four lacquered adjustable shelves.

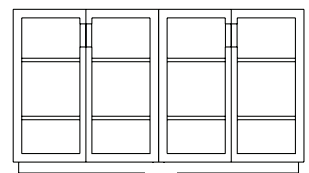

Frame 160 Medium (Glass doors)

H: 90 cm
D: 42 cm
W: 160 cm

Two sliding doors in glass. One partition.
Including four lacquered adjustable shelves. Cabinet with glass doors has no holes at the back.

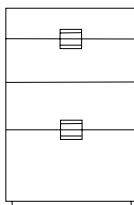

Frame Drawer High

H: 108 cm
D: 42 cm
W: 80 cm

One medium, two large and one XL drawer

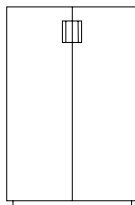

Frame 80 High (covered doors)

H: 108 cm
D: 42 cm
W: 80 cm

Sliding door.
Including two lacquered adjustable shelves.

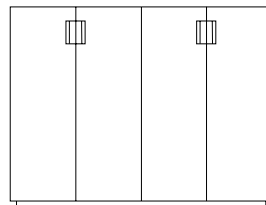

Frame 160 High (covered doors)

H: 108 cm
D: 42 cm
W: 160 cm

2 sliding doors. One partition.
Including four lacquered adjustable shelves.

From 2022 a more sustainable and durable water-based lacquer is used for surfacing the FRAME series.



05 Light Grey	15 White	40 Storm Grey	44 Nordic Blue	45 Green Khaki
46 Dark Sand	47 Taupe	49 Char Grey	Natural	
			Cognac	
			Dark Brown	
			Black	

LUC

By Broberg & Ridderstråle 2012

Storage series in oak veneer with metal stand and stone or glass top.

Cabinet in veneer:

- P1 - Natural Oak
- P2 - White Stained Oak
- P4 - Black Walnut Oak
- P5 - Char Grey Lacquered Oak, combine with stand in 49 Char Grey.
- P5 - Taupe Lacquered Oak, combine with stand in 47 Taupe
- P6 - Dark Smoked Oak

Top:

- Carrara Marble
- Nero Marquina
- Jura Limestone
- Pietra Grey
- Elegant Grey
- Glass*

*Note that the cabinet with glass top has a fixed shelf

Stand* in lacquered metal:

- 15 White
- 30 Deep Blue
- 40 Storm Grey
- 44 Nordic Blue
- 45 Green Khaki
- 47 Taupe
- 49 Char Grey

*Stand height 30 cm

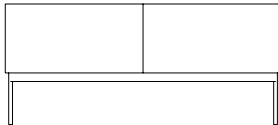

Luc Sideboard 160 (drawers)

H: 70 cm
D: 42 cm
W: 160 cm

Storage with 2 drawers in oak veneer with a lacquered stand and a stone or glass top.

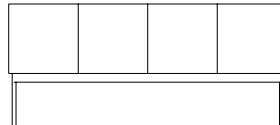

Luc Sideboard 160 (doors)

H: 70 cm
D: 42 cm
W: 160 cm

Storage with a stand in lacquered metal and stone or glass top. Cabinet with two compartments and four doors in oak veneer. Including one shelf in each compartment.



Luc Sideboard 200 (doors) with 160 stand

H: 70 cm
D: 42 cm
W: 200 cm

Storage with a stand in lacquered metal and stone top. Cabinet with three compartments and five doors in oak veneer. Including one shelf in each compartment.

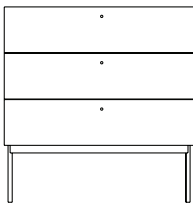

Luc Drawer 100

H: 103 cm
D: 42 cm
W: 100 cm

Cabinet with 3 drawers in oak veneer with brushed brass knobs, a lacquered stand and a stone or glass top.

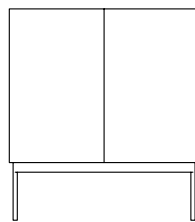

Luc Cabinet 100

H: 103 cm
D: 42 cm
W: 100 cm

Cabinet with 2 doors in oak veneer with a lacquered stand and a stone or glass top.

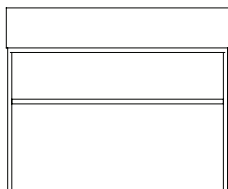

Luc Console 100 Oak

H: 81 cm
D: 40,4 cm
W: 99 cm

Console in oak veneer (P2, P4, P5 or P6) with one drawer and a lacquered MDF shelf. Stand in lacquered metal. Top in stone. Hidden grip.

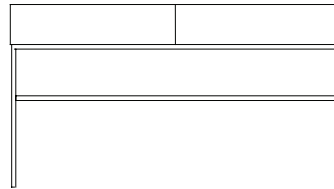

Luc Console 160 Oak

H: 81 cm
D: 40,4 cm
W: 158,4 cm

Console in oak veneer (P2, P4, P5 or P6) with two drawers and a lacquered MDF shelf. Stand in lacquered metal. Top in stone. Hidden grip.

Console in veneer:

- P1 - Natural Oak
- P2 - White Stained Oak
- P4 - Black Walnut Oak
- P5 - Char Grey Lacquered Oak, combine with stand in 49 Char Grey.
- P5 - Taupe Lacquered Oak, combine with stand in 47 Taupe
- P6 - Dark Smoked Oak

Top:

- Carrara Marble
- Nero Marquina
- Jura Limestone
- Pietra Grey
- Elegant Grey

Stand* in lacquered metal:

- 15 White
- 30 Deep Blue
- 40 Storm Grey
- 44 Nordic Blue
- 45 Green Khaki
- 47 Taupe
- 49 Char Grey

*Stand height 65 cm

ASPLUND

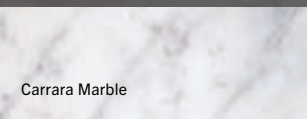
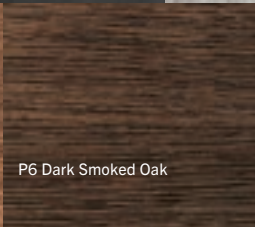
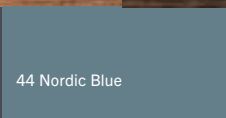
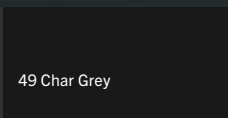

Luc Sideboard 160 doors (P2 White Stained Oak, Nordic Blue, Carrara Marble)

 Carrara Marble	 Jura Grey Limestone	 Pietra Grey	 Elegant Grey	 Nero Marquitta		
 P1 Natural Oak	 P2 White Stained Oak	 P4 Black Walnut Oak	 P6 Dark Smoked Oak	 P5 Taupe Lacquered Oak	 P5 Char Grey Lacquered Oak	
 15 White	 30 Deep Blue	 40 Storm Grey	 44 Nordic Blue	 45 Green Khaki	 47 Taupe	 49 Char Grey

LUC CONSOLE

By Broberg & Ridderstråle 2015

Lacquered Console with brushed brass knob and stone or wood top.

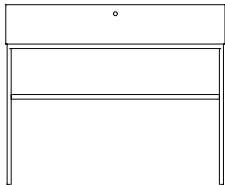

Luc Console 100

H: 81 cm

D: 40,4 cm

W: 99 cm

Console in lacquered MDF containing one drawer with a brushed brass knob. Stand in lacquered metal, shelf in lacquered MDF and top in stone or oak veneer.

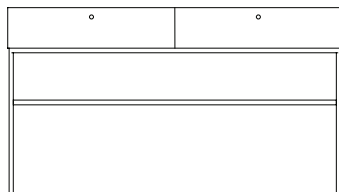

Luc Console 160

H: 81 cm

D: 40,4 cm

W: 158,4 cm

Console in lacquered MDF containing two drawers with brushed brass knobs. Stand in lacquered metal, shelf in lacquered MDF and top in stone or oak veneer.

Colours:

15 White
30 Deep Blue
40 Storm Grey
44 Nordic Blue
45 Green Khaki
46 Dark Sand
47 Taupe
49 Char Grey

Top:







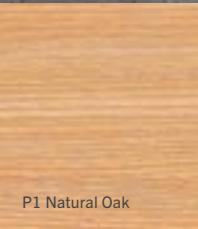

Carrara Marble
Nero Marquina
Jura Limestone
Pietra Grey
Elegant Grey
P1 - Natural Oak
P2 - White Stained Oak
P4 - Black Walnut Oak
P6 - Dark Smoked Oak
Lacquered glass - on request

*Stand height 65 cm

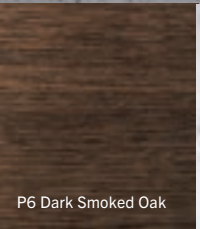
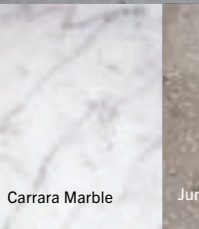
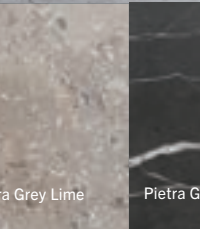
ASPLUND

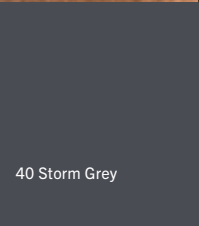
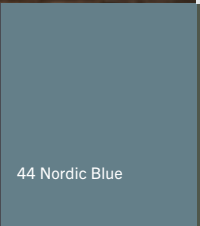
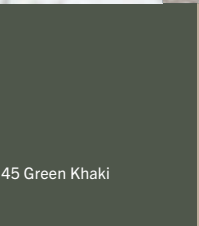
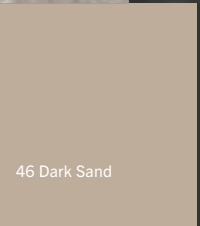
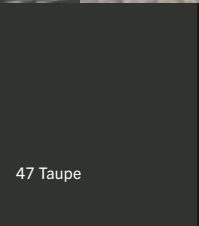

Luc Console 160 (Dark Sand)

								
P1 Natural Oak	P2 White Stained Oak	P4 Black Walnut Oak	P6 Dark Smoked Oak	Carrara Marble	Jura Grey Lime	Pietra Grey	Elegant Grey	Nero Marquina
								
15 White	30 Deep Blue	40 Storm Grey	44 Nordic Blue	45 Green Khaki	46 Dark Sand	47 Taupe	49 Char Grey	

LUC DELUXE

By Broberg & Ridderstråle 2012

Cabinet in lacquered oak veneer with stone top and solid wooden stand.

Colours in P5:
40 Storm Grey
44 Nordic Blue
46 Dark Sand
47 Taupe
49 Char Grey

Top:
Carrara Marble
Nero Marquina
Jura Limestone
Pietra Grey
Elegant Grey

Stand in solid oak:
P1 - Natural Oak
P2 - White Stained Oak
P4 - Black Walnut Oak
P6 - Dark Smoked Oak

Stand height 30 cm

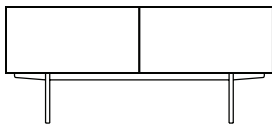

Luc Deluxe 160 (drawers)

H: 70 cm
D: 42 cm
W: 160 cm

Storage in lacquered oak veneer with a wooden stand and stone top. Two drawers.

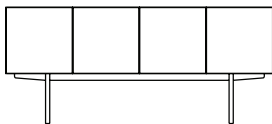

Luc Deluxe 160 (doors)

H: 70 cm
D: 42 cm
W: 160 cm

Storage in lacquered oak veneer with a wooden stand and stone top. Cabinet with two compartments (77/77) and four doors. One shelf in each compartment.

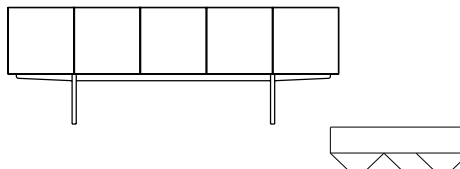

Luc Deluxe 200 (doors)

H: 70 cm
D: 42 cm
W: 200 cm

Storage in lacquered oak veneer with a wooden stand and stone top. Cabinet with three compartments (97/47/97) and five doors. One shelf in each compartment.

ASPLUND



Luc Deluxe 160, Doors (Jura Grey Limestone, Dark Sand). Stand in P6 Dark Smoked Oak

 Carrara Marble	 Jura Grey Limestone	 Pietra Grey	 Elegant Grey	 Nero Marquina
 40 Storm Grey	 44 Nordic Blue	 46 Dark Sand	 47 Taupe	 49 Char Grey
 P1 Natural Oak Stand	 P2 White Stained Oak Stand	 P4 Black Walnut Oak Stand	 P6 Dark Smoked Oak Stand	

KILT LIGHT

By Claesson Koivisto Rune 2011

Storage series in lacquered MDF with lacquered metal stand.

Colours:

15 White
30 Deep Blue
40 Storm Grey
44 Nordic Blue
45 Green Khaki
46 Dark Sand
47 Taupe
49 Char Grey

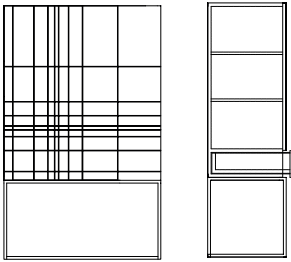

Kilt Light 90

H: 145 cm (stand 45 cm)

D: 45 cm

W: 90 cm

Cabinet in lacquered MDF with lacquered metal stand in the same colour. The cabinet has two doors and two drawers. It has two compartments and two shelves behind each door. Inside of drawer in birch.



Standard back for Kilt light:
Openings on the back for
cables/ventilation.

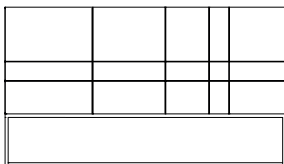

Kilt Light 137

H: 87 cm (stand 32 cm)

D: 45 cm

W: 137 cm

Cabinet in lacquered MDF with lacquered metal stand in the same colour.

One shelf behind each door.

Cabinet with three doors (D)

Width of the doors from left to right: 37/37/62 cm.

Cabinet with two doors and two drawers to the right (DB)

Width of the doors from left to right: 37/37 cm.

Width of the drawers: 62 cm.

Inside of drawer in birch.

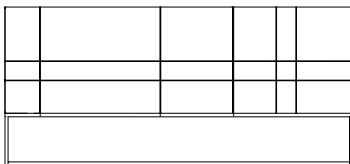

Kilt Light 180

H: 87 cm (stand 32 cm)

D: 45 cm

W: 180 cm

Cabinet in lacquered MDF with lacquered metal stand in the same colour. One shelf behind each door.

Cabinet with four doors (D)

Width of the doors from left to right: 18/62/37/62.

Cabinet with three doors and two drawers to the right (DB)

Width of the doors from left to right: 18/62/37 cm.

Width of the drawers: 62 cm.

Inside of drawer in birch.

ASPLUND

Kilt Light 90 (Nordic Blue)



KILT SIDEBOARD

By Claesson Koivisto Rune 2008

Cabinet series in lacquered MDF with doors or drawers and runners in solid oak.

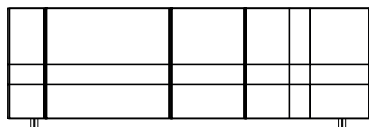

**Kilt Sideboard 180
(doors)**

H: 60 cm
D: 31,5 cm alt 45 cm
W: 180 cm

Cabinet with four doors with one removable shelf behind each door.
Width of the doors from left to right: 18/62/37/62 cm.

Lacquered MDF or Veneer P4, P6.
Runners in oak

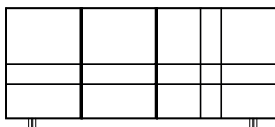

**Kilt Sideboard 137
(doors)**

H: 60 cm
D: 31,5 cm alt 45 cm
W: 137 cm

Cabinet with three doors with one removable shelf behind each door.
Width of the doors from left to right: 37/37/62 cm.

Lacquered MDF or Veneer P4, P6.
Runners in oak

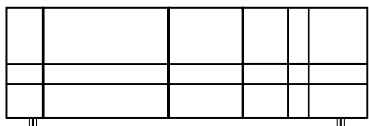

**Kilt Sideboard 180
(doors & drawers)**

H: 60 cm
D: 45 cm
W: 180 cm

Cabinet with three doors and two drawers to the right, comes with one removable shelf behind each door.
Width of the doors from left to right: 18/62/37 cm. Width of the drawers: 62 cm.

Lacquered MDF or Veneer P4, P6.
Runners in oak
Inside of drawers in birch.

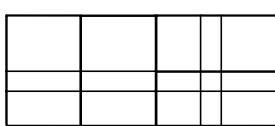

**Kilt Sideboard 137
(doors & drawers)**

H: 60 cm
D: 45 cm
W: 137 cm

Cabinet with two doors and two drawers to the right, comes with one removable shelf behind each door.
Width of the doors from left to right: 37/37 cm. Width of the drawers: 62 cm.

Lacquered MDF or Veneer P4, P6.
Runners in oak
Inside of drawers in birch.

Colours:
15 White
30 Deep Blue
40 Storm Grey
44 Nordic Blue
45 Green Khaki
46 Dark Sand
47 Taupe
49 Char Grey

Runners in solid oak:
P1 - Natural Oak
P2 - White Stained Oak
P4 - Black Walnut Oak
P6 - Dark Smoked Oak

Runners height: 5 cm

Veneer:
P4 - Black Walnut Oak
P6 - Dark Smoked Oak

Veneered cabinets only comes with matching solid oak runners.

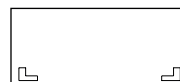

Standard back for Kilt:
Openings on the back for cables/ventilation.

ASPLUND



Kilt Sideboard 137 (Taupe)

15 White	30 Deep Blue	40 Storm Grey	44 Nordic Blue	45 Green Khaki
46 Dark Sand	47 Taupe	49 Char Grey	P2 White Stained Oak Base	P4 Black Walnut Oak Base
			P1 Natural Oak Base	P6 Dark Smoked Oak Base

KILT OPEN

By Claesson Koivisto Rune 2010

Open storage in veneer and runners in solid oak.

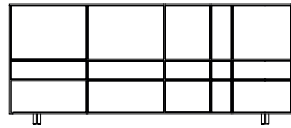

Kilt Open 137

H: 60 cm

D: 29,5 or 43,5 cm

W: 137 cm

Open storage in oak veneer with fixed interior.
Choose between P1, P2, P4 and P6.

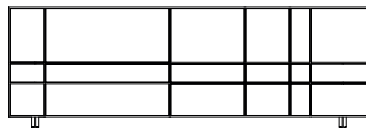

Kilt Open 180

H: 60 cm

D: 29,5 or 43,5 cm

W: 180 cm

Open storage in oak veneer with fixed interior.
Choose between P1, P2, P4 and P6.

Veneer:

P1 - Natural Oak

P2 - White Stained Oak

P4 - Black Walnut Oak

P6 - Dark Smoked Oak

The open storage always with
matching solid oak runners, height
5 cm.

ASPLUND



Kilt Open (P4 Black Walnut Oak)

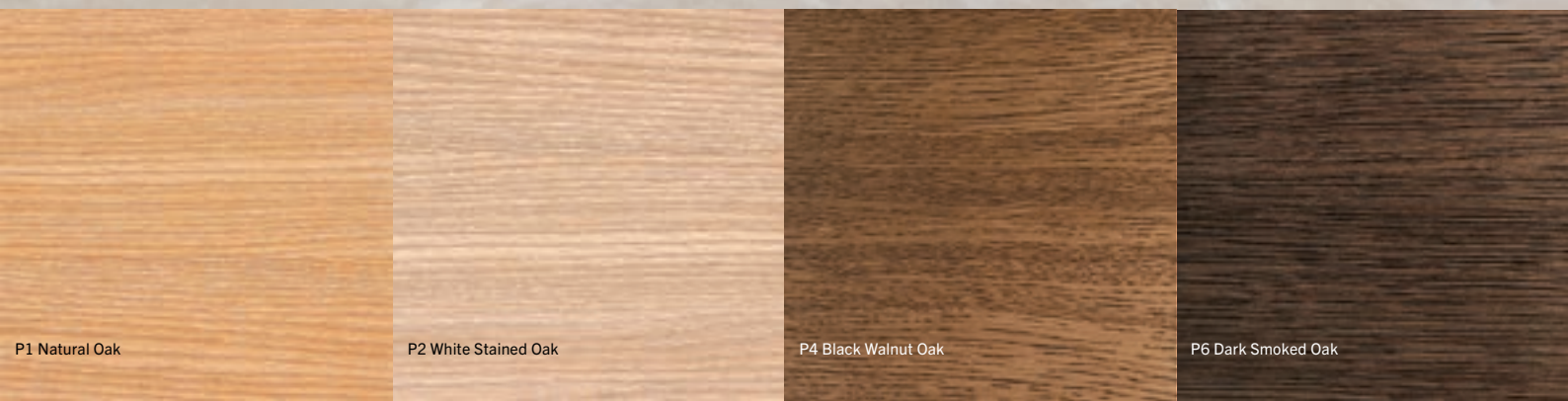

P1 Natural Oak

P2 White Stained Oak

P4 Black Walnut Oak

P6 Dark Smoked Oak

VASS

By Claesson Koivisto Rune 2007

Storage series in lacquered MDF or oak veneer. Stand or base in solid oak.

Floor protection feet will add about 0,5 cm to the height.

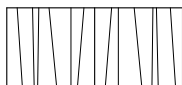

Vass 40:90 Wall
2 doors, 1 section

H: 40 cm
D: 40 cm
W: 90 cm

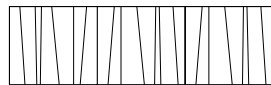

Vass 40:135 Wall
3 doors, 2 sections

H: 40 cm
D: 40 cm
W: 135 cm



Standard back for the free standing Vass. L-shaped openings on the back for cables/ventilation.

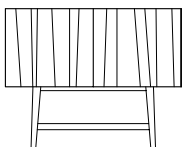

Vass 40:90
2 doors, 1 section

H: 72 cm
D: 40 cm
W: 90 cm

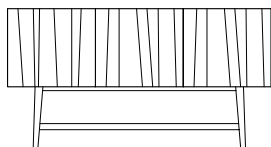

Vass 40:135
3 doors, 2 sections

H: 72 cm
D: 40 cm
W: 135 cm

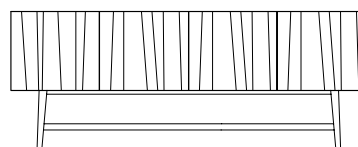

Vass 40:180
4 doors, 2 sections

H: 72 cm
D: 40 cm
W: 180 cm

Colours:

15 White
40 Storm Grey
45 Green Khaki
46 Dark Sand
47 Taupe
P4 - Black Walnut Oak
P6 - Dark Smoked Oak

Stand or Base in solid oak:

P1 - Natural Oak
P2 - White Stained Oak
P4 - Black Walnut Oak
P6 - Dark Smoked Oak

Please note that veneered cabinets always comes with matching solid oak stand or base. All Vass combinations are available with stand or base.

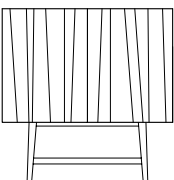

Vass 60:90
2 doors, 1 section

H: 92 cm
D: 40 cm
W: 90 cm

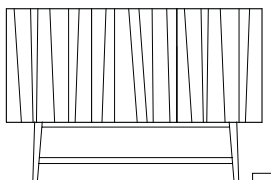

Vass 60:135
3 doors, 2 sections

H: 92 cm
D: 40 cm
W: 135 cm

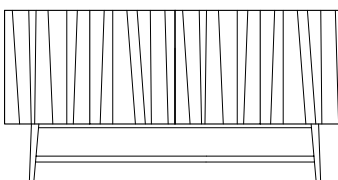

Vass 60:180
4 doors, 2 sections

H: 92 cm
D: 40 cm
W: 180 cm

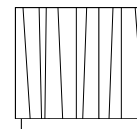

Stand height: 32 cm
Base height: 5 cm

Please note that glides will add about 0,5 cm to the height.

The width of each Vass door is 44,5 cm

– Please find Vass Desk on page 60.

ASPLUND

Vass 40:135 Stand (Green Khaki)



15 White	40 Storm Grey	45 Green Khaki	46 Dark Sand
47 Taupe	P4 Black Walnut Oak	P6 Dark Smoked Oak	<div>Stand in oak:</div> <div>P1 Natural Oak</div> <div>P2 White Stained Oak</div> <div>P4 Black Walnut Oak</div> <div>P6 Dark Smoked Oak</div>

SNOW

By Thomas Sandell & Jonas Bohlin 1994

Storage in lacquered MDF with base in solid oak and soft-closing drawers.

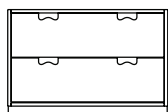

Snow Drawer A2

H: 59 cm
D: 42 cm
W: 90 cm

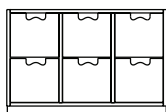

Snow Drawer B2

H: 59 cm
D: 42 cm
W: 90 cm

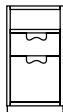

Snow Drawer G3

H: 59 cm
D: 42 cm
W: 31,1 cm

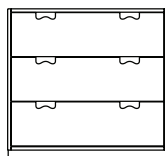

Snow Drawer A3

H: 84 cm
D: 42 cm
W: 90 cm

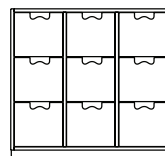

Snow Drawer B3

H: 84 cm
D: 42 cm
W: 90 cm

Colours:

05 Light Grey
15 White
25 Rose
40 Storm Grey
44 Nordic Blue
45 Green Khaki
46 Dark Sand
47 Taupe
49 Char Grey

Standard base:
Natural oak P1

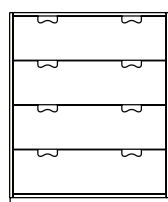

Snow Drawer A

H: 109 cm
D: 42 cm
W: 90 cm

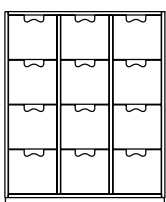

Snow Drawer B

H: 109 cm
D: 42 cm
W: 90 cm



Snow Drawer J4

H: 109 cm
D: 42 cm
W: 31,3 cm

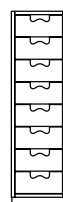

Snow Drawer J8

H: 109 cm
D: 42 cm
W: 31,3 cm

Please note!

From 2022 a more sustainable and durable water-based lacquer is used for surfacing the SNOW series. It may differ slightly from the old one.

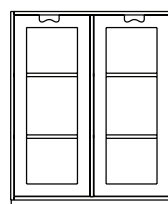

Snow Cabinet E (Glass doors)

H: 109 cm
D: 30 cm alt. 42 cm
W: 90 cm

Cabinet with glass doors with middle partition and four shelves, choose between two depths.
Width of shelf: 42,5 cm
Extra shelves can be ordered.

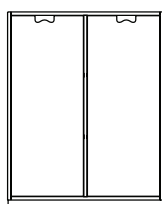

Snow Cabinet E (Covered doors)

H: 109 cm
D: 30 cm alt. 42 cm
W: 90 cm

Cabinet with covered doors with middle partition and four shelves, choose between two depths.
Width of shelf: 42,5 cm.
Extra shelves can be ordered.

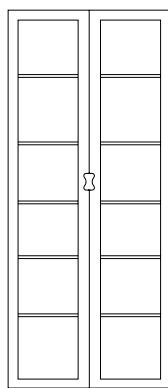

Snow Cabinet F (Glass doors)

H: 210 cm
D: 30 cm alt. 42 cm
W: 90 cm

Cabinet with glass doors and lacquered shelves, choose between two depths.
Width of shelf: 86 cm.
Extra shelves can be ordered.

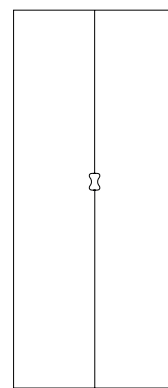

Snow Cabinet F (Covered doors)

H: 210 cm
D: 30 cm alt. 42 cm
W: 90 cm

Cabinet with covered doors and lacquered shelves, choose between two depths.
Width of shelf: 86 cm.
Extra shelves can be ordered.

ASPLUND



Snow Drawer A3 (05 Light Grey)

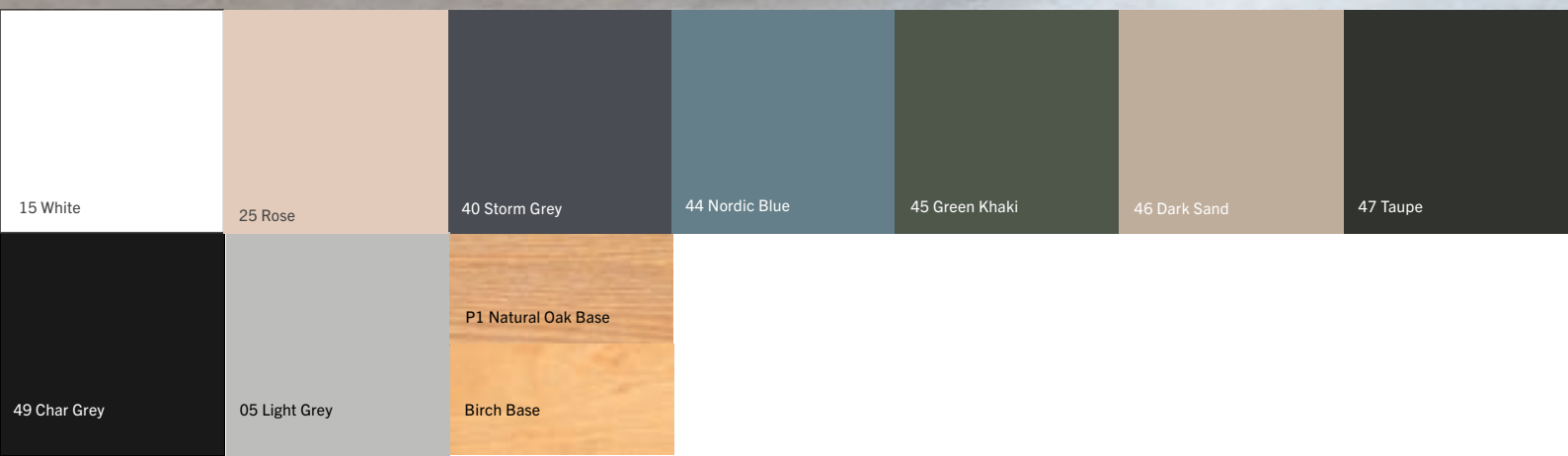

15 White

25 Rose

40 Storm Grey

44 Nordic Blue

45 Green Khaki

46 Dark Sand

47 Taupe

49 Char Grey

05 Light Grey

P1 Natural Oak Base

Birch Base

PILE

By Jessica Signell Knutsson 2013

Unit with one drawer and hidden castors.

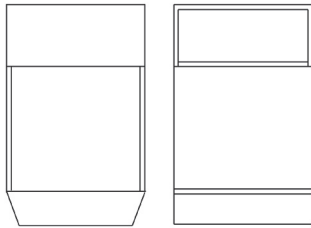

Pile

H: 49 cm

D: 35 cm

B: 35 cm

Colours:

P2 - White Stained Oak

American Walnut



P2 White Stained Oak



American Walnut

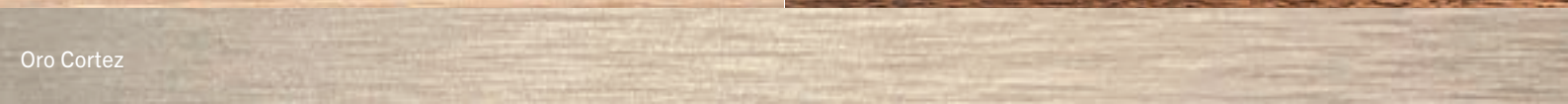

Oro Cortez





CHAMFER

By Mattias Stenberg 2018

A coffee table and a stackable lounge table with versatile functionality. The name Chamfer comes from the angled detail that make the specific corner appearance.

Colour:
Extra White Stained Oak (EP2)

Please note our stained finishes are applied by hand and may vary.

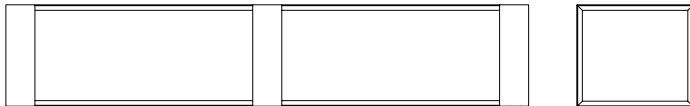

Chamfer Lounge Table/Shelf

H: 35 cm
W: 40 cm
L: 180 cm

With adjustable feet.

This lounge unit is quite special and versatile since it easily can be stacked together into a nice and sturdy bookshelf to use as a room divider or against a wall. Also, putting two or three together make a really generous coffee table. In other word, use it as you like.

Practical info:

Comes with adjustable and removable feet about 0,5-10 mm.

The stacked shelf is really steady without fittings up to 4 units. But for proper child/toddler protection it needs to be assembled with screws.

This is something we do not provide.

The product is sold as a floor unit.

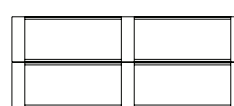

Example of two stacked shelves.

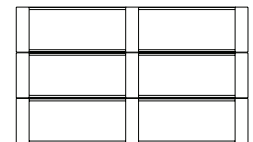

Example of three stacked shelves.

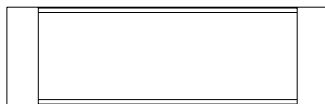

Chamfer Coffee Table

H: 35 cm
W: 80 cm
L: 115 cm

With adjustable feet.

A low minimalistic table with optimized space for books and other accessories. One short side is covered to hide eventual mess and give a calm feeling, while the other sides are open. For a wider lounge, it looks really nice to put two units beside eachother.

Please note Chamfer Coffee table and Shelf are available on Quick Ship. From our warehouse in 1-2 weeks:

Extra White Stained Oak (EP2)

Please note that we have some products available within a shorter lead time. Please see our Quick Ship assortment in separate price list.



ASPLUND







TATI COFFEE TABLE

By Broberg & Ridderstråle 2011

A series of tables with a bent metal structure.

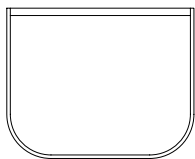

Tati Coffee Table 63,5 High (square)

H: 50 cm
D: 63,5 cm
W: 63,5 cm

Frame: Lacquered metal

Top:
Stone
Oak
Glass
Lacq. glass*



Tati Coffee Table 63,5 Low (square)

H: 40 cm
D: 60,5 cm
W: 63,5 cm

Frame: Lacquered metal

Top:
Stone
Oak
Lacq. glass*

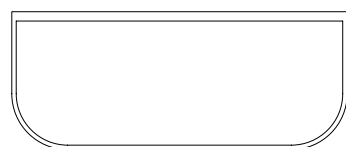

Tati Coffee Table 90 High

H: 37 cm
D: 90 cm
W: 90 cm

Frame: Lacquered metal

Top:
Stone
Oak
Glass
Lacq. glass*

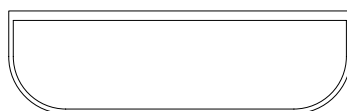

Tati Coffee Table 90 Low

H: 27 cm
D: 87 cm
W: 90 cm

Frame: Lacquered metal

Top:
Stone
Oak
Lacq. glass*

Frame colours:

15 White
35 Nougat
39 Quartz Grey
40 Storm Grey
44 Nordic Blue
45 Green Khaki
48 Bronze *
49 Char Grey

Top:

Oak:
P2 - White Stained Oak
P4 - Black Walnut Oak
P6 - Dark Smoked Oak

Stone:

Carrara Marble
Nero Marquina
Jura Limestone
Pietra Grey
Elegant Grey

Glass:

Lacquered glass*:
Standard, same as frame colours.
Clear glass only in given models.

* Please note!

Additional cost for lacquered glass in colour:
White with Opti white glass
Nougat with Opti white glass
Bronze with Bronze mirror glass.

* Please note!

Shelves for Bronze Tables are made in oak veneer P6.

TATI LOUNGE

By Broberg & Ridderstråle 2012

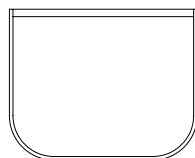

Tati Lounge 65

H: 51 cm
D: 48 cm
W: 65 cm

Frame: Lacquered metal

Top:
Stone
Glass
Lacq. glass*



Tati Lounge 120

H: 40 cm
D: 40 cm
W: 120 cm

Frame: Lacquered metal

Top:
Stone
Lacq. glass*

Glass:

Clear glass only in given models.

Lacquered glass*:

Standard, same as frame colours.









* Please note!

Additional cost for lacquered glass in colour:
White with Opti white glass
Nougat with Opti white glass
Bronze with Bronze mirror glass.

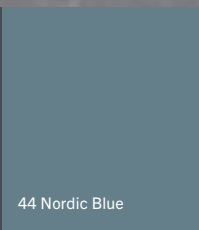
ASPLUND

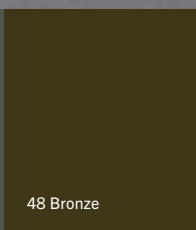

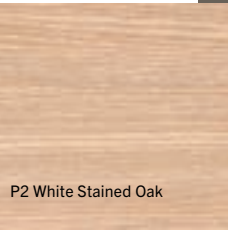
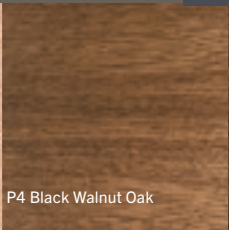
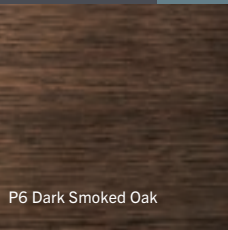
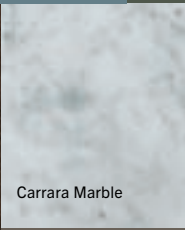
Tati Coffee Table 90 High (Char Grey and transparent glass)
Tati Coffee Table 90 Low (Char Grey and Nero Marquina)

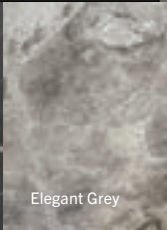
							
15 White	35 Nougat	40 Storm Grey	44 Nordic Blue	45 Green Khaki	48 Bronze	49 Char Grey	39 Quartz Grey
							
P2 White Stained Oak	P4 Black Walnut Oak	P6 Dark Smoked Oak	Carrara Marble	Jura Grey Lime	Pietra Grey	Elegant Grey	Nero Marquina

TATI CONSOLE

By Broberg & Ridderstråle 2011

Console table with a bent metal structure.

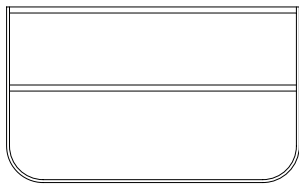

Tati Console 120

H: 72 cm
D: 40 cm
W: 120 cm

Frame: Lacquered metal, shelf in lacquered MDF.

Top:

Stone
Oak
Lacq. glass*
Shelf: Same colour as stand

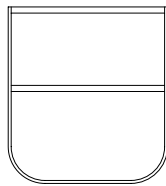

Tati Console 65

H: 72 cm
D: 40 cm
W: 65 cm

Frame: Lacquered metal, shelf in lacquered MDF.

Top:

Stone
Oak
Lacq. glass*
Shelf: Same colour as stand

Frame colours:

15 White
35 Nougat
39 Quartz Grey
40 Storm Grey
44 Nordic Blue
45 Green Khaki
48 Bronze*
49 Char Grey

Top:

Oak:

P2 - White Stained Oak
P4 - Black Walnut Oak
P6 - Dark Smoked Oak

Stone:

Carrara Marble
Nero Marquina
Jura Limestone
Pietra Grey
Elegant Grey

Glass:

Lacquered glass

* Please note!

Shelves for Bronze Tables are made in oak veneer P6.

TATI NIGHT TABLE

By Broberg & Ridderstråle for 2012

Bedside table with a bent metal structure.

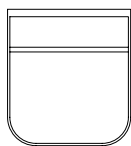

Nati Tati Console Low

H: 55 cm
D: 40 cm
W: 45 cm

Frame: Lacquered metal, shelf in MDF.

Top:

Stone: Carrara Marble
Nero Marquina
Jura Limestone
Pietra Grey
Elegant Grey
Oak: P2, P4, P6
Shelf: Same as stand, Bronze has an oak veneer shelf.

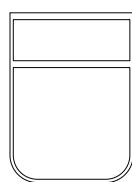

Nati Tati Console High

H: 62 cm
D: 40 cm
W: 45 cm

Frame: Lacquered metal, shelf in MDF.

Top:

Stone: Carrara Marble
Nero Marquina
Jura Limestone
Pietra Grey
Elegant Grey
Oak: P2, P4, P6
Shelf: Same as stand, Bronze has an oak veneer shelf.

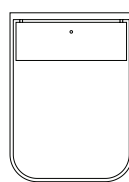

Nati Tati Drawer High

H: 62 cm
D: 40 cm
W: 45 cm

Frame: Lacquered metal.

Top and drawer in Oak: P2, P4, P6.

Drawer with brushed brass knob.



Tati Console 120 (Char Grey)

TATI DESK

By Broberg & Ridderstråle 2012

Desk with lacquered metal frame stand. Drawer with brushed brass knob. Optional addition up to 3 drawers in total.

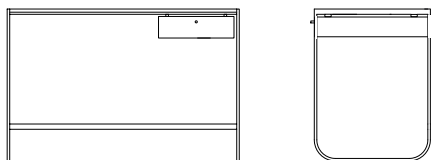

Tati Desk

H: 72 cm

D: 55 cm

W: 110 cm

Top:

Oak: P2, P4 or P6.

Tati Desk comes with 1 drawer in the same veneer as the desk top.

Drawer can be moved to the left side.

Delivered fully assembled.

Adjustable feet included, +5 mm.

Rear bracket is 25 cm from the floor.

Additional:

2 Drawers

3 Drawers (only recommended if used as sideboard)

Frame colours:

15 White

35 Nougat

39 Quartz Grey

40 Storm Grey

44 Nordic Blue

45 Green Khaki

48 Bronze

49 Char Grey

Top:

P2 - White Stained Oak

P4 - Black Walnut Oak

P6 - Dark Smoked Oak

Please note the following colour combinations with one drawer
are available on Quick Ship (From our warehouse in 1-2 weeks):

Frame colour Char Grey, with top/drawer P6

Frame colour White, with top/drawer P2

Frame colour Storm Grey, with top/drawer P2



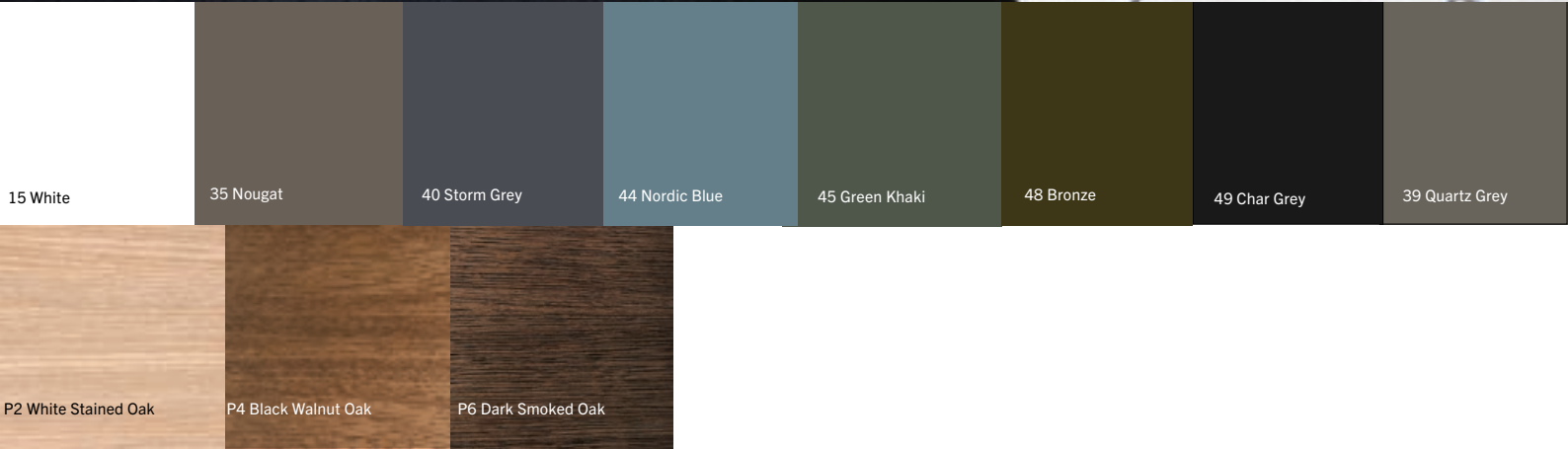

PALAIS COFFEE TABLES

By Anya Septon & Eva Lilja Löwenhielm 2018

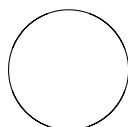
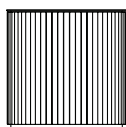

**Petit Palais
Side Table H:42**

H: 42 cm
Ø: 42 cm

Side and Coffee table with base in solid oak or ash panels. Top in veneer with a solid oak edge in the same colour as the base. Available in multiple colour options. The top is treated with polyurethane lacquer.
Extra weight in the base for stability.
Top: Stained veneer or Carrara Marble.
Base: Stained veneer.

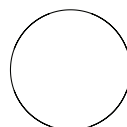
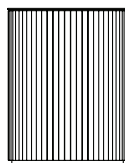

**Petit Palais
Side Table H:55**

H: 55 cm
Ø: 42 cm

Colour:
Natural Oak (PU1)
White Stained Oak (PU2)
White Stained Ash (APU2)
Teak Stained (APU7)
Dark Grey (APU8)
Dusty Pink (APU9)
Chestnut Stained (APU10)
Charcoal Stained (APU11)

Please note our stained finishes are applied by hand and may vary.

Laminate top on request.
For customized contract solutions, please contact us.

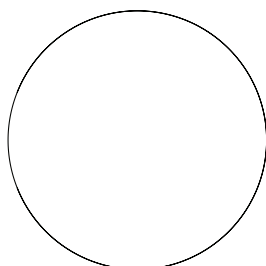
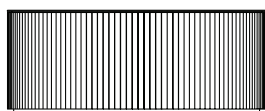

**Grand Palais
Coffee Table**

H: 37 cm
Ø: 92 cm

Coffee table with base in solid oak or ash panels. Top in veneer with a solid edge in the same colour as the base. Available in multiple colour options. The top is treated with polyurethane lacquer.
Extra weight in the base for stability.
Top: Stained veneer.
Base: Stained veneer.

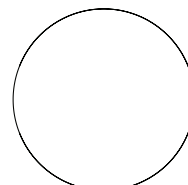
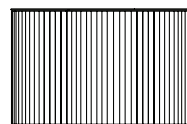

**Palais Bourbon
Coffee Table**

H: 42 cm
Ø: 65 cm

Coffee table with base in solid oak or ash panels. Top in veneer with a solid edge in the same colour as the base. Available in multiple colour options. The top is treated with polyurethane lacquer.
Extra weight in the base for stability.
Top: Stained veneer.
Base: Stained veneer.

ASPLUND



Grand Palais (White Stained Oak PU2)

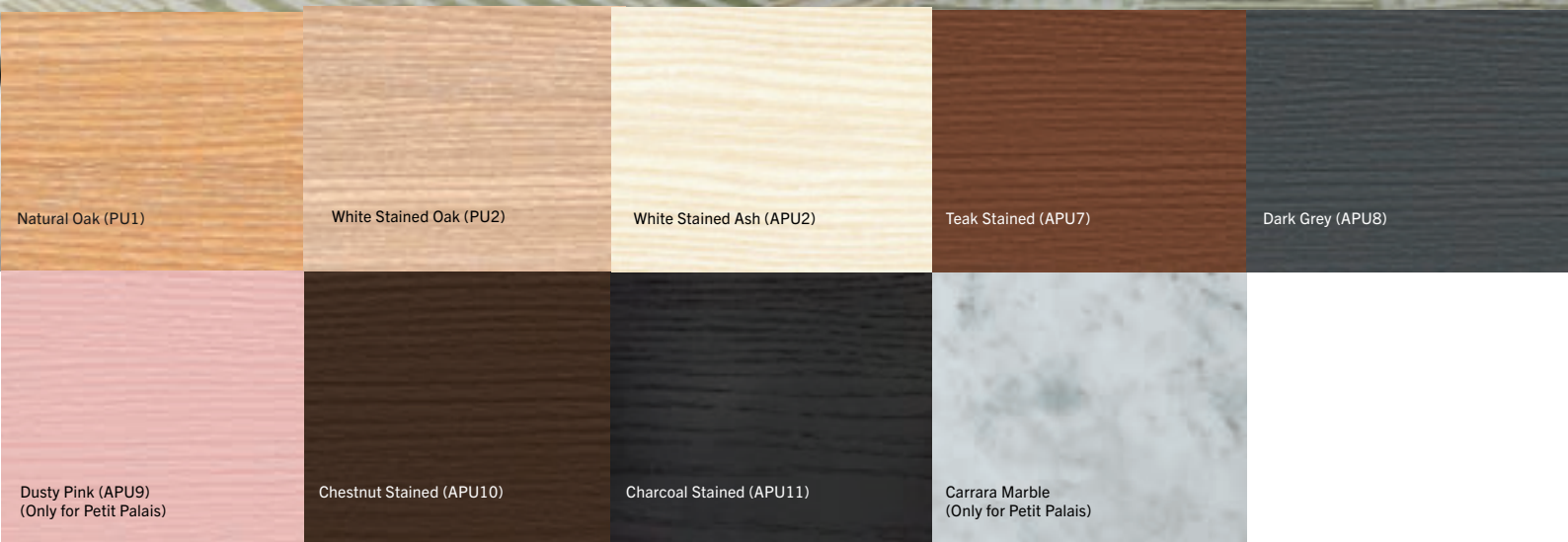

Natural Oak (PU1)

White Stained Oak (PU2)

White Stained Ash (APU2)

Teak Stained (APU7)

Dark Grey (APU8)

Dusty Pink (APU9)
(Only for Petit Palais)

Chestnut Stained (APU10)

Charcoal Stained (APU11)

Carrara Marble
(Only for Petit Palais)

PALAIS OVALE

By Anya Septon & Eva Lilja Löwenhielm 2018

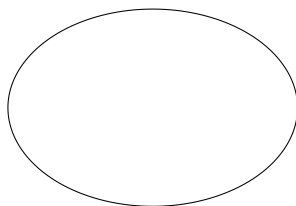
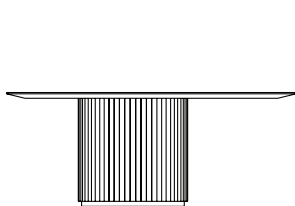

Palais Ovale
Coffee table

H: 43,5 cm
D: 75 cm & 110 cm
Base: Ø 42 cm

Oval coffee table with base in solid oak or ash panels. Top in veneer with a solid edge in the same colour as the base. Available in multiple colour options. The top is treated with polyurethane lacquer.
Extra weight in the base for stability. Delivered with base and top separately.

Colour:
Natural Oak (PU1)
White Stained Oak (PU2)
White Stained Ash (APU2)
Teak Stained (APU7)
Dark Grey (APU8)
Chestnut Stained (APU10)
Charcoal Stained (APU11)

Please note our stained finishes are applied by hand and may vary.

Laminate top on request.
For customized contract solutions, please contact us.

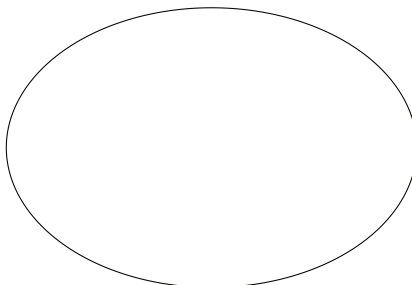
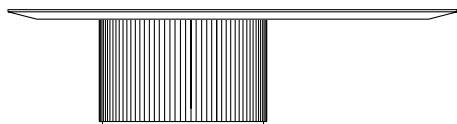

Palais Ovale Large
Coffee table

H: 43,5 cm
D: 102 cm & 150 cm
Base: Ø 53,5 cm

Oval coffee table with base in solid oak or ash panels. Top in veneer with a solid edge in the same colour as the base. Available in multiple colour options. The top is treated with polyurethane lacquer.
Extra weight in the base for stability. Delivered with base and top separately.

ASPLUND



Palais Ovale (White Stained Oak PU2)

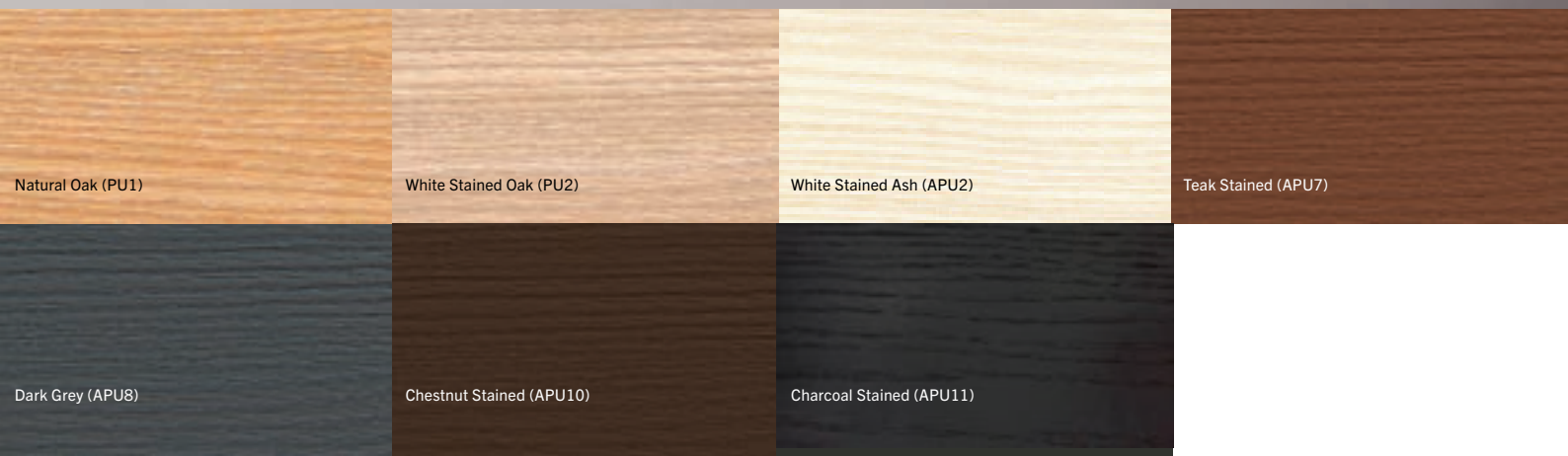

PALAIS ROYAL

By Anya Sebton & Eva Lilja Löwenhielm 2018

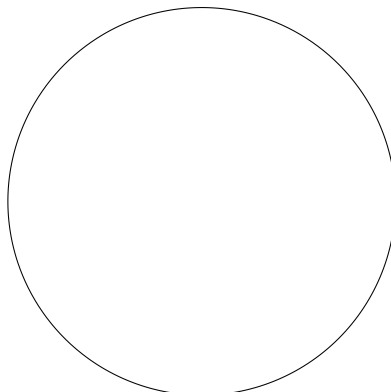
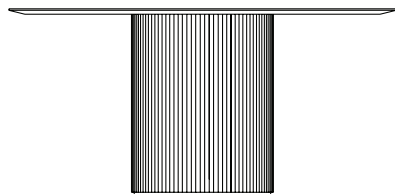

**Palais Royal Large
Dining**

H: 73 cm
Top: Ø 150 cm
Base: Ø 53,5 cm

Round table with base in solid oak or ash panels. Top in veneer with a solid edge in the same colour as the base. Available in multiple colour options. The top is treated with polyurethane lacquer.
Extra weight in the base for stability. Delivered with base and top separately.

Colour:
Natural Oak (PU1)
White Stained Oak (PU2)
White Stained Ash (APU2)
Teak Stained (APU7)
Dark Grey (APU8)
Chestnut Stained (APU10)
Charcoal Stained (APU 11)

Please note our stained finishes are applied by hand and may vary.

Laminate top on request.
For customized contract solutions, please contact us.

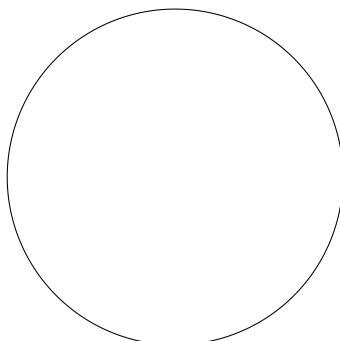
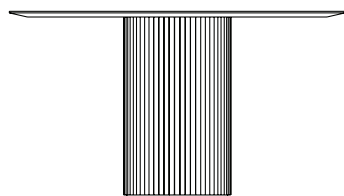

**Palais Royal
Dining**

H: 73 cm
Top: Ø 130 cm
Base: Ø 42 cm

Round table with base in solid oak or ash panels. Top in veneer with a solid edge in the same colour as the base. Available in multiple colour options. The top is treated with polyurethane lacquer.
Extra weight in the base for stability. Delivered with base and top separately.

Cable solution available with cognac leather top.

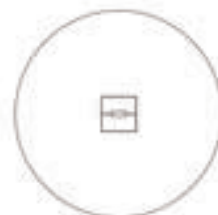

ASPLUND



Palais Royal (Teak Stained APU7)

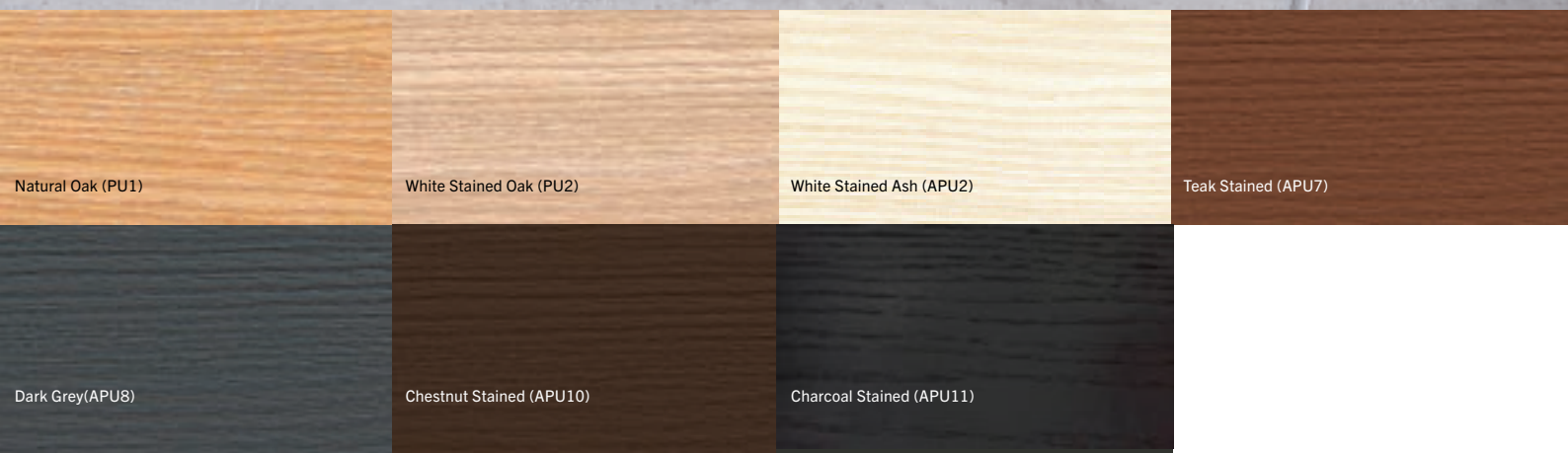

Natural Oak (PU1)

White Stained Oak (PU2)

White Stained Ash (APU2)

Teak Stained (APU7)

Dark Grey (APU8)

Chestnut Stained (APU10)

Charcoal Stained (APU11)

PALAIS MEGA

By Anya Sebton & Eva Lilja Löwenhielm 2018

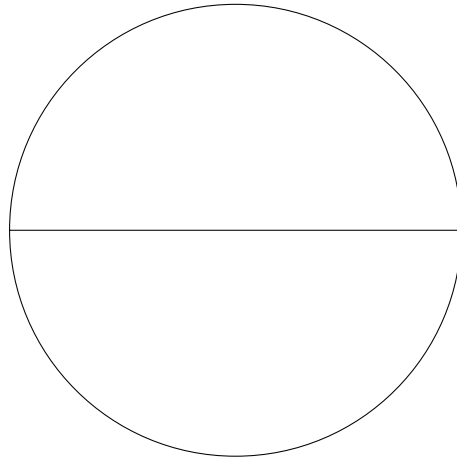
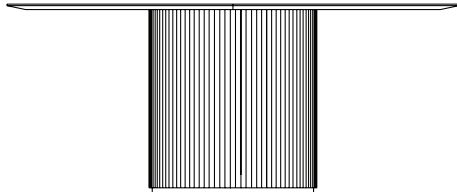

Colour:
Natural Oak (PU1)
White Stained Oak (PU2)
White Stained Ash (APU2)
Teak Stained (APU7)
Dark Grey (APU8)
Chestnut Stained (APU10)
Charcoal Stained (APU11)

Please note our stained finishes are applied by hand and may vary

For customized contract solutions, please contact us..

Palais Mega 175 Dining

H: 73 cm
Top: Ø 175 cm
Base: Ø 65 cm

Round table with base in solid oak or ash panels. Top in veneer with a solid edge. Available in multiple colour options. The top is coated with polyurethane lacquer. Extra weight in the base for stability. Delivered with base and top separately. Note that the top is divided and delivered in two parts.

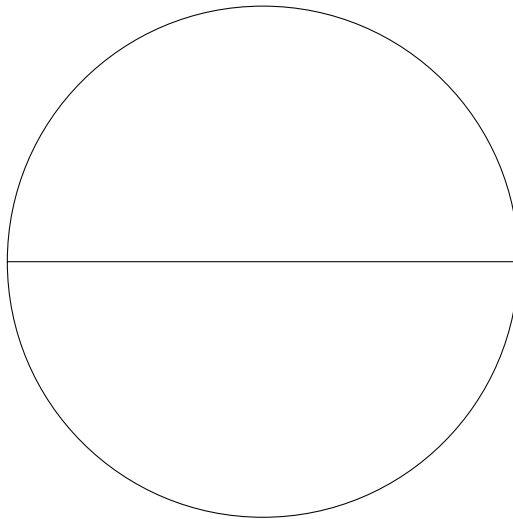
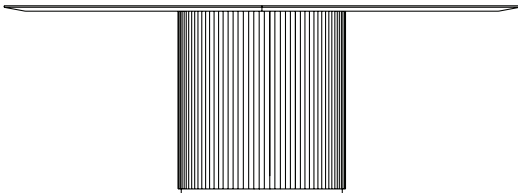

Palais Mega 200 Dining

H: 73 cm
Top: Ø 200 cm
Base: Ø 92 cm

Round table with base in solid oak or ash panels. Top in veneer with a solid oak edge. Available in multiple colour options. The top is coated with polyurethane lacquer. Extra weight in the base for stability. Delivered with base and top separately. Note that the top is divided and delivered in two parts.

Cable solution available with cognac leather top.

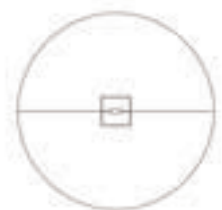

ASPLUND



Palais Mega (White Stained Oak PU2)

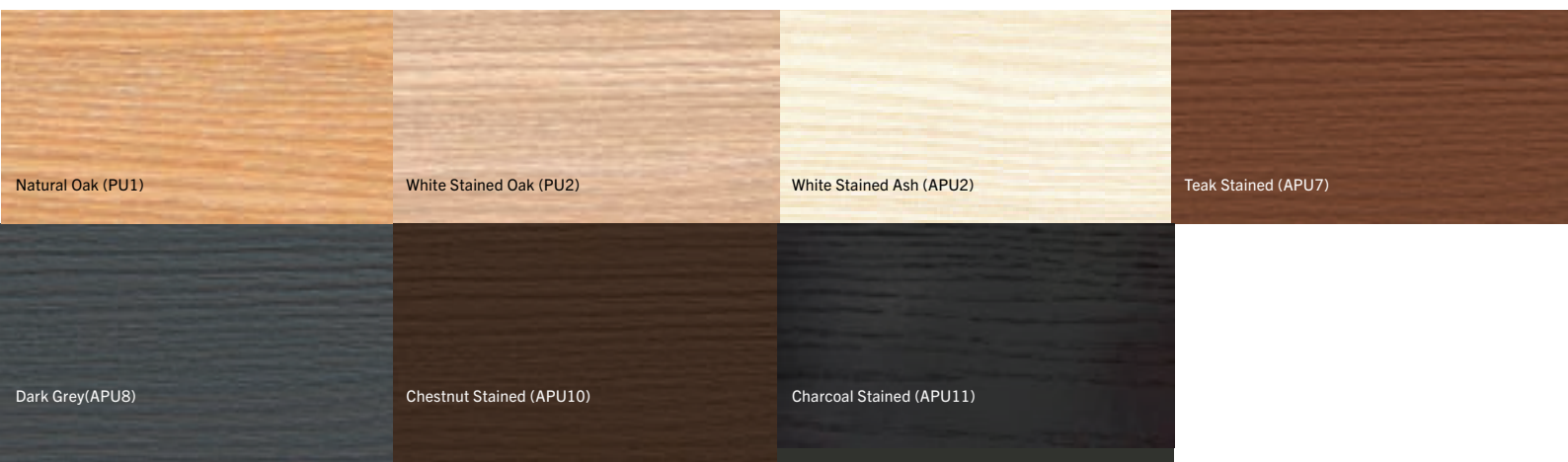

MOCI TABLE

By Moa Sjöberg 2021

Moci is a handcrafted and generous table for dining and or conference purposes made with solid oak legs and an oak veneer top.

In 2022 the MOCI Dining Table has been awarded:

- **FURNITURE OF THE YEAR** by RUM (Sweden)
- **GOOD DESIGN®** award (Chicago)



Colour:

Natural (PU1)

White Stained (PU2)

Chestnut Stained (APU10)

Please note our stained finishes are applied by hand and may vary.

Cable solutions on request.



Moci Table

H: 72 cm

W: 95 cm

L: 240 cm



Moci Table Large

H: 72 cm

W: 95 cm

L: 280 cm

ASPLUND



Moci Dining Table I (Chestnut Stained APU10)

Natural (PU1)

White Stained (PU2)

Chestnut Stained (APU10)

TATI DINING TABLES

By Broberg & Ridderstråle 2012

Series of dining tables with a bent metal structure.

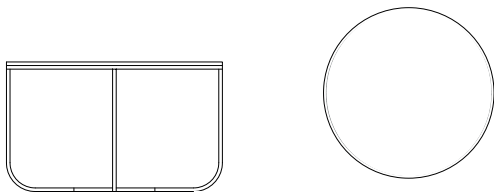

Tati Dining Table Round Ø120

ø: 120 cm

H: 72 cm*

Round table with lacquered metal frame.

Top:

Stone: Carrara Marble, Jura Limestone, Pietra Grey, Elegant Grey, Nero Marquina

*Adjustable feet will add from 0,5 cm to the height.

Delivered fully assembled. Stone top separate.

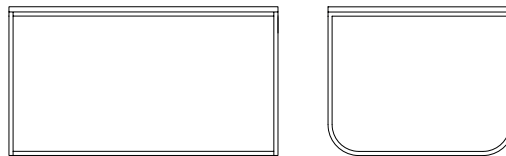

Tati Dining Table 140

H: 72 cm*

D: 85 cm

W: 140 cm

Rectangular table with lacquered metal frame.

Top:

Stone: Carrara Marble, Jura Limestone, Pietra Grey, Elegant Grey, Nero Marquina
Oak: White Stained Oak (PU2), Black Walnut Oak (PU4)

*Adjustable feet will add from 0,5 cm to the height.

The oak top comes with a clear protective top coat of polyurethane lacquer.

Frame and top are delivered unassembled in flat pack.

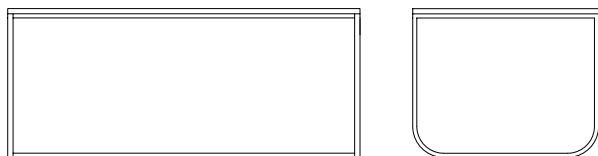

Tati Dining Table 200

H: 72 cm*

D: 85 cm

W: 200 cm

Dining or work table with a frame in lacquered metal and a table top in selected oak veneer.

Top:

White Stained Oak (PU2)

Black Walnut Oak (PU4)

*Adjustable feet will add from 0,5 cm to the height.

The oak top comes with a clear protective top coat of polyurethane lacquer.

Frame and top are delivered unassembled in flat pack.

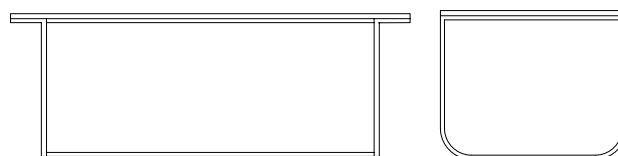

Tati Dining Table 200 (retracted stand)

H: 72 cm*

D: 85 cm

W: 200 cm

Dining or work table with a frame in lacquered metal and a table top in selected oak veneer with an overhang of 29 cm on each short side.

Top:

White Stained Oak (PU2)

Black Walnut Oak (PU4)

*Adjustable feet will add from 0,5 cm to the height.

The oak top comes with a clear protective top coat of polyurethane lacquer.

Frame and top are delivered unassembled in flat pack.

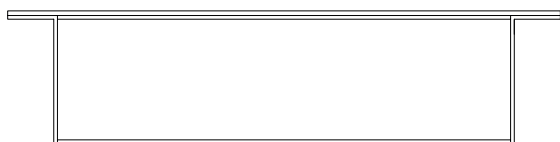

Tati Dining Table 260 (retracted stand)

H: 72 cm*

D: 85 cm

W: 260 cm

Dining or work table with a frame in lacquered metal and a table top in selected oak veneer with an overhang of 29 cm on each short side.

Top:

White Stained Oak (PU2)

Black Walnut Oak (PU4)

*Adjustable feet will add from 0,5 cm to the height.

The oak top comes with a clear protective top coat of polyurethane lacquer.

Frame and top are delivered unassembled in flat pack.

Frame colours:

15 White

35 Nougat

39 Quartz Grey

40 Storm Grey

44 Nordic Blue

45 Green Khaki

48 Bronze

49 Char Grey

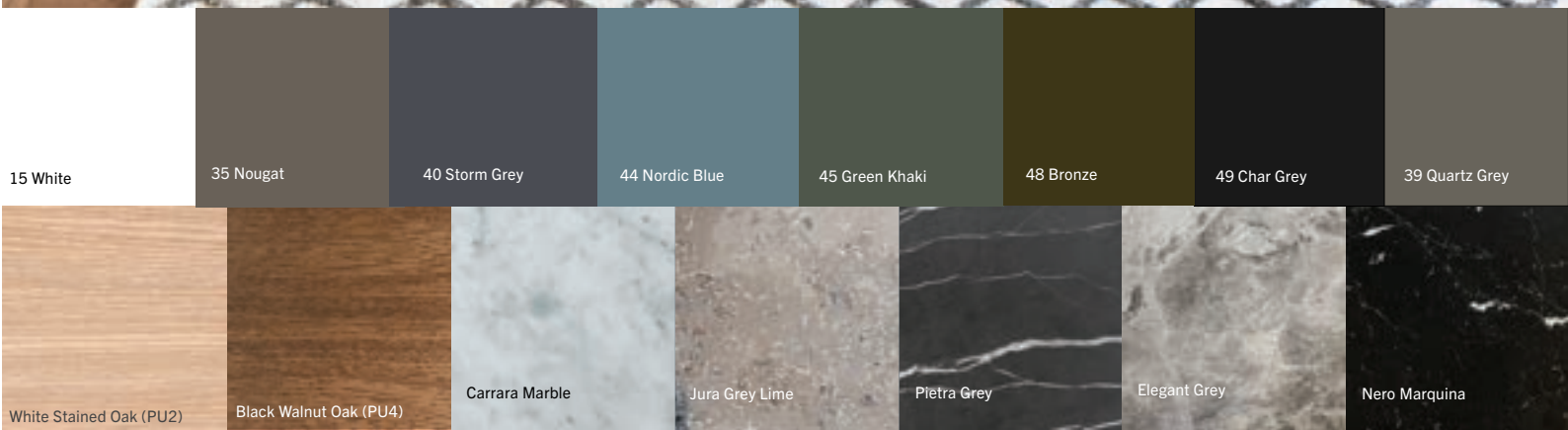

BERMUDA

By Thomas Eriksson 2006

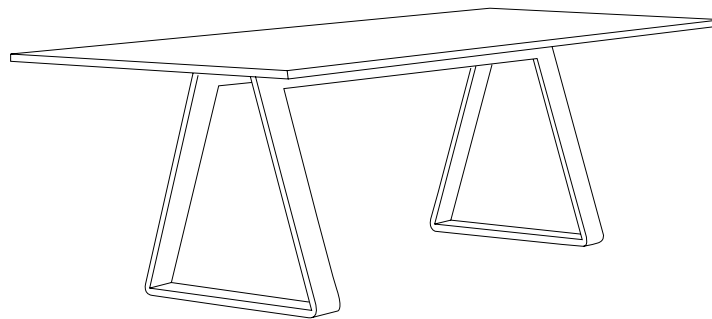

Colour:
15 White

Top:
Color core laminate
Other colour combinations, laminates
and cable solutions on request.

Bermuda Table

H: 72 cm
D: 90 cm
W: 200 cm

Table with a lacquered metal stand and top with Color Core Laminate and polyurethane lacquered edges and underside. Delivered in flat pack.
Stands: W = 10 cm each. Bermuda Table 200 x 90 cm and 240 x 90 cm: the open space between the stands is 130 cm wide.
Bermuda Table 280 x 90 cm: the open space between the stands is 170 cm wide.

H: 72 cm
D: 90 cm
W: 240 cm

Red Dot Award winner 2006.

H: 72 cm
D: 90 cm
W: 280 cm



VASS DESK

By Claesson Koivisto Rune 2007

Desk with one hidden drawer.

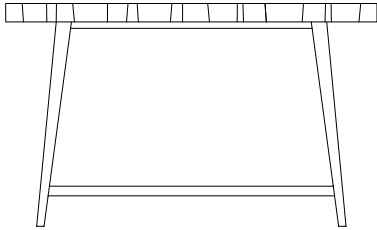

Vass Desk

H: 72 cm

D: 60 cm

B: 120 cm

Top in oak veneer and stand in solid oak.

Colours:

P4 - Black Walnut Oak

P6 - Dark Smoked Oak



ASPLUND



Vass Desk (P4 Black Walnut Oak)

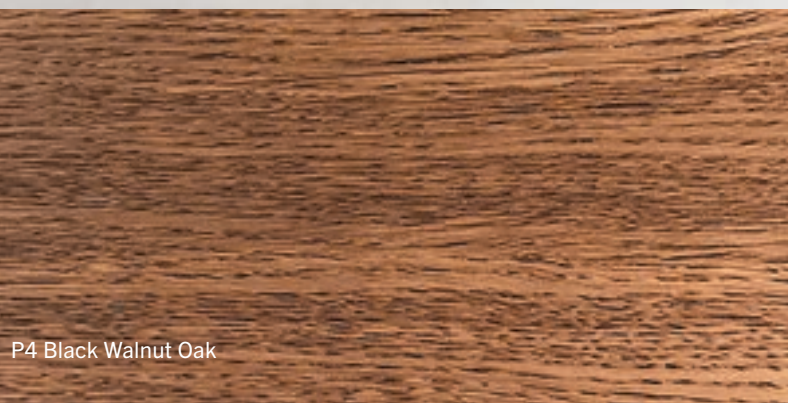

P4 Black Walnut Oak

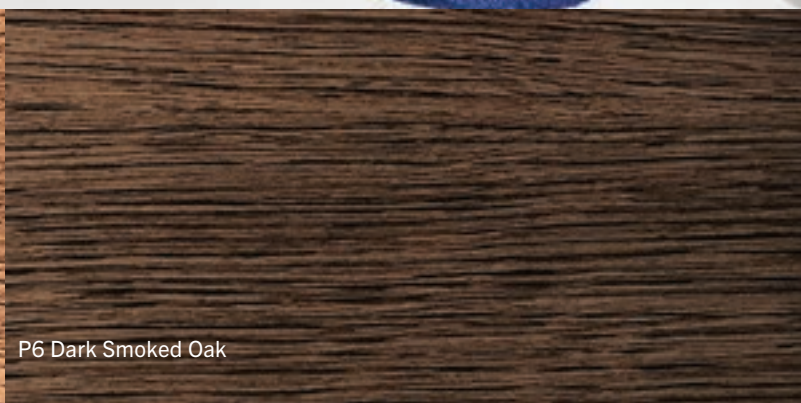

P6 Dark Smoked Oak

OBLIQUE COFFEE TABLE

By Claesson Koivisto Rune 2018

Coffee table available in two sizes with square steel rod and a thin metal plate top.

Colour:
48 Bronze

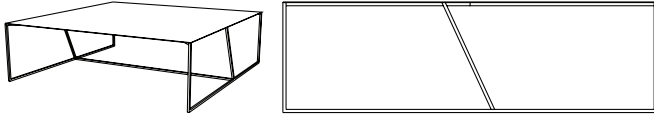

Oblique Square Coffee Table

H: 35 cm
W: 118 cm
D: 118 cm

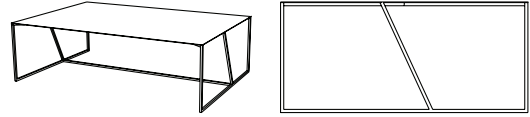

Oblique Rectangular Coffee Table

H: 35 cm
W: 118 cm
D: 78 cm

OBLIQUE DESK / SIDETABLE

By Claesson Koivisto Rune 2018

Colour:
48 Bronze

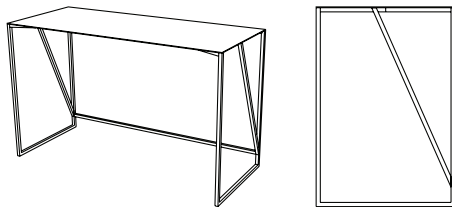

Oblique Desk

H: 72 cm
W: 118 cm
D: 50 cm

Desk with square steel rod and a thin metal plate top.

ASPLUND



Oblique Rectangular Coffee Table

PAGODA

By Broberg & Ridderstråle 2018

Floor standing shelving system with a lacquered metal structure and shelves in lacquered oak.

Colours:
Nougat 35
Green Khaki 45
Char Grey 49

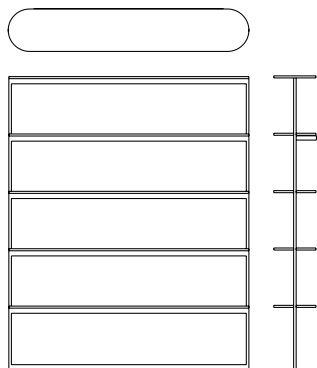

Pagoda 140:5

H: 171 cm
W: 140 cm
D: 26 cm

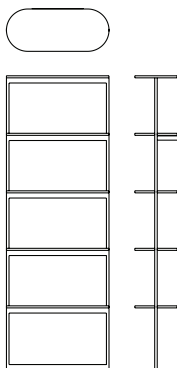

Pagoda 60:5

H: 171 cm
W: 60 cm
D: 26 cm

Wall shelf units, Pagoda 140:5 and Pagoda 60:5 with 5 shelves.
Floor standing with wall attachment.
Wall screws are not included.

ASPLUND



Pagoda 140:5 & 60:5 (Nougat)



35 Nougat

45 Green Khaki

49 Char Grey

P5 Nougat lacquered Oak

P5 Green Khaki lacquered Oak

P5 Char Grey lacquered Oak

BELLE

By Broberg & Ridderstråle 2016

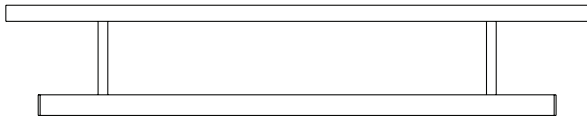

Belle Coat Rack 90

H: 17 cm
W: 90 cm
D: 31 cm

Belle Coat Rack 120

H: 17 cm
W: 120 cm
D: 31 cm

Coat rack in lacquered metal with a leather wrapped rail.
Top shelf in oak veneer.
(screws for attachment to wall not included)

Colour options:

1. White with cognac leather and top in Black Walnut oak (P4)
2. Char Grey with cognac leather and top in Black Walnut oak (P4)
3. Green Khaki with cognac leather and top in Black Walnut oak (P4)



Belle Shoe plate 90

H: 3 cm
W: 90 cm
D: 31 cm

Belle Shoe plate 120

H: 3 cm
W: 120 cm
D: 31 cm

Rectangular shoe plate in lacquered metal.
Insert in natural coconut fibre.

Colour of frame:

White, Char Grey or Green Khaki

All colour combinations above are available on
Quick Ship (From our warehouse in 1-2 weeks).



Belle Coat Rack (Green Khaki)



Cognac

Cognac

Cognac

15 White

45 Green Khaki

49 Char Grey

Black Walnut Oak (P4)

Black Walnut Oak (P4)

Black Walnut Oak (P4)

TATI COAT RACK

By Broberg & Ridderstråle for 2011

Colours:
15 White
35 Nougat
39 Quartz Grey
40 Storm Grey
44 Nordic Blue
45 Green Khaki
48 Bronze
49 Char Grey

Stone:
Carrara Marble
Nero Marquina
Jura Limestone
Pietra Grey
Elegant Grey

Hooks and knobs are sold separately

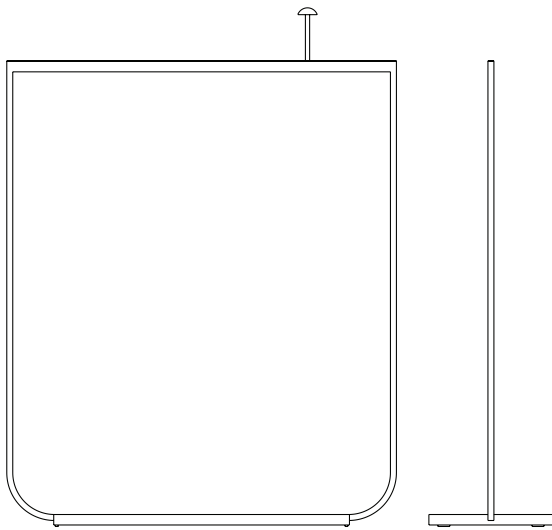

Tati Coat Rack Large 130

H: 155 cm
W: 130 cm
D: 41 cm

Floor standing coat hanger/rack in metal with brass details and stone base.

Structure: Metal.

Base / Insert: Stone.

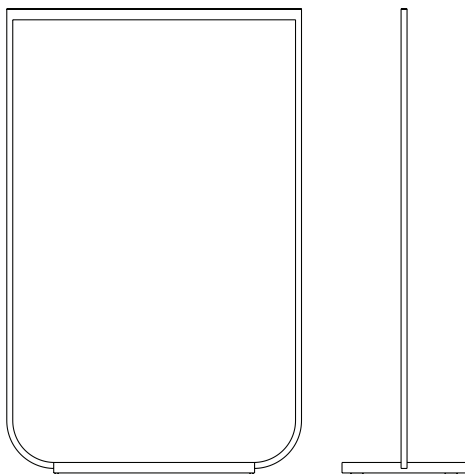

Tati Coat Rack Small 100

H: 155 cm
W: 100 cm
D: 41 cm





Floor standing coat hanger/rack in metal with brass details and stone base.

Structure: Metal

Base / Insert: Stone

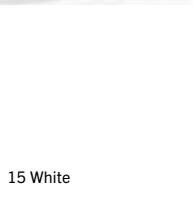

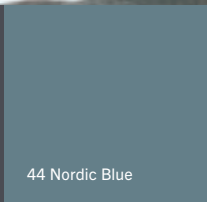
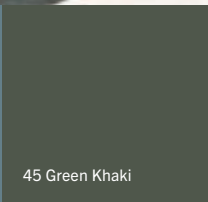
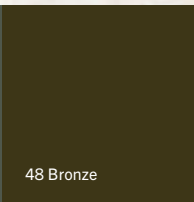
Tati Coat Rack Large (Char Grey)

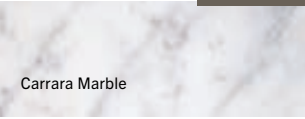
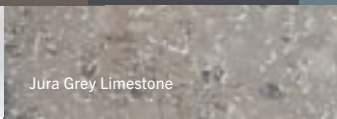
							
15 White	35 Nougat	40 Storm Grey	44 Nordic Blue	45 Green Khaki	48 Bronze	49 Char Grey	39 Quartz Grey
							
Carrara Marble	Jura Grey Limestone	Pietra Grey	Elegant Grey	Nero Marquina			

TATI MIRROR

By Broberg & Ridderstråle for 2011

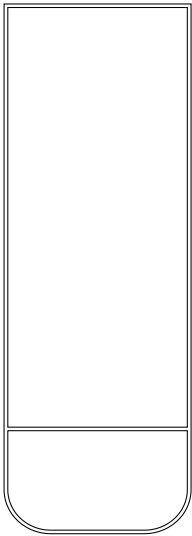

Tati Mirror Large

H: 180 cm

W: 60 cm

D: 5 cm (distance from wall)

Wall mounted or floor standing mirror.

Fram: Lacquered metal.

- Colours:
- 15 White
 - 35 Nougat
 - 39 Quartz Greyv
 - 40 Storm Grey
 - 44 Nordic Blue
 - 45 Green Khaki
 - 48 Bronze
 - 49 Char Grey

The colours 15 White and 49 Char Grey are available on Quick Ship (From our warehouse in 1-2 weeks).



15 White

49 Char Grey

40 Storm Grey

35 Nougat

45 Green Khaki

48 Bronze

39 Quartz Grey

44 Nordic Blue

ASPLUND



Tati Mirror Large (Char Grey)

OTTO MIRROR

By Anya Septon & Eva Lilja Löwenhielm 2016

Round mirror with a horizontal metal shelf.

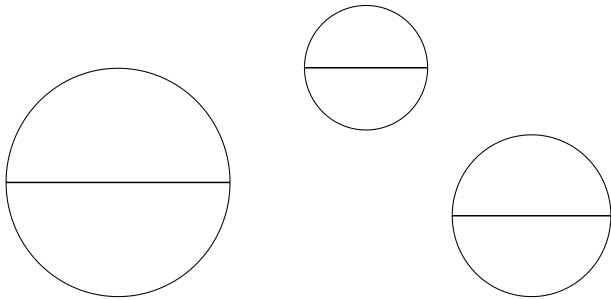

OTTO Mirror Round Ø 110 :
Ø: 110 cm
D: 12 cm (Shelf included)

OTTO Mirror Round Ø 80 :
Ø: 80 cm
D: 10 cm (Shelf included)

OTTO Mirror Round Ø 60 :
Ø: 60 cm
D: 10 cm (Shelf included)

Shelf and backside in colour.

Available Colour Options

Option 1: Char Grey Structure, Smoked Mirror.

Option 2: Bronze Structure, Bronze Mirror.

Option 3: Green Khaki Structure, Clear Mirror.

ASPLUND



Otto Mirror Ø 110 (Frame and shelf in Char Grey)

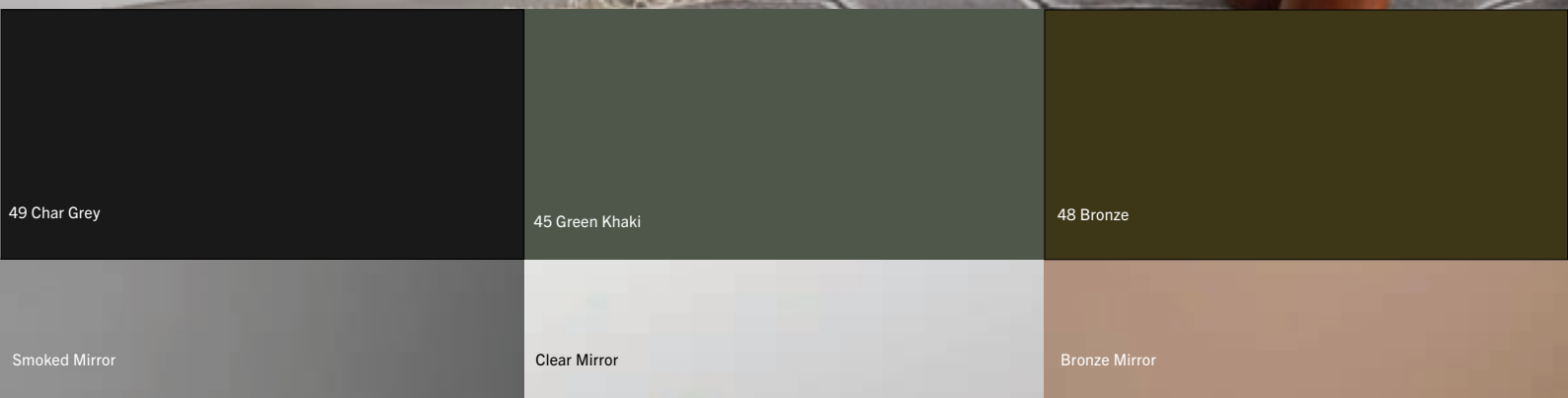

49 Char Grey

45 Green Khaki

48 Bronze

Smoked Mirror

Clear Mirror

Bronze Mirror

ASPLUND - FURNITURE CARE/MAINTENANCE

MAINTENANCE OF WOOD MATERIALS

Wood is a living material, making each part unique. Solid wood, veneer or lacquered MDF can be cleaned with a soft cloth, plain water and soap or mild detergent. Be aware and wipe up liquids on surfaces immediately. With more extensive stains on wood and veneer you can sand lightly with very fine sandpaper in the direction of the wood veins. Note that veneers can be as thin as 0.6 mm. Wood furniture treated with clear, matte or coloured polyurethane or acid-curable paint should not be sanded since the lacquered surface becomes easily scratched and destroyed. Waxed, dyed or oiled surfaces treated with colour pigmentation can also lose pigments and be affected if an area is sanded or taken care of incorrectly. If sanding surfaces is necessary, please do so carefully and on your own risk or contact a professional carpenter. Sun, moisture and everyday wear affect the natural protection of the material.

We recommend using Osmo maintenance wax regularly and a few times each year to treat and care for our wooden furniture. In case of an accident, we have a small bottle of water-based paint for our painted MDF and wood furniture in all standard colours that you easily can order from us at Asplund, directly online. Carefully read and follow the attached instructions for each treatment and cleaning agent.

MAINTENANCE OF LAMINATES

Clean laminated surfaces with water and mild detergents. When removing less severe stains, we recommend liquids or agents that does not contain abrasive substances. Stubborn stains and discoloured areas can most often be removed by gently using slightly stronger detergent cleaners. However, steel wool, scouring sponges or strong abrasive cleaners should never be used. Ink and tumbler marks from bullet and felt pens can be removed with a suitable solvent (eg alcohols, acetone, etc.) on a clean cloth. Organic solvents such as mineral turpentine and cellulose thinner can also be used to remove paint stains because they do not affect the laminate surface.

After using detergent, rinse the surface with clean water and dry with a soft cloth. There are a number of window cleaners on the market that can be used to prevent or remove rings and stripes from the surface after cleaning, with excellent results. Furniture polish should not be used because deposits of silicone wax on the surface can cause discolouration and stripes that can be very difficult to remove. Surfaces with heavy structure or matte surfaces are more difficult to clean than surfaces that are flat or easily structured. Stains and marks on structured surfaces can be removed with nylon brush and any of the cleaning agents listed above. Carefully read and follow the attached instructions for each treatment and cleaning agent.

MAINTENANCE OF METALS

Primarily clean metals with plain water and mild detergents and afterward wipe off any moisture so the surface is dry. When brushing and polishing different types of metals, Glanol, Håxans, Autosol or Bistro is recommended agents. Untreated metals should be polished regularly to maintain quality and luster. Metals naturally get a patina over time. Painted and coated metals should not be polished with abrasive cleaners. Carefully read and follow the attached instructions for each treatment and cleaning agent.

MAINTENANCE OF STONES

Stones are cleaned smoothly with a damp cloth and very mild detergent. Be aware and wipe up liquids on surfaces immediately. Marble and limestone are porous materials and can not handle acidic fluids with a pH below 7 such as wine, fruit juice, carbonic acid, vinegar and acidic cleaners. The acids do not affect the stone's strength, but causes cosmetic damage. When cleaning we recommend Akemi Triple Effect or soap and water. For extra protection and impregnation Akemi Nano Effect is used. A stone slab with a matte surface can be treated with a stone wax or stone oil as the surface becomes very dirt and grease-proof. The treatment with oil causes the stone to darken, where excess oil is dried off immediately. Carefully read and follow the attached instructions for each treatment and cleaning agent.

MAINTENANCE OF LEATHERS

All leathers are unique and needs to be lubricated regularly with a conditioner, leather oil or leather fat so it does not dry out and to get the longest life expectancy. Wearing, sunlight and fluids affect the natural protection of the leather. Aniline and semi-aniline leather need some more care and maintenance compared to a completely pigmented or protected leather. In case of any stains the material can be cleaned with a slightly damp cloth and a special gall or leather soap and then treated with a moisturizing agent. When you lubricate or moisturize a leather upholstery it can become noticeably darker and to achieve a beautiful patina it is important to take good care of the leather. Do not rub during cleaning and never use gasoline and cleaning solutions, alkaline and acidic cleaning agents or abrasives. Carefully read and follow the attached instructions for each treatment and cleaning agent.

MAINTENANCE OF GLASS

Glass should be cleaned with cleaning equipment that is free of gravel and debris, to avoid scratching the glass surface. Only recommended detergents suitable for cleaning glass should be used. Gentle detergents are preferred. Do not clean glass when warm or in direct sunlight. Abrasive cleaners, powder-based cleaners, scouring powder or other strong agents should never be used to clean glass. Carefully read and follow the attached instructions for each treatment and cleaning agent.

We reserve the right for any printing errors and changes without prior notice. The last updated version is always in our Dropbox.

