



621F and 627F Exit Device Trim Installation Instructions

**For use with all Yale® 7000, 2100,
1800 and 1500 Series Exit Devices
(Wood and Metal Doors)**

⚠ WARNING
This product can expose you to lead which is known to the state of California to cause cancer and birth defects or other reproductive harm. For more information go to www.P65warnings.ca.gov.
08/2018

Attention Installer

Installation of cylindrical locks and latches must be through bolted in all doors. If installation instructions are not followed this may result in damage to the lock and void the factory warranty.
Any retrofit or other field modification to a fire rated opening can potentially impact the fire rating of the opening, and Yale Locks & Hardware makes no representations or warranties concerning what such impact may be in any specific situation. When retrofitting any portion of an existing fire rated opening, or specifying and installing a new fire-rated opening, please consult with a code specialist or local code official (Authority Having Jurisdiction) to ensure compliance with all applicable codes and ratings.

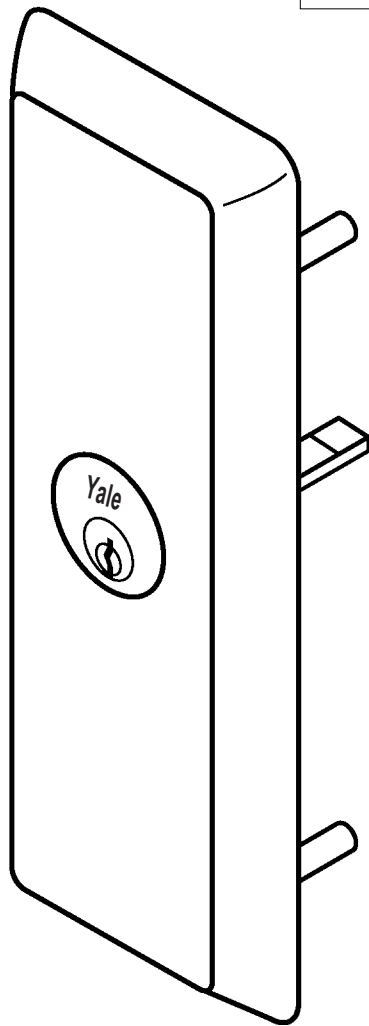

**621F Series
Nightlatch Function Trim
Non-Handed**

* Represents prefix letter(s) for various lever designs.

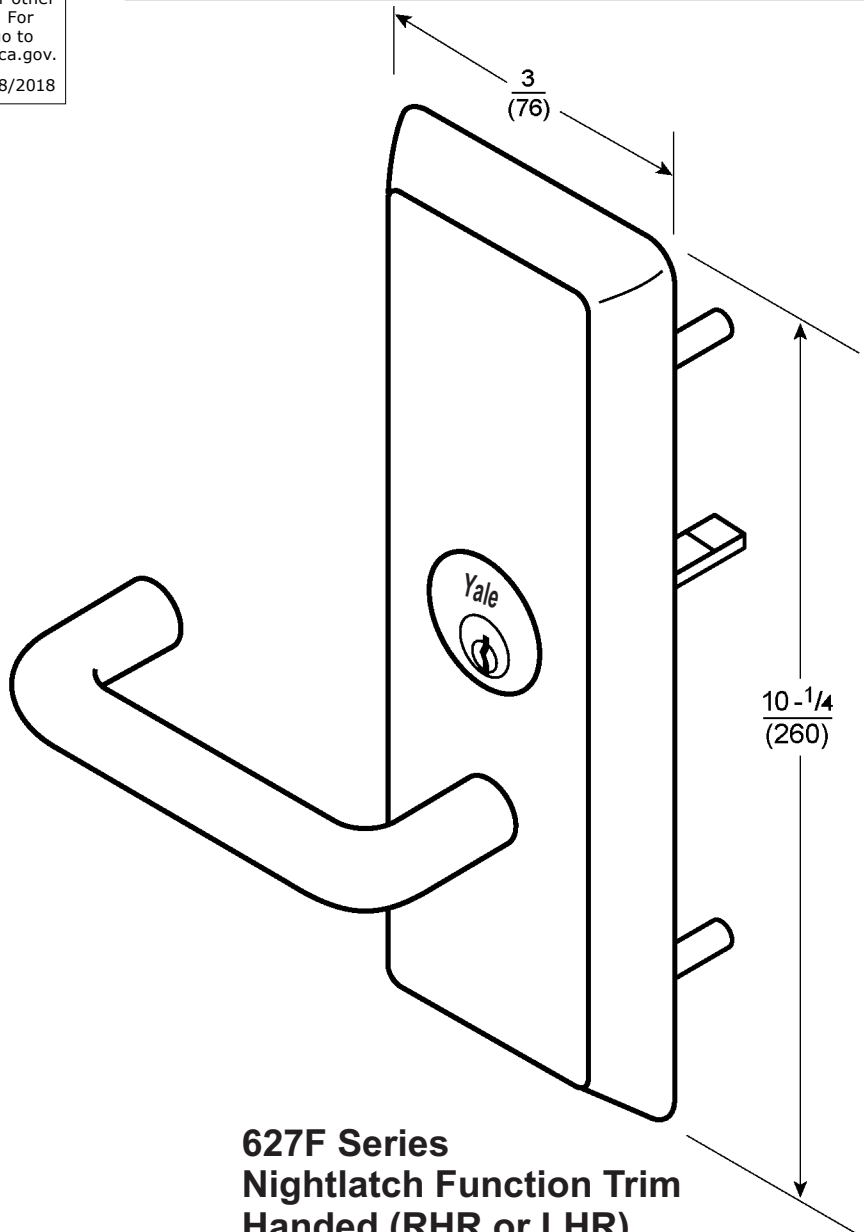

**627F Series
Nightlatch Function Trim
Handed (RHR or LHR)
Free-Wheeling Lever**



Trim Assembly Instructions

1. Check cylinder components.

NOTE: Cylinders longer than 1-1/8" (29) will require collars. Refer to Yale® cylinder collar chart.

2. Assemble cylinder.

Insert cylinder housing prongs into matching notches of escutcheon. Pass cylinder tailpiece thru cylinder collar (when required) and hole in cylinder housing. Fasten cylinder using (2) mounting screws. DO NOT OVERTIGHTEN SCREWS.

Yale® Cylinder Collar Chart

Cylinder Length	Collar
1-1/8" (29)	None
1-1/4" (32)	**
1-1/2" (38)	**

** Specify finish

621F Nightlatch Trim

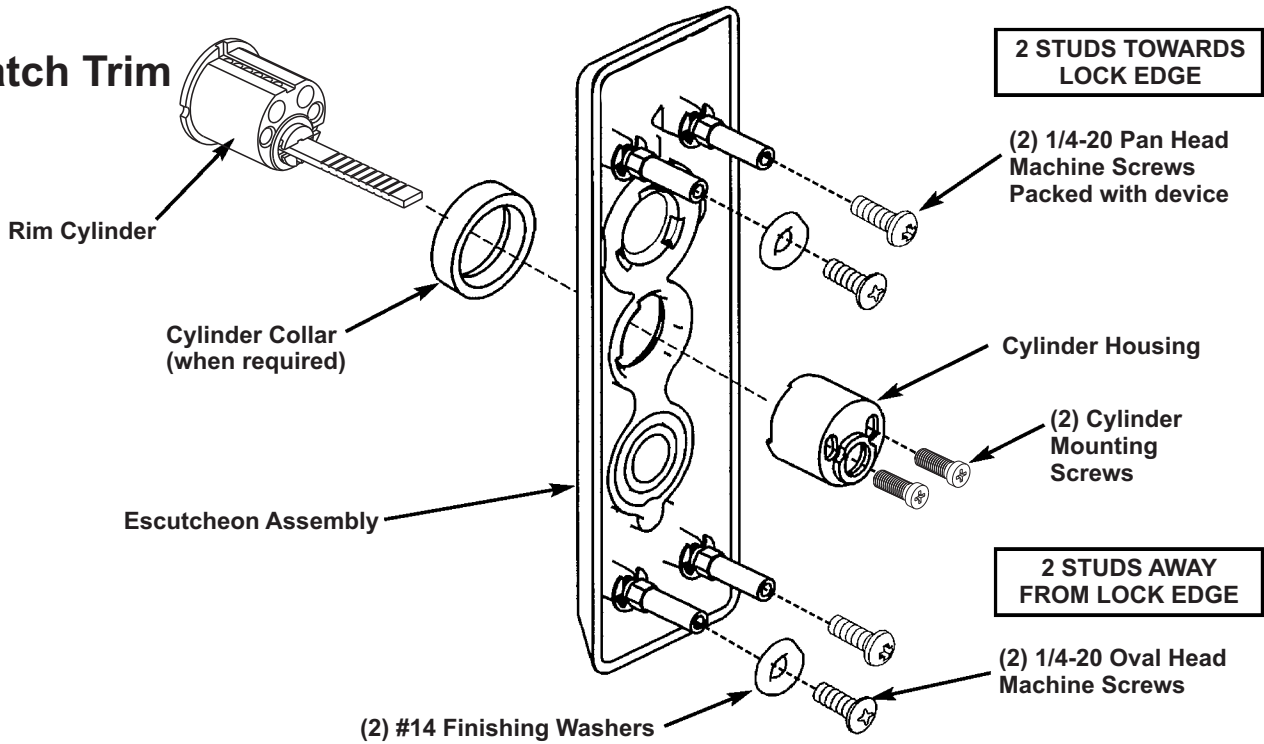

627F Nightlatch Trim

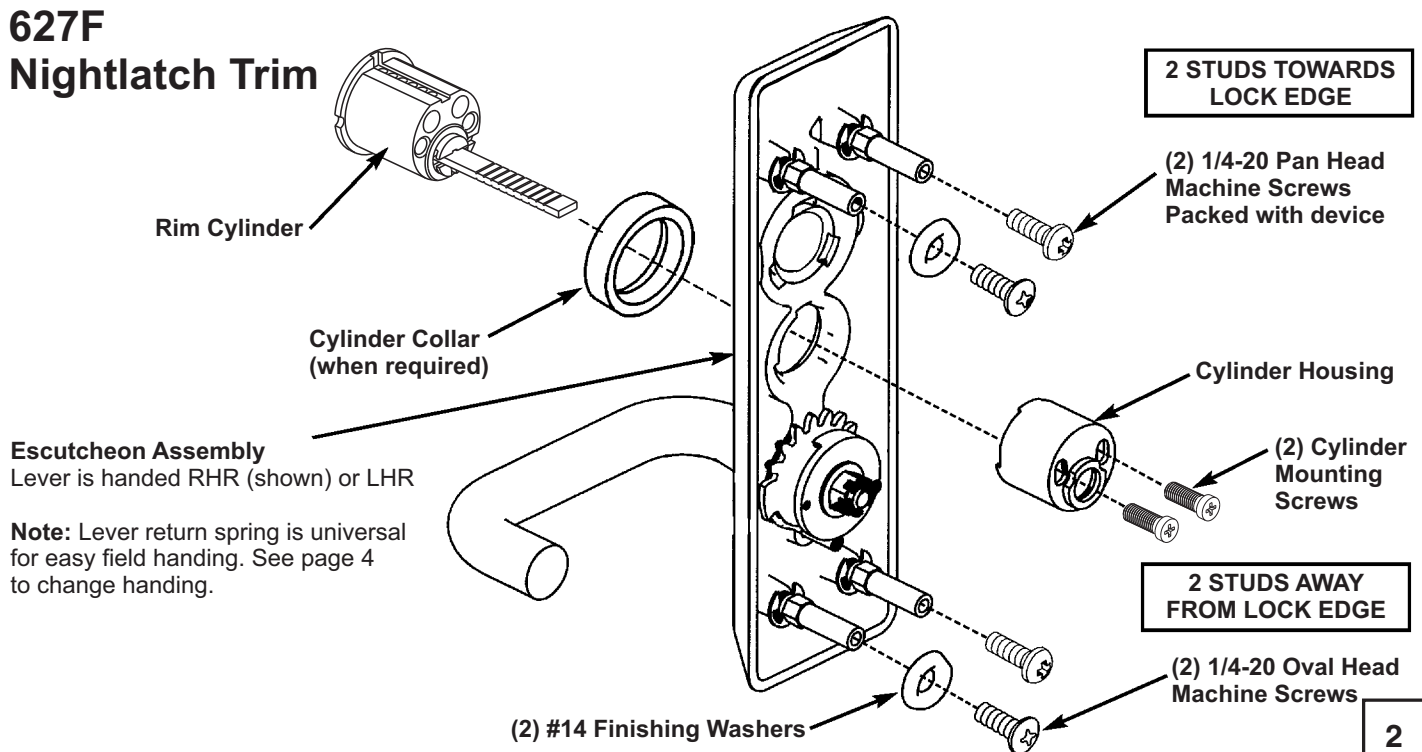

Escutcheon Assembly

Lever is handed RHR (shown) or LHR

Note: Lever return spring is universal for easy field handing. See page 4 to change handing.

Installation Instructions

1. Check box for contents. See previous page for components.
2. After marking door inside face for device location (Device Instructions), transfer Vertical Reference Centerline from inside to outside door face. Follow steps 2a. and 2b. below.

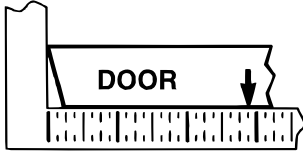

2a. MEASURE INSIDE LINE LOCATION.

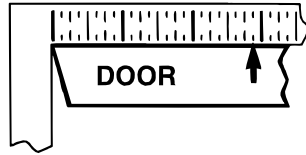

2b. TRANSFER DIMENSION TO OUTSIDE FACE.

3. Transfer Horizontal Reference Centerline from inside to outside door face.

4. Align trim template and tape to outside door face.
5. Spot holes and prepare door for trim.
6. Mount trim to door thru holes "B". Fasten finger tight only with (2) screws and washers seating on door as shown in Fig. 1.
7. Cut trim tailpiece as shown in Figure 2.
8. Seat device so that the trim tailpiece penetrates the cam slot as shown in Figure 1. Continue as shown in the device instructions.

Figure 1

Device is bolted to trim using holes 'A' (closest to door lock edge)

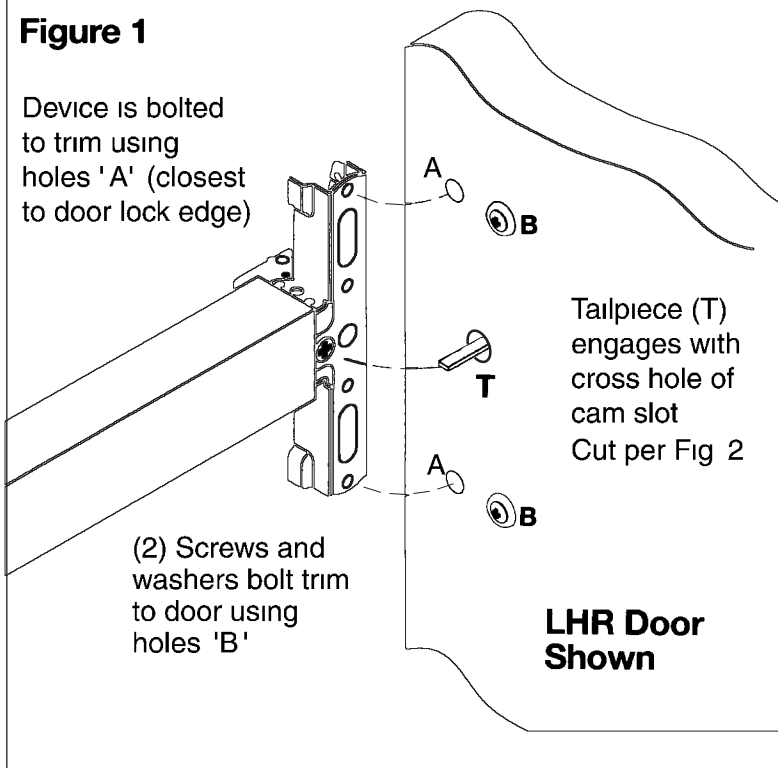

Figure 2

Device Mounting Surface (See Note)

Trim Tailpiece

Hold $\frac{5}{16}$ (8)

Cut Line

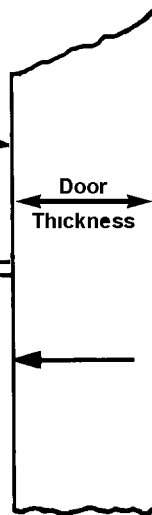

NOTE: Measure from device mounting surface (door face or shim surface)

To Change Hands:

Tools Needed: Needle Nose pliers, Crescent wrench.

LEFT HAND REVERSE

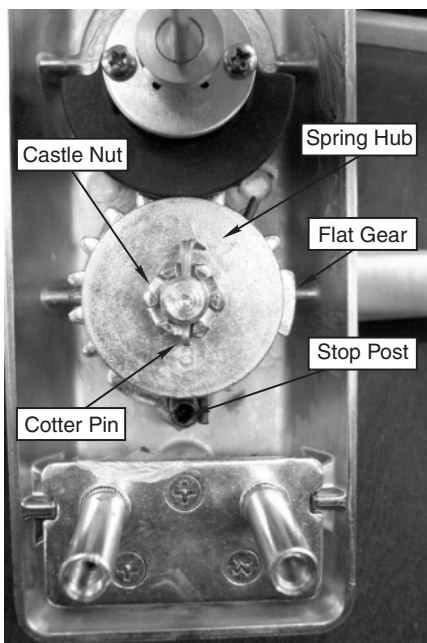

RIGHT HAND REVERSE

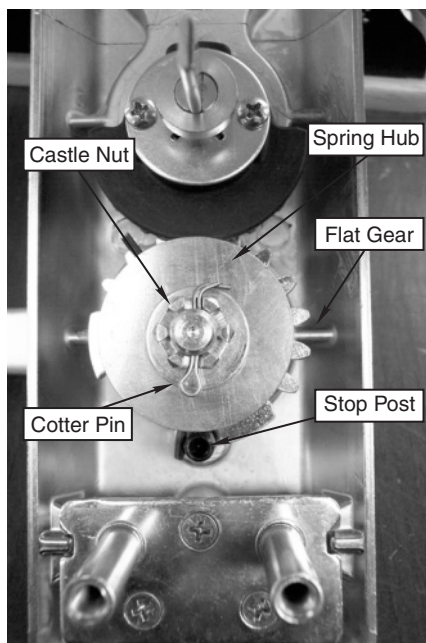

Notch for spring to engage for left hand reverse operation



Spring orientation for right hand reverse operation



1. Remove cotter pin.
2. Remove castle nut.
3. Remove washer.
4. Carefully pull up on spring hub to disengage spring.
5. Remove spring and note orientation.
6. Remove lever handle.
7. Pick-up flat gear, flip and orient stop on opposite side of stop post. See pictures for orientation.
8. Install spring upside down from original orientation and place spring leg on opposite side of stop post from original installation orientation. See pictures for orientation.
9. Install lever 180 degrees from original position.
10. Install spring hub with stamped number in the 6 o'clock position.
11. Rotate spring leg around with needle nose pliers to engage notch in spring hub, refer to pictures for reference position. Press down on spring hub to ensure complete engagement.
12. Install washer.
13. Install castle nut, do not over tighten, verify by insuring lever returns horizontally on its own.
14. Install cotter pin.

Yale Locks & Hardware

Product Support Tel 800.438.1951 • www.yalelocks.com

Yale Locks & Hardware is a division of Yale Security Inc., an ASSA ABLOY Group company.

Yale® is a registered trademark of Yale Security Inc., an ASSA ABLOY Group company. Other products' brand names may be trademarks or registered trademarks of their respective owners and are mentioned for reference purposes only. These materials are protected under U.S. copyright laws. All contents current at time of publication. Yale Security Inc. reserves the right to change availability of any item in this catalog, its design, construction, and/or its materials. Copyright © 2005, 2013, Yale Security Inc., an ASSA ABLOY Group company. All rights reserved. Reproduction in whole or in part without the express written permission of Yale Security Inc., an ASSA ABLOY Group company is prohibited.

Outside Door Face

Trim Template

HOLES MARKED "X" (4 Places)

METAL DOORS:

Inside Face 5/16" (8) Dia.

Outside Face 1/2" (13) Dia.

WOOD DOORS:

1/2" (13) Dia. Thru

Dimensions given in $\frac{\text{Inches}}{\text{(mm)}}$

TRIM	HOLES
621F	B, C, X
627F	A, B, C, X

CAUTION:

Office copiers, printers and facsimile machines may change the size of a drawing and make the template inaccurate to use as a door marker.

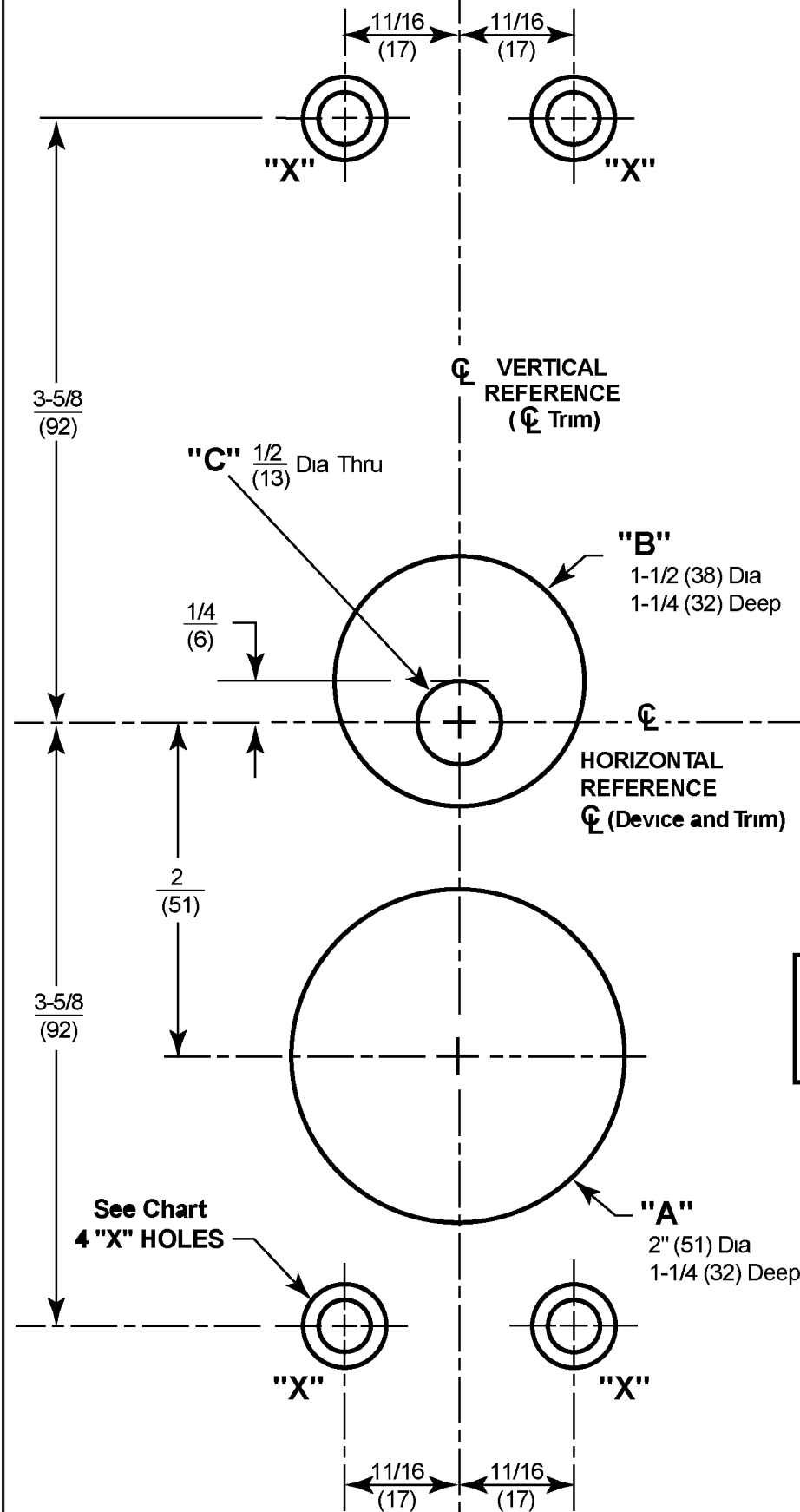

CUT LINE



