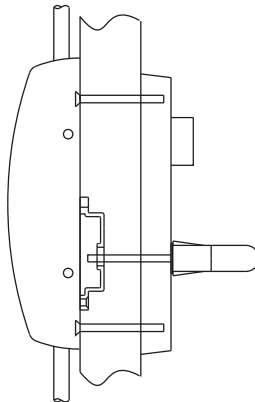
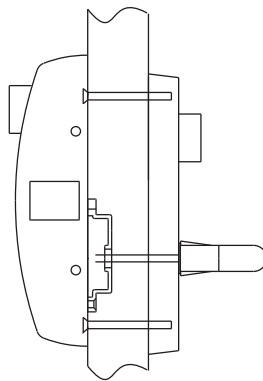
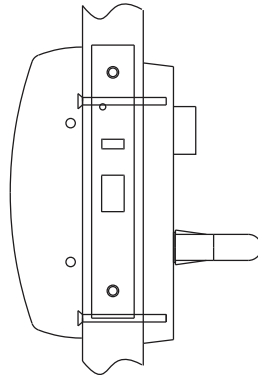
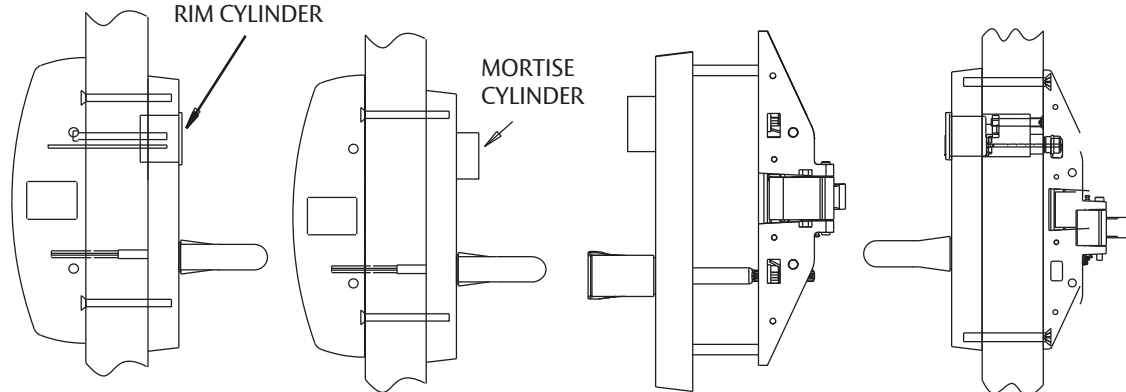
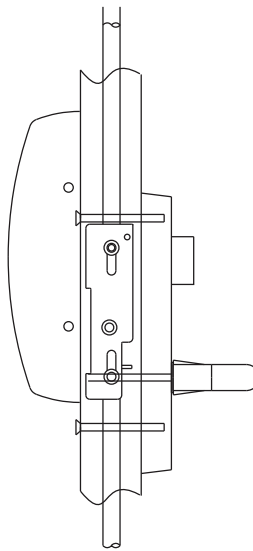
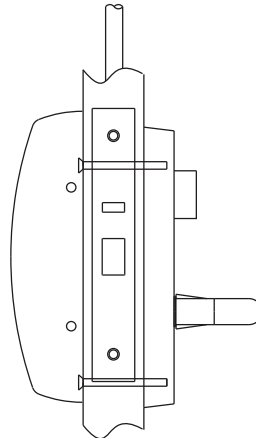
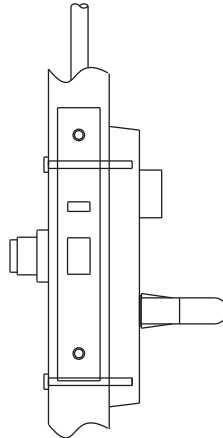

<div>700 SERIES CONTROL USED WITH 8700 AND 9700 SURFACE MOUNTED VERTICAL ROD EXIT DEVICES</div> <div>8700 RHRB SHOWN</div> <div></div>	<div>700 SERIES CONTROL USED WITH 8816 AND 9800 RIM EXIT DEVICES</div> <div>8816 RHRB SHOWN</div> <div></div>	<div>700 SERIES CONTROL USED WITH 8900 AND 9900 MORTISE LOCK EXIT DEVICES</div> <div>8900 RHRB SHOWN</div> <div></div>	<div>700 8 SERIES CONTROL USED WITH 8500, 8800, 12-8800, 8888, 12-8888, HC8800 AND 12-HC8800 RIM TYPE EXIT DEVICES</div> <div>8800 X 775 RHRB SHOWN</div> <div>8800 X 713 RHRB SHOWN</div> <div>8500 X 713, 715 LHRB SHOWN</div> <div>8500 X 704 LHRB SHOWN</div> <div></div> <div>IMPORTANT: SEE INSTRUCTION SHEET A6770 FOR (12-)8888, AND (12-)HC8800 EXIT DEVICE MOUNTING, OR A6699 FOR 8500 EXIT DEVICE MOUNTING.</div>
<div>700-4 SERIES CONTROL USED WITH 8400, 12-MD8400, MD8600, WD8600 AND 12-WD8600 CONCEALED VERTICAL ROD EXIT DEVICES</div> <div>RHRB SHOWN</div> <div>US PATENT No. 4145900</div> <div>IMPORTANT: SEE PROPER INSTRUCTION SHEET FOR EXIT DEVICE MOUNTING: A6697 - FOR 8400 EXIT DEVICE; A7012 - FOR 12-MD8400 EXIT DEVICE; A7002 - FOR WD8600 AND 12-WD8600 A3937 - FOR WD8600 AND 12-WD8600 EXIT DEVICES.</div> <div></div>	<div>700-6 SERIES CONTROL USED WITH PR8600, PP8600 AND SP8600 AND SP8600 CENTER AND TOP LATCH CONCEALED VERTICAL ROD EXIT DEVICES</div> <div>PP8600 RHRB SHOWN</div> <div>IMPORTANT: SEE INSTRUCTION SHEET A7330 FOR SP8600, 12-SP8600, PP8600, 12-PP8600, PR8600 AND 12-PR8600 EXIT DEVICE MOUNTING.</div> <div></div>	<div>700-6 SERIES CONTROL USED WITH LR8600, LP8600 AND LS8600 PROFILE SERIES EXIT DEVICES</div> <div>LP8600 RHRB SHOWN</div> <div>IMPORTANT: SEE INSTRUCTION SHEET A7393 FOR LP8600, 12-LP8600, LS8600, 12-LS8600,LR8600 AND 12-LR8600 EXIT DEVISE MOUNTING.</div> <div></div>	

METHOD FOR CHANGING HAND OF LEVER

- DISASSEMBLE:
1. REMOVE TRUSS HEAD MACHINE SCREW, FUSIBLE LINK AND RETAINING PLATE.
 2. REMOVE HUB SPRING FROM THE GROOVE PIN AND PULL THE SPINDLE, HUB PLATE AND HUB SPRING OUT OF THE LEVER HANDLE.
 3. REMOVE THE STOP SCREW AND SECURE IN THE OTHER HOLE.
 4. SEPARATE THE SPINDLE FROM THE HUB PLATE AND PLACE THE SPINDLE INTO THE LEVER HANDLE THRU THE CAP NUT.
 5. ROTATE THE LEVER HANDLE 180 DEGREES AND REMOVE THE SPINDLE.

- REASSEMBLE:
1. FLIP THE HUB PLATE OVER SO THAT THE HUB SPRING MOUNTING HOLE IS ON THE OTHER SIDE AND SLIDE THE LOWER END OF THE SPINDLE THRU THE SQUARE HOLE IN THE HUB PLATE.
 2. SLIDE THE SPINDLE AND HUB PLATE INTO THE LEVER HANDLE THRU THE CAP NUT, MAKING SURE THAT THEY ARE PARALLEL TO EACH OTHER.
 3. SLIDE THE HUB SPRING INTO THE LOWER MOUNTING HOLE OF THE HUB PLATE AND SLIDE THE OTHER END OVER THE GROOVE PIN.
 4. SLIDE THE RETAINING PLATE OVER THE SPINDLE AND SECURE WITH THE FUSIBLE LINK AND TRUSS HEAD MACHINE SCREW.

METHOD FOR REPLACING CYLINDER

1. WITH LOCKING SLIDE IN THE DOWN POSITION, UNSCREW CYLINDER NUT AND REMOVE THE CYLINDER AND BLOCKING RING. REMOVE THE CYLINDER NUT IF NEEDED.
2. REPLACE CYLINDER BY REVERSEING ABOVE PROCEDURE, MAKING SURE THAT THE CYLINDER NUT IS IN PLACE AND THE CAM IS POINTING UP. BE SURE BLOCKING RING IS THE CORRECT LENGTH.

ELECTRO-MECHANICAL LEVER HANDLE CONTROL

1. 773/775 – POWER-ON LOCKS LEVER
2. 774/776 – POWER-ON UNLOCKS LEVER

POWER REQUIREMENTS: 24 VDC 1/4 AMP

1. THE ELECTRO-MECHANICAL CASE IS SIMILAR TO THE STANDARD CASE, EXCEPT THAT THE LOCKING SLIDE AND SPRING ASSEMBLY IS REPLACED WITH MOTOR ASSEMBLY.
2. THE METHOD FOR CHANGING THE LEVER HAND IS THE SAME AS THE STANDARD, LOCKING TRIM, EXCEPT THE RETAINING PLATE IS HELD ON BY (2) SCREWS IN THE CASE.

ATTENTION:

1. 54-700 CONTROLS IS NOT REVERSIBLE.
2. "A" LEVER DESIGN IS NOT REVERSIBLE.
3. 773 AND 774 LEVER HANDLE CONTROL DO NOT HAVE CYLINDERS.

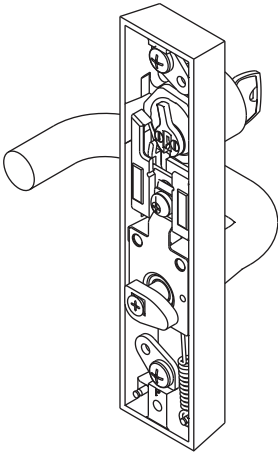
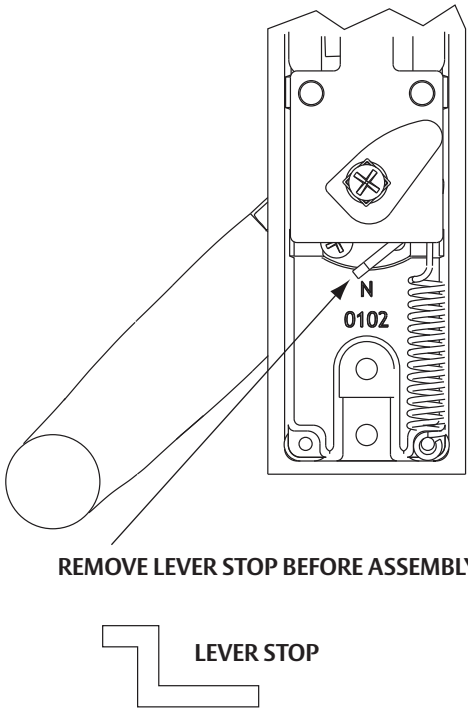
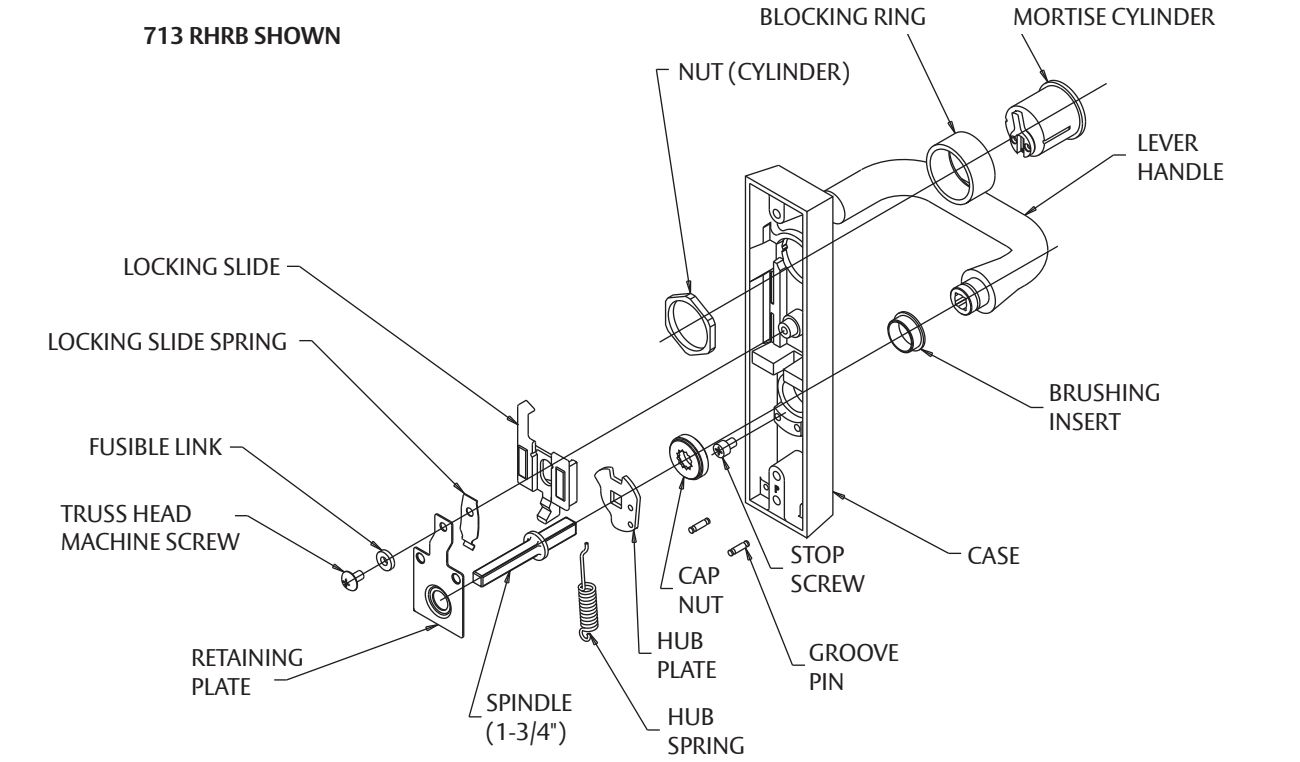
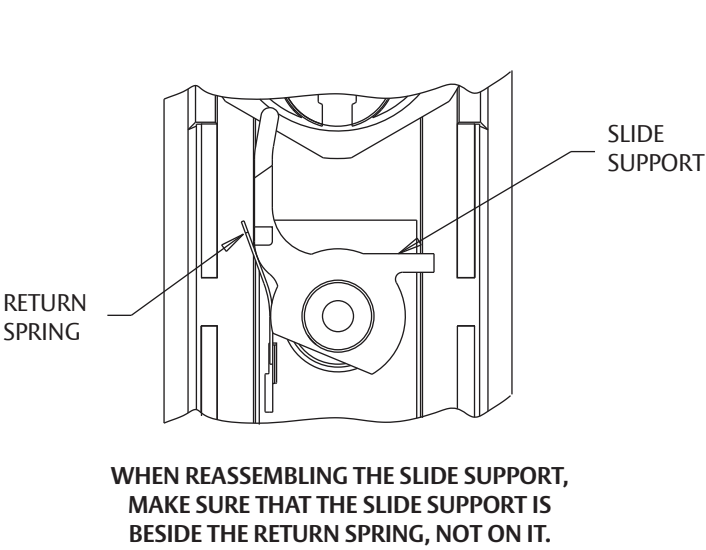

700-4 ET CONTROL

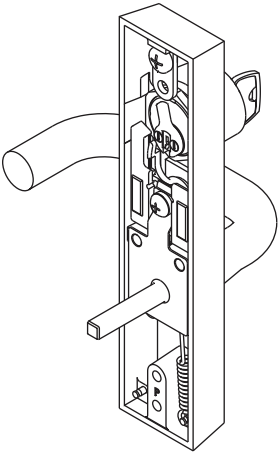

700-6 ET CONTROL

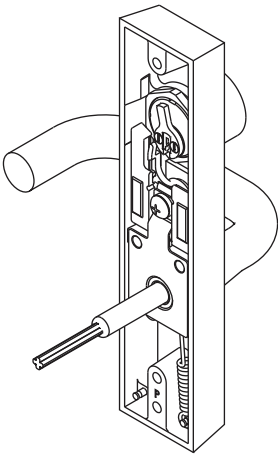

700-8 ET CONTROL

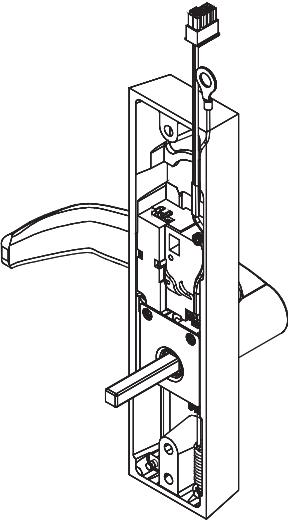

ECOFLEX
ELECTRICAL
ET CONTROL

- METHOD FOR SETTING FAIL SAFE / FAIL SECURE FUNCTION**
ONLY 73, 74, 75, AND 76 FUNCTIONS
1. INSERT THE PLASTIC TOOL (INCLUDED IN THE BOX) INSIDE THE SWITCH CASE (DETAIL A) ON THE ECOFLEX MOTOR, ALIGN THE TOOL NOTCH WITH THE MOTOR SWITCH.
 2. MOVE SWITCH TO THE CORRECT POSITION (SEE GRAPHICS)
 3. REMOVE TOOL AND SAVE IT FOR FUTURE USE.

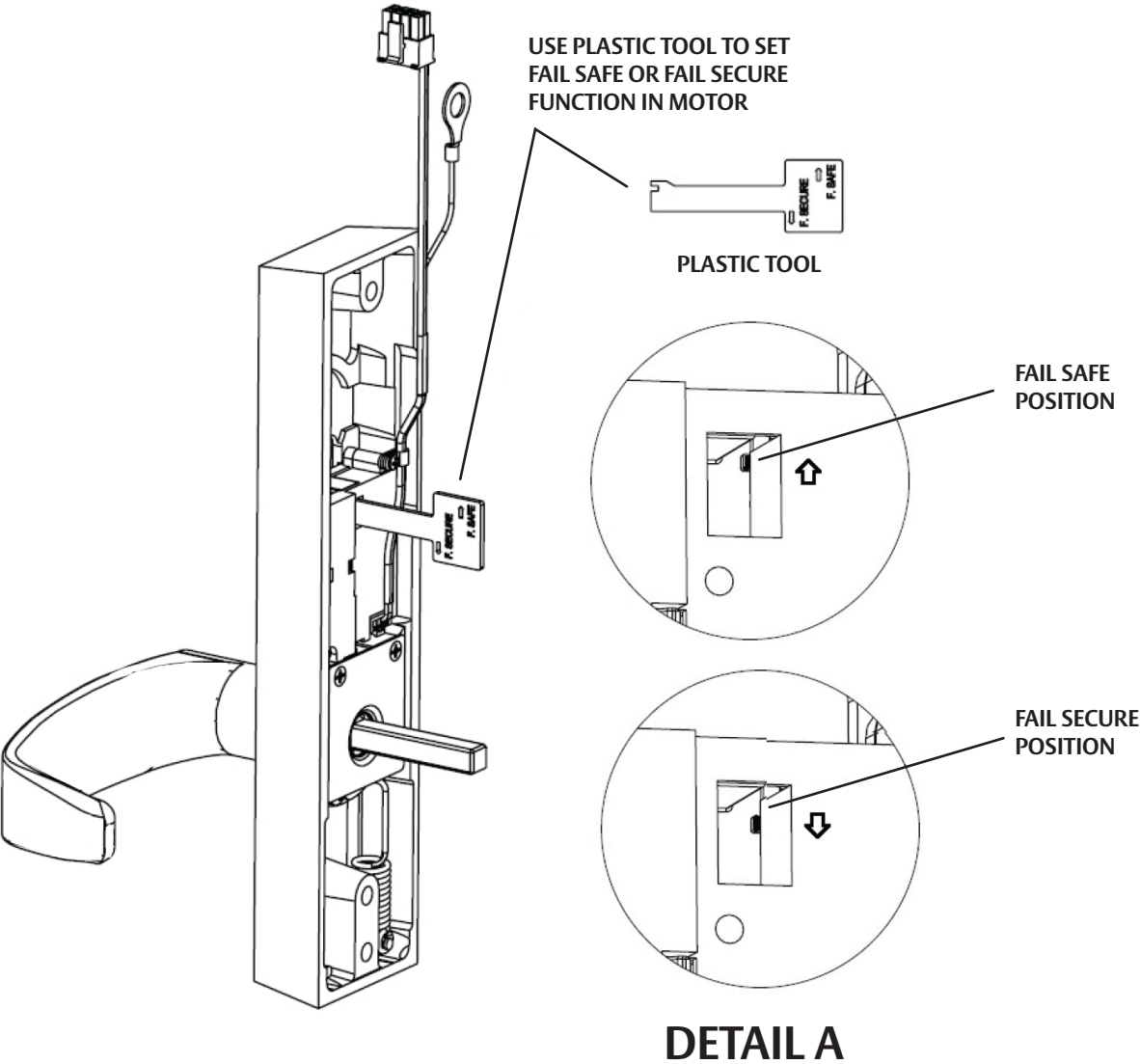

- METHOD FOR INSTALLING THE TRIM WITH GROUND LUG**
ONLY 73, 74, 75, AND 76 FUNCTIONS
1. INSERT THRU BOLTS (INCLUDED IN THE BOX) THROUGH THE HOLES IN THE DOOR.
 2. ALIGN TRIM TO THE THRU BOLTS
 3. SLIDE GROUND LUG OVER THE UPPER THRU BOLT.
 4. SCREW THE THRU BOLTS TO THE TRIM, LEAVING THE GROUND LUG BETWEEN THE DOOR.

