

Strike Dimensions

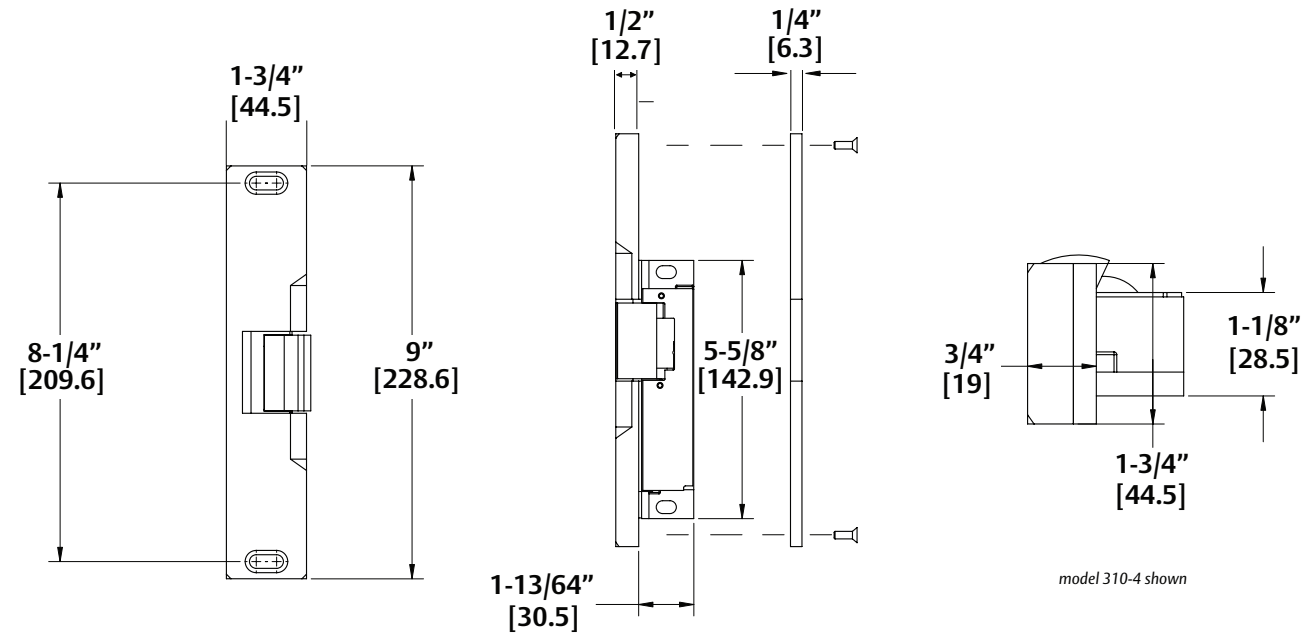

Cutout Template

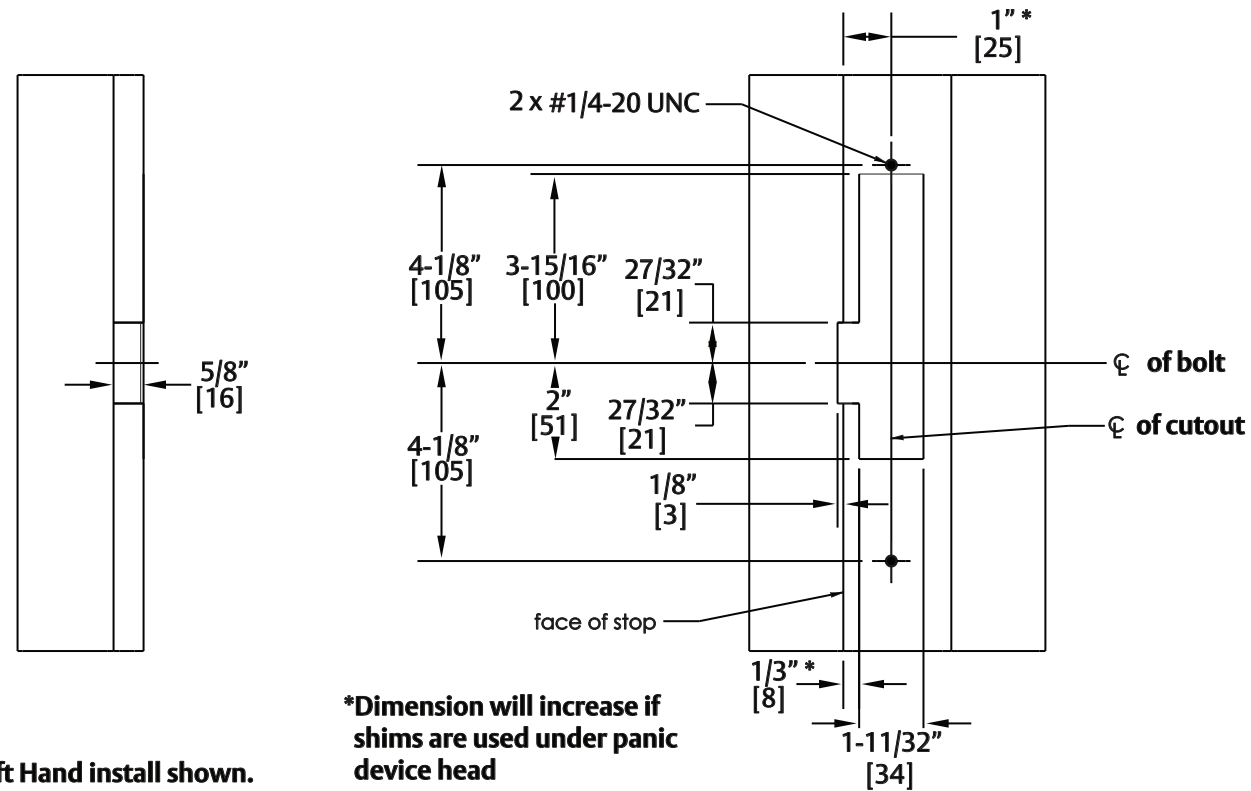

Folger Adam is a brand associated with Hanchett Entry Systems, Inc., an ASSA ABLOY Group company. Copyright © 2016, Hanchett Entry Systems, Inc. All rights reserved. Reproduction in whole or in part without the express written permission of Hanchett Entry Systems, Inc. is prohibited.

Product Components

- ① Electric Strike Body & Faceplate
- ② #1/4-20 x 1" Faceplate Mounting Screws
- ③ #14-2" Wood Screw
- ④ #12-24 Body Mounting Screws
- ⑤ #8-32 x 3/8" & 3/4" setscrew
- ⑥ Plug In Connector

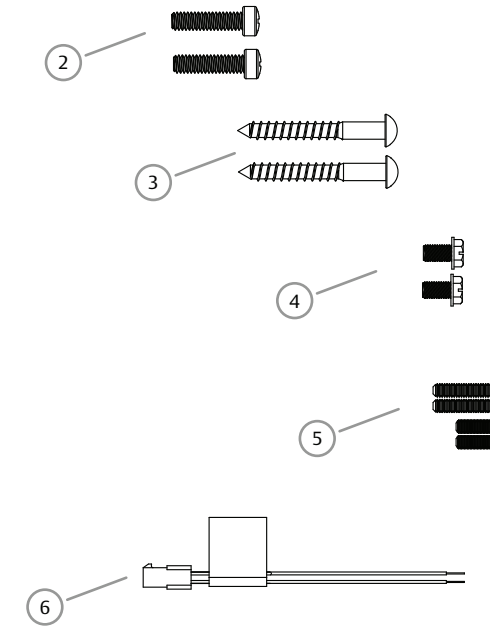
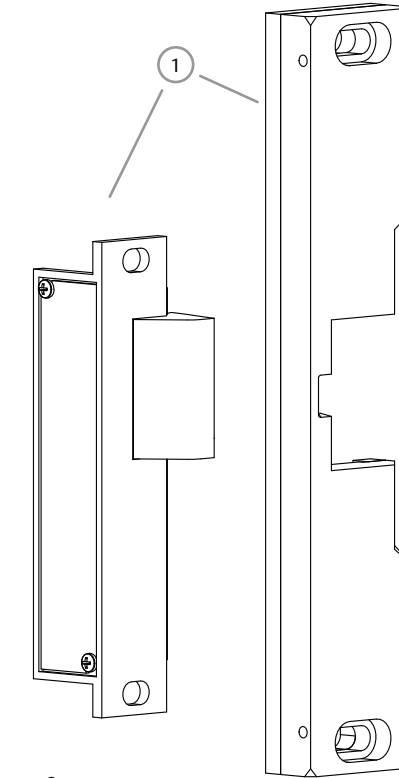

Specifications

ELECTRICAL RATINGS FOR SOLENOID		
CONTINUOUS DUTY	12 VDC	24 VDC
Resistance in Ohms	23.5	96
Amps	.51	.25
Solenoids are rated at +/- 10% indicated value.		

MINIMUM WIRE GAUGE REQUIREMENTS		
SOLENOID VOLTAGE	12 VDC	24 VDC
200 feet or less	18 gauge	18 gauge
200 - 300 feet	16 gauge	18 gauge
300 - 400 feet	14 gauge	16 gauge

UL 294 INFORMATION					
Product Type and Model	Access Control Line Security	Destructive Attack	Endurance	Destructive Attack	Conditions and Notes
Electric Strike, Accessory 310-1, -2, -3, -4, -5, or -6 (+) Series (Report Date 1970-2-18)	I	I	IV	I	May include one or more of the following suffixes: DBR, EL, FS, LBM, LCM, LCBM, LCBMA, OB, PK, RF, U, W, SK, 3/4, 1, 2, 3, 8, 30, or 100. Indoor Use Only

Installation Directions

CAUTION!

Before connecting any device at the installation site, verify input voltage using a multimeter. Many power supplies and low voltage transformers operate at higher levels than listed. Any input voltage exceeding 10% of the solenoid rating may cause severe damage to the unit and will void the warranty.

Preparing the Strike

1. ATTACH the faceplate to the strike body using the #12-24 x 3/8" Body Mounting screws as illustrated in "Attaching the Faceplate" on Page 3.
 2. IF using the LCBMA (Latchbolt & Locking Cam Monitor), THEN SEE "Monitoring Switches" below for wiring instructions.
- NOTE:** The strike body ships as either a 12 or 24 volt unit and is not field selectable.
3. VERIFY the available voltage is +/- 10% of the rated voltage of the strike body.

Preparing the Frame

4. PREPARE frame using the template on Page 4.
5. TEST FIT the electric strike in the door frame.
6. IF there is not enough clearance between the exit device and the door strike, THEN REMOVE the spacer plate as shown on Page 3.

Finishing the Installation

7. CONNECT the Plug In Connector to the electric strike, and CONNECT wires from the Plug In Connector leads to the power source.
8. INSTALL the electric strike unit in jamb cutout, using the provided #12-24 x 1/2" faceplate mounting screws.
9. ADJUST the strike horizontally as shown on Page 3 to accommodate any door silencers or smoke seals.

Monitoring Switches

Latchbolt Monitor (LBM)

White	Common
Orange	Normally Open
Green	Normally Closed



Locking Cam Monitor (LCM)

When Secure	
Brown	Common
Blue	Normally Open
Yellow	Normally Closed



Installation Directions

Attaching the Faceplate

1. To attach the 310 series electric strike body to the faceplate, INSTALL with two #8-32 body mounting screws, as shown.
2. ENSURE body mounting screws are tightened and secured.
3. ADJUST the keeper position by loosening the #8-32 body mounting screws, and repositioning the strike body as needed.
4. RETIGHTEN the #8-32 body mounting screws after adjustment is made.

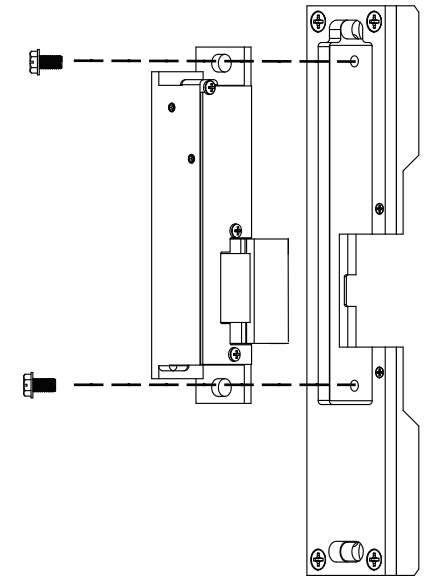

Removing the 1/4" Spacer Plate

NOTE: A 1/4" spacer plate is preinstalled to the strike faceplate. Removal of the spacer plate will decrease faceplate thickness from 3/4" to 1/2".

1. REMOVE the four #8-32 screws and two #2-56 screws.
2. REMOVE the spacer plate.

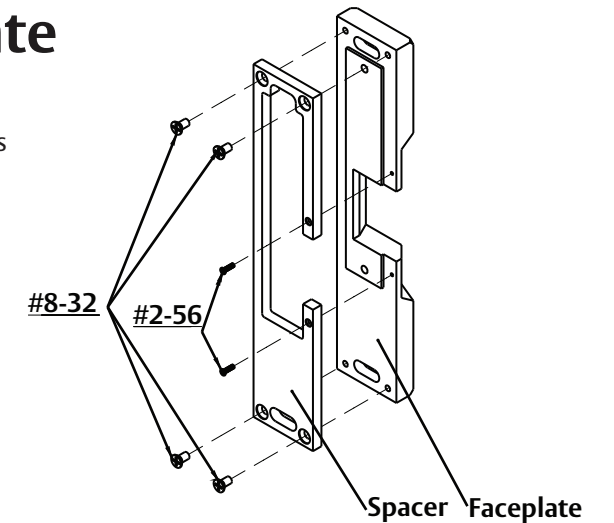

Adjusting the Horizontal

1. LOOSEN the two #1/4-20 faceplate mounting screws.
2. ADJUST the strike to the appropriate position.
3. TIGHTEN the two #1/4-20 faceplate mounting screws.

NOTE: A 3/8" and 3/4" setscrew are provided. Proper selection will secure the #1/4-20 faceplate mounting screws, but not protrude from the strike body.

4. LOCK DOWN the adjustment by installing the provided set screws.

