



**BradConnectivity™ diagnostic connectors for PROFIBUS® effectively reduce installation, connection and troubleshooting time with their unique design.**

22 Apr. 10  
DW2006136

## PROFIBUS® D-Sub Connector

### Features

- All metal construction for harsh environments
- Fully shielded for high noise immunity
- IDC connections for fast and reliable installations
- Captive single-screw mechanism - no loose parts
- High transfer rate - 12 MBaud
- 4 LEDs for fast diagnostics and health status of the bus and device (diagnostic versions only)
- Terminator monitor indicates if terminator is missing (diagnostic versions only)
- Integrated switchable terminators
- Transparent cable slots and covers for high visibility
- Integrated programming/diagnostic port (on 90° / 45° formats)
- Available in 0°, 45° and 90° formats making connections to various devices easier



Bottom View



Side View

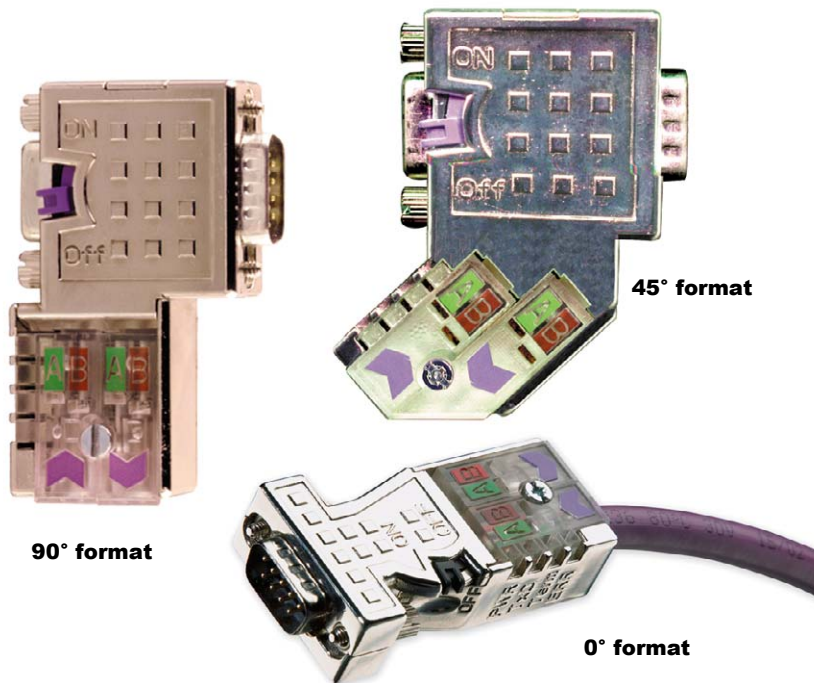

### Overview

The BradConnectivity PROFIBUS Diagnostic D-Sub connector effectively reduces installation, connection and troubleshooting time with its unique design. The dual cable entry guide makes connections virtually foolproof. Just strip the cable jacket, guide the PROFIBUS 2-conductor cable into the slots, and tighten with a **single** screw.

PROFIBUS network troubleshooting is also easy thanks to an LED display that pinpoints power, bus, device and termination errors. An integrated port is also included for field diagnostic monitors, analyzers or laptops. The connector is enclosed in a sturdy metal case that contributes to safe and reliable operation by helping to prevent outside interference and damage in harsh applications.

BradConnectivity Diagnostic D-Sub connectors will benefit machine tool, conveyor and material handling applications with its time-saving features. Whether used in motor control centers, variable frequency drives or I/O, they can shorten time to market and reduce production downtime significantly ▲



## Physical Dimensions

### 90° Style

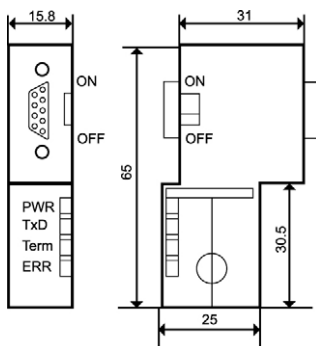

## Switchable Terminating Resistors

The switchable terminating resistors are activated by a slide switch accessible from both the side and rear. With this switch, the OUT Bus can be shut off. For testing purposes the PROFIBUS components following the connector can be switched off without removing the plug.

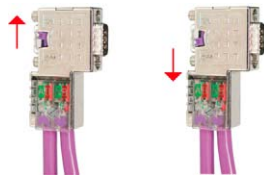

## Cable Installation

Connect Fast! Install Fast!  
Troubleshoot Fast!

- Loosen the single screw
- Lift the contact cover(s)
- Push the 2 stripped wires into the wire channel, lining up with the color code:
- Green Line to "A" and Red Line to "B"
- Close the contact cover
- Tighten the screw securely and you are finished!

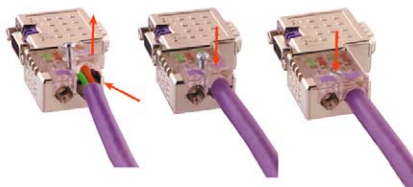

## Ordering Information

Part Number	SAP Number	Description
MA9D00-42	1201000005	0° connector, with integrated diagnostics
PA9D0B-42	1201030003	45° connector, with integrated diagnostics
PA9D01-42	1201030001	90° connector, with integrated diagnostics
PA9S01-42	1201030005	90° connector, without diagnostics
PBSTRIP	1201030007	Cable stripping tool

## Specifications

### Mechanical:

- PROFIBUS
  - Programming/Diagnostics
  - Insertion (withdrawal) cycles
  - Cable Type
  - Cable Diameter
  - Screw/Tightening Torque
  - Enclosure Material
  - Temperature Range
  - Cable Connection
  - Terminating Resistor
  - Bus Signals
- 9 Pole SubD Pin Headers  
9 Pole SubD Socket  
Min. 200  
Solid Core PROFIBUS Type A, EN50170  
8mm  
4-40 UNC/0.4Nm  
Die-Cast Zinc  
-20°C to +75°C  
IDC Technology  
Yes, Built-In Switchable  
Dual, IN and OUT

### Insulation Stripping Lengths:

- Outer Sheath 17mm
- Shield 11mm

LED	Color	LED Off	LED On	LED Flashing at 5Hz
PWR	Yellow	No 5 Vdc Power Supply from Device	Self Testing Completed Device Power OK	PB Master Failed or Short Circuit of Wire
TxD	Green	No Bus Activity	N/A	Data Transfer in Progress
Term	Yellow	No Termination	Terminator OK	Internal Terminating Resistors Faulty
ERR	Red	No Errors	Faulty Bus Terminations in The Bus Line	Signal Levels Out of Defined Range

## Cable Stripping

\*Stripping Tool Shown Sold Separately

- Measure wire length as shown

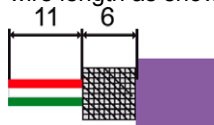

- Insert end of cable into stripping tool and fix it tightly until stopped

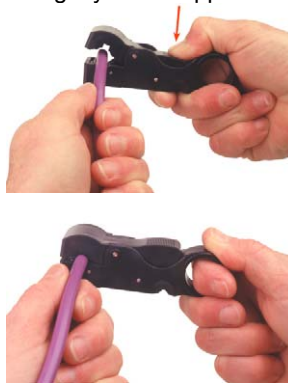

- Turn the stripping tool repeatedly around the cable



- Pull off in closed state



- Remove wire protection film and insulation

To contact us: [www.woodhead.com](http://www.woodhead.com)

North America: US: +1 (630) 969-4550 – Canada: +1 519 725 5136

Europe: France: +33 2 32 96 04 20 – Germany: +49 7252 94 96 0 – Italy: +39 (02) 950551 – UK: +44 (1252) 720720

Asia: China: +86 21-5048-0889 Singapore: +65 6-268-6868 – Japan: +81 46-265-2325 – Korea: +82 31-492-9000

Brad is a registered trademark and BradControl, BradCommunications, applicom, Direct-Link and SST are trademarks of Molex Incorporated. © 2010 Molex