

Anybus[®] Wireless Bolt LTE[™]

STARTUP GUIDE

SP2868 1.1 en-US ENGLISH



Important User Information

Disclaimer

The information in this document is for informational purposes only. Please inform HMS Networks of any inaccuracies or omissions found in this document. HMS Networks disclaims any responsibility or liability for any errors that may appear in this document.

HMS Networks reserves the right to modify its products in line with its policy of continuous product development. The information in this document shall therefore not be construed as a commitment on the part of HMS Networks and is subject to change without notice. HMS Networks makes no commitment to update or keep current the information in this document.

The data, examples and illustrations found in this document are included for illustrative purposes and are only intended to help improve understanding of the functionality and handling of the product. In view of the wide range of possible applications of the product, and because of the many variables and requirements associated with any particular implementation, HMS Networks cannot assume responsibility or liability for actual use based on the data, examples or illustrations included in this document nor for any damages incurred during installation of the product. Those responsible for the use of the product must acquire sufficient knowledge in order to ensure that the product is used correctly in their specific application and that the application meets all performance and safety requirements including any applicable laws, regulations, codes and standards. Further, HMS Networks will under no circumstances assume liability or responsibility for any problems that may arise as a result from the use of undocumented features or functional side effects found outside the documented scope of the product. The effects caused by any direct or indirect use of such aspects of the product are undefined and may include e.g. compatibility issues and stability issues.

1 Preface

1.1 About This Document

This manual describes how to install and configure Anybus Wireless Bolt LTE.

For additional documentation and software downloads, FAQs, troubleshooting guides and technical support, please visit www.anybus.com/support.

1.2 Document Conventions

Numbered lists indicate tasks that should be carried out in sequence:

1. First do this
2. Then do this

Bulleted lists are used for:

- Tasks that can be carried out in any order
- Itemized information
- ▶ An action
 - and a result

User interaction elements (buttons etc.) are indicated with bold text.

Program code and script examples

Cross-reference within this document: *Document Conventions, p. 4*

External link (URL): www.hms-networks.com



WARNING

Instruction that must be followed to avoid a risk of death or serious injury.



Caution

Instruction that must be followed to avoid a risk of personal injury.



Instruction that must be followed to avoid a risk of reduced functionality and/or damage to the equipment, or to avoid a network security risk.



Additional information which may facilitate installation and/or operation.

1.3 Trademarks

Anybus® is a registered trademark and Wireless Bolt LTE™ is a trademark of HMS Industrial Networks AB. All other trademarks mentioned in this document are the property of their respective holders.

2 Safety

2.1 General Safety Instructions

**Caution**

This equipment emits RF energy in the ISM (Industrial, Scientific, Medical) band. Make sure that all medical devices used in proximity to this equipment meet appropriate susceptibility specifications for this type of RF energy.

**Caution**

Minimum temperature rating of the cable to be connected to the field wiring terminals, 90 °C.

**Caution**

Use copper wire only for field wiring terminals.



This equipment is recommended for use in both industrial and domestic environments. For industrial environments it is mandatory to use the functional earth connection to comply with immunity requirements. For domestic environments the functional earth must be used if a shielded Ethernet cable is used, in order to meet emission requirements.



This equipment contains parts that can be damaged by electrostatic discharge (ESD). Use ESD prevention measures to avoid damage.

2.2 Intended Use

The intended use of this equipment is as a communication interface and router. The equipment receives and transmits data over Ethernet and Cellular standard networks.

3 Installation

3.1 Installing SIM Card



Supported SIM card types are Nano SIM for IoT and M2M, for data communication, as well as standard mobile phone Nano SIM.

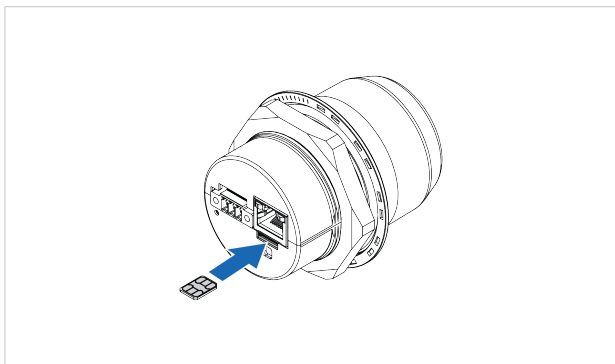

Fig. 1

To connect Wireless Bolt LTE to a cellular data network, install a cellular SIM card:

1. Insert a *SIM card* into the Wireless Bolt LTE *SIM card holder*.



Ensure that the SIM card contact surface is facing towards the Ethernet port.

3.2 Mechanical Installation

Placement

- The device is intended to be mounted on top of a machine or cabinet through an M50 (50.5 mm) hole using the included sealing ring and nut.
- The top mounting surface, in contact with the sealing, must be flat with a finish equivalent to Ra 3.2 or finer and cleaned and free from oils and greases.
- For optimal reception, cellular devices require a zone around them clear of objects that could obstruct or reflect the signal. To avoid interference, a minimum distance of 50 cm between Wireless Bolt LTE and other cellular devices should be observed.



Make sure that the sealing ring is correctly placed in the circular groove in the top part of the housing before tightening the nut.



Always hold the **BOTTOM** part of the unit when untightening the nut, not the top part (the cap).

3.3 Connecting to Power Over Ethernet (PoE)

Before You Begin



Connecting the Wireless Bolt LTE to PoE and DC power simultaneously may result in a current loop that could damage both the power sources and the Wireless Bolt LTE. Ensure to use only one of the power connections at a time.



Shielded or unshielded Ethernet cables may be used.



Wireless Bolt LTE is designed to comply with PoE, IEEE 802.3at Type 1 (Class 0, 37-57 VDC, max 12.95 W).

Procedure

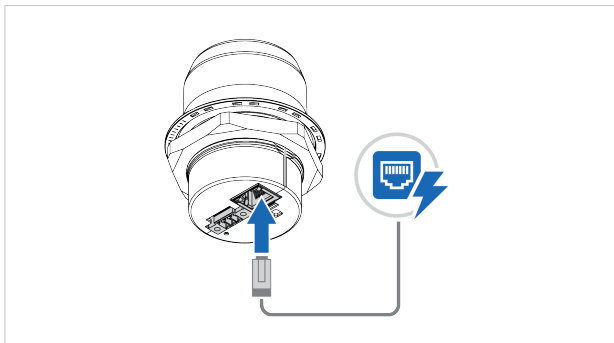
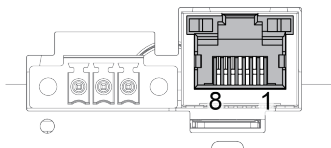

Fig. 3

1. Connect the Wireless Bolt LTE *Ethernet port* to Ethernet/PoE.

Ethernet Connector, RJ45 PoE

Pin	Data	PoE	
1	TD+	A+	Positive power from alt. A PSE
2	TD-		
3	RD+	A-	Negative power from alt. A PSE (with pin 6)
4		B+	Positive power from alt. B PSE
5			
6	RD-	A-	Negative power from alt. A PSE (with pin 3)
7		B-	Negative power from alt. B PSE
8			
Housing	Shield	Functional Earth (FE), via 1 nF capacitor and 1 MΩ bleeder resistor	

3.4 Connecting to Power and Ethernet

Before You Begin



Connecting power with reverse polarity or using the wrong type of power supply may damage the equipment. Make sure that the power supply is connected correctly and of the recommended type.



Connecting the Wireless Bolt LTE to PoE and DC power simultaneously may result in a current loop that could damage both the power sources and the Wireless Bolt LTE. Ensure to use only one of the power connections at a time.



When Wireless Bolt LTE is powered via the power connector, Functional Earth (FE) must be connected.



When Wireless Bolt LTE is installed in an environment with a high level of electrical noise, use a power/Functional Earth (FE) cable with a maximum length of 3 meters.

See also [Technical Data, p. 18](#) regarding power supply requirements.

Functional earth wire screw placement

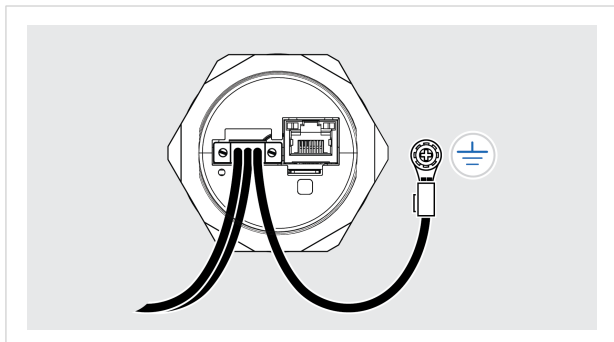

Fig. 4

When Wireless Bolt LTE is mounted on a sheet metal plate, connect Functional Earth (FE) to the plate near Wireless Bolt LTE.

Procedure

Connecting to power

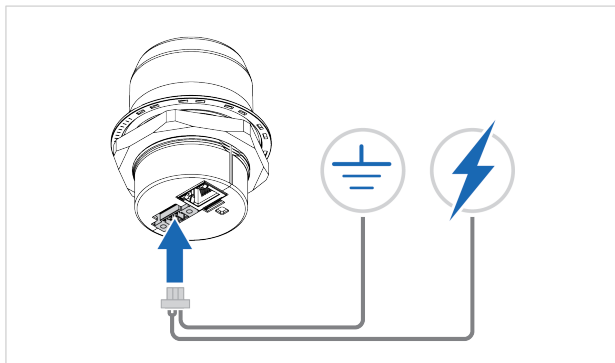
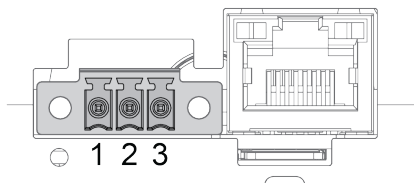

Fig. 5

1. Connect Wireless Bolt LTE *Power connector* to a power supply.
2. Connect Wireless Bolt LTE *Power connector* to Functional Earth (FE).

Power connector, 3-pin terminal block



Pin	Function	
1	+	11–33 VDC
2	-	
3	Functional Earth (FE)	

Connecting to Ethernet

3. Connect the Wireless Bolt LTE to Ethernet.

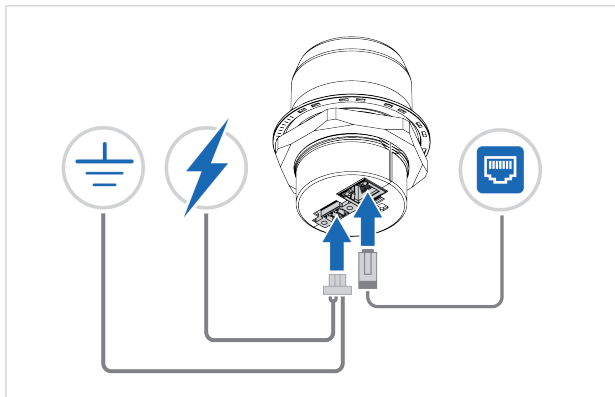

Fig. 6

4 Configuration

Wireless Bolt LTE Built-In Web Interface

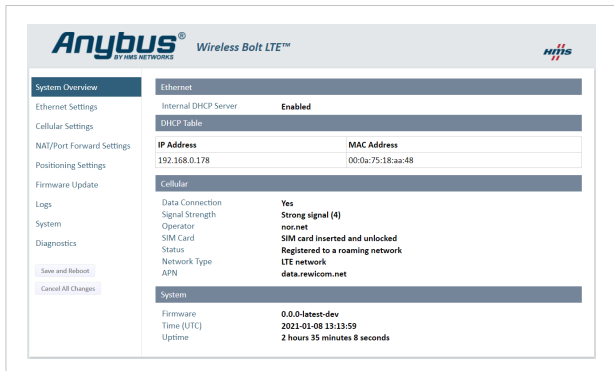

Fig. 7 Example, Wireless Bolt LTE built-in web interface

The Wireless Bolt LTE built-in web interface is used to configure the Wireless Bolt LTE system settings.

The *System Overview* page shows the current settings and network connection status.

Before You Begin



The Wireless Bolt LTE comes with a default username and password.

*The default username is **admin**. Written in lowercase letters.*

You find the default password on the Wireless Bolt LTE product housing.



*Wireless Bolt LTE default IP address is **192.168.0.98**.*

To access the Wireless Bolt LTE built-in web interface, ensure that the Wireless Bolt LTE IP address and your PC IP address are within the same IP address range.

Procedure

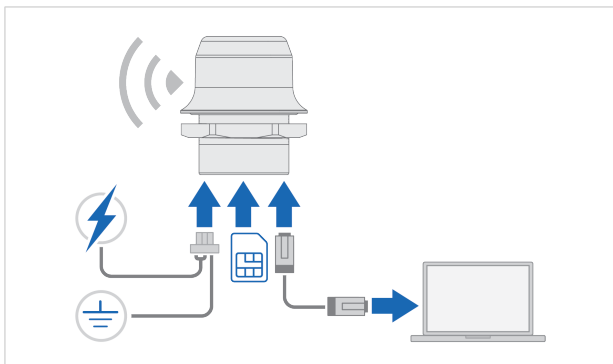

Fig. 8

Connecting Wireless Bolt LTE to internet:

1. Insert a *cellular SIM card* in the *Wireless Bolt LTE SIM card holder*.



Ensure that the SIM card contact surface is facing towards the Ethernet port.

2. Connect the Wireless Bolt LTE *Ethernet port* to your PC.
3. Connect the Wireless Bolt LTE *Power connector* to a power supply.
4. To access the built-in web interface, enter the Wireless Bolt LTE IP address in your web browser and click Enter.
5. Login to the Wireless Bolt LTE built-in web interface.
6. Configure the **Ethernet Settings**, IP address and internal DHCP server settings.
7. Verify that the **APN Settings** are correct. You can adjust the settings manually.
8. In the left sidebar menu, click **Save and Reboot**.
→ Wireless Bolt LTE automatically reboots for the settings to take effect.
9. On the **System Overview** page, verify that the cellular **Data Connection** has status **Yes**.

Result

Wireless Bolt LTE should now be connected to internet.



Depending on the mobile network operator and network type, it can take up to 10 minutes the first time Wireless Bolt LTE is connecting to internet.

Verify that Wireless Bolt LTE is connected to internet, by sending a ping to *Google Public DNS*.

1. On the **Diagnostics** page, select the **Ping** method.
2. In the **Target** field, enter the IP address *8.8.8.8*.
3. To **Perform Action**, click **Start**.
 - The ping request is sent.
 - When the ping response returns, a message appears.

The screenshot shows the 'Network Diagnostics' interface. At the top, there's a header 'Network Diagnostics'. Below it, there are three input fields: 'Method' with a dropdown menu showing 'Ping', 'Target' with the text '8.8.8.8', and 'Perform Action' with a blue 'Start' button. Below these fields, there is a text area displaying the following output:

```
Starting: ping -w 30 -c 4 -4 -s 56 8.8.8.8
PING 8.8.8.8 (8.8.8.8): 56 data bytes
64 bytes from 8.8.8.8: seq=0 ttl=52 time=521.234 ms
64 bytes from 8.8.8.8: seq=1 ttl=52 time=196.823 ms
64 bytes from 8.8.8.8: seq=2 ttl=52 time=174.440 ms
64 bytes from 8.8.8.8: seq=3 ttl=52 time=175.135 ms

--- 8.8.8.8 ping statistics ---
4 packets transmitted, 4 packets received, 0% packet loss
round-trip min/avg/max = 174.440/266.908/521.234 ms
ping finished: 0
```

Fig. 9 Example, Ping response message from target 8.8.8.8

Connecting Devices

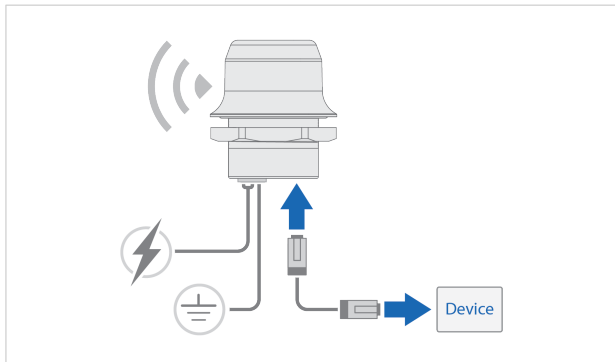

Fig. 10

Connecting a device to internet:

1. Connect an Ethernet cable between Wireless Bolt LTE and the device.
2. Verify that the device is connected to internet.

5 Technical Data

5.1 Technical Specifications

Order code	EMEA: AWB1500 Americas: AWB1502	EMEA: AWB1501 Americas: AWB1503
Color	Black	White top and black base
Operating temperature	Shadow: -40 to +65 °C Direct sunlight: -40 to +45 °C	Shadow: -40 to +65 °C Direct sunlight: -40 to +65 °C
Host interface	RJ45 Ethernet 10/100 Mbit/s, PoE	
Storage temperature	-40 to +85 °C	
Humidity compability	EN 600068-2-78: Damp heat, +40 °C, 90% (non-condensing).	
Vibration	Refer to datasheet at www.anybus.com/support .	
Dimensions	Diameter: 68 mm. Height: 75 mm without Power connector, 84 mm incl. Power connector. Height above mounting surface: 41 mm.	
Weight	100 g	
Housing material	Plastic (see datasheet for details)	
Protection class	Top (outside of host): IP66 and IP67 / UL Type 4X Base (inside of host): IP21	
Mounting	M50 screw and nut (50.5 mm hole needed)	
Power	3-pin screw connector and PoE (Power over Ethernet) 11-33 VDC through Power connector, PoE, IEEE 802.3at Type 1 (Class 0, 37-57 VDC, max 12.95 W) Redundant or separate operation of PoE and DC connectors. Power Consumption: Sleep Mode: Power connector 0.1 W. PoE 0.3 W Idle Mode: Power connector 0.6 W. PoE 0.8 W Worst Case average power: Power connector 3.2 W. PoE 3.6 W. Worst case peak current: 1.2A@11VDC	

Order code	EMEA: AWB1500 Americas: AWB1502	EMEA: AWB1501 Americas: AWB1503
Cellular standards	EMEA: LTE B1, B3, B7, B8, B20, B28. Fallback 3G and 2G Americas: LTE B2, B4, B5, B12, B13, B14, B25, B26, B66. Fallback 3G.	
Maximum Data speeds	Max download speed: 100 Mbit/s Max upload speed: 50 Mbit/s	
Ethernet protocols	Transparent transfer of any TCP/UDP based protocol, Built-in firewall, NAT and DHCP server.	
Certifications	Refer to datasheet at www.anybus.com/support .	

