

quality . service
innovation . integrity

Model 98



Features

The "Flow-Mate" series of submersible pumps is designed for use in residential or light commercial dewatering applications and can be used to transfer groundwater or effluent. These durable cast iron pumps include a powder coated epoxy finish to prevent corrosion, and are designed to provide great heat dissipation from the motor, ensuring a long service life. As with every Zoeller pump, each one is 100% pressure-tested, submerged and run to ensure quality and reliability for years of trouble-free performance! This attention to detail is an inherent feature of every pump in this series, making it one of the most reliable in the industry.

- Automatic models include a float-operated, NEMA 6, 2-pole mechanical switch, a stainless steel float guard and switch arm, and a solid, buoyant polypropylene float, which prevents water from filling the float and causing a malfunction.
- For nonautomatic pumps, variable level control systems and containers of various sizes are available for longer cycles.
- Includes a stainless steel handle for easy installation and removal.
- All models are hermetically sealed to be watertight, dust-tight, and completely submersible.

Specifications

Motor Characteristics

Horse Power	0.77 KW
Voltage	220 V
Phase	1 Ph
Hertz	50 Hz
RPM	1400 RPM
Type	Permanent split capacitor
Insulation	Class B
Amps	4.7 Amps

Pump Characteristics

Operation	Automatic or nonautomatic
Auto On/ Off Points	24 cm / 8 cm (9-1/2" / 3")
Discharge Size	1-1/2" NPT
Solids Handling	12 mm (1/2") spherical solids
Cord Length	3 m (9') standard
Cord Type	SOW/SOOW (CE model H07RN-F)
Max Head	4.9 m (16')
Max Flow Rate	12.7 m ³ /hr (56 GPM)
Max Operating Temp	54°C (130°F)
Cooling	Oil filled
Motor Protection	Auto reset thermal overload

Materials Characteristics

Cap	Cast iron
Motor Housing	Cast iron
Pump Housing	Cast iron
Base	Cast iron
Upper Bearing	Sleeve bearing
Lower Bearing	Sleeve bearing
Mechanical Seals	Carbon and ceramic
Impeller Type	Non-clogging vortex
Impeller	Engineered plastic
Hardware	Stainless steel
Motor Shaft	AISI 1215 steel
Gasket	Neoprene

50 Hz



PUMP COMPANY

Zoeller Family of Water Solutions™

FM2709_Eb
Section W2.20.070
Updated 0313
Supersedes 1011

Model 98

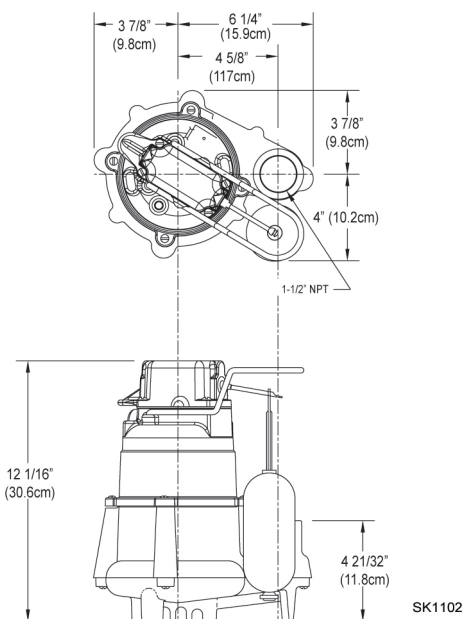
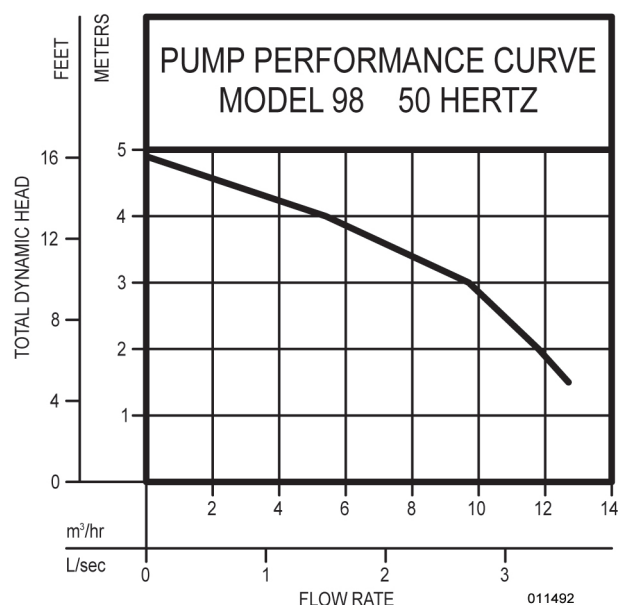

Model

Model Number	Seal	Mode	Volts	Phase	Amps	KW (p1)	Hz	Kg	Lbs
U98	Single	Auto	220	1	4.7	0.77	50	16	35
V98	Single	Non	220	1	4.7	0.77	50	16	35

Additional cord lengths are available in 8 m (25'), 11 m (35') and 15 m (50'). Power cords less than 10 m (33') on CE rated models are intended for indoor use only.

All models are available with a type E/F (5 or 10 m), G (2 or 10 m) or I (5 m) plug.

Optional pump stand (P/N/10-2421). The stand, made of durable, non-corrosive ABS, attaches securely to the pump and is intended to reduce clogging by debris, eliminate the need for bricks or blocks under the pump, and provide the ability to raise the intake by adding sections of DN40 or DN50 (1-1/2" or 2") PVC.

Reserve Powered Design: For unusual conditions, a reserve safety factor is engineered into the design of every pump.

Your Peace of Mind is Our Top Priority®
3649 Cane Run Rd | Louisville, KY 40211 USA
+1 502-778-2731 | Fax: +1 502-774-3624
www.zoeller.com

Product information presented here reflects conditions at time of publication. Consult factory regarding discrepancies or inconsistencies. Copyright 2013. All rights reserved.