

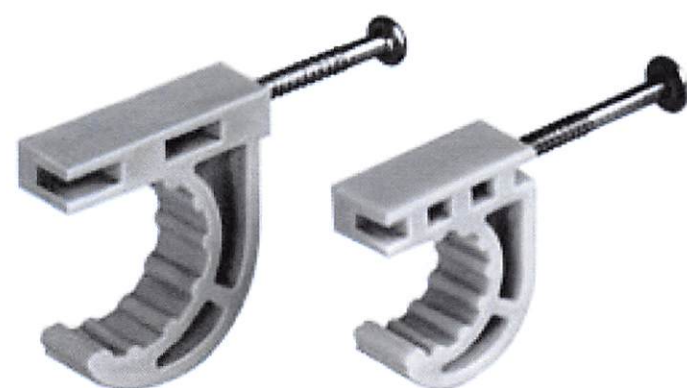





Half Clamps



Features

- Plastic half clamp preloaded with nail.
- Supports copper, PEX and polybutylene tubing. Not recommended for CPVC tubing.
- Impact resistant to 0°F (-18°C) Max Temp: 160° F continuous.

Product Description		Model #	Product Code	Units/ Case	Lbs./ Case
	Supports 3/8" CTS, with Preloaded Nail (100/Bag)	H 138	82846	1000	9
	Supports 1/2" CTS, with Preloaded Nail (50/Bag)	H 112	82850	2000	22
	Supports 3/4" CTS, with Preloaded Nail (50/Bag)	H 134	82855	1000	14
	Supports 1" CTS, with Preloaded Nail (50/Bag)	H 101	82860	500	13

Display Packs		Model #	Product Code	Units/ Case	Lbs./ Case
	Supports 1/2" CTS, with Preloaded Nail (5/Bag)	RH 122C	82840	10	1
	Supports 3/4" CTS, with Preloaded Nail (5/Bag)	RH 134C	82845	10	1