

THE EXCLUSIVE TWO FINGER FLANGE

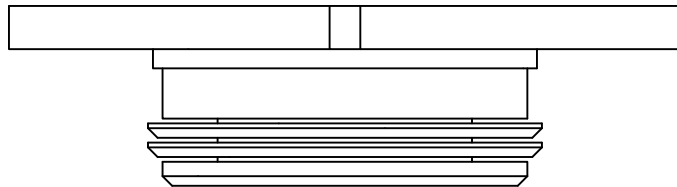

- FLUSH IT
- REDESIGNED TO FIT OBLONG HORNS
- MADE OF CAST IRON
- PUSHES EASILY INTO CAST IRON OR SCHEDULE 30 DWV PIPE
- NO TEAR OUT OR CAULKING REQUIRED
- ASTM C-564 RUBBER GASKET
- 3" X 2", 4" X 2" AND 4" X 3": FOR AREAS WITH THE BEND CLOSE TO THE FLANGE
- 3" X 4", 4" X 4" AND 4" X 6": FOR AREAS WITHOUT THE BEND CLOSE TO THE FLANGE OR BROKEN PIPE

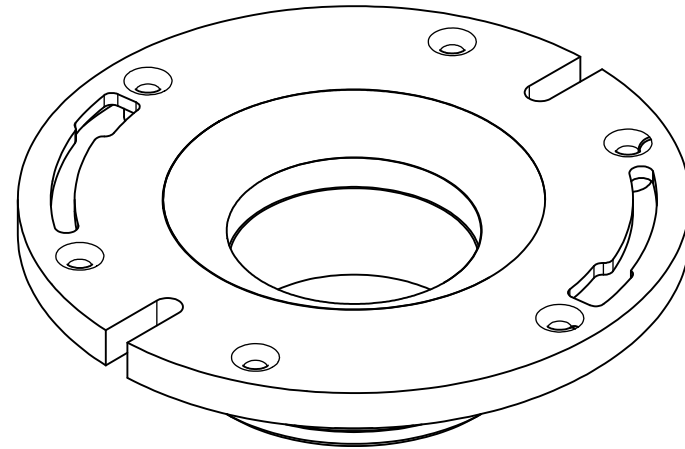
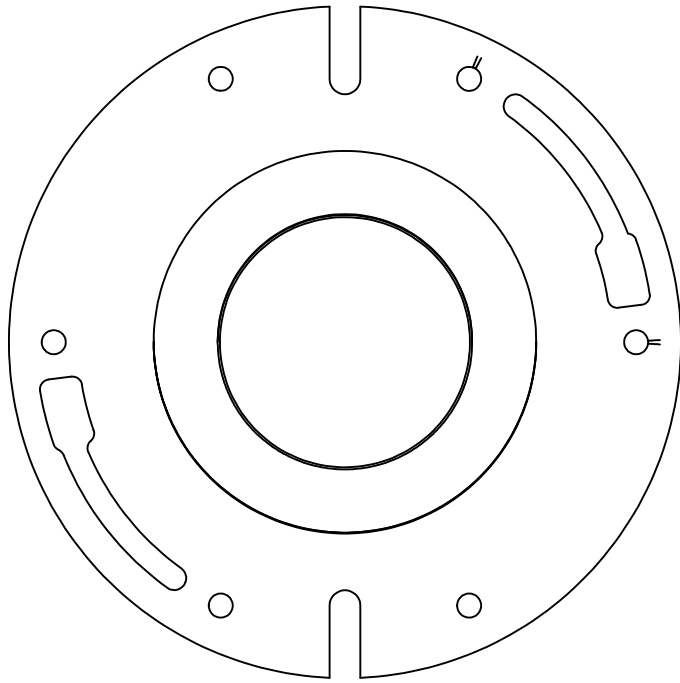

PHONE NUMBER
1-800-355-6637

FAX NUMBER
1-800-462-6991

SCALE
1 : 1

DATE
2-25-11

SHEET
1 OF 1

DRAWN BY
ASHLEY KRALOVEC

PART NO.	C47420				
DESCRIPTION	4" X 2"				
CTN QTY	8				