

# 90° STREET ELBOW



## PRODUCT SPECIFICATIONS

## Malleable Iron Screwed Fittings - Class 150

BLACK

GALVANIZED

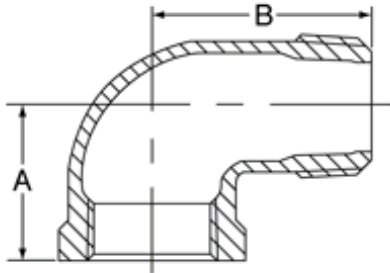

### 90° STREET ELBOW

Nominal Size	Dimensions		Approx. Wt. Each
	A	B	
In. (mm)	In. (mm)	In. (mm)	Lbs. (kg)
1/8	0.69	1.00	0.05
6	17.53	25.40	0.02
1/4	0.81	1.19	0.09
8	20.57	30.23	0.04
3/8	0.95	1.44	0.15
10	24.13	36.58	0.07
1/2	1.12	1.63	0.20
15	28.45	41.40	0.09
3/4	1.31	1.89	0.34
20	33.27	48.01	0.15
1	1.50	2.14	0.58
25	38.10	54.36	0.26
1 1/4	1.75	2.45	0.84
32	44.45	62.23	0.38
1 1/2	1.94	2.69	1.12
40	49.28	68.33	0.51
2	2.25	3.26	1.85
50	57.15	82.80	0.84
2 1/2	2.70	3.86	3.28
65	68.58	98.04	1.49
3	3.08	4.51	5.00
80	78.23	114.55	2.27
4	3.79	5.69	9.18
100	96.27	144.53	4.16

### MATERIAL SPECIFICATIONS

Dimensional: Fittings: ASME B16.3  
Unions: ASME B16.39  
Bushings/Plugs: ASME B16.14

Material: ASTM A-197

Galvanizing: ASTM A-153 (Hot Dip Galvanizing)

Threading\*: ASME B1.20.1

Pressure Rating: Fittings: ASME B16.3  
Unions: ASME B16.39  
Bushings/Plugs: ASME B16.14

Pressure Testing: All malleable iron fittings are tested for through wall porosity using an air under water process.

Agency Approvals: All malleable iron fittings and unions are UL Listed and FM Approved.

\* British Standard threading per BS 21 available upon request.



For Listings/Approval Details and Limitations, visit our website at [www.anvilintl.com](http://www.anvilintl.com) or contact an Anvil® Sales Representative.

All dimensions listed are nominal. MAINLINE® reserves the right to make product and material changes at any time without notice.