

90° ELBOW



PRODUCT SPECIFICATIONS

Malleable Iron Screwed Fittings - Class 150

BLACK

GALVANIZED

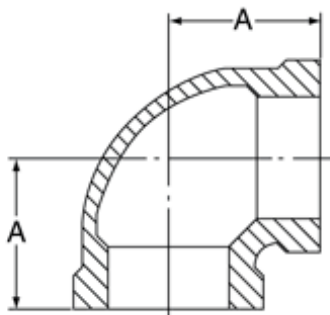

90° ELBOW

Nominal Size	Dimension A	Approx. Wt. Each
<i>In. (mm)</i>	<i>In. (mm)</i>	<i>Lbs. (kg)</i>
1/8	0.69	0.06
6	17.53	0.03
1/4	0.81	0.10
8	20.57	0.05
3/8	0.95	0.15
10	24.13	0.07
1/2	1.12	0.22
15	28.45	0.10
3/4	1.31	0.36
20	33.27	0.16
1	1.50	0.57
25	38.10	0.26
1 1/4	1.75	0.87
32	44.45	0.40
1 1/2	1.94	1.16
40	49.28	0.53
2	2.25	1.81
50	57.15	0.82
2 1/2	2.70	3.23
65	68.58	1.47
3	3.08	4.82
80	78.23	2.19
4	3.79	8.41
100	96.27	3.82
6	5.13	19.96
150	130.30	9.05

MATERIAL SPECIFICATIONS

Dimensional: Fittings: ASME B16.3
Unions: ASME B16.39
Bushings/Plugs: ASME B16.14

Material: ASTM A-197

Galvanizing: ASTM A-153 (Hot Dip Galvanizing)

Threading*: ASME B1.20.1

Pressure Rating: Fittings: ASME B16.3
Unions: ASME B16.39
Bushings/Plugs: ASME B16.14

Pressure Testing: All malleable iron fittings are tested for through wall porosity using an air under water process.

Agency Approvals: All malleable iron fittings and unions are UL Listed and FM Approved.

* British Standard threading per BS 21 available upon request.



For Listings/Approval Details and Limitations, visit our website at www.anvilintl.com or contact an Anvil® Sales Representative.

All dimensions listed are nominal. MAINLINE® reserves the right to make product and material changes at any time without notice.