

QIX Accessories

QIX Port Insert Kits & Accessories

Port Insert Kits (includes o-rings & pins) NPT BSPP

Port Size	NPT	BSPP
1/4"	IK20Y	IK20YG
3/8"	IK20X	IK20XG
1/2"	IK20A	IK20AG
3/4"	IK20B	IK20BG
1"	IK20C	IK20CG
Combination Connector (connects 2 QIX units together)	IK20CC	IK20CC
Combination Porting Block (same as IK20CC, except with 1/4" top branch outlet)	IK20CP	IK20GCP
IK20CP Porting Block and 1908 Pressure Switch	PST20	—

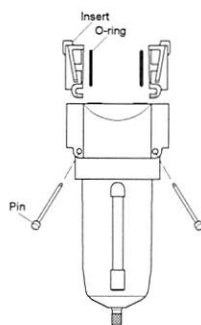

Port Insert Assembly

QIX MK20 Mounting Brackets

Part Number: MK20-0100

Kit contains 2 brackets and 4 screws

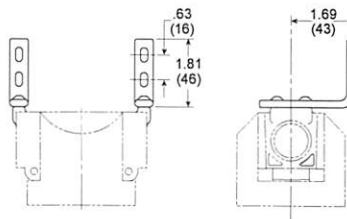

QIX IK20V Shut-Off Valve

This modular, 3-way ball valve attaches between the port insert and the inlet side of any QIX component. This valve shuts off the air pressure and vents the downstream pressure through a 1/8" NPTF port in the bottom of the valve.

The valve comes standard with a "lockout" feature as required by OSHA Standard 1910.147

Valve adds 1.4" to width of system.

