

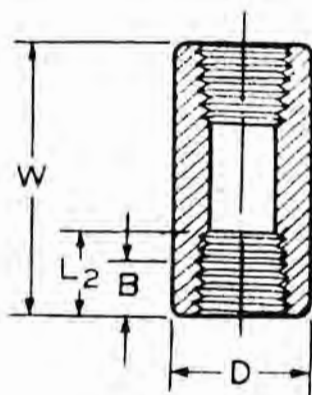

THREADED FITTINGS

ASME B16.11-1996(REVISION OF ASME B16.11-1991)



COUPLING

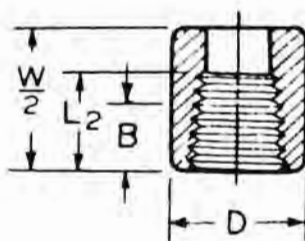

HALF COUPLING

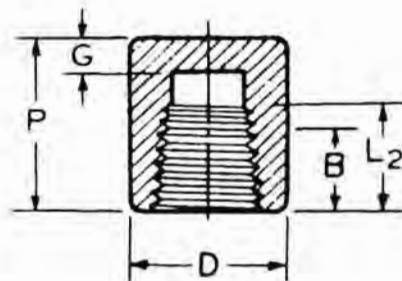

CAP

Dimensions in Millimeters.

DN	Nom. Pipe Size	End to End Couplings W		End to End Caps P		Outside Diameter D		End Wall Thickness G Min.		Length of Thread. Min. (1)	
		3000 & 6000	3000	6000	3000	6000	3000	6000	B	L2	
6	1/8	32	19	...	16	22	4.8	...	6.4	6.7	
8	1/4	35	25	27	19	25	4.8	6.4	8.1	10.2	
10	3/8	38	25	27	22	32	4.8	6.4	9.1	10.4	
15	1/2	48	32	33	28	38	6.4	7.9	10.9	13.6	
20	3/4	51	37	38	35	44	6.4	7.9	12.7	13.9	
25	1	60	41	43	44	57	9.7	11.2	14.7	17.3	
32	1-1/4	67	44	46	57	64	9.7	11.2	17.0	18.0	
40	1-1/2	79	44	48	64	76	11.2	12.7	17.8	18.4	
50	2	86	48	51	76	92	12.7	15.7	19.0	19.2	
65	2-1/2	92	60	64	92	108	15.7	19.0	23.6	28.9	
80	3	108	65	68	108	127	19.0	22.4	25.9	30.5	
100	4	121	68	75	140	159	22.4	28.4	27.7	33.0	

(1) Dimension B is minimum length of perfect thread. The length of useful thread (B plus threads with fully formed roots and flat crests) shall not be less than L2 (effective length of external thread) required by American National Standard for Pipe Threads(ANSI/ASME B1.20.1)

(2) Class 2000 and NPS 1/8 (DN6)class 6000 couplings, half couplings, and caps are not included in this standard.