

# Options and Accessories Index

Page

## Operators

Lever-Lock. ....	41
Gear. ....	42
Stem Extensions, Silicone Free Issue. ....	43

### Lever-Lock Operator (Standard) LD/WD2000/3000/5022

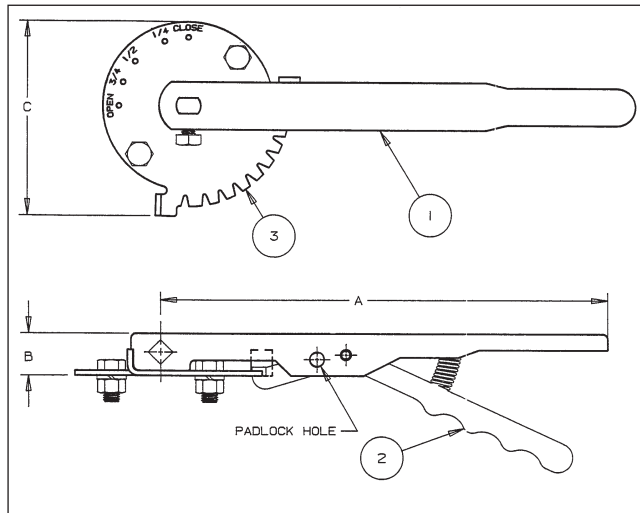

The lever-lock handle and throttling plate provide throttling notches every 10° for excellent manual control in balancing up to 90° or shut off service. The valve may be padlocked in any one of the positions including opened or closed by virtue of a locking hole located in the handle and lever.

### Position-Lock Operator (Optional) LD/WD2000/3000/5022

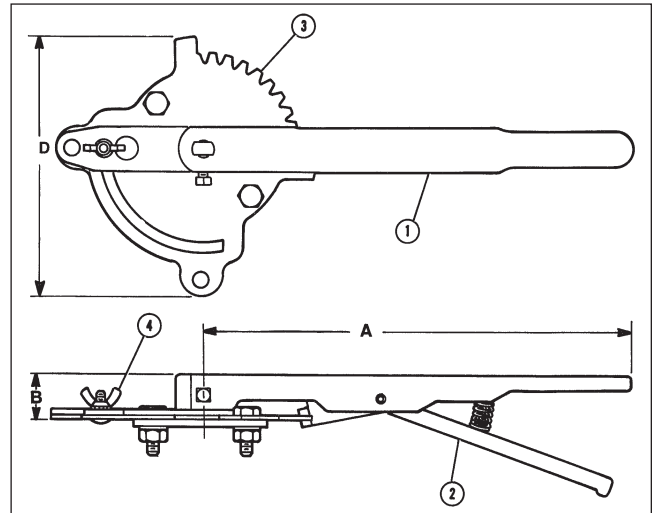

The position-lock can be used to set the valve in any position or as a memory stop so the valve may be reopened to the previous position. The valve may be padlocked in full open or full closed position.

Ordering: Sold as a field retrofitable kit only.

## MATERIAL LIST

PART	SPECIFICATION
1. Handle	Polymer Coated Iron
2. Lever-Lock	Zinc Plated Steel
3. Throttle Plate	Zinc Plated Steel

## DIMENSIONS AND TORQUE OUTPUT

LD/WD Valve Size	FC/FD GD Valve Size	Lever (STD)	Throttle Plate (STD)	Throttle Plate/ Infinite Pos. Kit	Dimensions				Torque Rated Output in Inch-Pounds	
					A	B	C	D	At 60 pounds Pull	At 100 pounds Pull
2"		T115106PP	T115138PP	T114840FG	10½"	1"	4⅝"	6⅜"	540 In-Lbs.	900 In-Lbs.
2½" - 3"	2", 2½", 3"	T115107PP	T115138PP	T114841FG	10½"	1"	4⅝"	6⅜"	540 In-Lbs.	900 In-Lbs.
4"		T115108PP	T115138PP	T114842FG	10½"	1"	4⅝"	6⅜"	540 In-Lbs.	900 In-Lbs.
	4" - 5"	T118446PP	T115138PP	T114843FG	10½"	1"	4⅝"	6⅜"	540 In-Lbs.	900 In-Lbs.
5" - 6"		T115109PP	T115138PP	T114843FG	13¾"	1"	4⅝"	6⅜"	735 In-Lbs.	1225 In-Lbs.
8"	6"	T115110PP	T115138PP	T114844FG	13¾"	1"	4⅝"	6⅜"	735 In-Lbs.	1225 In-Lbs.

\*Not recommended for 8", 10" and 12" valves

## DIMENSIONS AND TORQUE OUTPUT

LCS 6822 Class 150	LCS 7822 Class 300	LEVER	A	B	C & D	@ 60 LBS. PULL	@ 100 LBS. PULL
2"	2"	RG70031 & RG70034 Bushing	13.75"	1.25"	N/A	735 In-Lbs.	1225
2½" - 4"	2½" - 4"	RG70032	13.75"	1.25"	N/A	735 In-Lbs.	1225
5" - 6"	5" - 6"	RG70033	13.75"	1.25"	N/A	735 In-Lbs.	1225