

MALLEABLE IRON STREET 45° ELL CLASS 150

NPS	Center to End A	Center to Male B	Outside Dia. of Band C (min)	Port Dia. Male End D (max)	Length of Internal Threads E (min)	Length of External Threads F (min)	Take Out Male End	Take Out Female End
1/8	0.69	0.94	0.69	0.20	0.25	0.26	0.67	0.42
1/4	0.73	0.94	0.84	0.26	0.32	0.40	0.53	0.32
3/8	0.80	1.03	1.01	0.37	0.36	0.41	0.62	0.39
1/2	0.88	1.15	1.20	0.51	0.43	0.53	0.61	0.34
3/4	0.98	1.29	1.46	0.69	0.50	0.55	0.74	0.43
1	1.12	1.47	1.77	0.91	0.58	0.68	0.78	0.43
1 1/4	1.29	1.71	2.15	1.19	0.67	0.71	1.00	0.58
1 1/2	1.43	1.88	2.43	1.39	0.70	0.72	1.15	0.70
2	1.68	2.22	2.96	1.79	0.75	0.76	1.46	0.92

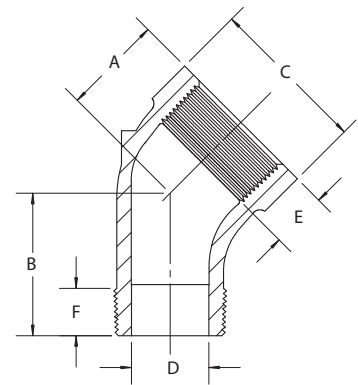

MALLEABLE IRON STRAIGHT TEES CLASS 150

NPS	Center to End A	Outside Dia. of Band B (min)	Length of Threads C (min)	Take Out
1/8	0.69	0.69	0.25	0.42
1/4	0.81	0.84	0.32	0.40
3/8	0.95	1.01	0.36	0.54
1/2	1.12	1.20	0.43	0.58
3/4	1.31	1.46	0.50	0.76
1	1.50	1.77	0.58	0.81
1 1/4	1.75	2.15	0.67	1.04
1 1/2	1.94	2.43	0.70	1.21
2	2.25	2.96	0.75	1.49
2 1/2	2.70	3.59	0.92	1.56
3	3.08	4.28	0.98	1.88
3 1/2	—	—	—	—
4	3.79	5.40	1.08	2.49
6	—	—	—	—

