

Swing Check Valve

INSIST ON
F P P I®

Full Floating Clapper Assembly

Description

The bronze* swing check valve features a full floating clapper assembly that provides for a positive seal each time the valve is cycled. This feature improves the swing check valves ability to “clear” any debris that may be present in the water supply. The seat material is NBR which provides for a positive seal even under light residual pressures.

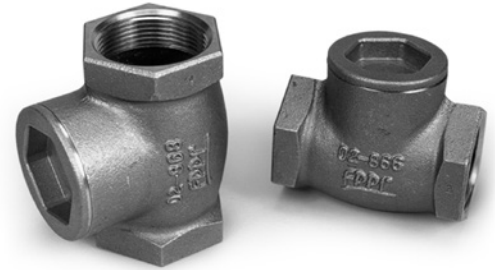

Installation

For horizontal installation only. The female by female swing check valve should be installed in accordance with commonly used installation practices for the fire sprinkler industry. Proper seal of the threads can be accomplished by applying a liberal amount of PTFE based thread sealant such as PipeFit® Thread Sealant Paste or PTFE Tape. Never use tape and paste together. This will cause excessive stress on the threaded connection leading to failure of the valve. Do not exceed one full turn past hand tight when installing male threads into the check valve.

Warning

DO NOT OVER TIGHTEN. Over tightening during installation will crack the valve body. Evidence of overtightening may not be readily visible or apparent upon pressurization.

Specifications

Valve Body:
Cast Bronze*
(85-5-5-5)

Clapper Assembly:
Forged Brass

Seat:
NBR (Chloramine Resistant)

Sizes:
½" IPS
2" IPS
Female by female

Rated Pressure:
250 psi

*Contains lead. Not for use in water systems intended for human consumption.

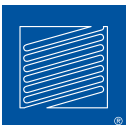

3198 LIONSHEAD AVE
CARLSBAD, CA 92010
TEL + 1 760 599-1168
+ 1 800 344-1822
FAX + 1 800 344-3775

© 2012 Fire Protection Products, Inc.

WWW.FPPI.COM