

## WARD DI-ELECTRIC UNION IRON TO BRASS

NPS	Overall Length A (min)	Length of Threads B (min)	Thru Hole C (min)	Width of Nut D (min)
*1/2 x 1/2	1.87	0.57	0.54	1.68
*3/4 x 1/2	1.87	0.64	0.74	1.68
*3/4 x 3/4	1.31	0.64	0.74	1.68

\* Manufactured to WARD specifications

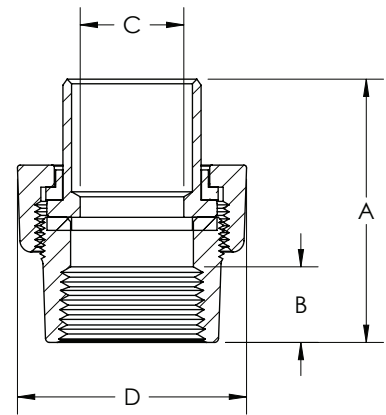

## WARD UNION BRASS TO BRASS SEAT CLASS 300

NPS	Overall Length A (min)	Length of Threads B (min)	Thru Hole C (min)	Width of Nut D (min)
1/4	1.55	0.43	0.30	1.33
3/8	1.71	0.47	0.42	1.50
1/2	1.81	0.57	0.54	1.76
3/4	2.12	0.64	0.74	2.15
1	2.31	0.75	0.95	2.48
1 1/4	2.66	0.84	1.27	3.02
1 1/2	2.85	0.87	1.50	3.28
2	2.23	1.00	1.93	3.96
2 1/2	3.33	1.17	2.32	4.72
3	4.09	1.23	2.90	5.37
*4	4.47	1.33	3.82	7.00

\*UL Standards not applicable to 4" size unions

