



P200 Series Molded-In-Place One Piece Ball Valves

BODY MATERIALS: PVC, CPVC

SIZES: 1/2" - 4"

END TYPES: Threaded, Socket, or CTS

SEAT: EPDM or PTFE (TEFLON)

"O"-RING: EPDM or FPM (VITON)

TEST PRESSURE: 225 PSI

WORKING PRESSURE: 150 PSI

<i>Molded-In-Place One Piece Ball Valves</i>	<i>Body</i>	<i>Ends</i>	<i>Seats</i>	<i>Seals</i>
<i>P200</i>	Schd 40 PVC	IPS	EPDM	EPDM
<i>P200S</i>	Schd 40 PVC	Socket	EPDM	EPDM
<i>P200-80</i>	Schd 80 PVC	IPS	EPDM	EPDM
<i>P200S-80</i>	Schd 80 PVC	Socket	EPDM	EPDM
<i>P200CTS</i>	CPVC	CTS	PTFE	EPDM
<i>P201</i>	Schd 80 PVC	IPS	PTFE	EPDM
<i>P201S</i>	Schd 80 PVC	Socket	PTFE	EPDM
<i>P202</i>	Schd 80 PVC	IPS	PTFE	VITON
<i>P202S</i>	Schd 80 PVC	Socket	PTFE	VITON
<i>P203</i>	CPVC	IPS	PTFE	EPDM
<i>P203S</i>	CPVC	Socket	PTFE	EPDM



- Low cost & convenient operation.
- Various applications: For water supply, building, housing, factory & marine equipment, water and waste treatment, chemical plants, agriculture, irrigation, multiple industrial uses, etc.
- Severe shock, loads and stress are absorbed by the valve body, not the ball and seat, minimizing the chance of uneven wear and leakage.
- Excellent flow characteristics.
- Suitable for hot water systems (CPVC).

SIZE			7mm	10mm	15mm	20mm	25mm	30mm	40mm	50mm	65mm	80mm	100mm
Nom.			(1/4")	(3/8")	(1/2""	(3/4")	(1")	(1-1/4")	(1-1/2")	(2")	(2-1/2")	(3")	(4")
thd/in	NPT		18	18	14	14	11.5	11.5	11.5	11.5	8	8	8
	BSPT		19	19	14	14	11	11	11	11	11	11	11
JIS	d2		-	17.78	21.7	25.7	31.67	37.57	47.54	59.44	75.87	88.83	113.98
	d1		-	18.4	22.3	26.3	32.33	38.43	48.46	60.56	76.6	89.6	114.7
BS	d2		-	17.1	21.3	26.7	33.5	42.2	48.2	60.3	75.1	88.8	114.2
	d1		-	17.3	21.5	26.9	33.7	42.4	48.4	60.5	75.3	89.1	114.5
ANSI	d2		-	17.04	21.23	26.57	33.27	42.04	48.11	60.17	72.85	88.7	114.07
	d1		-	17.45	21.54	26.87	33.65	42.42	48.56	60.36	73.38	89.31	114.76
DIN	d2		-	16.1	20.1	25.1	32.3	40.1	50.1	63.1	75.1	90.1	110.1
	d1		-	16.3	20.3	25.3	32.1	40.3	50.3	63.3	75.3	90.3	110.4
d			8	12	14	20	25	30	36	46.5	60	77	101
D1			20	24	30	38	45	54	62	77	92	106	135
L			52	68	83	95	106	114	130	147	204	229	300
L1			50	60	70	88	100	100	109	134	178	224	276
I	ANSI	SCH80	15.88 ^L	19.05	22.22 ^L	25.4 ^L	28.57	31.75	34.93	38.1	44.45	47.63	57.15
		SCH40	-	-	19	20	24	25.5	29.5	31	44.45	47.63	57.15
	DIN		15.88	19.05	22.22	25.4	28.57	31.75	34.93	38.1	44.45	47.63	57.15
	JIS		12	14	16	19	22	26	31	38	44	51	61
D			40	49	62	78	93	98	115	135	160	190	233
H1			28	34	43	54	65	67	78	89	105	124	148
H			25	31	38	49	57	63	75	92	110	133	170

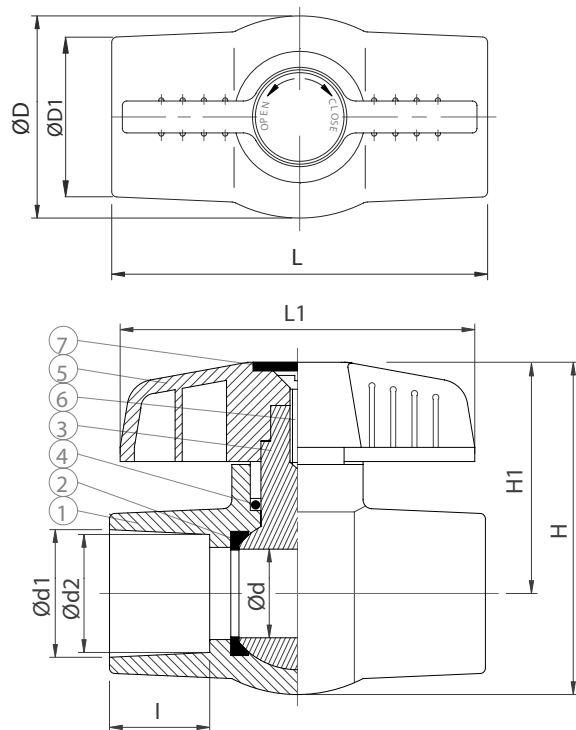

NO.	PART	MATERIAL	Q'TY
1	BODY	PVC, CPVC, ABS	1
2	SEAT SEAL	EPDM, PTFE	2
3	BALL	PVC, CPVC, ABS	1
4	O-RING	EPDM, FPM	1
5	HANDLE	ABS	1
6	BOLT	ZINC-PLATED STEEL	1
7	CAP	ABS	1

AMERICAN VALVE STATEMENT OF WARRANTY & LIMITATION OF WARRANTY

American Valve warrants, to its initial purchaser only, that its products which are delivered to this initial purchaser will be the kind described in the order or price list and will be free of defects in workmanship or material for a period of one year from the date of delivery to you, our initial purchaser.

Should any failure to conform to this warranty appear within one year after the date of the initial delivery to our initial purchaser, American Valve will, upon written notification thereof and substantiation that the goods have been stored, installed, maintained and operated in accordance with American Valve's recommendation and standard industry practice, correct such defects by suitable repair or replacement at American Valve's own expense. If any valve alleged to be defective, is returned to our factory at Greensboro, NC, it will be examined and, if found to be defective under the warranty, it will be replaced at no charge.

THIS WARRANTY IS EXCLUSIVE AND IS IN LIEU OF ANY IMPLIED WARRANTY OF MERCHANTABILITY, FITNESS FOR A PARTICULAR PURPOSE OR OTHER WARRANTY OF QUALITY, WHETHER EXPRESS OR IMPLIED, EXCEPT THE WARRANTY OF TITLE AND AGAINST PATENT INFRINGEMENT. Correction of non-conformities, in the manner and for the period of time provided above, shall constitute fulfillment of all liabilities of American Valve to our initial purchaser, with respect to the goods, whether based on contract, negligence, strict tort or otherwise, it is the intention of American Valve that no warranty of any kind, whether express or implied, shall pass through our initial purchaser to any other person or corporation.

LIMITATION OF LIABILITY: American Valve SHALL NOT UNDER ANY CIRCUMSTANCES BE LIABLE FOR SPECIAL OR CONSEQUENTIAL DAMAGES SUCH AS, BUT NOT LIMITED TO, DAMAGES OR LOSS OF OTHER PROPERTY OR EQUIPMENT, LOSS OF PROFITS, OR REVENUE, COST OF CAPITAL, COST OF PURCHASED OR REPLACEMENT GOODS, OR CLAIMS OF CUSTOMERS OF OUR INITIAL PURCHASER. THE REMEDIES OF OUR INITIAL PURCHASER, AND ALL OTHERS, SET FORTH HEREIN ARE EXCLUSIVE, AND THE LIABILITY OF AMERICAN VALVE WITH RESPECT TO SAME SHALL NOT, EXCEPT AS EXPRESSLY PROVIDED HEREIN, EXCEED THE PRICE OF GOODS UPON WHICH SUCH LIABILITY IS BASED.



P.O. Box 35229
Greensboro, NC 27425
Phone: 1-800-645-0101
Fax: 1-800-876-0109
<http://www.AmericanValve.com>