



# Scattering Tube Instructions

## PARTS

Disassemble the scattering tube and ensure you have the following parts:



OUTER TUBE



INNER TUBE



LID



STICKER



GLUE  
(Optional, Not Included)



FUNNEL  
(Optional, Not Included)

## INSTRUCTIONS

- 1 FILL THE INNER TUBE**  
Place the inner tube on a flat surface. Slowly fill the inner tube with ashes. A funnel may be used to make this process easier.
- 2 PREPARE THE SCATTERING TUBE FOR SEALING (Optional)**  
Squeeze a thin line of household glue around the top of the inner tube, approximately one inch below the rim. See Fig. 1
- 3 JOIN THE INNER AND OUTER TUBES**  
Slide the decorative outer tube carefully over the inner tube until it is firmly in place.
- 4 APPLY THE LABEL**  
Once the inner tube is securely encased by the outer tube, place the sticker over the outer tube's vent hole.
- 5 FIT THE LID**  
Flip the scattering urn over and slide the lid onto the tube.
- 6 SCATTER**  
Once you are ready to scatter, remove the lid. Carefully punch out the perforated tab on the top and gently scatter the ashes.

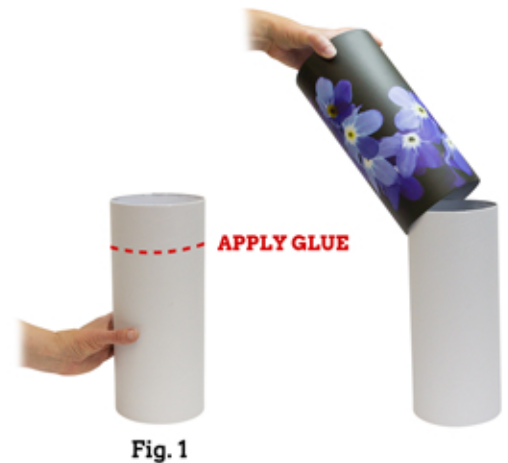

Need more help?  
Call us at (888) 872-0228

Scan this code with your smartphone to see our video on how to fill and use a scattering tube. The video can also be viewed here:  
<http://bit.ly/ScatteringTubeInstructions>



stardust  
memorials  
[www.stardust-memorials.com](http://www.stardust-memorials.com)