

Two line pricing gun Instructions T1940

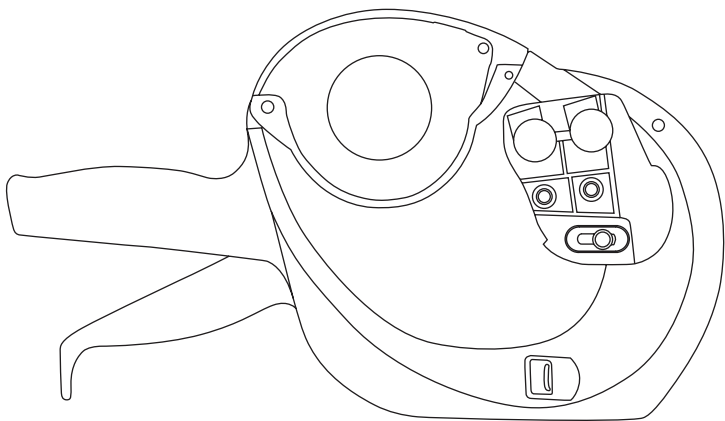

Question? Call us on 1300 11 SHOP

How to operate pricing gun



To open the base cover, pull back opening buttons that are located on both sides of the gun.

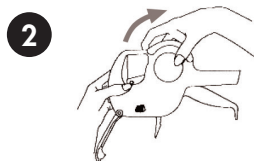

Open the cover of the label case as shown.

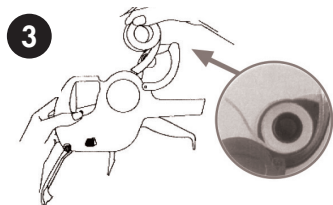

Put a label roll into roll holder.

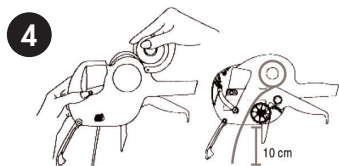

Insert label paper to the inside of the gun and bring it out of the base until about 10cm of the label paper comes out.

2

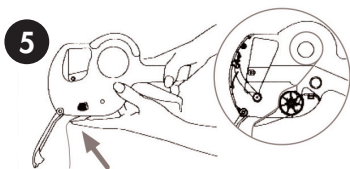

Close the base cover.

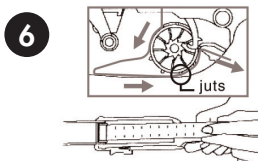

Adjust the label paper so that the holes of the paper are folded over juts of the feed roller.

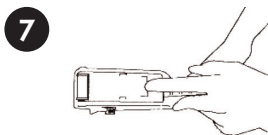

Close the base cover making sure that the label paper is tightly rolled over the feed roller.

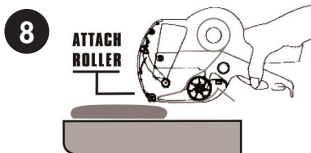

Pull the lever of the gun **three** times to feed the labels. Attach labels onto your desired position of the product by sliding attach roller onto the product.

How to replace ink roller

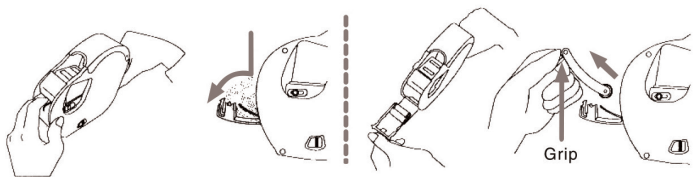

Press and pull the zigzag-shaped cover () to open the ink roller case.

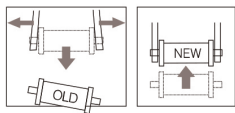

Pull the ink roller by the grip and replace the old ink roller with a new one.

Setting letters

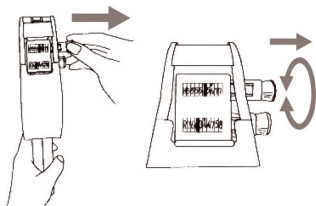

Pull the dial shaft outward and rotate it to set letters.

When finished setting letters, push the shaft inward.

Tip

- Black letter in white background shows what is printed on the label.
- Yellow background without letter means blank space.

Question? Call us on 1300 11 SHOP

How to fix printing position

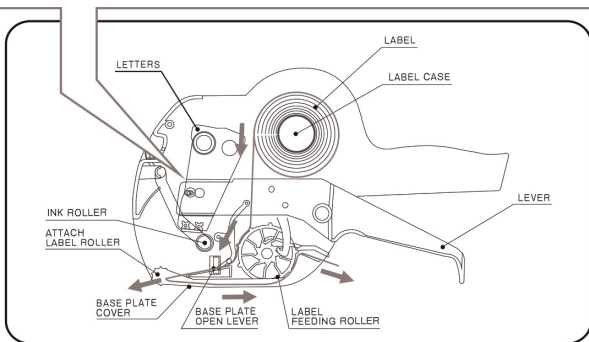
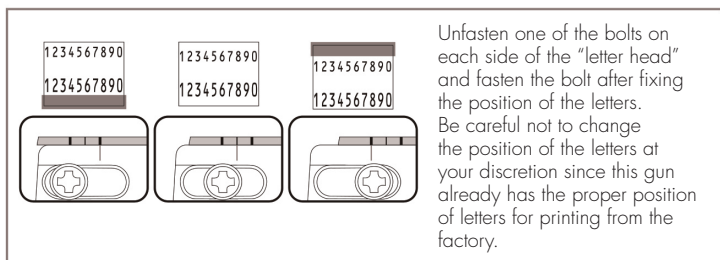

NOTE

It may cause damages when the gun is dropped over the height of 1m or when it is hit hard.

The gun is made of P.O.M resin and A.B.S, which is heat sensitive and a high temperature, over 60°degrees Celsius, may change the shape and the condition of the product.

Bring the product to Shop for Shops for any problems. Use only our parts and accessories with the product. Replacing any parts that are made from other companies may cause defects.