

RMP40 radio machine probe



© 2010–2019 Renishaw plc. All rights reserved.

This document may not be copied or reproduced in whole or in part, or transferred to any other media or language, by any means, without the prior written permission of Renishaw.

The publication of material within this document does not imply freedom from the patent rights of Renishaw plc.

Renishaw part no: H-5480-8504-04-A
First issued: 02.2010
Revised: 06.2019

Contents

Before you begin	1.1
Before you begin	1.1
Disclaimer	1.1
Trade marks	1.1
Warranty	1.1
Changes to equipment	1.1
CNC machines	1.1
Care of the probe	1.1
Patents	1.2
EU declaration of conformity	1.3
WEEE directive	1.3
REACH regulation	1.3
FCC Information to user (USA only)	1.3
Radio approval	1.4
Safety	1.6
RMP40 basics	2.1
Introduction	2.1
Getting started	2.1
System interface	2.1
Trigger Logic™	2.2
Probe modes	2.2
Configurable settings	2.2
Switch-on/switch-off methods	2.2
Enhanced trigger filter	2.3
Multiple probe mode	2.4
Acquisition mode	2.4
RMP40 dimensions	2.5
RMP40 specification	2.6
Typical battery life	2.7

System installation	3.1
Installing the RMP40 with an RMI or RMI-Q	3.1
Positioning the RMP40 and RMI or RMI-Q	3.2
Performance envelope	3.2
Preparing the RMP40 for use	3.3
Fitting the stylus	3.3
Installing the batteries	3.4
Mounting the probe on a shank	3.5
Stylus on-centre adjustment	3.6
Calibrating the RMP40	3.7
Why calibrate a probe?	3.7
Calibrating in a bored hole or on a turned diameter	3.7
Calibrating in a ring gauge or on a datum sphere	3.7
Calibrating the probe length	3.7
Trigger Logic™	4.1
Reviewing the probe settings	4.1
Multiple probe mode settings	4.2
Probe settings record	4.3
Changing the probe settings	4.4
RMP40 – RMI partnership	4.6
RMP40 – RMI-Q partnership	4.7
Operating mode	4.8
Maintenance	5.1
Maintenance	5.1
Cleaning the probe	5.1
Changing the batteries	5.2
RMP40M system	6.1
RMP40M system	6.1
RMP40M dimensions	6.2
RMP40M screw torque values	6.2
Fault-finding	7.1
Parts list	8.1

Before you begin

Before you begin

Disclaimer

RENISHAW HAS MADE CONSIDERABLE EFFORTS TO ENSURE THE CONTENT OF THIS DOCUMENT IS CORRECT AT THE DATE OF PUBLICATION BUT MAKES NO WARRANTIES OR REPRESENTATIONS REGARDING THE CONTENT. RENISHAW EXCLUDES LIABILITY, HOWSOEVER ARISING, FOR ANY INACCURACIES IN THIS DOCUMENT.

Trade marks

RENISHAW and the probe symbol used in the RENISHAW logo are registered trade marks of Renishaw plc in the United Kingdom and other countries. **apply innovation** and names and designations of other Renishaw products and technologies are trade marks of Renishaw plc or its subsidiaries.

Google Play and the Google Play logo are trademarks of Google LLC.

Apple and the Apple logo are trademarks of Apple Inc., registered in the U.S. and other countries. App Store is a service mark of Apple Inc., registered in the U.S. and other countries.

All other brand names and product names used in this document are trade names, trade marks, or registered trade marks of their respective owners.

Warranty

Equipment requiring attention under warranty must be returned to your equipment supplier.

Unless otherwise specifically agreed in writing between you and Renishaw, if you purchased the equipment from a Renishaw company, the warranty provisions contained in Renishaw's **CONDITIONS OF SALE** apply. You should consult these conditions in order to find out the details of your warranty but, in summary, the main exclusions from the warranty are if the equipment has been:

- neglected, mishandled or inappropriately used; or
- modified or altered in any way except with the prior written agreement of Renishaw.

If you purchased the equipment from any other supplier, you should contact them to find out what repairs are covered by their warranty.

Changes to equipment

Renishaw reserves the right to change equipment specifications without notice.

CNC machines

CNC machine tools must always be operated by fully trained personnel in accordance with the manufacturer's instructions.

Care of the probe

Keep system components clean and treat the probe as a precision tool.

Patents

Features of the RMP40, and other similar Renishaw products, are the subject of one or more of the following patents and/or patent applications:

CN	100466003	JP	3967592
CN	101287958	JP	4237051
CN	101482402	JP	4575781
EP	1185838	JP	4754427
EP	1373995	JP	4773677
EP	1425550	JP	4851488
EP	1457786	JP	5238749
EP	1477767	JP	5390719
EP	1477768	KR	1001244
EP	1576560	TW	I333052
EP	1701234	US	6776344
EP	1734426	US	6941671
EP	1804020	US	7145468
EP	1931936	US	7285935
EP	1988439	US	7441707
EP	2216761	US	7486195
IN	215787	US	7665219
WO	2004/057552	US	7812736
WO	2007/028964	US	7821420
		US	9140547

EU declaration of conformity



Renishaw plc declares under its sole responsibility that the RMP40 and RMP40M are in conformity with all relevant Union legislation.

The full text of the EU declaration of conformity is available at:

www.renishaw.com/mtpdoc

WEEE directive

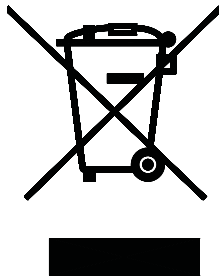

The use of this symbol on Renishaw products and/or accompanying documentation indicates that the product should not be mixed with general household waste upon disposal. It is the responsibility of the end user to dispose of this product at a designated collection point for waste electrical and electronic equipment (WEEE) to enable reuse or recycling. Correct disposal of this product will help to save valuable resources and prevent potential negative effects on the environment. For more information, please contact your local waste disposal service or Renishaw distributor.

REACH regulation

Information required by Article 33(1) of Regulation (EC) No. 1907/2006 ("REACH") relating to products containing substances of very high concern (SVHCs) is available at:

www.renishaw.com/REACH

FCC Information to user (USA only)

47 CFR Section 15.19

This device complies with part 15 of the FCC Rules. Operation is subject to the following two conditions:

1. This device may not cause harmful interference, and
2. This device must accept any interference received, including interference that may cause undesired operation.

47 CFR Section 15.21

The user is cautioned that any changes or modifications not expressly approved by Renishaw plc or authorised representative could void the user's authority to operate the equipment.

Radio approval

Argentina:

RMP40 CNC 16-9813
RMP40M CNC 16-9834

Australia:



Brazil:



Este equipamento não tem direito à proteção contra interferência prejudicial e não pode causar interferência em sistemas devidamente autorizados.

Canada:

RMP40 IC: 3928A-RMP40
RMP40M IC: 3928A-RMP40M

This device complies with Industry Canada licence-exempt RSS standard(s). Operation is subject to the following two conditions: (1) this device may not cause interference, and (2) this device must accept any interference, including interference that may cause undesired operation of the device.

Le présent appareil est conforme aux CNR d'Industrie Canada applicables aux appareils radio exempts de licence. L'exploitation est autorisée aux deux conditions suivantes : (1) l'appareil ne doit pas produire de brouillage, et (2) l'utilisateur de l'appareil doit accepter tout brouillage radioélectrique subi, même si le brouillage est susceptible d'en compromettre le fonctionnement.

Europe:



India:

RMP40 1783/2012/WRLO
RMP40M 1784/2012/WRLO

Japan:



Malaysia:

RMP40

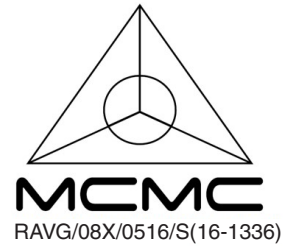

RMP40M

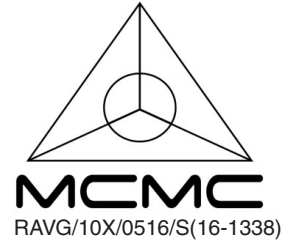

Mexico:

RMP40 ITF#RCPRERM18-0105
RMP40M ITF#RCPRERM18-0105-A1

“La operación de este equipo está sujeta a las siguientes dos condiciones:
(1) es posible que este equipo o dispositivo no cause interferencia perjudicial y
(2) este equipo o dispositivo debe aceptar cualquier interferencia, incluyendo la que pueda causar su operación no deseada.”

New Zealand:



Singapore:

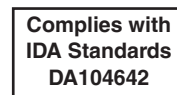

South Africa:

RMP40



RMP40M



South Korea:



Class A Equipment (Industrial Use)

이 기기는 업무용(A급) 전자파적합기기로서 판매자 또는 사용자는 이 점을 주의하시기 바라며, 가정외의 지역에서 사용하는 것을 목적으로 합니다.

Taiwan:

RMP40  CCAB10LP5080T0

RMP40M  CCAB10LP508BT4

警語

經型式認證合格之低功率射頻電機, 非經許可, 公司、商號或使用者均不得擅自變更頻率、加大功率或變更原設計之特性及功能。

低功率射頻電機之使用不得影響飛航安全及干擾合法通信; 經發現有干擾現象時, 應立即停用, 並改善至無干擾時方得繼續使用。

前項合法通信, 指依電信法規定作業之無線電通信。低功率射頻電機須忍受合法通信或工業、科學及醫療用電波輻射性電機設備之干擾。

USA:

RMP40 FCC ID: KQGRMP40

RMP40M FCC ID: KQGRMP40M

Israel Montenegro Russia Switzerland Turkey

Exempt: China Thailand Vietnam

Safety

Information to the user

The RMP40 and RMP40M are supplied with two non-rechargeable ½AA lithium-thionyl chloride batteries (approved to BS EN 62133:2013 [IEC 62133:2012]). Once the charge in these batteries is depleted, do not attempt to recharge them.

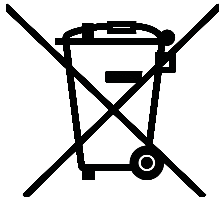

The use of this symbol on the batteries, packaging or accompanying documents indicates that used batteries should not be mixed with general household waste. Please dispose of the used batteries at a designated collection point. This will prevent potential negative effects on the environment and human health which could otherwise arise from inappropriate waste handling. Please contact your local authority or waste disposal service concerning the separate collection and disposal of batteries. All lithium and rechargeable batteries must be fully discharged or protected from short circuiting prior to disposal.

Please ensure replacement batteries are of the correct type and are fitted in accordance with the instructions in this manual (see Section 5, “Maintenance”), and as indicated on the product. For specific battery operating, safety and disposal guidelines, please refer to the battery manufacturer’s literature.

- Ensure that all batteries are inserted with the correct polarity.
- Do not store batteries in direct sunlight or rain.
- Do not heat or dispose of batteries in a fire.
- Avoid forced discharge of the batteries.
- Do not short-circuit the batteries.
- Do not disassemble, pierce, deform or apply excessive pressure to the batteries.
- Do not swallow the batteries.
- Keep the batteries out of the reach of children.
- Do not get batteries wet.
- If a battery is damaged, exercise caution when handling it.

Please ensure that you comply with international and national battery transport regulations when transporting batteries or the products.

Lithium batteries are classified as dangerous goods and strict controls apply to their shipment by air. To reduce the risk of shipment delays, if you need to return the RMP40 and RMP40M to Renishaw for any reason, do not return any batteries.

In all applications involving the use of machine tools or CMMs, eye protection is recommended.

The RMP40 and RMP40M have a glass window. Handle with care if broken to avoid injury.

Information to the machine supplier/ installer

It is the machine supplier’s responsibility to ensure that the user is made aware of any hazards involved in operation, including those mentioned in Renishaw product literature, and to ensure that adequate guards and safety interlocks are provided.

Under certain circumstances, the probe signal may falsely indicate a probe seated condition. Do not rely on probe signals to halt the movement of the machine.

Information to the equipment installer

All Renishaw equipment is designed to comply with the relevant EU and FCC regulatory requirements. It is the responsibility of the equipment installer to ensure that the following guidelines are adhered to, in order for the product to function in accordance with these regulations:

- any interface MUST be installed in a position away from any potential sources of electrical noise, i.e. power transformers, servo drives etc.;
- all 0 V/ground connections should be connected to the machine “star point” (the “star point” is a single point return for all equipment ground and screen cables). This is very important and failure to adhere to this can cause a potential difference between grounds;

- all screens must be connected as outlined in the user instructions;
- cables must not be routed alongside high current sources, i.e. motor power supply cables etc., or be near high-speed data lines;
- cable lengths should always be kept to a minimum.

Equipment operation

If this equipment is used in a manner not specified by the manufacturer, the protection provided by the equipment may be impaired.

This page is intentionally left blank.

RMP40 basics

Introduction

The RMP40 forms part of Renishaw's family of new generation radio transmission probes. It is ideally suited to large machining centres or where line-of-sight between probe and receiver is difficult to achieve or where Z travel is limited.

The RMP40 features an integrated probe module delivering exceptional robustness and generous overtravel.

The RMP40 complies with FCC regulations and operates in the 2.4 GHz band. It delivers interference-free transmission through the use of frequency hopping spread spectrum (FHSS), which allows several systems to operate in the same machine shop without risk of cross-interference.

All RMP40 settings are configured using "Trigger Logic™". This technique enables the user to review and subsequently change probe settings by deflecting the stylus whilst observing the LED display.

Configurable settings are:

- Radio on / radio off
- Radio on / timer off
- Spin on / spin off
- Spin on / timer off
- Filter on / filter off
- Multiple probe mode on / multiple probe mode off.

Getting started

Three multicolour LEDs provide visual indication of selected probe settings.

For example:

- Switch-on and switch-off methods
- Probe status – triggered or seated
- Battery condition

Batteries are inserted or removed as shown (see Section 3, "System installation" and Section 5, "Maintenance" for further information).

On insertion of batteries, the LEDs will begin to flash (see Section 4, "Trigger Logic™" for further information).

System interface

The RMI and RMI-Q integrated interfaces/receivers are used to communicate between the RMP40 probe and the machine controller.

Trigger Logic™

Trigger Logic™ (see Section 4, “Trigger Logic™”) is a method that allows the user to view and select all available mode settings in order to customise a probe to suit a specific application. Trigger Logic is activated by battery insertion and uses a sequence of stylus deflections (triggering) to systematically lead the user through the available choices to allow selection of the required mode options.

A Trigger Logic app is available that simplifies this process with clear, interactive instructions and informative videos and is available for download on the following app stores.



or



Current probe settings can be reviewed by simply removing the batteries for a minimum of 5 seconds, and then replacing them to activate the Trigger Logic review sequence.

Probe modes

The RMP40 probe can be in one of three modes:

Standby mode: where the probe is awaiting a switch-on signal.

Operational mode: activated by one of the switch-on methods described on the next page. In this mode the RMP40 is ready for use.

Configuration mode: where Trigger Logic may be used to configure the probe settings.

Configurable settings

Switch-on/switch-off methods

The following switch-on/switch-off options are user-configurable.

- Radio on / radio off
- Radio on / timer off
- Spin on / spin off
- Spin on / timer off

RMP40 switch-on method Switch-on options are configurable	RMP40 switch-off method Switch-off options are configurable	Switch-on time
<p>Radio on</p> <p>Radio switch on is commanded by machine input.</p>	<p>Radio off</p> <p>Radio switch off is commanded by machine input. A timer automatically switches the probe off 90 minutes after the last trigger if it is not turned off by machine input.</p> <p>Timer off (timeout)</p> <p>Timeout will occur 12, 33 or 134 seconds (user-configurable) after the last probe trigger or reset.</p>	<p>1 second maximum</p> <p>Note: This assumes a good radio communication link. In a poor RF environment this may rise to a maximum of 3 seconds.</p>
<p>Spin on</p> <p>Spin at 500 rev/min for 1 second minimum (6 seconds maximum).</p>	<p>Spin off</p> <p>Spin at 500 rev/min for 1 second minimum (6 seconds maximum). A timer automatically switches the probe off 90 minutes after the last trigger if it is not spun.</p> <p>Timer off (timeout)</p> <p>Timeout will occur 12, 33 or 134 seconds (user-configurable) after the last probe trigger or reset.</p>	<p>2 seconds maximum.</p> <p>Note: The 2 seconds starts from the moment the spindle reaches 500 rev/min.</p>

NOTE: After being switched on, the RMP40 must be on for 1 second minimum. When using spin on / spin off, ensure that the probe is stationary for 1 second minimum after it has stopped spinning before using spin on.

Enhanced trigger filter

Probes subjected to high levels of vibration or shock loads may output signals without having contacted any surface. The enhanced trigger filter improves the probe's resistance to these effects.

When the filter is enabled, a constant 10 ms delay is introduced to the probe's output.

The RMP40 is factory-set to trigger filter off.

NOTE: It may be necessary to reduce the probe approach speed to allow for the increased stylus overtravel during the extended time delay.

Multiple probe mode

The RMP40 can be configured, using Trigger Logic, to allow multiple radio probes to be used with a single RMI or RMI-Q.

NOTES:

The “radio on” switch-on method cannot be used in multiple probe mode. Multiple probe mode will not appear as an option if the “radio on” option has been selected.

RMP40 probes which are set to “multiple probe mode on” can coexist alongside any number of RMP40 probes set to “mode off”.

To allow multiple radio probes to work in close proximity, and with a single RMI or RMI-Q, 16 choices of “mode on” colours are available, each representing a different machine tool installation. The colour choices available are as shown in Section 4, “Trigger Logic™”.

All probes operating with a single RMI or RMI-Q must be set to the same “mode on” colour choice; any multiple probes located on adjacent machines must all be set to an alternative “mode on” colour choice.

Only one probe per “mode on” colour choice needs to be partnered with the RMI or RMI-Q as, by configuring multiple probes to a single “mode on” colour choice, all probes using this “mode on” colour choice will have the same identity. The probe to be partnered is partnered after selecting the “multiple probe mode” setting and choosing the “mode on” option. See Section 4, “Trigger Logic”.

There is no limit to the number of probes that can be used with a single RMI or RMI-Q as long as they all have the same “mode on” colour choice.

All RMP40 probes are factory-set to “mode off”.

The addition of any further probe(s) into a single probe installation will require that all probes are reconfigured to the same “mode on” colour choice and that one of the probes is then repartnered with the RMI or RMI-Q.

The addition of any further probe(s), or replacements, into a multi-probe installation can be achieved simply through the reconfiguration of the probe to the same “mode on” colour choice.

Acquisition mode

System set-up is achieved by using Trigger Logic and powering-on the RMI or RMI-Q, or applying ReniKey. Partnering is only required during initial system set-up. Further partnering will be required if the RMP40, RMI or RMI-Q is changed.

NOTES:

Systems using the RMI-Q can be partnered with up to four RMP40s manually. Alternatively this can be achieved by using ReniKey: a Renishaw machine macro cycle which does not require the RMI-Q to be power cycled.

For more information or to download ReniKey free of charge visit:

www.renishaw.com/mtpsupport/renikey

Partnering by ReniKey is not available for RMI.

Partnering will not be lost by reconfiguring the probe settings or changing the batteries, except where multiple probe mode is selected. Partnering can take place anywhere within the operating envelope.

RMP40 dimensions

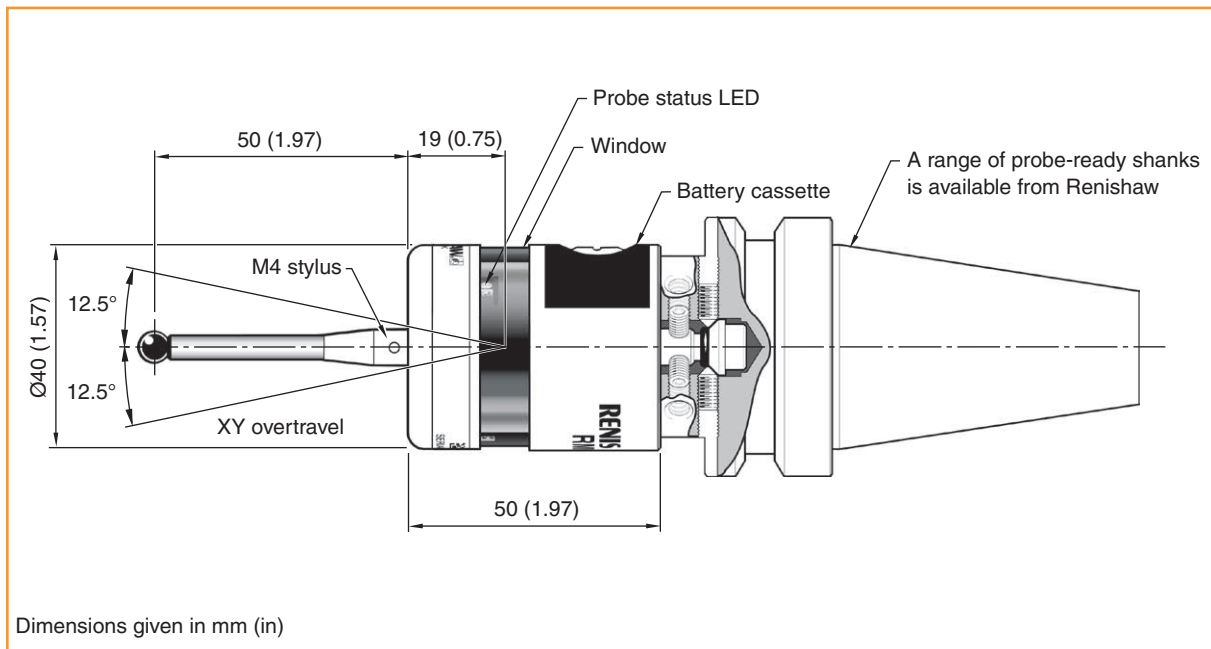

Stylus overtravel limits		
Stylus length	$\pm X/\pm Y$	Z
50 (1.97)	12 (0.47)	6 (0.24)
100 (3.94)	22 (0.87)	6 (0.24)

RMP40 specification

Principal application	Workpiece inspection and job set-up on machining centres and multi-tasking machines	
Dimensions	Length	50 mm (1.97 in)
	Diameter	40 mm (1.57 in)
Weight (without shank)	With batteries	250 g (8.82 oz)
	Without batteries	230 g (8.11 oz)
Transmission type	Frequency hopping spread spectrum (FHSS) radio	
Radio frequency	2400 MHz to 2483.5 MHz	
Switch-on methods	Radio M-code, spin	
Switch-off methods	Radio M-code, spin, timeout	
Spindle speed (maximum)	1000 rev/min	
Operating range	Up to 15 m (49.2 ft)	
Receiver/interface	RMI or RMI-Q combined antenna, interface and receiver unit	
Sense directions	Omni-directional $\pm X$, $\pm Y$, $+Z$	
Unidirectional repeatability Maximum 2σ value in any direction	1.00 μm (40 μin) 2σ (see note 1)	
Stylus trigger force (see notes 2 and 3) XY low force XY high force Z	0.50 N, 51 gf (1.80 ozf) 0.90 N, 92 gf (3.24 ozf) 5.85 N, 597 gf (21.04 ozf)	
Stylus overtravel	XY plane $+Z$ plane	$\pm 12.5^\circ$ 6 mm (0.24 in)
Environment	IP rating	IPX8, BS EN 60529:1992+A2:2013 (IEC 60529:1989+A1:1999+A2:2013)
	IK rating	IK01 (BS EN IEC 62262: 2002) [for glass window]
	Storage temperature	-10°C to $+70^\circ\text{C}$ ($+14^\circ\text{F}$ to $+158^\circ\text{F}$)
	Operating temperature	$+5^\circ\text{C}$ to $+55^\circ\text{C}$ ($+41^\circ\text{F}$ to $+131^\circ\text{F}$)

Note 1 Performance specification is tested at a standard test velocity of 480 mm/min (18.9 in/min) with a 50 mm stylus. Significantly higher velocity is possible depending on application requirements.

Note 2 Trigger force, which is critical in some applications, is the force exerted on the component by the stylus when the probe triggers. The maximum force applied will occur after the trigger point (overtravel). The force value depends on related variables including measuring speed and machine deceleration.

Note 3 These are the factory settings, manual adjustment is not possible.

Battery types	2 × ½AA 3.6 V lithium-thionyl chloride (LTC)
Battery reserve life	Approximately one week after a low battery warning is first given (based on 5% usage)
Low battery indication	Blue flashing LED in conjunction with normal red or green probe status LED
Dead battery indication	Constant or flashing red
Typical battery life	See the table below

Typical battery life

Spin switch on		Radio switch on		Continuous use
Standby life	5% usage (72 minutes/day)	Standby life	5% usage (72 minutes/day)	
240 days	150 days	290 days	170 days	450 hours

This page is intentionally left blank.

System installation

Installing the RMP40 with an RMI or RMI-Q

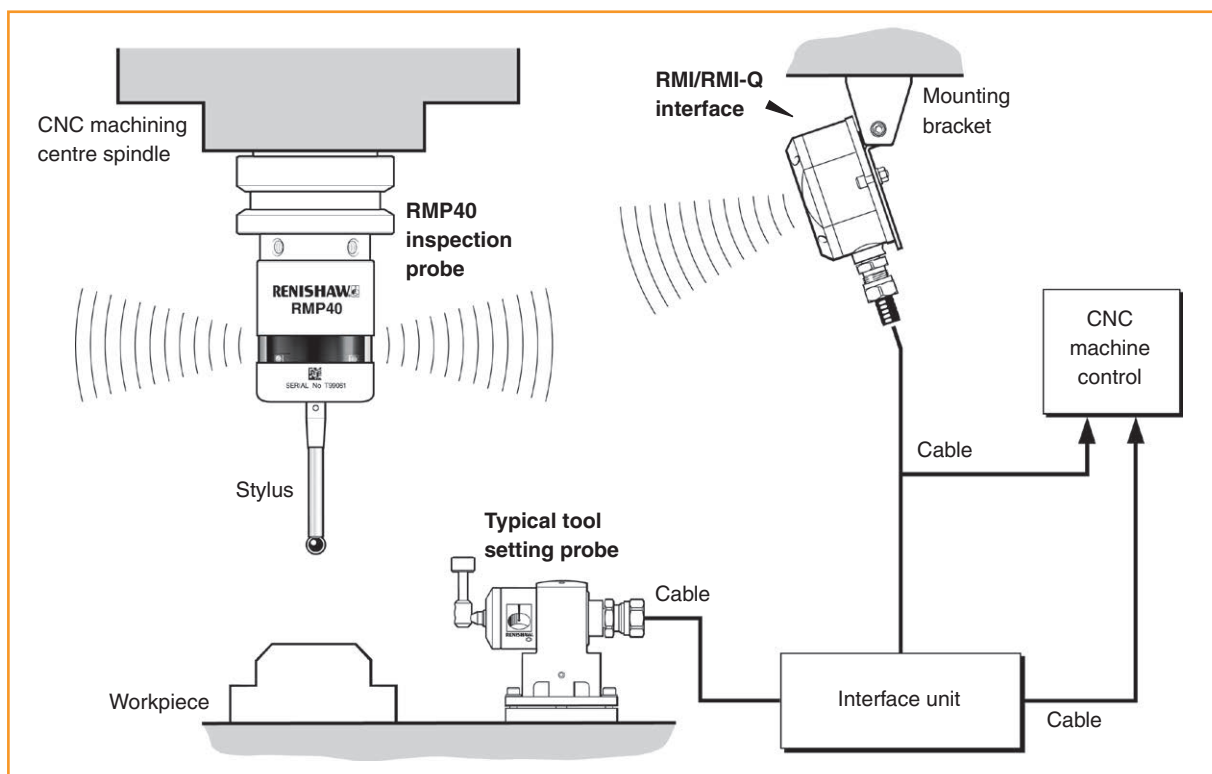

Radio transmission does not require line-of-sight and will pass through very small gaps and machine tool windows. This allows easy installation, either inside or outside the machine enclosure.

Coolant and swarf residue accumulating on the RMP40 and RMI or RMI-Q may have a detrimental effect on transmission performance. Wipe clean as often as is necessary to maintain unrestricted transmission.

When operating, do not cover the probe glass window, RMI or RMI-Q with your hands, as this will affect the performance.

Positioning the RMP40 and RMI or RMI-Q

The probe system should be positioned so that the optimum range can be achieved over the full travel of the machine's axes. Always face the front cover of the RMI or RMI-Q in the general direction of the machining area and the tool magazine, ensuring both are within the performance envelope shown below. To assist in finding the optimum position of the RMI or RMI-Q, the signal quality is displayed on an RMI or RMI-Q signal LED.

NOTE: Installing the RMP40 and RMI or RMI-Q with the RMP40 in radio-on configuration

The RMP40 has a built-in hibernation mode (battery-saving mode) that saves battery life when the RMI or RMI-Q is unpowered in radio-on (radio-off or timer-off) configurations. The RMP40 goes into hibernation mode 30 seconds after the RMI or RMI-Q is unpowered (or the RMP40 is out of range). When in hibernation mode, the RMP40 checks for a powered RMI or RMI-Q every 30 seconds. If found, the RMP40 goes from hibernation mode to standby mode, ready for radio-on.

Performance envelope

The RMP40 and RMI or RMI-Q must be within each other's performance envelope, as shown below. The performance envelope shows line-of-sight performance, however, radio transmission does not require this, as any reflected radio paths will be less than the 15 m (49.2 ft) operating range.

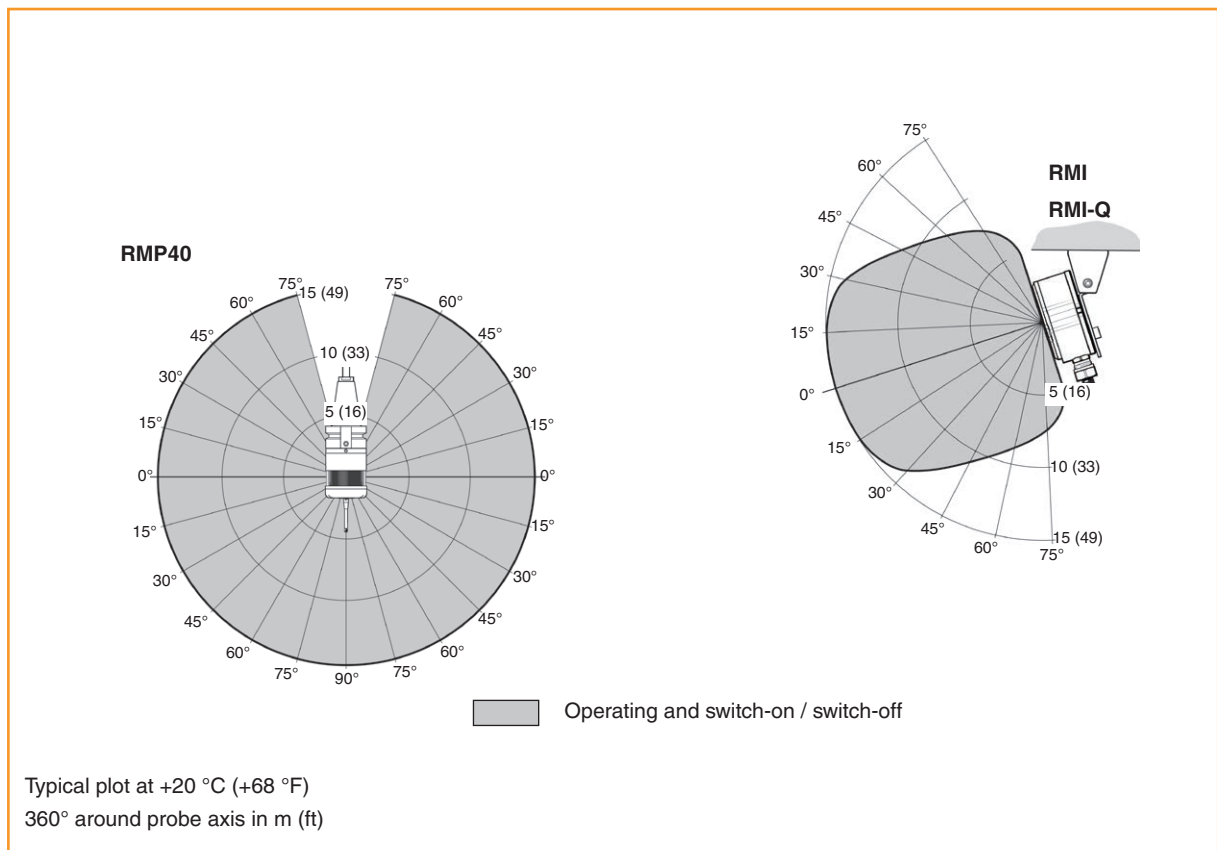

Preparing the RMP40 for use

Fitting the stylus



Installing the batteries

NOTES:

See Section 5, "Maintenance" for a list of suitable battery types.

If dead batteries are inadvertently inserted, the LEDs will remain a constant red.

Do not allow coolant or debris to enter the battery compartment. When inserting batteries, check that the battery polarity is correct.

After the batteries have been inserted, the LEDs will display the current probe settings (for details, see Section 4, "Trigger Logic™").



Mounting the probe on a shank

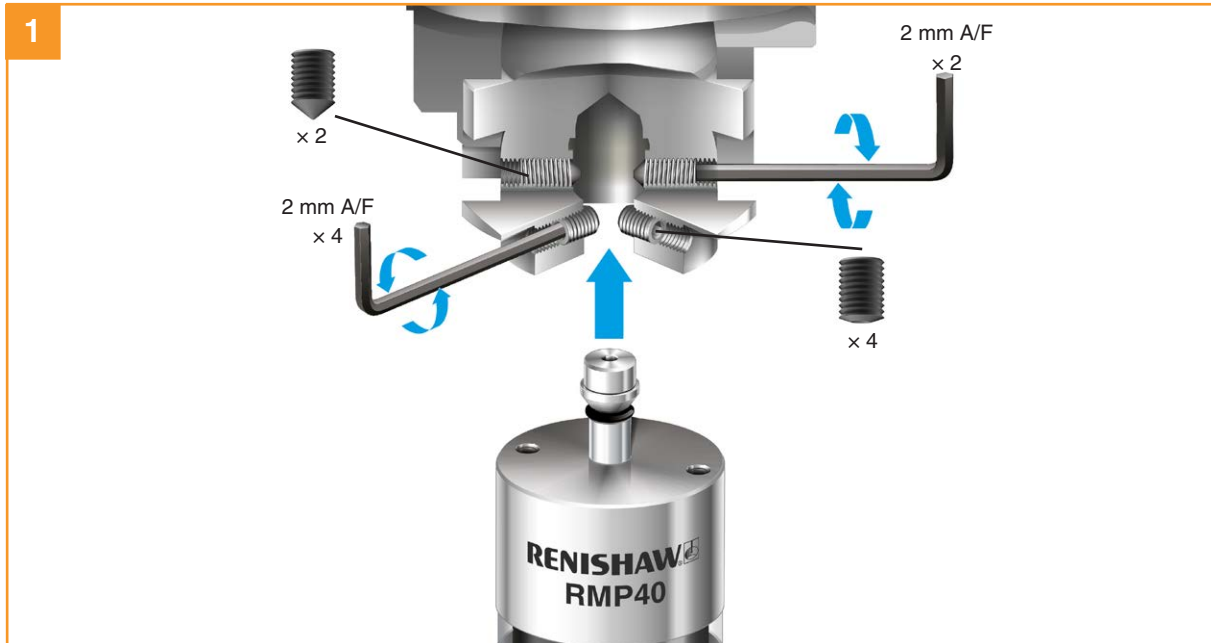

Stylus on-centre adjustment

NOTES:

If a probe and shank assembly is dropped, it must be rechecked for correct on-centre adjustment.

Do not hit or tap the probe to achieve on-centre adjustment.

1

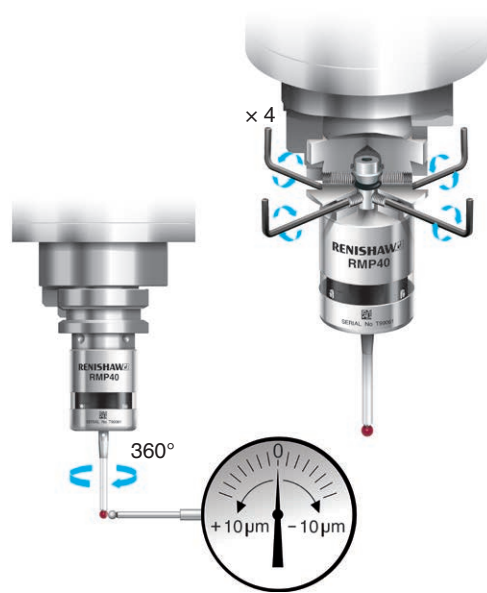

2

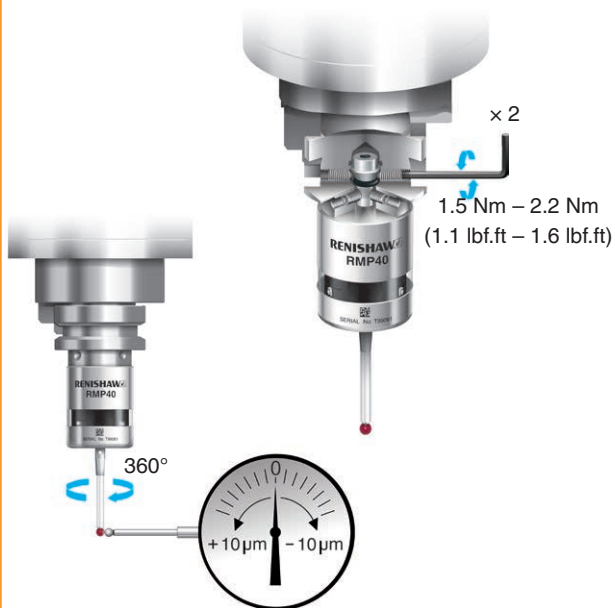

3

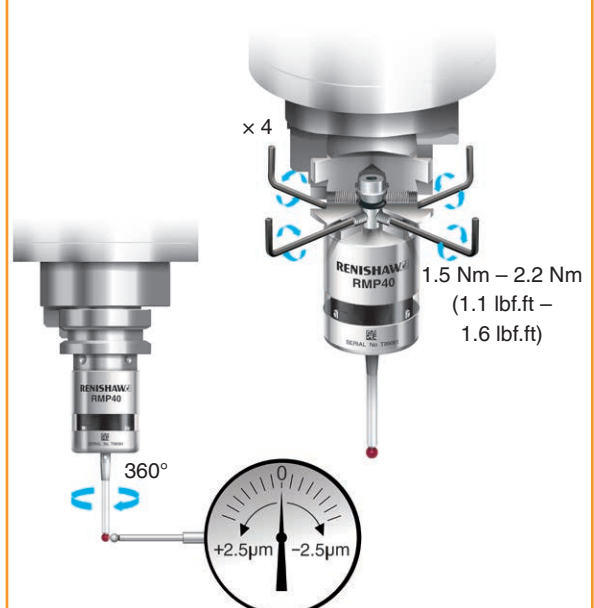

Calibrating the RMP40

Why calibrate a probe?

A spindle probe is just one component of the measurement system which communicates with the machine tool. Each part of the system can introduce a constant difference between the position that the stylus touches and the position that is reported to the machine. If the probe is not calibrated, this difference will appear as an inaccuracy in the measurement. Calibration of the probe allows the probing software to compensate for this difference.

During normal use, the difference between the touch position and the reported position does not change, but it is important that the probe is calibrated in the following circumstances:

- when a probe system is to be used for the first time;
- when a new stylus is fitted to the probe;
- when it is suspected that the stylus has become distorted or that the probe has been crashed;
- at regular intervals to compensate for mechanical changes of your machine tool;
- if repeatability of relocation of the probe shank is poor. In this case, the probe may need to be recalibrated each time it is selected.

It is good practice to set the tip of the stylus on-centre, because this reduces the effect of any variation in spindle and tool orientation (see “Stylus on-centre adjustment” earlier in this section). A small amount of run-out is acceptable, and can be compensated for as part of the normal calibration process.

Three different operations are to be used when calibrating a probe. They are:

- calibrating either in a bored hole or on a turned diameter of known position;
- calibrating either in a ring gauge or on a datum sphere;
- calibrating the probe length.

Calibrating in a bored hole or on a turned diameter

Calibrating a probe, either in a bored hole or on a turned diameter of known size, automatically stores values for the offset of the stylus ball to the spindle centre line. The stored values are then used automatically in the measuring cycles. Measured values are compensated by these values so that they are relative to the true spindle centre line.

Calibrating in a ring gauge or on a datum sphere

Calibrating a probe either in a ring gauge or on a datum sphere with a known diameter automatically stores one or more value for the radius of the stylus ball. The stored values are then used automatically by the measuring cycles to give the true size of the feature. The values are also used to give true positions of single surface features.

NOTE: The stored radius values are based on the true electronic trigger points. These values are different from the physical sizes.

Calibrating the probe length

Calibrating a probe on a known reference surface determines the length of the probe, based on the electronic trigger point. The stored value for length is different from the physical length of the probe assembly. Additionally, the operation can automatically compensate for machine and fixture height errors by adjusting the probe length value that is stored.

This page is intentionally left blank.

Trigger Logic™

Reviewing the probe settings

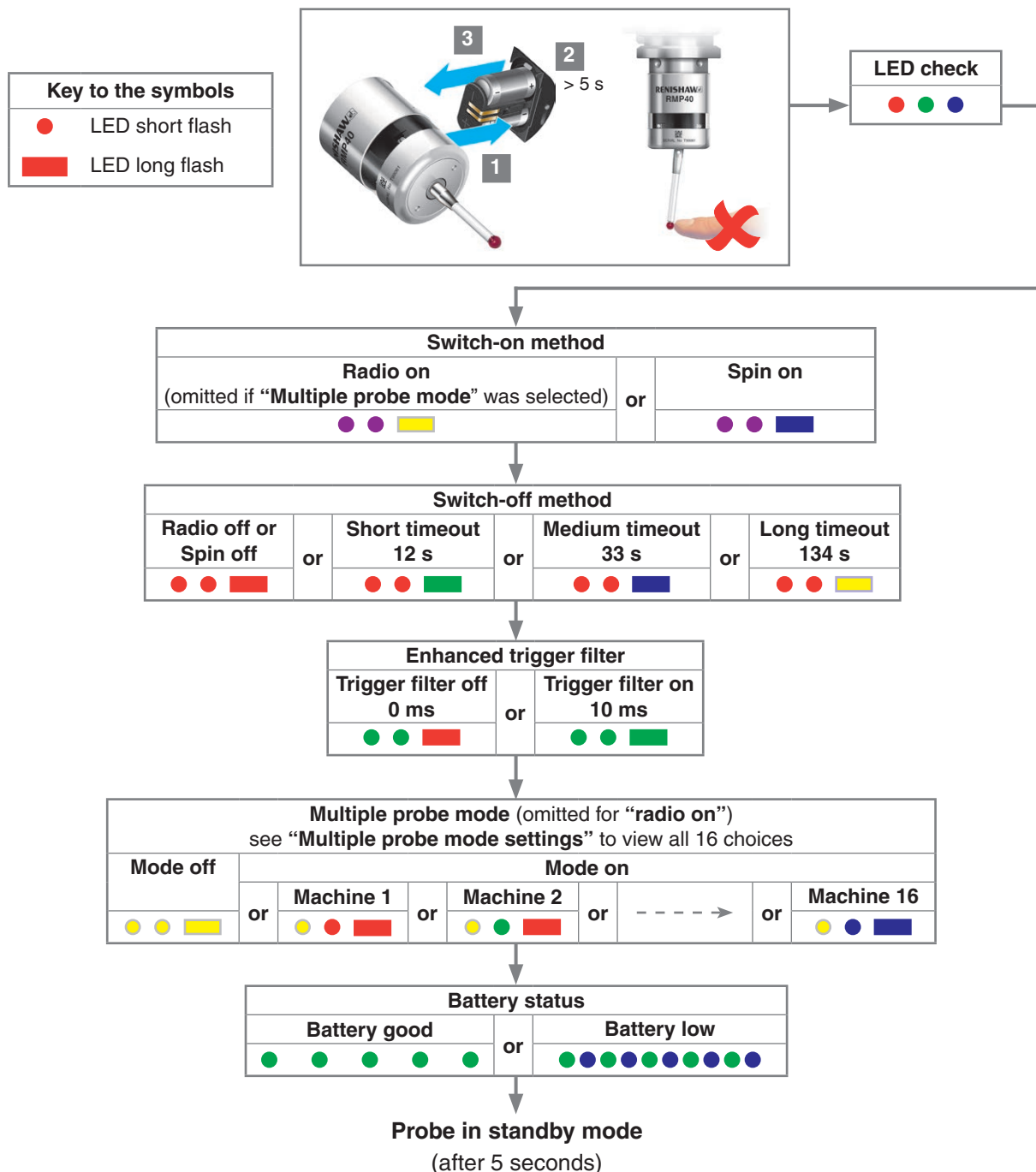

Multiple probe mode settings

Deflect the stylus for less than 4 seconds to cycle to the next setting.

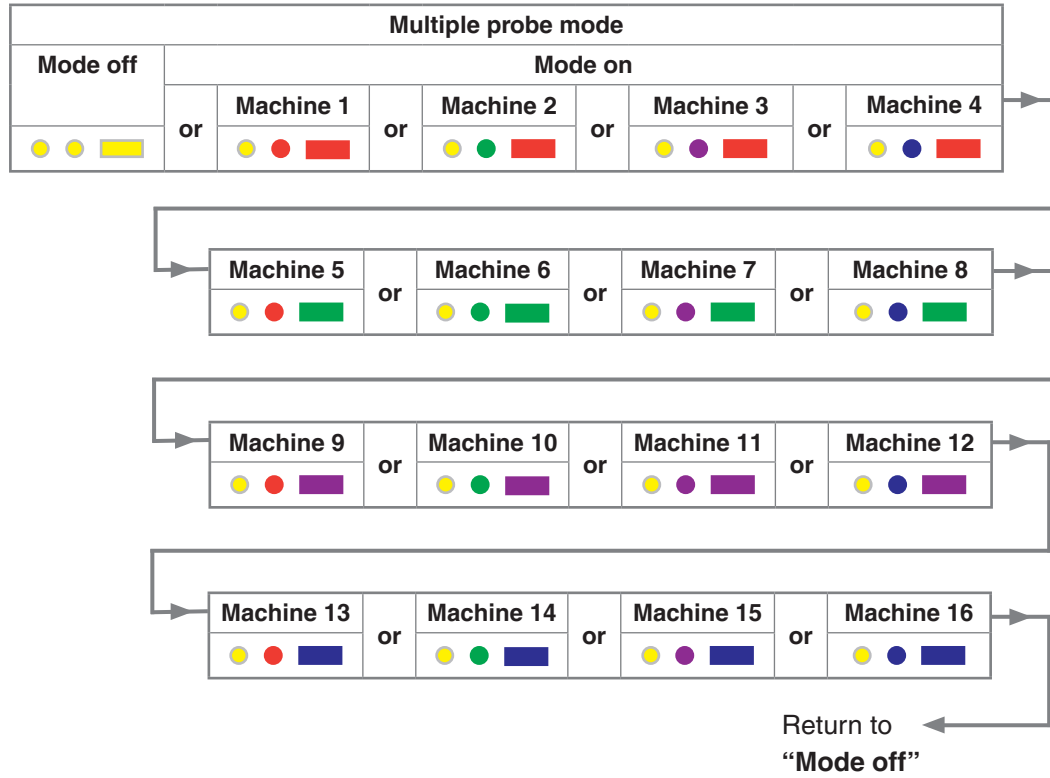

Probe settings record

This page is provided to note your probe's settings.

			✓ tick	✓ tick
			Factory settings	New settings
Switch-on method	Radio on		✓	
	Spin on			
Switch-off method	Radio or spin		✓	
	Short timeout (12 s)			
	Medium timeout (33 s)			
	Long timeout (134 s)			
Enhanced trigger filter	Trigger filter off (0 ms)		✓	
	Trigger filter on (10 ms)			
Multiple probe mode	Off (factory set)		✓	
	On (machine number)	See “ Multiple probe mode settings ”		

Changing the probe settings

Insert the batteries or, if they have already been installed, remove them for five seconds and then refit them.

Following the LED check, immediately deflect the stylus and hold it deflected until five red flashes have been observed (if the battery power is low, each red flash will be followed by a blue flash).

Keep the stylus deflected until the “**Switch-on method**” setting is displayed, then release it. The probe is now in configuration mode and Trigger Logic is activated.

CAUTION: Do not remove the batteries whilst in configuration mode. To exit, leave the stylus untouched for more than 20 seconds.

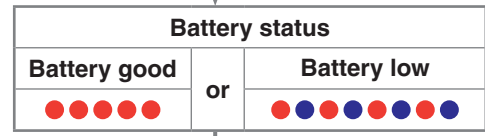
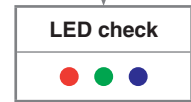
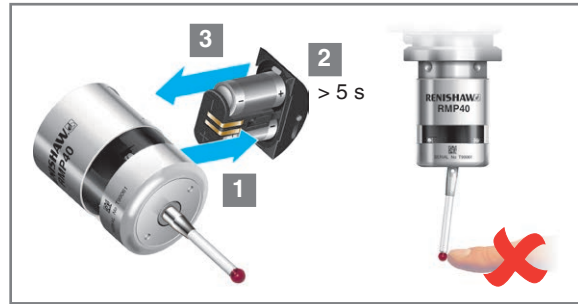

Key to the symbols	
●	LED short flash
	LED long flash
⇨	Deflect the stylus for less than 4 seconds to move to the next menu option.
⇩	Deflect the stylus for more than 4 seconds to move to the next menu.
⇩	To exit, leave the stylus untouched for more than 20 seconds.

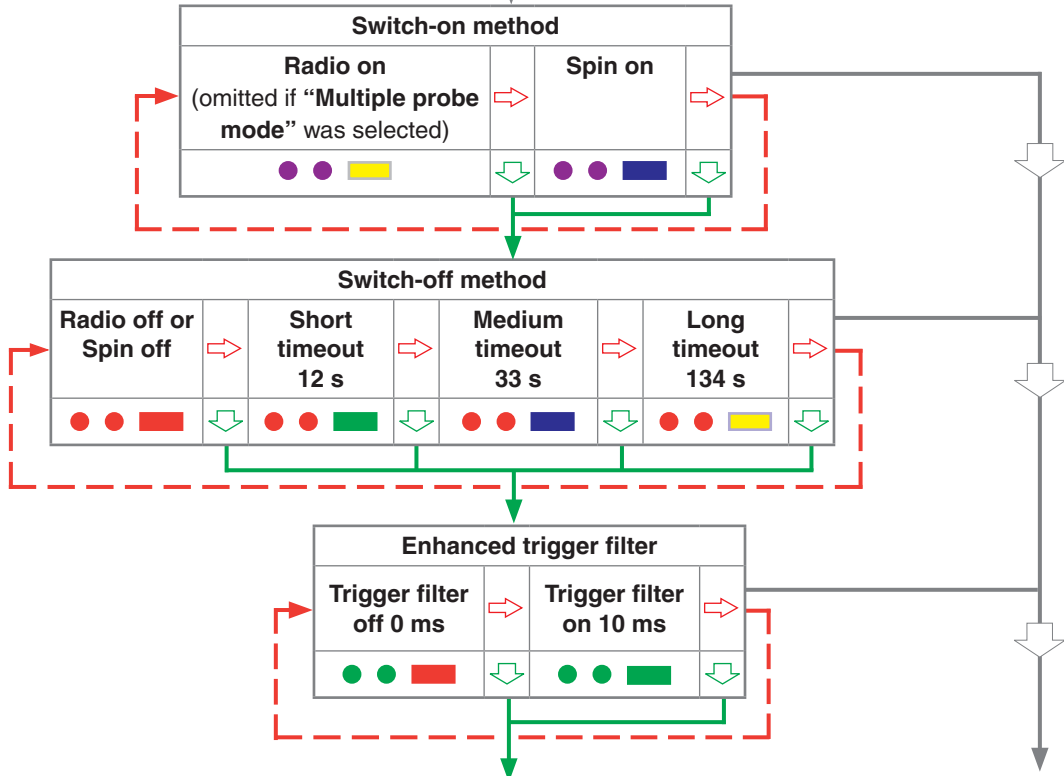

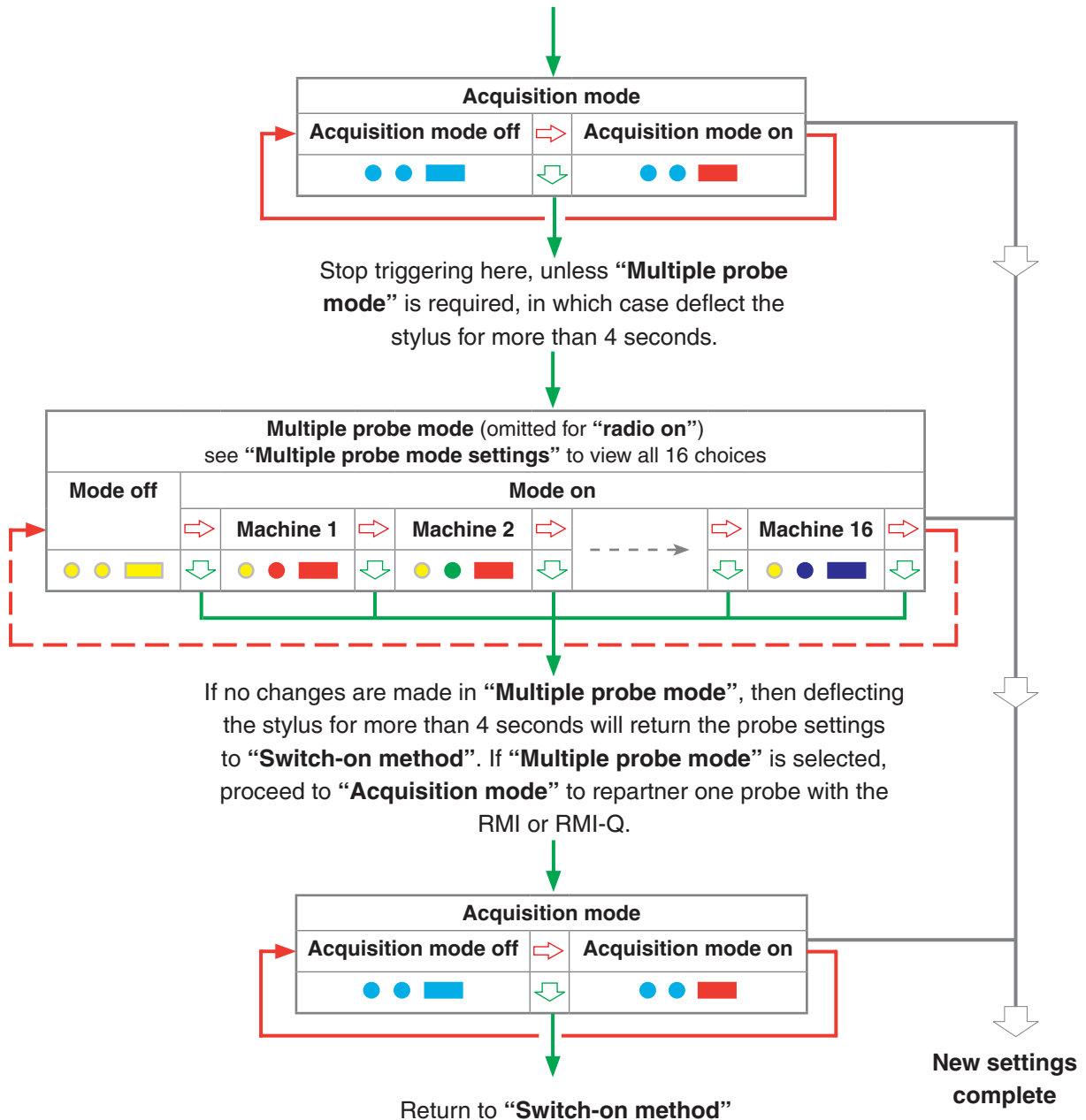

NOTE: If using multiple probe mode, refer to the *RMI radio machine interface* installation guide (Renishaw part no. H-4113-8554) or the *RMI-Q radio machine interface* installation guide (Renishaw part no. H-5687-8504).

NOTE: Further probes used require the same multiple probe mode setting, but do not need to be partnered with the RMI or RMI-Q.

NOTE: To partner an RMP40 with an RMI please see “RMP40 – RMI partnership”. Once acquisition has been successful, the RMP40 will revert to “**Acquisition mode off**”.

NOTE: To partner an RMP40 with an RMI-Q please see “RMP40 – RMI-Q partnership”. Once acquisition has been successful, the RMP40 will revert to “**Acquisition mode off**”.

RMP40 – RMI partnership

System set-up is achieved using Trigger Logic and powering the RMI. Partnering is only required during initial system set-up. Further partnering will be required if either the RMP40 or RMI is changed, or if a system is reconfigured for multiple probes (multiple probe mode).

Partnering will not be lost by reconfiguring the probe settings or when changing batteries, except where multiple probe mode is selected. Partnering can take place anywhere within the operating envelope.

In configuration mode, configure the probe settings as required until you reach the “**Acquisition mode**” menu, which defaults to “**Acquisition mode off**”.

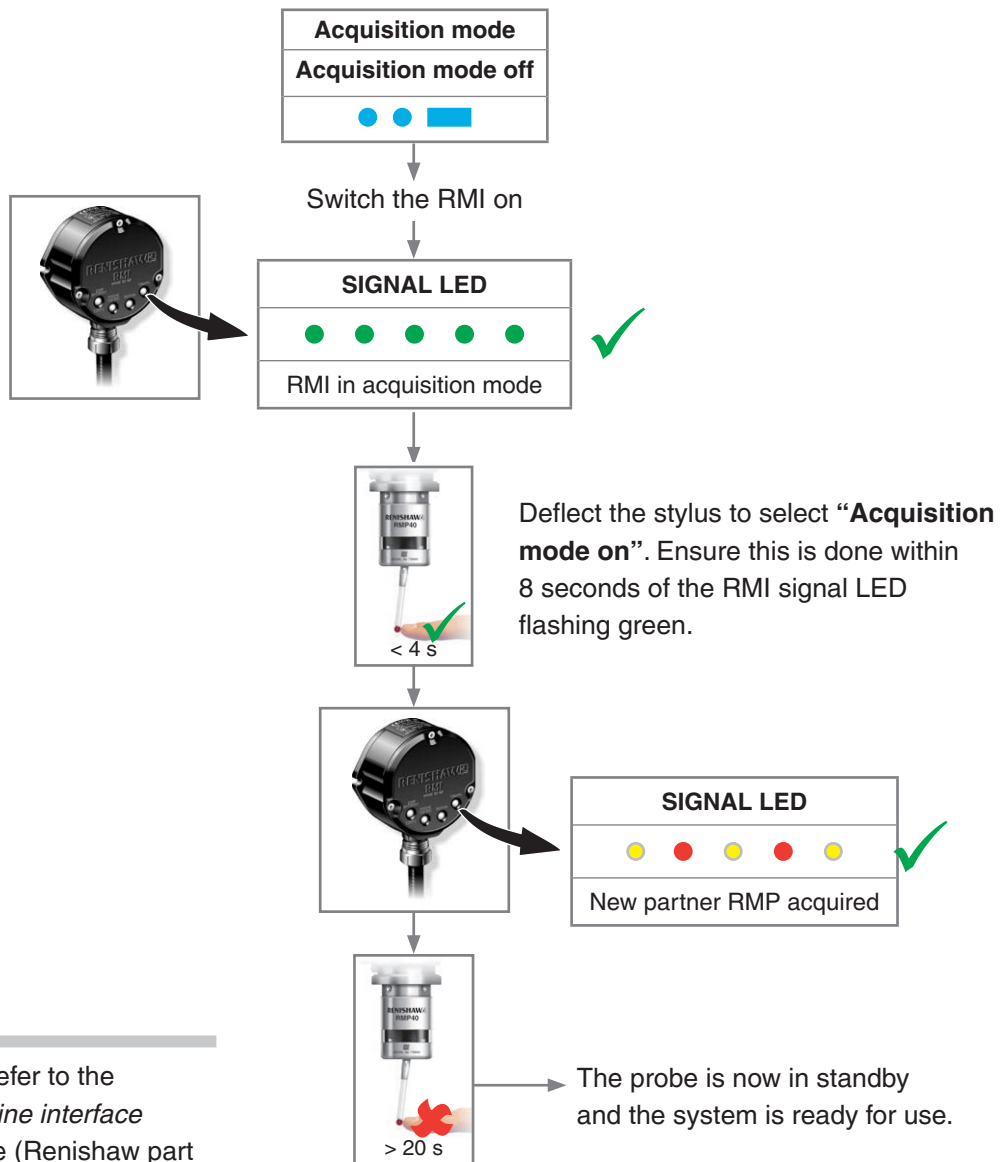

NOTE: Please refer to the *RMI radio machine interface* installation guide (Renishaw part no. H-4113-8554) when partnering the RMP40.

RMP40 – RMI-Q partnership

System set-up is achieved by using Trigger Logic and powering on the RMI-Q or applying ReniKey. Partnering is required during initial system set-up. Further partnering will be required if either the RMP40 or RMI-Q is changed.

Partnering will not be lost by reconfiguring the probe settings or changing the batteries. Partnering can take place anywhere within the operating envelope.

An RMP40 that is partnered with the RMI-Q but then used with another system will need to be repartnered before being used again with the RMI-Q.

In configuration mode, configure the probe settings as required until you reach the “**Acquisition mode**” menu, which defaults to “**Acquisition mode off**”.

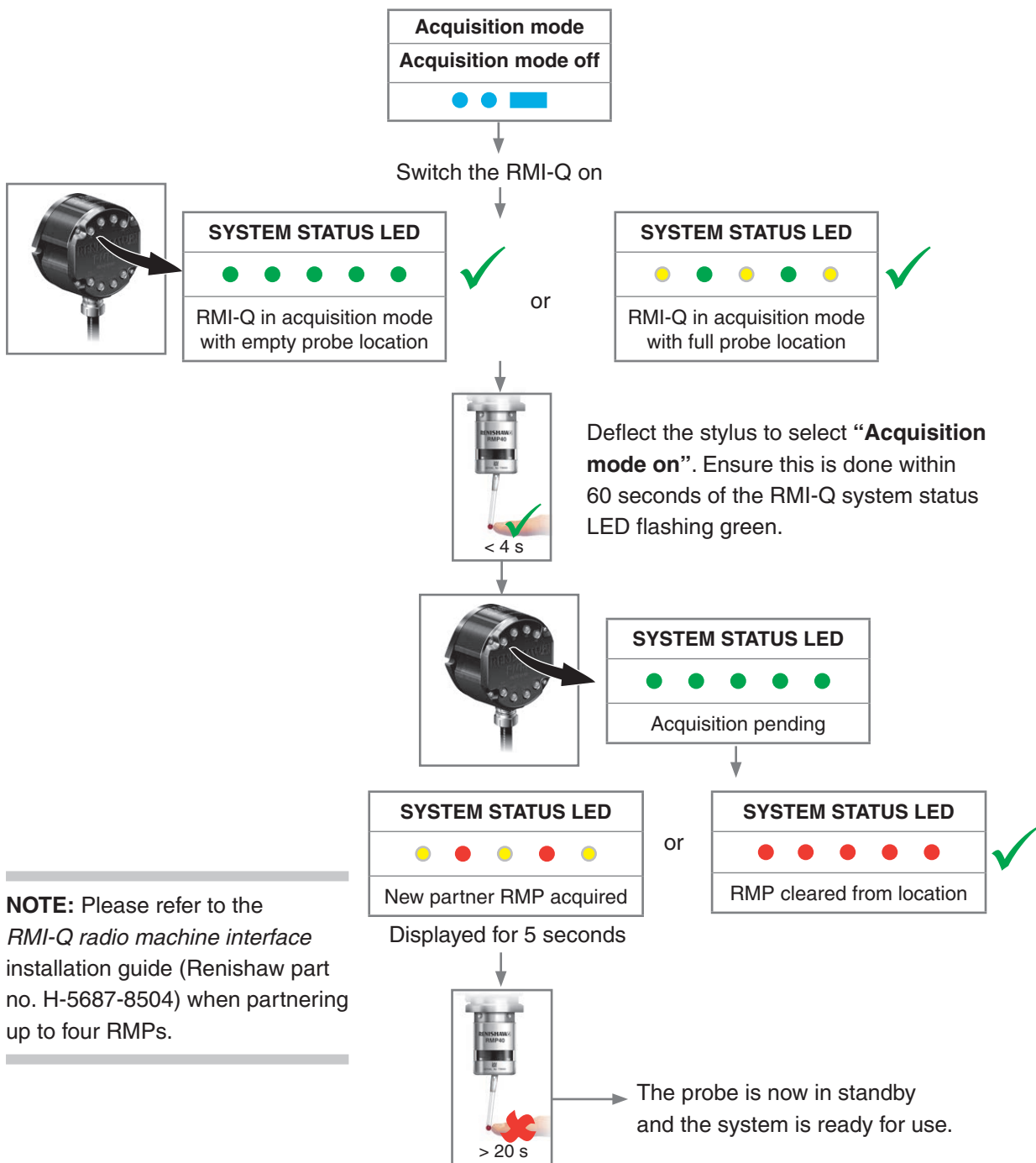

NOTE: Please refer to the *RMI-Q radio machine interface* installation guide (Renishaw part no. H-5687-8504) when partnering up to four RMPs.

Operating mode



Probe status LEDs

LED colour	Probe status	Graphic hint
Flashing green	Probe seated in operating mode	● ● ●
Flashing red	Probe triggered in operating mode	● ● ●
Flashing green and blue	Probe seated in operating mode – low battery	● ● ● ● ● ●
Flashing red and blue	Probe triggered in operating mode – low battery	● ● ● ● ● ●
Constant red	Battery dead	■
Flashing red or Flashing red and green or Sequence when batteries are inserted	Unsuitable battery	● ● ● ● ● ● ● ● ● ● ● ● ● ● ●

NOTE: Due to the nature of lithium-thionyl chloride batteries, if a “low battery” LED warning is ignored, it is possible for the following sequence of events to occur:

1. When the probe is active, the batteries discharge until battery power becomes too low for the probe to operate correctly.
2. The probe stops functioning, but then reactivates as the batteries recover sufficiently to provide the probe with power.
3. The probe begins to run through the LED review sequence (see “Reviewing the probe settings”).
4. Again, the batteries discharge and the probe ceases to function.
5. Again, the batteries recover sufficiently to provide the probe with power, and the sequence repeats itself.

Maintenance

5.1

Maintenance

You may undertake the maintenance routines described in these instructions.

Further dismantling and repair of Renishaw equipment is a highly specialised operation, which must be carried out at an authorised Renishaw Service Centre.

Equipment requiring repair, overhaul or attention under warranty should be returned to your supplier.

Cleaning the probe

Wipe the window of the probe with a clean cloth to remove machining residue. This should be done on a regular basis to maintain optimum transmission.



CAUTION: The RMP40 has a glass window. Handle with care if broken to avoid injury.

Changing the batteries

1



CAUTIONS:

Do not leave dead batteries in the probe.

When changing batteries, do not allow coolant or debris to enter the battery compartment.

When changing batteries, check that the battery polarity is correct.

Take care to avoid damaging the battery cassette gasket.

Only use specified batteries.

2

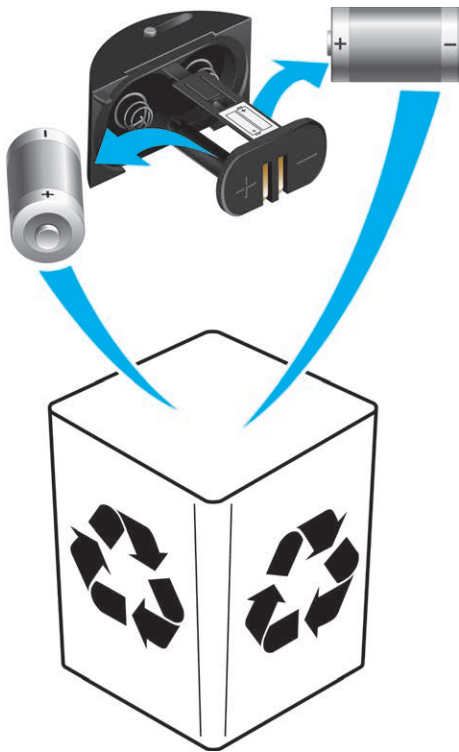

CAUTION: Please dispose of dead batteries in accordance with local regulations. Never dispose of batteries in a fire.

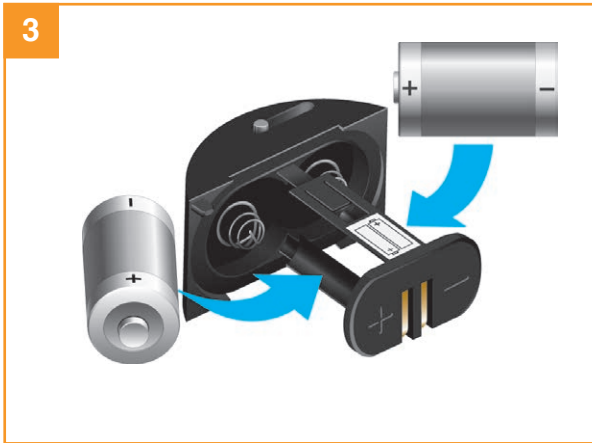

NOTES:

After removing the old batteries, wait more than 5 seconds before inserting the new batteries.

Do not mix new and used batteries or battery types, as this will result in reduced life and damage to the batteries.

Always ensure that the cassette gasket and mating surfaces are clean and free from dirt before reassembly.

If dead batteries are inadvertently inserted, the LEDs will remain a constant red.

Battery type	
½ AA Lithium-thionyl chloride (3.6 V) × 2	
Saft: LS 14250	✓
Tadiran: SL-750	
Xeno: XL-050F	
Dubilier: SB-AA02	✗
Maxell: ER3S	
Sanyo: CR 14250SE	
Tadiran: SL-350, SL-550, TL-4902, TL-5902, TL-2150, TL-5101	
Varta: CR ½ AA	



This page is intentionally left blank.

RMP40M system

RMP40M system

RMP40M is a special modular version of RMP40. It enables probe inspection of part features inaccessible to RMP40, by fitting selected adaptors and extensions as shown below.

See Section 8, "Parts list".

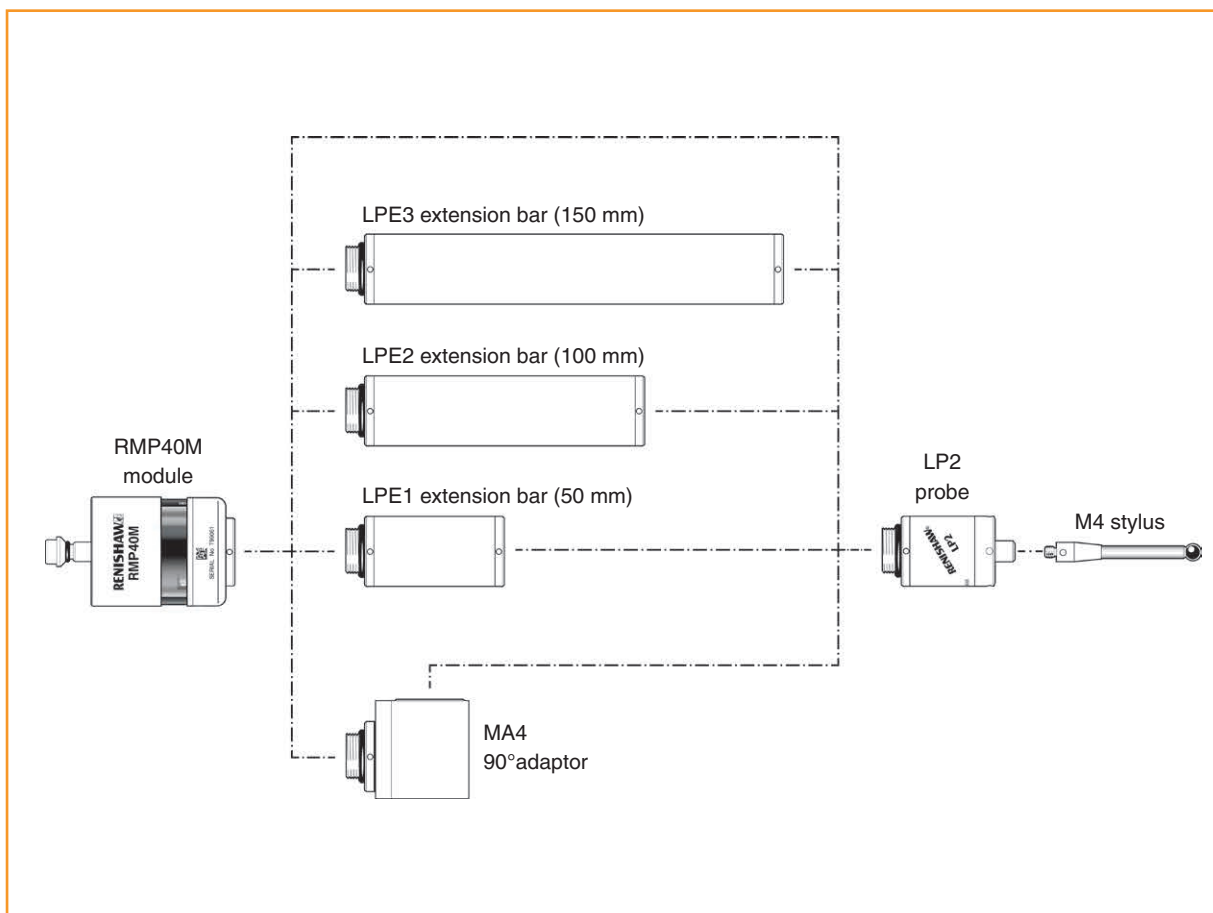

RMP40M dimensions

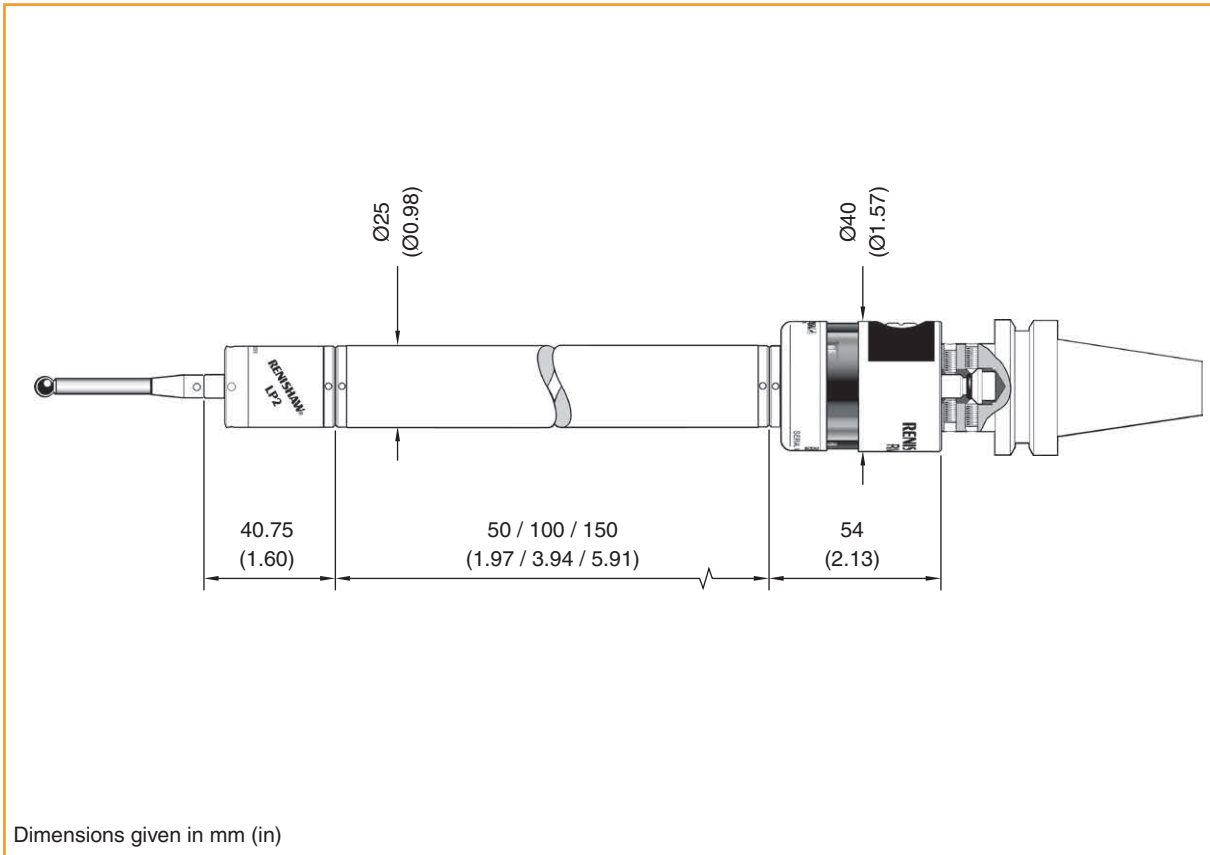

RMP40M screw torque values

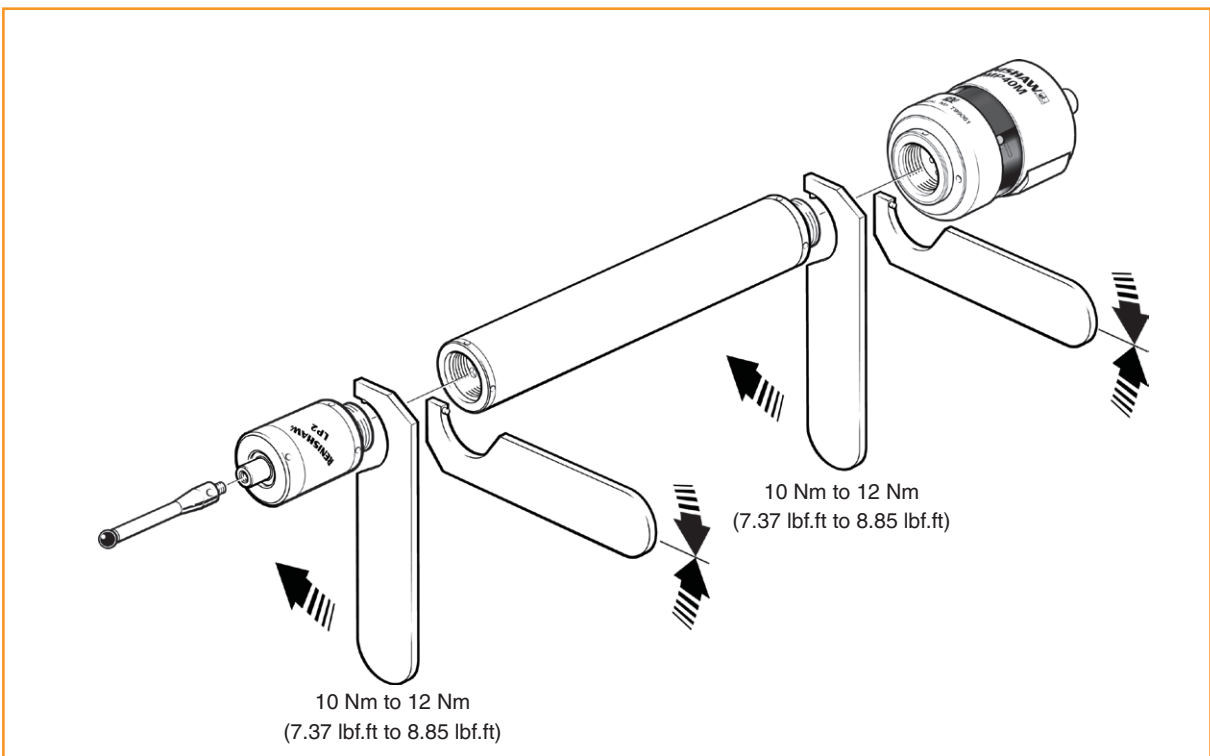

Fault-finding

Symptom	Cause	Action
Probe fails to power up (no LEDs illuminated or fails to indicate current probe settings).	Dead batteries.	Change batteries.
	Unsuitable batteries.	Fit suitable batteries.
	Batteries inserted incorrectly.	Check battery insertion/polarity.
	Batteries removed for too short a time and probe has not reset.	Remove batteries for a minimum of 5 seconds.
	Poor connection between battery cassette mating surfaces and contacts.	Remove any dirt and clean the contacts before reassembly.
Probe fails to switch on.	Dead batteries.	Change batteries.
	Batteries inserted incorrectly.	Check battery insertion/polarity.
	Probe out of range.	Check position of RMI or RMI-Q, (see operating envelope).
	No RMI or RMI-Q “start/stop” signal (radio on method only).	Check RMI or RMI-Q for green start LED.
	Incorrect spin speed (spin-on method only).	Check spin speed and duration.
	Incorrect switch-on method configured.	Check configuration and alter as required.
	Incorrect multiple probe mode setting configured.	Check configuration and alter as required.

Symptom	Cause	Action
Machine stops unexpectedly during a probing cycle.	Radio link failure/RMP40 out of range.	Check interface/receiver and remove obstruction.
	RMI or RMI-Q receiver/machine fault.	Refer to receiver/machine user's guide.
	Dead batteries.	Change batteries.
	Excessive machine vibration causing false probe trigger.	Enable enhanced trigger filter.
	Probe unable to find target surface.	Check that part is correctly positioned and that stylus has not broken.
	Stylus not given sufficient time to settle from a rapid deceleration.	Add a short dwell before the probing move (length of dwell will depend on stylus length and rate of deceleration). Maximum dwell is one second.
Probe crashes.	Workpiece obstructing probe path.	Review probing software.
	Probe length offset missing	Review probing software.
	In cases where there is more than one probe on a machine, incorrect probe activated.	Review interface wiring or part program.

Symptom	Cause	Action
Poor probe repeatability and/or accuracy.	Debris on part or stylus.	Clean part and stylus.
	Poor tool change repeatability.	Redatum probe after each tool change.
	Loose probe mounting on shank or loose stylus.	Check and tighten as appropriate.
	Excessive machine vibration.	Enable enhanced trigger filter. Eliminate vibrations.
	Calibration out of date and/or incorrect offsets.	Review probing software.
	Calibration and probing speeds not the same.	Review probing software.
	Calibration feature has moved.	Correct the position.
	Measurement occurs as stylus leaves surface.	Review probing software.
	Measurement occurs within the machine's acceleration and deceleration zone.	Review probing software and probe filter settings.
	Probing speed too high or too slow.	Perform simple repeatability trials at various speeds.
	Temperature variation causes machine and workpiece movement.	Minimise temperature changes.
RMP40 status LEDs do not correspond to RMI or RMI-Q status LEDs.	Radio link failure – RMP40 out of RMI or RMI-Q range.	Check position of RMI or RMI-Q, see operating envelope.
	RMP40 has been enclosed/shielded by metal.	Remove from obstruction.
	RMP40 and RMI or RMI-Q are not partnered.	Partner RMP40 and RMI or RMI-Q.

Symptom	Cause	Action
RMI or RMI-Q error LED lit during probing cycle.	Probe not switched on or probe timed out.	Change setting. Review switch-off method.
	Probe out of range.	Check position of RMI or RMI-Q, see operating envelope.
	Dead batteries.	Fit new batteries.
	RMP40 and RMI or RMI-Q are not partnered.	Partner RMP40 with RMI or RMI-Q.
	Probe selection error.	Verify that one RMP is working and is correctly selected on the RMI or RMI-Q.
	0.5 second turn-on error.	Ensure that all RMPs are "Q" marked probes, or change the RMI-Q turn-on time to 1 second.
RMI or RMI-Q low battery LED lit.	Low batteries.	Change batteries soon.
Reduced range.	Local radio interference.	Identify and remove.
Probe fails to switch off.	Incorrect switch-off method configured.	Check configuration and alter as required.
	No RMI or RMI-Q "start/stop" signal (radio on method only).	Check RMI or RMI-Q for green start LED.
	Probe in timeout mode and placed in tool magazine and being triggered by movement.	Use shorter timeout setting or use different switch-off method.
	Incorrect spin speed (spin switch on only).	Check spin speed.
Probe goes into Trigger Logic™ configuration mode and cannot be reset.	Probe was triggered when batteries were inserted.	Do not touch the stylus or stylus mounting face during battery insertion.

Parts list

Type	Part number	Description
RMP40	A-5480-0001	RMP40 probe with batteries, tool kit and quick-start guide (factory-set to radio on / radio off, trigger filter off).
RMP40M module	A-5628-0001	RMP40M module with batteries, tool kit and quick-start guide (factory-set to radio on / radio off, trigger filter off).
Battery	P-BT03-0007	½AA battery – lithium-thionyl chloride (two required).
Stylus	A-5000-3709	PS3-1C ceramic stylus 50 mm long with Ø6 mm ball.
Probe tool kit	A-4071-0060	Kit comprising: Ø1.98 mm stylus tool, 2 mm A/F hexagon key, M4 × 6 mm cone point grub screw (× 2), and M4 × 6 mm flat point grub screw (× 4).
Battery cassette	A-4071-1166	RMP40 battery cassette assembly.
Cassette seal	A-4038-0301	Battery cassette housing seal.
RMI	A-4113-0050	RMI (side exit) with 15 m (49.2 ft) cable, tool kit and user's guide.
RMI-Q	A-5687-0050	RMI-Q (side exit) with 15 m (49.2 ft) cable, tool kit and user's guide.
Mounting bracket	A-2033-0830	Mounting bracket with fixing screws, washers and nuts.
Styli tool	M-5000-3707	Tool for tightening/releasing styli.
LP2	A-2063-6098	LP2 probe.
LPE1	A-2063-7001	LPE1 extension bar – 50 mm long.
LPE2	A-2063-7002	LPE2 extension bar – 100 mm long.
LPE3	A-2063-7003	LPE3 extension bar – 150 mm long.
MA4	A-2063-7600	MA4 90° adaptor assembly.
Publications. These can be downloaded from our web site at www.renishaw.com .		
RMP40	H-5480-8500	Quick-start guide: for rapid set-up of the RMP40 probe.
RMI	A-4113-8550	Quick-start guide: for rapid set-up of the RMI (includes CD with installation guides).
RMI-Q	H-5687-8500	Quick-start guide: for rapid set-up of the RMI-Q.
Styli	H-1000-3200	Technical specifications guide: Styli and accessories – or visit our Web shop at www.renishaw.com/shop .
Probe software	H-2000-2298	Data sheet: Probe software for machine tools – programs and features.
Taper shanks	H-2000-2011	Data sheet: taper shanks for machine tool probes.

Renishaw plc
New Mills, Wotton-under-Edge
Gloucestershire, GL12 8JR
United Kingdom

T +44 (0)1453 524524
F +44 (0)1453 524901
E uk@renishaw.com
www.renishaw.com

RENISHAW 
apply innovation™

For worldwide contact details, visit
www.renishaw.com/contact



H - 5480 - 8504 - 04