

Features

- Easy to use, minimum training required
- Enables the evacuation of one or two persons from an elevated position to a lower level or the ground
- Automatically controls rate of descent
- Constant descent speed of 235 ft./min. (72 m/min.) for one person and of 295 ft./min. (90 m/min.) for two
- Up to 1,300 ft. (400 m) of descent for one person and up to 650 ft. (200 m) of descent for two
- Multi-person rescue capability
- Snap hooks located at each end of the rope allow for multiple evacuations
- Operation can be carried out down a cableway or tagline positioned at an angle between 30° and 60°
- Available with hand crank winch for limited lifting
- Dual descent pig tails
- Intergraded jamming cleat that gives the user more control during a rescue
- External cooling fins ensure that the unit is rapidly ready for consecutive descents
- Utilizes ¾-in. (9 mm) Kernmantle rope
- Meets ANSI Z359.4-07 and CSA Z259.2.3, type 1E



DEROPE® T DESCENT DEVICE SYSTEMS

Standard Derope® allows a back and forth evacuation upwards as downwards.

- Derope® T descent device unit
- 6-ft. (1.8 m) vinyl covered wire rope sling (V4173)
- ¾-in. (19 mm) carbon steel autolocking carabiner (PM11Z)
- J-knife (KSOS)
- Rescue/rope bag (XB23144 or XB26168)

Part #	Description
KT7200/TK	200 ft. (60 m) Derope® rescue system
KT7300/TK	300 ft. (91 m) Derope® rescue system
KT7400/TK	400 ft. (121 m) Derope® rescue system
KT7500/TK	500 ft. (152 m) Derope® rescue system
KT7600/TK	600 ft. (182 m) Derope® rescue system

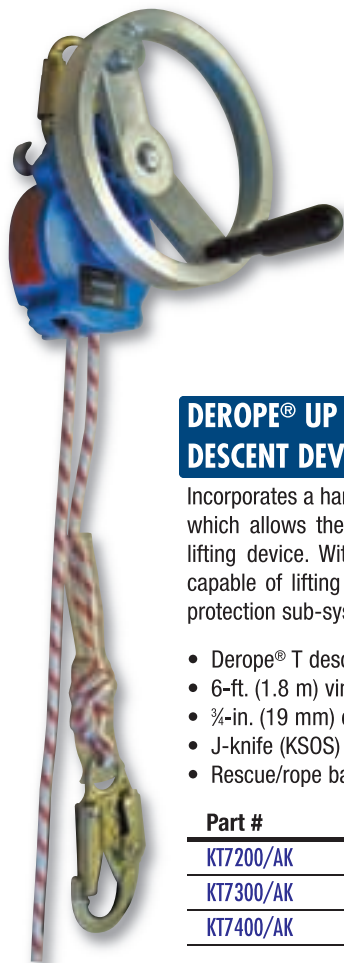

DEROPE® UP A DESCENT DEVICE SYSTEMS

Incorporates a hand wheel winch mounted on to the base unit which allows the Derope® descent device to be used as a lifting device. With a lift ratio of roughly 2:1, the winch is capable of lifting a victim in order to release it from its fall protection sub-system.

- Derope® T descent device unit
- 6-ft. (1.8 m) vinyl covered wire rope sling (V4173)
- ¾-in. (19 mm) carbon steel autolocking carabiner (PM11Z)
- J-knife (KSOS)
- Rescue/rope bag (XB23144 or XB26168)

Part #	Description
KT7200/AK	200 ft. (60 m) Derope® rescue system
KT7300/AK	300 ft. (91 m) Derope® rescue system
KT7400/AK	400 ft. (121 m) Derope® rescue system



LADDER DEROPE® UP E DESCENT DEVICE SYSTEMS

Equipped with a wheel winch and a ladder bracket that can be secured on ladder rungs for more stability during rescue operations.

- Derope® Up E descent device with mounted ladder adapter
- Adjustable lanyard including two ¾-in. (19 mm) carbon steel autolocking carabiners (D58U98)
- Edge roller (K072586K)
- Rescue bag (XB26168)

Derope® Up E descent device systems

Part #	Description
KT7230/WK	100 ft. (30 m) Derope® rescue system
KT7280/WK	200 ft. (60 m) Derope® rescue system
KT7300/WK	300 ft. (91 m) Derope® rescue system
KT7330/WK	330 ft. (100 m) Derope® rescue system

Derope® Up E descent device systems with all of the above plus:

- T-bar (K5TBAR/K)
- Stopfor® A rope grab (WA58)

Part #	Description
KT7230/WKE	100 ft. (30 m) Derope® rescue system
KT7280/WKE	200 ft. (60 m) Derope® rescue system
KT7300/WKE	300 ft. (91 m) Derope® rescue system
KT7330/WKE	330 ft. (100 m) Derope® rescue system



TRIPOD DEROPE® UP R DESCENT DEVICE SYSTEMS

Equipped with a wheel winch and a tripod bracket that can be secured on a tripod leg to perform rescue operations in confined space environments.

Part #	Description
KT7050/R	50 ft. (15 m) Derope® rescue system
KT7100/R	100 ft. (30 m) Derope® rescue system

To calculate rope length required

Evacuation: descent height x 1

Controlled rescue: descent height x 2

Emergency evacuation device

The derope® emergency escape/controlled descent device enables the evacuation of one or two persons from an elevated position to a lower level or the ground at a controlled speed of 235 ft./min. (72 m/min.).

Rescue device

The derope® descent device can also be used for one man or two-man rescue operations. Victims can be lowered alone or accompanied by the rescuer following the standard procedures for rescue applications. If obstructions or obstacles prevent a vertical evacuation, the operation can be carried out down a cableway or tagline positioned at an angle between 30° and 60°.

derope® T (base model)

The derope® descent device utilizes 3/8 in. (9.5 mm) Kernmantle® rope that runs through a guarded rope sheave which is connected to a sealed centrifugal brake that limits the descent speed to 235 ft./min. (72 m/min.). Snap hooks located at each end of the rope allow for multiple evacuations as the brake controls the descent speed in either direction. Dual descent pig tails and an intergraded jamming cleat give the user more control during a rescue. External cooling fins ensure that the unit is rapidly ready for consecutive descents.

derope® Up A descent device with hand wheel winch

Model incorporates a hand wheel winch mounted on to the base unit which allows the Derope® descent device to be used as a lifting device. With a lift ratio of roughly 2:1, the winch is capable of lifting a victim in order to release it from its fall protection sub-system.

derope® Up E descent device with ladder bracket

Model equipped with a wheel winch and a ladder bracket that can be secured on ladder rungs for more stability during rescue operations.

derope® Up R descent device with tripod bracket

Model equipped with a wheel winch and a tripod bracket that can be secured on a tripod leg to perform rescue operations in confined space environments.

For further information, refer to "Use and Maintenance Instructions" for evacuation and rescue equipment and derope® emergency escape/controlled descent device.

FEATURES

- Easy to use, minimum training required
- Single descent for one person:
 - Constant descent speed of 235 ft./min. (72 m/min.)
 - Up to 1,300 ft. (400 m) of descent
- Single descent for two persons:
 - Constant descent speed of 295 ft./min. (90 m/min.)
 - Up to 650 ft. (200 m) of descent

APPLICATIONS

- Wind power turbines
- Aerial electric lines
- Antennas, towers
- Platforms, cranes
- Confined space (sewerage system, gas grid, piping)
- Cable car cabins
- Silos

APPLICABLE STANDARDS

- ANSI Z359.4-07
- CSA Z259.2.3, type 1E

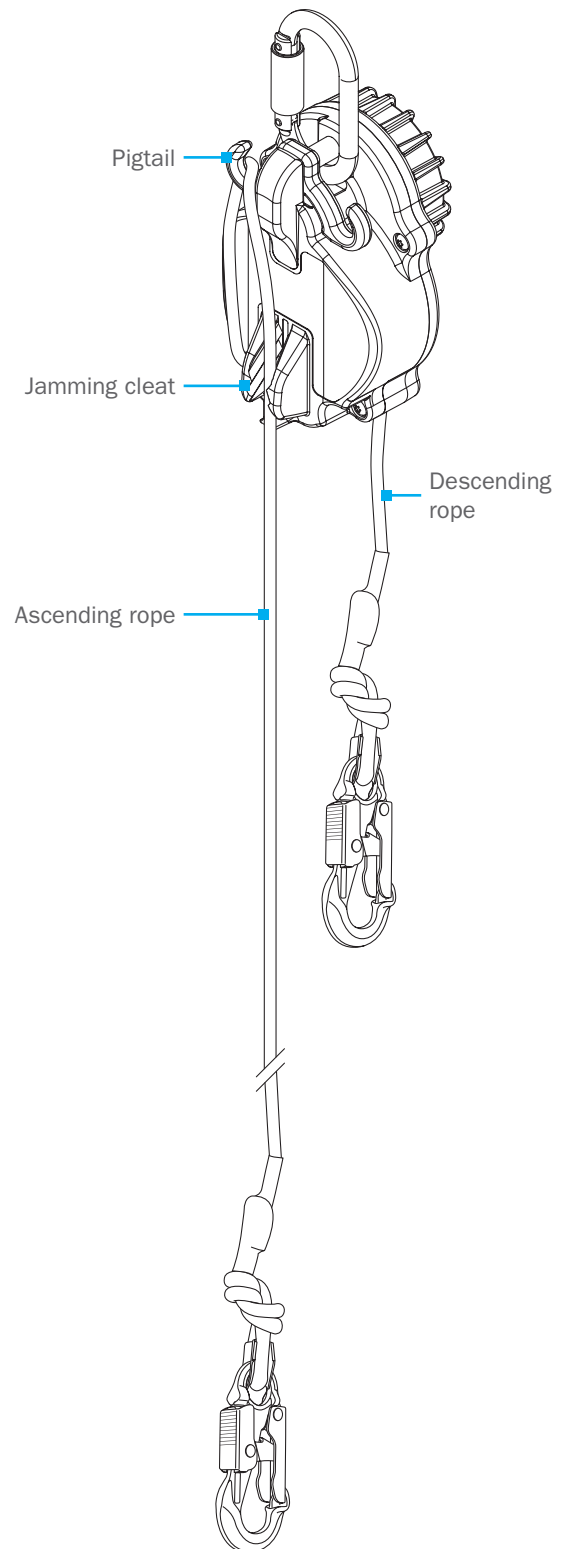

AVAILABLE DEROPE® T DESCENT DEVICE KITS INCLUDING:

derope® descent device unit
6 ft. (1.8 m) vinyl covered wire rope sling – V4173
5/16 in. (16 mm) carbon steel autolocking carabiner – PM11Z
J-knife – KSOS
Rescue/rope bag – XB23144 or XB26168

KT7200/TK 200 ft. (60 m) derope® T descent device system
KT7300/TK 300 ft. (90 m) derope® T descent device system
KT7400/TK 400 ft. (120 m) derope® T descent device system
KT7500/TK 500 ft. (150 m) derope® T descent device system
KT7600/TK 600 ft. (180 m) derope® T descent device system

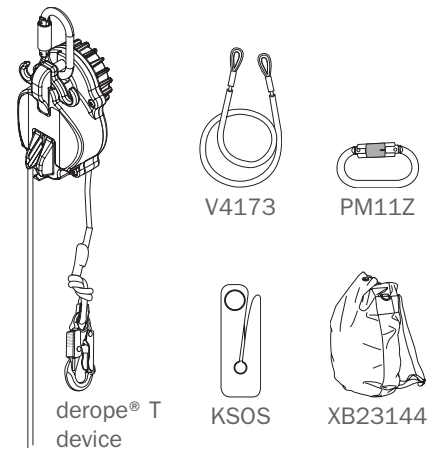

AVAILABLE DEROPE® UP A DESCENT DEVICE KITS INCLUDING:

derope® descent device unit with hand wheel winch
6 ft. (1.8 m) vinyl covered wire rope sling – V4173
5/16 in. (16 mm) carbon steel autolocking carabiner – PM11Z
J-knife – KSOS
Rescue/rope bag – XB23144 or XB26168

KT7200/AK 200 ft. (60 m) derope® Up A descent device system
KT7300/AK 300 ft. (90 m) derope® Up A descent device system
KT7400/AK 400 ft. (120 m) derope® Up A descent device system

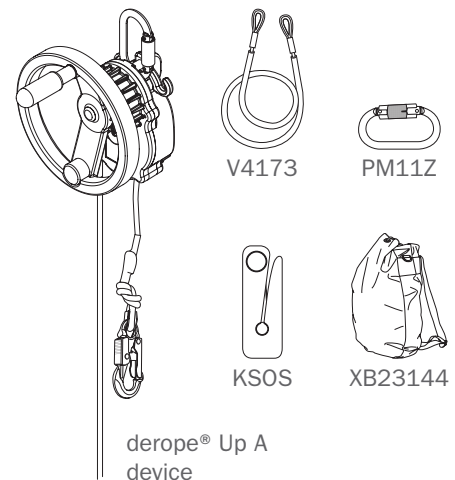

AVAILABLE LADDER DEROPE® UP E DESCENT DEVICE KITS INCLUDING:

derope® descent device unit with mounted ladder adapter
Adjustable lanyard including two PM11Z carabiners – D58U98
Edge roller – K072586K
T-bar – K5TBAR/K
stopfor® A rope grab – WA58
Rescue bag – XB26168

KT7230/WKE 230 ft. (70 m) derope® Up E descent device system
KT7280/WKE 280 ft. (85 m) derope® Up E descent device system
KT7300/WKE 300 ft. (90 m) derope® Up E descent device system
KT7330/WKE 330 ft. (100 m) derope® Up E descent device system

*Recommended lanyard: C826H

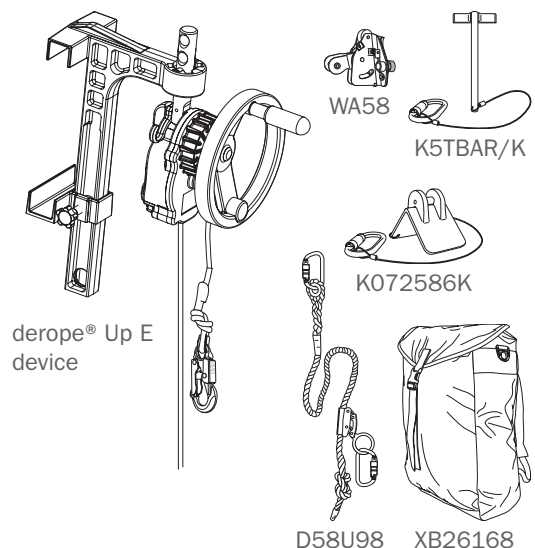

AVAILABLE LADDER DEROPE® UP E DESCENT DEVICE KITS INCLUDING:

derope® descent device unit with mounted ladder adapter
Adjustable lanyard including two PM11Z carabiners – D58U98
Edge roller – K072586K
Rescue bag – XB26168

KT7230/WK 230 ft. (70 m) derope® Up E descent device system
KT7280/WK 280 ft. (85 m) derope® Up E descent device system
KT7300/WK 300 ft. (90 m) derope® Up E descent device system
KT7330/WK 330 ft. (100 m) derope® Up E descent device system

*Recommended lanyards: C5Y26H/R, C526H/R, CA226H/R and C826H

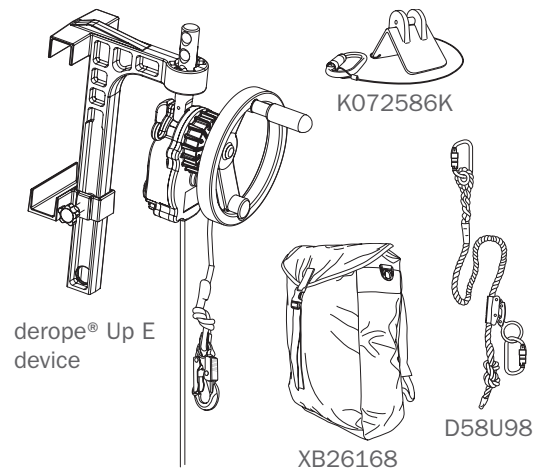

AVAILABLE TRIPOD DEROPE® UP R DESCENT DEVICE KITS:

KT7050/R 50 ft. (15 m) derope® Up R descent device system
KT7100/R 100 ft. (30 m) derope® Up R descent device system

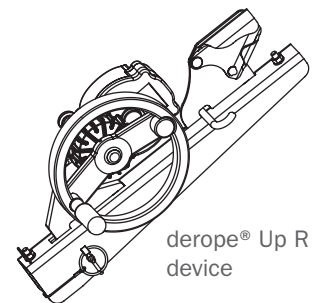

ACCESSORIES

K3040092 In-line double pulley
K3020512 Rigging plate
GC759 Super dry, semi-static 3/8-in. (9.5 mm) kernmantle rope, per foot (system requires 2 ft. [0.6 m] of rope for each foot of height)

Recommended lengths of rope
Evacuation: 1 x the height to evacuate
Rescue: 2 x the height

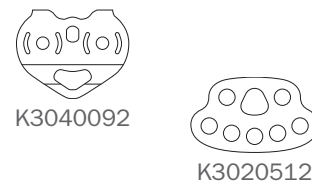

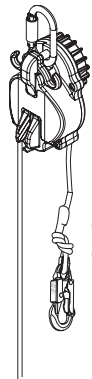

derope® T
descent device

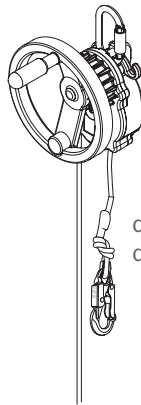

derope® Up A
descent device

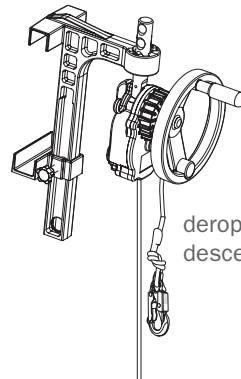

derope® Up E
descent device

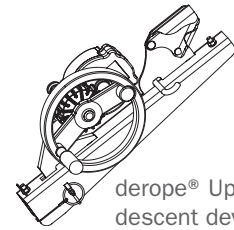

derope® Up R
descent device

MODEL	DEROPE® T		DEROPE® UP A	DEROPE® UP E	DEROPE® UP R
MAX. HEIGHT FOR SINGLE DESCENT	1 PERSON	1,300 ft. (400 m)			
	2 PERSONS	650 ft. (200 m)			
SPEED OF DESCENT	1 PERSON	235 ft./min (72 m/min)			
	2 PERSONS	295 ft./min (90 m/min)			
TEMPERATURE	-31 to 122°F (-35 to 50°C)				
DIMENSIONS (H x W x D)	6 ¹¹ / ₁₆ x 4 ²³ / ₃₂ x 4 ¹ / ₈ in. (170 x 120 x 105 mm)		8 ⁵⁵ / ₆₄ x 7 ⁷ / ₈ x 6 ¹ / ₂ in. (225 x 200 x 165 mm)	19 ²⁹ / ₃₂ x 10 ⁷ / ₁₆ x 6 ¹ / ₂ in. (485 x 265 x 165 mm)	19 ³ / ₃₂ x 10 ⁷ / ₁₆ x 6 ¹ / ₂ in. (485 x 265 x 165 mm)
CONSTRUCTION	Housing: aluminum casting Internal parts (pulley and gears): heat-treated steel				
HAND WHEEL WINCH	MAX. LOAD	n/a	310 lbs. (140 kg)		
	APPLIED FORCE		11 lbs. (5 kg)		
	LIFT RATIO		10 rotations raises victim by 6¾ in. (17 cm)		
CAPACITY	1 PERSON	310 lbs. (140 kg)			
	2 PERSONS	500 lbs. (225 kg)			
WEIGHT	4 lbs. (1.9 kg)		6.6 lbs. (3 kg)	13.4 lbs. (6.1 kg)	14.3 lbs. (6.5 kg)
KERNMANTLE® ROPE (GC7S9)*	¾ in. (9 mm) Tractel® super dry Kernmantle® made of nylon Minimum breaking strength: 4,000 lbs. (18 kN) Elongation: 4.5%				
STANDARDS	ANSI Z359.4-07 and CSA Z259.2.3, type 1E				

Recommended lengths of rope

Evacuation: 1 x the height to evacuate

Rescue: 2 x the height

MAXIMUM NUMBER OF CONSECUTIVE DESCENTS

DESCENT HEIGHT	< 165 ft. (< 50 m)	< 410 ft. (< 125 m)	< 650 ft. (< 200 m)	< 1,000 ft. (< 300 m)	< 1,300 ft. (< 400 m)
CAPACITY OF 310 LBS. (140 KG)	16	6	4	2	2
CAPACITY OF 500 LBS. (225 KG)	6	2	1	1	Prohibited

Specifications are subject to change without notice. Images are for illustrative purposes only.



Distributed By:

WESTECH RIGGING SUPPLY

Visit Us Online at: www.WestechRigging.com

Call Us Toll Free at: 800-442-7475

Call Us or Visit Our Stores Monday - Friday 8:00am - 5:30pm Pacific

4140 West 11th Avenue
Eugene, Oregon 97402
TEL 541-344-6349
FAX 541-338-4931

2439 McGilchrist St SE
Salem, Oregon 97302
TEL 503-399-7037
FAX 503-399-7047