

SUBSEA LEVER HOIST



MODEL: StingRay Subsea Lever Hoist

FEATURES:

- Designed & constructed for use in extreme marine environments and subsea operations
- Unique hand wheel and free wheel knob design.
- Hook tips with cast self-locking latches.
- Patented bonded brake, no brake discs required.
- Caged roller bearings on the load sprocket.
- Dacromet finish on all brake components.
- Integrated safety overload clutch.
- Weston brake with twin pawls.
- Stainless steel name plates.
- Minimum handle effort required to raise loads.
- Load chain includes adjustable End Stop.
- Nickel plated G100 alloy load chain.
- All steel construction & internal surfaces are treated with special anti-corrosive finish.
- Powder coated exterior paint finish.
- Does not require pre-load for lifting function.
- Operating temperature range from -40° to +140°.
- Meets: OSHA, ASME B30.21 and ASME HST-3
- Meets: IMCA D028 Standard (UK subsea lever hoist)



This lever hoist meets or exceeds the following governing standards:



AS 1418.2
ASME B30.21
IMCA D028



Model	Capacity	Pull to Lift Rated Load (lbs.)	Load Chain Size	Chain Strands	Weight w/ o Chain - lbs.	Dimensions (inches)							
						A	B	C	D	E	G	S	T
TUF-SRLH8	08t	60	5.6 x 15.7 mm	1	14.5	6.3	5.2	12.6	9.4	3.9	1.1	1.5	0.6
TUF-SRLH16	1.6t	71	7.1 x 19.9 mm	1	25	7.2	6.2	14.4	10.4	4.3	1.4	1.9	0.8
TUF-SRLH32	3.2t	77	10 x 28 mm	1	45	8.2	8.3	18.3	16.5	4.8	1.7	2.3	1.0
TUF-SRLH63	6.3t	80	10 x 28 mm	2	69	8.2	10.0	23.0	16.5	4.8	1.7	2.6	1.1
TUF-SRLH9	9t	86	10 x 28 mm	3	102	8.2	13.3	27.2	16.5	4.8	2.1	3.3	1.6

Final assembly, factory acceptance testing & proof load testing of imported components carried out in USA.

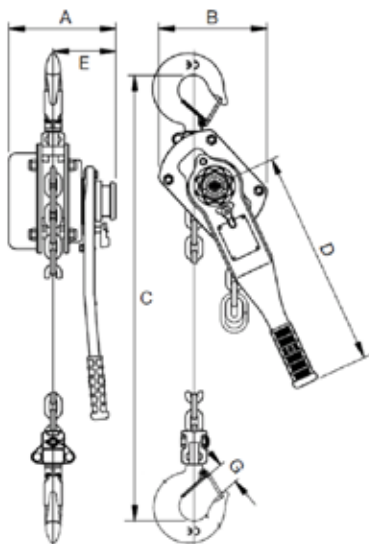

0.8, 1.6 & 3.2t

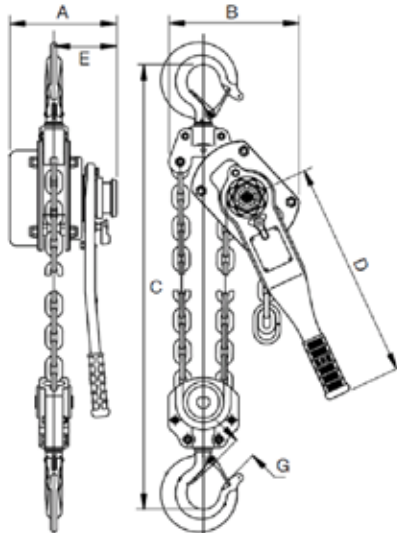

6.3t

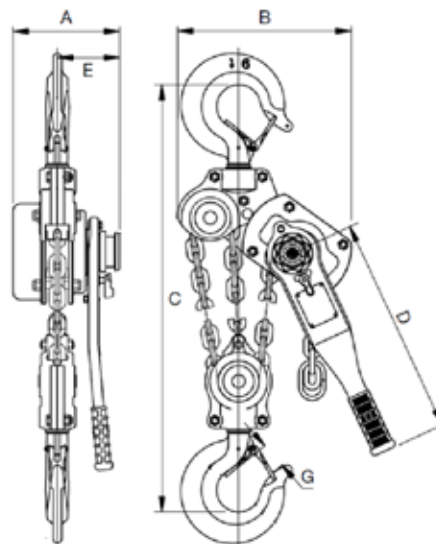

9t

