

**PECK & HALE, L.L.C.
LIMITED PRODUCT
WARRANTY**

WARNING:

THE *RAM-Hook*
IS NOT INTENDED FOR
AND SHOULD NOT
BE USED IN OVERHEAD
OR LIFE SUPPORT
OPERATIONS.

Peck & Hale products are warranted against defective material and workmanship for a period of one year from date of delivery. This warranty is limited to repair or replacement of the defective part or the complete replacement at the discretion of Peck & Hale, L.L.C.

In no event shall Peck & Hale, L.L.C. be liable for any consequential damage resulting from part failure for any reason whatsoever. No other warranties are expressed or implied.

This warranty shall be null and void if the product is repaired or altered by anyone other than personnel authorized by Peck & Hale, L.L.C.

Proper maintenance, use and observance of load limits are your best assurance of long, trouble-free service life.

RETURN & REPAIR POLICY

Any attempt to repair or modify a RAM-Hook by anyone other than authorized Peck & Hale personnel voids all warranties.

If hook fails to open when latch lock is properly pulled while under load, immediately relieve load, remove RAM-Hook and contact Peck & Hale sales for return authorization and evaluation.

Release-A-Matic® *RAM-Hook*



Peck & Hale™
Cargo securing systems

WESTECH RIGGING SUPPLY
Call Toll Free: 800-442-7475

Call Us or Visit Our Stores:
Monday - Friday, 8:00am - 5:30pm Pacific



Distributed By

Visit Us Online at: www.WestechRigging.com

4140 West 11th Avenue
Eugene, Oregon 97402

2439 McGilchrist St SE
Salem, Oregon 97302

Release-A-Matic®

RAM-Hook

SPECIFICATIONS

	P&H No.	WEIGHT LBS	MINIMUM BREAK STRENGTH	SAFE* WORKING LOAD	PULL STRENGTH TO RELEASE-LBS			
					WEIGHT OF LOAD	PULL STRENGTH REQUIRED (APPROX)	MAX WEIGHT OF LOAD	PULL STRENGTH REQUIRED (APPROX)
Forged Alloy Steel	H44-3	2.0	18,000	4,500	0	15	3,500	80
	H44-9	12.0	71,700	18,000	0	35	10,000	120
Stainless Steel	H44-3L	2.0	8,000	2,000	0	15	2,000	70

*Do not exceed Safe Working Load limit

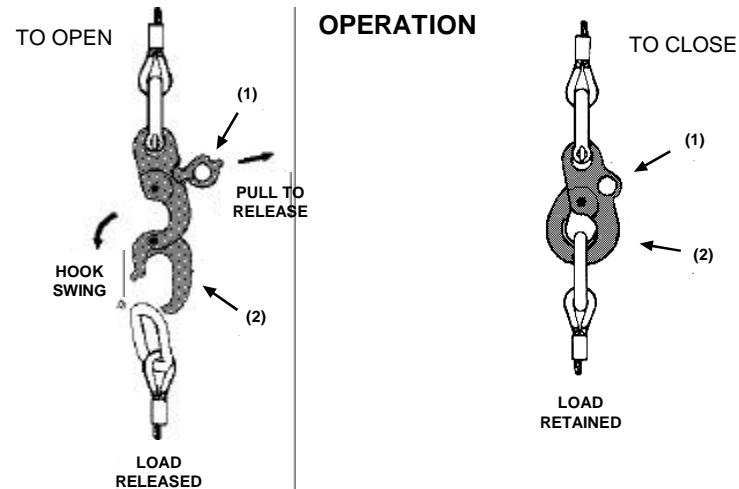

INSTRUCTIONS FOR OPERATION

1. To open hook-pull on latch lock (1). Link (2) will swing open allowing load to be released.
2. To close hook-with a recommended ring engaging the link (2) rotate the link to a fully upright position. Snap the latch lock (1) shut against the hook body. Tug on ring to confirm proper engagement before applying load in the direction shown on the following page (to close, step 3).
3. A lanyard can be attached to the latch lock (1) for remote release provided that adequate safety precautions are taken.

H44 - OPERATING INSTRUCTIONS

TO OPEN:



TO CLOSE:

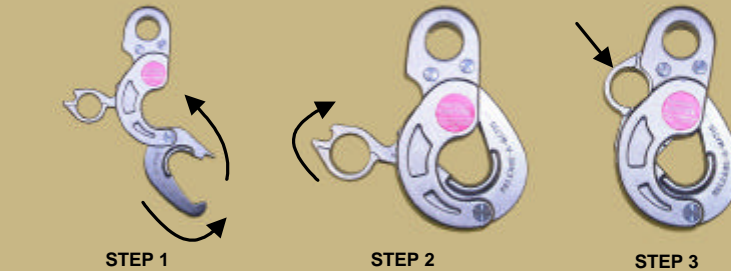

**DO NOT HAMMER OR USE
EXCESSIVE FORCE**
**LATCH LOCK WILL ENGAGE EASILY
WHEN CLOSED PROPERLY**

Release-A-Matic®

RAM-Hook

PROPER USAGE

- 1) All RAM-Hooks are intended to be released under slack load conditions. They can also be utilized to release under load conditions. Any release under load must be carefully studied as to its applicability and safety.
- 2) NEVER EXCEED "SAFE WORKING LOAD" as stated herein.
- 3) When releasing under a load condition, NEVER EXCEED "WEIGHT OF LOAD TO RELEASE" limits as stated herein. (Refer to Specification Chart).
- 4) Manufacturer denies any liability for damages which may result from use in excess of "Safe Working Load" or "Weight of Load to Release" limits.
- 5) Any change, abuse or misuse of the hook may lessen the load the hook will withstand. Some examples of change, abuse or misuse are:
 - Twisting
 - Modification
 - Deterioration by corrosion
 - Shock/Impact loading
 - Used for purpose other than intended
 - Used in excess of "Safe Working Load" limit (SWL)
 - Used in excess of "Weight Of Load To Release" limit (WLR)
 - Side loading
 - Loads applied from more than one source through hook body
 - Extreme vibration**NOTE: MISUSE OF THIS PRODUCT CAN RESULT IN SERIOUS INJURY.**
- 6) All loads must be evenly distributed in the middle of the hook and in a center line with the lifting eye in order to insure a straight line pull.
- 7) This hook is intended to release when the latch lock is pulled. Under no circumstances should anyone stand near or under the load being released.
- 8) These hooks are intended to engage a *single* round, oblong or pear shaped ring of sufficient diameter to lay within the hook link and center itself without interference with the hook body. Ring stock must be round and ring strength must meet or exceed hook strength.
- 9) Hooks should be regularly inspected to determine their condition as a basis for deciding if the product may continue to be used at the SWL Limit or WLR Limit.