

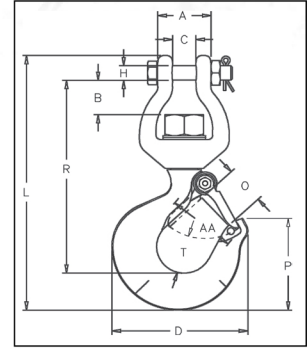

S-3316
REPLACEMENT HOOK

- Easily attaches to any chain and electric hoist with welded link load chain, roller chain or wire rope with suitable end fitting.
- Swivel jaw is forged.
- Suitable for infrequent, non-continuous rotation under load.
- Use in corrosive environment requires shank and nut inspection in accordance with ASME B30.10-1.10.4(b)(5)(c)2009.



S-3316 Replacement Hook

Working Load Limit (Tons)*	Frame Code	S-3316 Stock No.	Weight Each (lbs.)	Dimensions (in.)										Replacement Latch Kit Stock No.
				A	B	C	D	H	L	O	P	R	T	
1/2	F	1023029	1.25	1.31	.76	.56	3.19	.38	6.12	.97	2.25	4.59	.81	1096374
1	H	1023047	2.61	1.56	1.00	.69	4.09	.44	7.69	1.12	2.84	5.81	1.19	1096468

*Ultimate Load is 5 times the Working Load Limit.



A-378
SORTING HOOK

- Forged Alloy Steel - Quenched and Tempered.
- Deep straight throat permits efficient handling of flat plates or large cylindrical shapes.



A-378
SORTING HOOK

A-378 Sorting Hook

Working Load Limit at tip of Hook (Tons)*	Working Load Limit at bottom of Hook (Tons)*	A-378 Stock No	Style	Weight Each (lbs.)	Dimensions (in.)			
					I.D. of Eye	Overall Length	Opening at top of Hook	Radius at bottom of Hook
2	7-1/2	1028024	No Handle	6.42	1.38	9.69	2.81	.625
2	7-1/2	1028033	With Handle	6.42	1.38	9.69	2.81	.625

*Ultimate Load is 4 times the Working Load Limit.

WESTECH RIGGING SUPPLY

Call Toll Free: 800-442-7475

Call Us or Visit Our Stores:
Monday - Friday, 8:00am - 5:30pm Pacific



Distributed By

Visit Us Online at: www.WestechRigging.com

4140 West 11th Avenue
Eugene, Oregon 97402

2439 McGilchrist St SE
Salem, Oregon 97302