

## Vertical Clamps



### IPU10/A

The IPU10/A automatically clicks on to the material as soon as the clamp is placed on the plate. The fact that the safety lock remains in position as the clamp closes precludes hazardous situations. Fastening the IPU10/A clamp in places that are difficult to reach is no problem.

### For vertical transport of plates

- Available in capacities of 1 and 2 metric tons.
- Jaw openings available: 0 to 35mm; 0" to 1.97".
- Welded alloy steel body for strength and smaller size. Forged alloy components where required.
- Individually Proof Tested to 2 times the Working Load Limit with certification.
- Company name (CrosbyIP), logo, Working Load Limit and jaw opening permanently stamped on body.
- Each product is individually serialized, with the serial number and Proof Load test date stamped on body. User manual with test certificate is included with each clamp.
- Available in a variety of styles: Full 180° turning range for material transfer, turning or moving.
- Lock open, lock closed ability with latch for pretension on material and then release of material.
- Optional IP-5000 Stinger assembly available (see page 428). Allows for easy connection between the clamp and hoist hook.
- Minimum WLL of 10% of Maximum WLL.
- Maintenance replacement parts are available.
- Manufactured by an ISO 9001 facility.
- All sizes are **RFID EQUIPPED**.

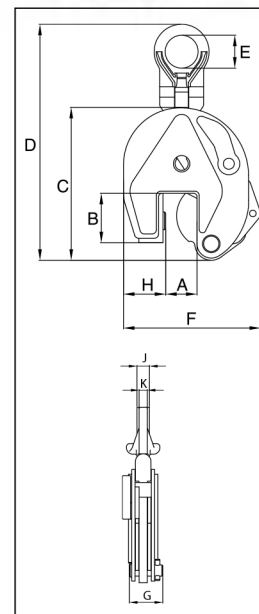

**Load Rated**

### Model IPU10/A

Model	Working Load Limit (t)*	IPU10/A Stock No.	Weight Each (lbs.)	Dimensions (in.)									
				Jaw A	B	C	D	E	F	G	H	J	K
IPU10/A	1	2701628	5.07	0 - .79	1.77	5.43	9.37	1.57	5.04	1.61	1.46	0.43	0.43
IPU10/A	2	2701629	19.62	0 - 1.38	3.07	7.9	14.88	2.76	7.87	2.40	2.83	0.63	0.63
IPU10/A	6	2701638	52.91	0 - 1.97	4.96	11.89	20.67	3.14	11.50	3.31	3.74	1.73	0.79

\* Design Factor based on EN 13155 and ASME B30.20.

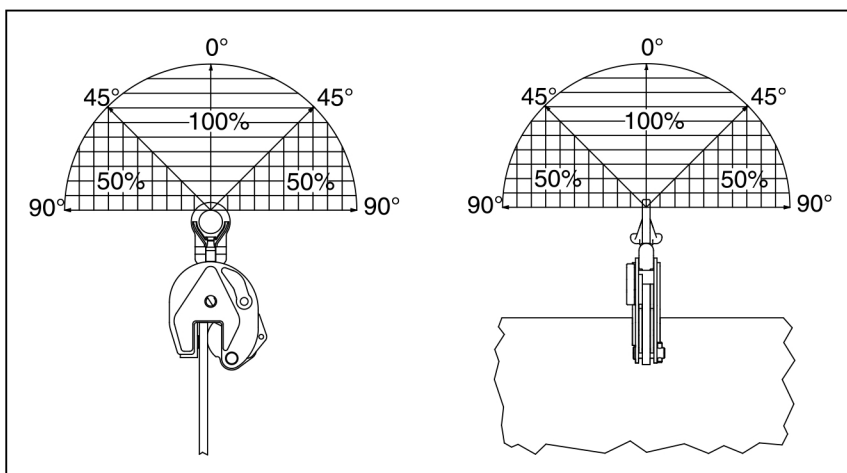

**WESTECH RIGGING SUPPLY**

Call Toll Free: 800-442-7475

Call Us or Visit Our Stores:  
Monday - Friday, 8:00am - 5:30pm Pacific



Distributed By

Visit Us Online at: [www.WestechRigging.com](http://www.WestechRigging.com)

4140 West 11th Avenue  
Eugene, Oregon 97402

2439 McGilchrist St SE  
Salem, Oregon 97302

**CROSBY® LIFTING CLAMPS**