

## HOOK CONNECTORS

The 5 connector styles shown below make it possible for Crosby to furnish a Golden Gate Hook to fit almost any make or model of hoisting equipment including, American Engineering Lo-Hed, ARO, Coffing, Electro Lift, Ingersoll-Rand, P & H, Robbins and Myers, Shepard Niles, CM, Shaw-Box, Wright, Yale & Towne.

**CLOSED SWIVEL BAIL**

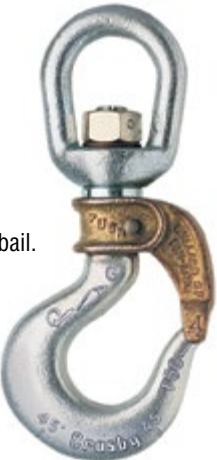

For use where hoisting line or shackle can be inserted into the bail. Suitable for positioning before lifting. Hook sizes: 1 through 14.

**Style C** — with self-closing gate.  
**Style A** — with manual-closing gate.

**SHANK-TYPE HOOK**  
 (Standard Length)



For use on existing load blocks, with standard shank length. Hook sizes: 2 through 14.

**Style D** — with self-closing gate.  
**Style B** — with manual-closing gate.

**SHANK-TYPE HOOK**  
 (Long Length)

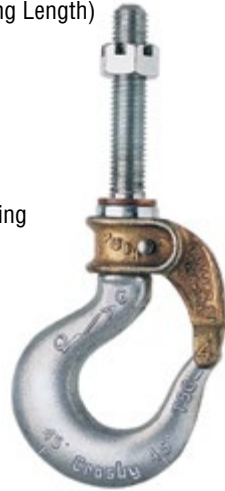

For use on existing load blocks requiring extra shank length. Hook sizes: 4 through 17.

**Style K** — with self-closing gate.  
**Style I** — with manual-closing gate.

**UNIVERSAL TYPE**



Open swivel bail for attachment to link chain. Suitable for positioning before lifting. Hook sizes: 3, 4, and 5.

**Style E** — with self-closing gate.  
**Style G** — with manual-closing gate.

**LINK CHAIN NEST**



With ball-bearing swivel; attaches to chain by an alloy pin. Suitable for frequent rotation under load. Hook sizes: 4, 5, and 7.

**Style O** — with self-closing gate.  
**Style P** — with manual-closing gate.

Letter designations shown beneath each illustration above indicate BOTH connector style and gate type. Each connector is available with either a self-closing or manual-closing gate. (e.g. A size 4 hook with a closed swivel bail connector and self-closing gate is 4-C; with manual-closing gate, it is 4-A.)

## Closed Swivel Bail



- For use where hoisting line or shackle can be inserted into the bail.
  - BL-C with self-closing gate
  - BL-A with manual-closing gate
- Suitable for positioning before lifting.
- Crosby Bullard® Hooks incorporate QUIC-CHECK® deformation and angle indicators. (For detailed information, see the Crosby Value Added page at the beginning of this section.)

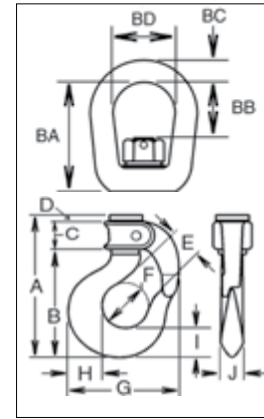

APPLICATION AND WARNING INFORMATION  
SECTION 17

## Closed Swivel Bail

Hook Size	BL-C Stock No.	BL-A Stock No.	Gate Type	WLL (short Tons)*	Weight Each (lb)	Dimensions (in)													
						A	B	C	D	E	F	G	H	I	J	BA	BB	BC	BD
1	1050210	1050001	LIF-LOK	.45	0.8	3.23	2.31	.63	.26	.69	.88	2.25	.69	.63	.44	1.75	.63	.31	1.00
2	1050221	1050012	PIN-LOK	.90	1.3	4.12	3.00	.93	.16	.97	1.25	2.88	.81	.75	.56	1.86	.95	.38	1.25
3	1050232	1050023	PIN-LOK	1.3	1.9	4.50	3.31	.94	.22	1.06	1.38	3.19	.94	.84	.63	2.44	1.31	.50	1.50
4	1050243	1050034	PIN-LOK	1.5	2.2	4.88	3.63	1.00	.22	1.13	1.50	3.63	1.16	1.00	.75	2.66	1.35	.50	1.50
5	1050254	1050045	ROLLOX	2.1	3.8	5.63	4.12	1.23	.25	1.25	1.64	4.09	1.31	1.12	.84	2.91	1.60	.63	1.75
6	1050265	1050056	ROLLOX	3.6	4.6	6.23	4.70	1.25	.25	1.39	1.64	4.56	1.57	1.34	.97	3.10	1.41	.63	1.75
7	1050276	1050067	ROLLOX	3.8	6.9	6.61	5.21	1.12	.25	1.50	2.00	4.94	1.63	1.44	1.13	3.48	1.67	.75	2.00
8	1050287	1050078	ROLLOX	5.0	9.6	7.17	5.80	1.06	.28	1.75	2.25	5.84	2.00	1.65	1.23	4.06	2.00	.88	2.25
9	1050298	1050089	ROLLOX	6.5	13.5	7.85	6.45	1.06	.31	1.88	2.50	6.50	2.06	1.81	1.38	4.65	2.21	1.03	2.50
11	1050309	1050100	TIP-LOK	8.3	20.5	9.62	8.00	1.25	.31	2.25	3.00	7.56	2.63	2.25	1.62	4.87	2.18	1.13	2.75
12	1050320	1050111	TIP-LOK	11.1	27.0	10.53	8.84	1.25	.38	2.50	3.25	8.69	2.94	2.59	1.94	5.13	2.25	1.25	3.13
14	1050342	1050133	TIP-LOK	16.7	55.0	12.60	10.75	1.41	.38	3.38	4.25	11.00	3.50	2.97	2.38	8.00	4.25	1.63	4.10

4:1 Design Factor.

## Open Swivel Bail



- Open Swivel Bail for attachment to link chain.
  - BL-E with self-closing gate
  - BL-G with manual-closing gate
- Suitable for positioning before lifting.
- Crosby Bullard® Hooks incorporate QUIC-CHECK® deformation and angle indicators. (For detailed information, see the Crosby Value Added page at the beginning of this section.)

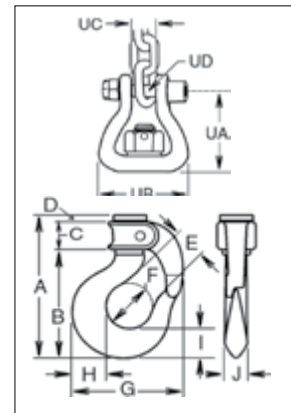

## Open Swivel Bail

Hook Size	BL-E Stock No.	BL-G Stock No.	Gate Type	WLL (short Tons)*	Weight Each (lb)	Dimensions (in)													
						A	B	C	D	E	F	G	H	I	J	UA	UB	UC	UD
3	1051607	1051706	PIN-LOK	1.3	1.8	4.50	3.31	.94	.22	1.06	1.38	3.19	.94	.84	.63	2.08	2.31	.52	.38
4	1051618	1051717	PIN-LOK	1.5	2.1	4.88	3.63	1.00	.22	1.13	1.50	3.63	1.16	1.00	.75	2.14	2.31	.52	.38
5	1051629	1051728	ROLLOX	2.1	3.2	5.63	4.12	1.23	.25	1.25	1.64	4.09	1.31	1.12	.84	2.56	2.63	.62	.44

4:1 Design Factor.

## Link Chain Nest



- With ball bearing swivel; attaches to chain by an alloy pin.
  - BL-O with self-closing gate
  - BL-P with manual-closing gate
- Suitable for frequent rotation under load.
- Crosby Bullard® Hooks incorporate QUIC-CHECK® deformation and angle indicators. (For detailed information, see the Crosby Value Added page at the beginning of this section.)

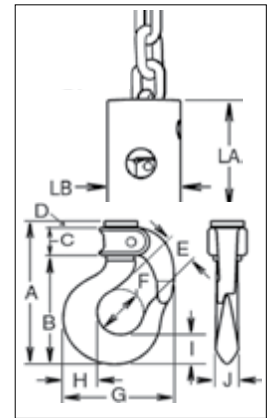

APPLICATION AND WARNING INFORMATION  
SECTION 17

## Link Chain Nest

Chain Size	BL-O Stock No.	BL-P Stock No.	Gate Type	WLL (short Tons)*	Weight Each (lb)	Dimensions (in)											
						A	B	C	D	E	F	G	H	I	J	LA	LB
4:1/4-9/32	1051409	1051508	PIN-LOK	1.5	2.5	4.88	3.63	1.00	.22	1.06	1.50	3.63	1.16	1.00	.75	2.65	1.75
5:5/16-3/8	1051442	1051541	ROLLOX	2.1	4.5	5.53	4.12	1.23	.25	1.25	1.64	4.10	1.31	1.12	.84	3.00	2.25
7:3/8-7/16	1051464	1051563	ROLLOX	3.8	11.0	6.61	5.21	1.12	.25	1.50	2.00	4.94	1.63	1.44	1.13	4.38	3.00
7:1/2-9/16	1051486	1051585	ROLLOX	3.8	11.0	6.61	5.21	1.12	.25	1.50	2.00	4.94	1.63	1.44	1.13	4.38	3.00

4:1 Design Factor.

## Standard Length



- For use on existing load blocks, with standard shank length.
  - BL-D with self-closing gate
  - BL-B with manual-closing gate
- Numbers 2 through 12 style hooks are threaded approximately 80% of shank length.
- Crosby Bullard® Hooks incorporate QUIC-CHECK® deformation and angle indicators. (For detailed information, see the Crosby Value Added page at the beginning of this section.)

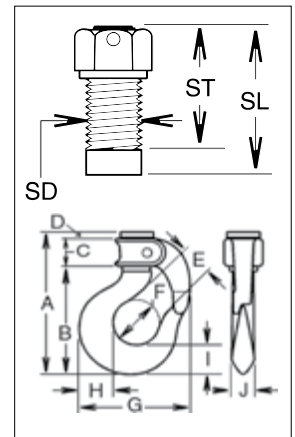

APPLICATION AND WARNING INFORMATION  
SECTION 17

## Standard Length Shank Hooks

Hook Size	BL-D Stock No.	BL-B Stock No.	Gate Type	WLL (short Tons)*	Weight Each (lb)	Dimensions (in)												
						A	B	C	D	E	F	G	H	I	J	SD	SL	ST
2	1050606	1050408	PIN-LOK	.91	1.1	4.12	3.00	.93	.16	.97	1.25	2.88	.81	.75	.56	.50	.91	.59
3	1050617	1050419	PIN-LOK	1.3	1.3	4.50	3.31	.94	.22	1.06	1.38	3.19	.94	.84	.63	.56	1.25	.75
4	1050628	1050430	PIN-LOK	1.5	1.7	4.88	3.63	1.00	.22	1.13	1.50	3.63	1.16	1.00	.75	.63	1.31	1.19
5	1050639	1050441	ROLLOX	2.1	2.5	5.63	4.12	1.23	.25	1.25	1.64	4.09	1.31	1.12	.84	.75	1.31	1.00
6	1050650	1050452	ROLLOX	3.6	3.5	6.23	4.70	1.25	.25	1.39	1.64	4.56	1.57	1.34	.97	.88	1.69	1.16
7	1050661	1050463	ROLLOX	3.8	5.2	6.61	5.21	1.12	.25	1.50	2.00	4.94	1.63	1.44	1.13	1.00	1.81	1.38
8	1050672	1050474	ROLLOX	5.0	7.1	7.17	5.80	1.06	.28	1.75	2.25	5.84	2.00	1.65	1.23	1.13	2.06	1.50
9	1050683	1050485	ROLLOX	6.5	9.5	7.85	6.45	1.06	.31	1.88	2.50	6.50	2.06	1.81	1.38	1.25	2.44	1.81
11	1050694	1050496	TIP-LOK	8.3	15.6	9.62	8.00	1.25	.31	2.25	3.00	7.56	2.63	2.25	1.62	1.50	2.69	1.88
12	1050705	1050507	TIP-LOK	11.2	21.0	10.53	8.84	1.25	.38	2.50	3.25	8.69	2.94	2.59	1.94	1.63	2.88	2.13
13	1050716	1050518	TIP-LOK	13.6	30.0	11.23	9.54	1.25	.38	3.00	3.75	9.63	3.28	2.75	1.94	1.75	3.50	2.20
14	1050727	1050529	TIP-LOK	16.8	40.0	12.60	10.75	1.41	.38	3.38	4.25	11.00	3.50	2.97	2.38	2.00	3.75	2.38

4:1 Factor de diseño.

## Long Length



- For use on existing load blocks requiring extra shank length.
  - BL-K with self-closing gate
  - BL-I with manual closing gate
- Numbers 4 through 9 style hooks are threaded approximately 80% of shank length.
- Crosby Bullard® Hooks incorporate QUIC-CHECK® deformation and angle indicators.

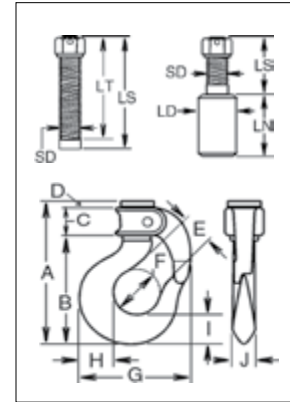

APPLICATION AND WARNING INFORMATION  
SECTION 17

## Long Length Shank Hooks

Hook Size	BL-K Stock No.	BL-I Stock No.	Gate Type	WLL (short Tons)*	Weight Each (lb)	Dimensions (in)													
						A	B	C	D	E	F	G	H	I	J	SD	LN	LS	LT
4 :1/2	1051002	1050804	PIN-LOK	1.45	1.9	4.88	3.63	1.00	.22	1.13	1.50	3.63	1.16	1.00	.75	.50	.44	3.19	3.19
4 :9/16	1051013	1050815	PIN-LOK	1.5	1.9	4.88	3.63	1.00	.22	1.13	1.50	3.63	1.16	1.00	.75	.56	.48	3.19	3.19
4 :5/8	1051024	1050826	PIN-LOK	1.5	1.9	4.88	3.63	1.00	.22	1.13	1.50	3.63	1.16	1.00	.75	.63	.55	3.31	3.19
5	1051035	1050837	ROLLOX	2.1	3.0	5.63	4.12	1.23	.25	1.25	1.64	4.09	1.31	1.12	.84	.75	.63	3.56	3.25
6	1051046	1050848	ROLLOX	3.6	3.8	6.23	4.70	1.25	.25	1.39	1.64	4.56	1.57	1.34	.97	.88	.75	4.06	3.54
7	1051057	1050859	ROLLOX	3.8	5.9	6.61	5.21	1.12	.25	1.50	2.00	4.94	1.63	1.44	1.13	1.00	.88	4.56	4.12
8	1051068	1050870	ROLLOX	5.0	7.8	7.17	5.80	1.06	.28	1.75	2.25	5.84	2.00	1.65	1.23	1.12	.94	5.06	4.50
9	1051079	1050881	ROLLOX	6.5	10.8	7.85	6.45	1.06	.31	1.88	2.50	6.50	2.06	1.81	1.38	1.25	1.06	5.56	4.94
12 ‡	1051101	1050903	TIP-LOK	11.2	28.0	10.53	8.84	1.25	.38	2.50	3.25	8.69	2.94	2.59	1.94	1.63	1.56	5.38	4.63
13 ‡	1051112	1050914	TIP-LOK	13.6	35.0	11.23	9.54	1.25	.38	3.00	3.75	9.63	3.28	2.75	1.94	1.75	1.50	7.37	5.75
14 ‡	1051123	1050925	TIP-LOK	16.8	45.0	12.60	10.75	1.41	.38	3.38	4.25	11.00	3.50	2.97	2.38	2.00	2.00	5.38	4.00
16	1051134	1050936	TIP-LOK	30.0	103.0	15.29	13.10	1.50	.63	4.00	5.00	13.62	4.63	3.63	3.00	2.75	2.75	16.00	7.00
17	1051156	1050958	TIP-LOK	60.0	370.0	24.20	20.57	2.63	.94	5.75	7.00	18.50	6.50	6.00	4.44	4.00	3.94	22.75	14.00

4:1 Design Factor. ‡Hook will have the shank extended by use of a Coupling Nut. Customer is required to complete and approve side 2 of a Crosby Bullard® hook data form.

## Crosby® / Bullard Golden Gate Hooks Service Parts

Hook Size	Gate Type	BL-GA Gate Assemblies		BL-RK Gate Repair Kit Stock No.
		Manual Close Stock No.	Self Close Stock No.	
2	PIN-LOK	1100298	1100309	1100101
3	PIN-LOK	1100320	1100331	1100102
4	PIN-LOK	1100342	1100353	1100103
5	ROLLOX	1100364	1100375	1100112
6	ROLLOX	1100386	1100397	1100113
7	ROLLOX	1100408	1100419	1100123
8	ROLLOX	1100430	1100441	1100124
9	ROLLOX	1100452	1100463	1100125
10	TIP-LOK	1100474	1100485	1100133
11	TIP-LOK	1100496	1100507	1100144
12	TIP-LOK	1100518	1100529	1100155
13	TIP-LOK	1100540	1100551	1100166
14	TIP-LOK	1100562	1100573	1100177
15	TIP-LOK	1100584	1100595	1100188
16	TIP-LOK	1100606	1100617	1100199
17	TIP-LOK	1100639	1100628	1100210

## Bullard® QUIC-CHECK® Deformation Indicator Table

Hook Size	Hook ID Code	AA (in)
1	1	1.50
2	D	1.50
3	F	1.50
4	G	2.00
5	H	2.00
6	6	2.50
7	I	2.50
8	8	3.00
9	J	4.00
11	K	4.00
12	L	4.50
13	13	5.00
14	N	5.00
16	O	6.50
17	T	10.00

O-318



- With ball bearing swivel; attaches to chain by an alloy pin.
- Suitable for frequent rotation under load.
- HO-318 Hooks utilize Crosby SHUR-LOC® positive locking hooks. Latch is self-locking when hook is loaded.
- O-319 Hooks utilize Crosby® standard 319 Shank Hooks which incorporate QUIC-CHECK® deformation and angle indicators. (For detailed information, see the Crosby Value Added page at the beginning of this section.)
- Entire assembly is zinc plated.
- Repair kit available consisting of bearing and spring pin.

O-319

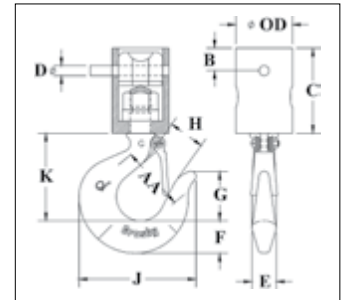
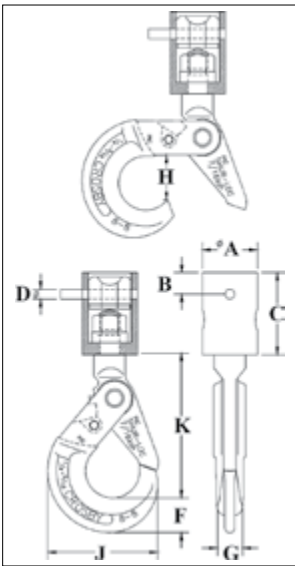

APPLICATION AND WARNING INFORMATION  
SECTION 17

O-318 Chain Nest Hooks

Chain Size (in)	Stock No.	WLL (short Tons)*	Weight Each (lb)	Dimensions (in)										Replacement Trigger Kit Stock No.
				A	B	C	D	F	G	H	J	K		
1/4 - 9/32	1098409	1.5	1.7	1.75	.70	2.62	.31	1.10	.81	1.46	3.50	4.59	6603011	
5/16 - 3/8	1098427	2.1	2.3	2.13	.70	3.19	.38	1.15	.94	1.83	4.35	5.65	6603012	
3/8 - 7/16	1098445	3.8	4.2	3.00	1.00	4.38	.50	1.66	1.16	2.11	5.45	7.06	6603013	
1/2 - 9/16	1098463	3.8	4.2	3.00	1.00	4.38	.63	1.66	1.16	2.11	5.45	7.06	6603013	

4:1 Design Factor.

O-319 Chain Nest Hooks

Chain Size (in)	Stock No.	WLL (short Tons)*	Weight Each (lb)	Dimensions (in)											Replacement Trigger Kit Stock No.
				OD	AA	B	C	D	E	F	G	H	J	K	
1/4 - 9/32	1098312	1.5	1.7	1.75	2.00	.70	2.62	.31	.75	1.00	1.53	1.00	3.62	2.69	1096421
5/16 - 3/8	1098334	2.1	2.3	2.13	2.00	.70	3.19	.38	.84	1.12	1.72	1.12	4.09	3.06	1096468
3/8 - 7/16	1098356	3.8	4.2	3.00	2.50	1.00	4.38	.50	1.12	1.44	2.12	1.34	4.84	3.78	1096515
1/2 - 9/16	1098378	3.8	4.2	3.00	2.50	1.00	4.38	.63	1.12	1.44	2.12	1.34	4.84	3.78	1096515

4:1 Design Factor. \*Deformation indicators.